

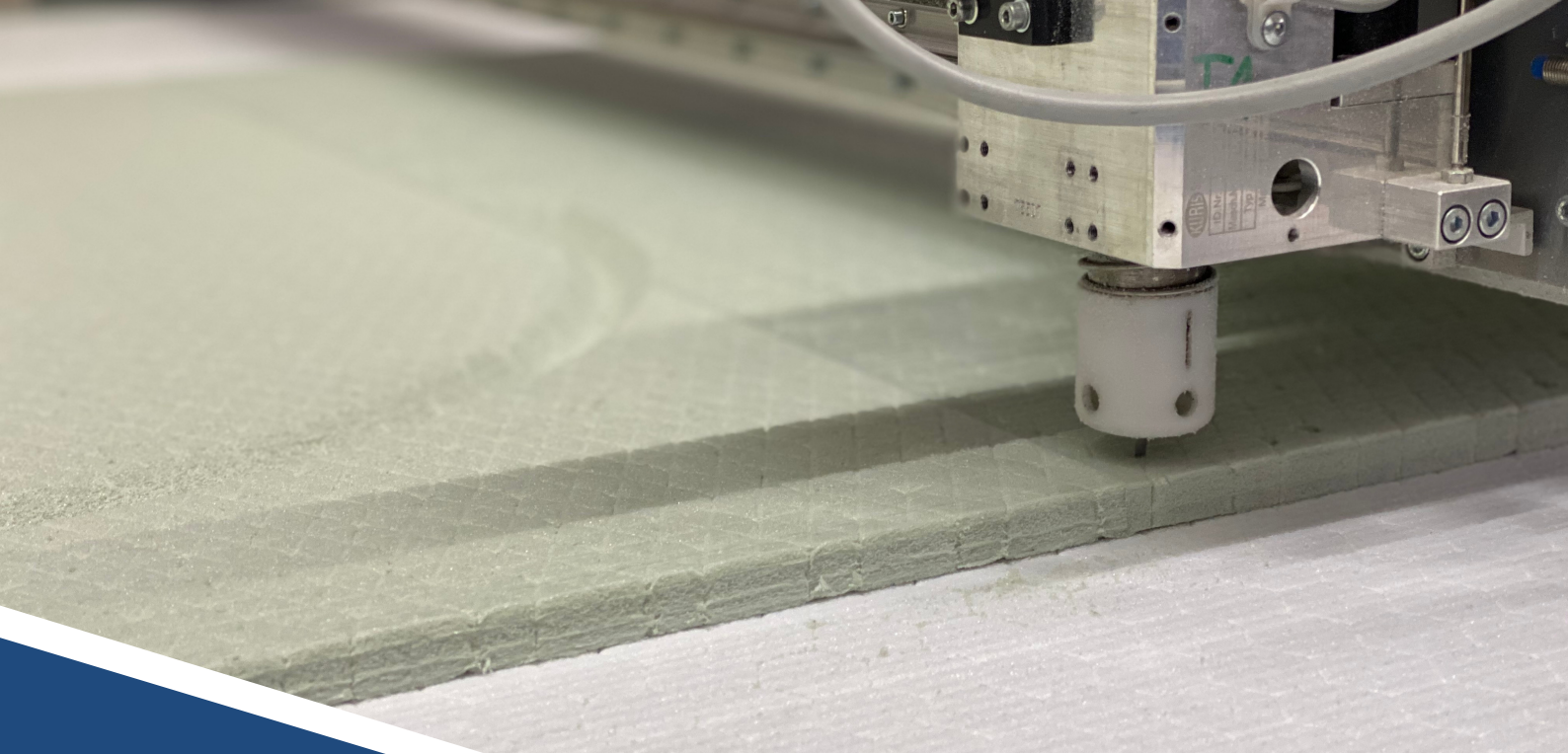

**3D|CORE™**  
all around composites

# **3D|CORE™ ASSEMBLY KITS**

# **MARINE**



**3D|CORE™**  
all around composites

## ASSEMBLY KITS

The 3D|CORE™ ASSEMBLY KITS consist of pre-cutted foam, scrim and fibre parts which will fit exactly into the mould. Through the patented 3D|CORE™ structure in the foam, you will get a product with already integrated flowing aid and outstanding technical properties.

## ALL OUT OF ONE HAND

From your idea, the drawing and the 3D planning, over the construction to the production of the ASSEMBLY KIT and placing on site.

## MORE

With 3D|CORE™ ASSEMBLY KITS you have the possibility of producing project specific prototypes and serial components. We will gladly support you with the calculations and design of simple and complex components, as well as checking the technical feasibility.

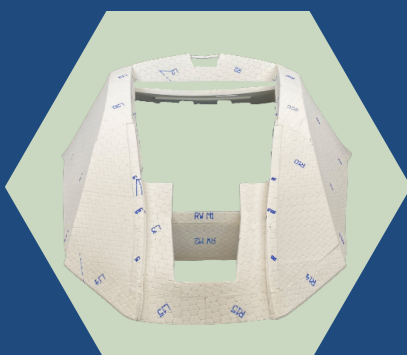

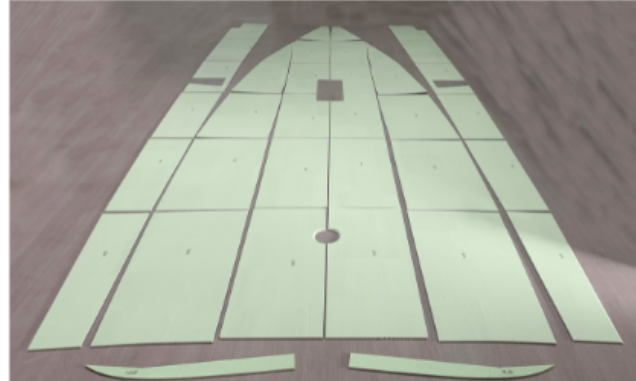
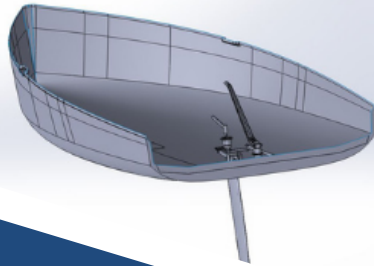
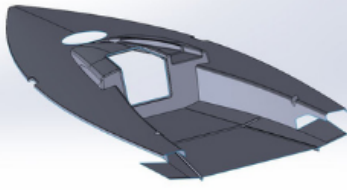

## THE PROCESS

Our 3D|CORE™ ASSEMBLY KITS are not off-the-shelf!

Our knowledge is based on our long-term experience and expertise in producing composite components for various markets. The process is based on your idea and requirements.

**3D|CORE™**  
all around composites

### DRAWING

- Examination of the drawing
- Recommendations
- Improvements

### COORDINATION

- Definition of the parts, costs, weight
- Division of tasks

### ENGINEERING

- Flattening process (3D to 2D)
- Calculations
- Checking the geometry of the cuttings

### PRODUCTION

- Production of the required 3D|CORE™ material
- Provision of needed materials
- Generating of the production drawing
- Optimization of the effective material use
- KIT plan with numbering for easy application
- Generating of the cutting files
- Production of the cuttings (foam and fabrics)

### PACKAGING

- Optimum packaging for a safe transport



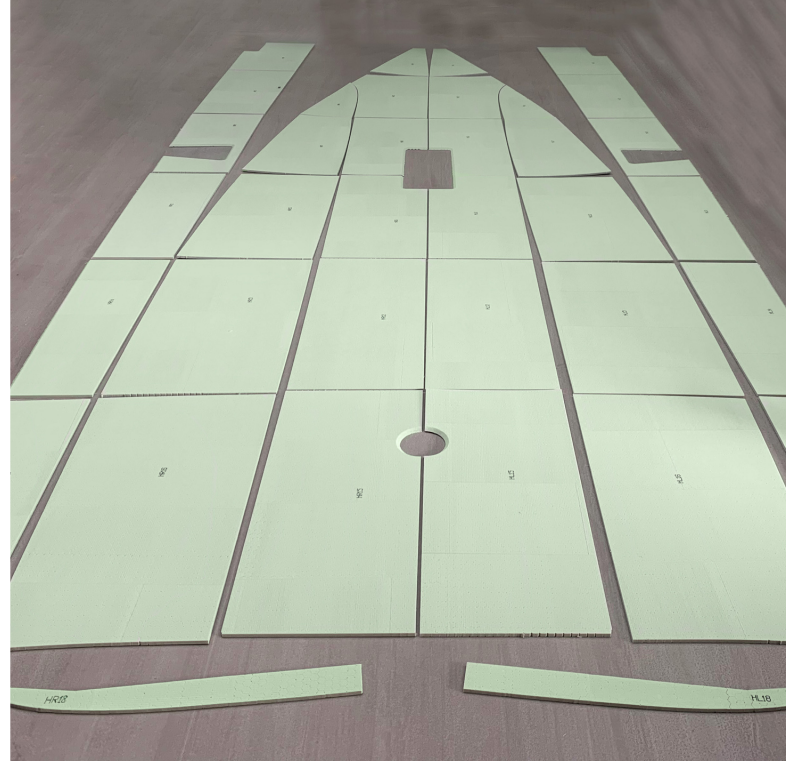

**3D|CORE™**  
all around composites

## MAJOR BENEFITS

### 3D|CORE™ ASSEMBLY KITS

- Optimized foam and fabric cuttings
- Lower storage costs
- Lower freight costs due to the optimized cuts (thus a better CO<sup>2</sup> balance)
- Reduction of waste in the production
- Refined assembly instructions for an effective laying process
- Acceleration of the production process
- Save 2/3 of working time
- Massive savings in labour costs possible
- Easy handling of the 3D|CORE™ ASSEMBLY KITS due to flexible foam cores

**WE WILL FIND THE PERFECT SOLUTION FOR YOU!**



## 3D|CORE™ ASSEMBLY KITS

### MARINE

The shipbuilding industry has to become more environmentally friendly in the near future. In this context, the topic of lightweight construction will be unavoidable. Fuel consumption reduces almost linearly with weight savings for the same length and speed.

Lightweight construction, cost efficiency, safety and environmental friendliness are today's key factors for marine applications.

To combine climate and environmental protection with efficient use of resources, ship resistance must be reduced.

3D|CORE easily solves this challenge by drastically reducing the weight of watercrafts.

With our high-quality 3D|CORE™ ASSEMBLY KITS, you not only get high-strength and lighter components, but also increase your productivity and optimize the profitability of your production.

### AREAS OF APPLICATION

- Deck
- Hull
- Keel
- Frame
- Interior
- Mast & Transom

### FOR

- Sailing boats
- Yachts
- Motorboats
- Cruise ships
- Ferries

# 3D|CORE™

all around composites

**ENGINEERING**

**PROCUREMENT**

**PRODUCTION**

**CERTIFICATION**

**3DICORE GMBH & CO. KG**  
**OSTSTRASSE 74**  
**32051 HERFORD**  
**GERMANY**

**WWW.3D-CORE.COM**  
**PHONE: 0049 5221 93 63 90**  
**E-MAIL: SALES@3D-CORE.COM**

**VISIT US ON:**

