



SEAVIEW

ELEVATE YOUR ELECTRONICS

Fleming Yachts 65.
Seaview Tapered Mast.
Image courtesy of Fleming Yachts.

@seaviewglobal
www.seaviewglobal.com

SEAVIEW

ELEVATE YOUR ELECTRONICS

Seaview is the global leader in designing and manufacturing mounting solutions for marine electronics. Seaview offers hundreds of installation options for optimal positioning of radar, satellite and tv domes, GPS, VHF, camera, searchlights and navigation lights. Seaview mounting solutions will not only provide unmatched strength and durability but look elegant, complementing the styling of your boat.

Working closely with all major electronic manufacturers, we offer an innovative range of high quality products for powerboats, sailboats, yachts, commercial and military vessels. While we offer a comprehensive selection of standard mounts, we also offer personalized mast solutions where the standard mounts may not be suitable. You will find Seaview mounting systems aboard many of the finest yachts around the world.



**MARINE ELECTRONICS ARE ALWAYS EVOLVING,
PLEASE REFER TO OUR MOST CURRENT CATALOG
UPDATES USING THE PROVIDED QR CODE OR GO TO
WWW.SEAVIEWGLOBAL.COM//DOWNLOADS**

Seaview supporting the world's leading marine electronic manufacturers!

See what they have to say on pages 39 and 40!

Intellian

FLIR

LOWRANCE

Raymarine

GARMIN

FURUNO

K|V|H

SIMRAD

SI-TEX

SEAVIEW

TABLE OF CONTENTS

MODULAR MOUNTS

SingleMounts.....	7-8
DualMounts.....	9-10
TopPlates.....	11
Light Bars & Light Bar Tops	12-13
Modular Mount Accessories	14

POWER BOAT MOUNTS

Tapered Masts	15-16
Stainless Steel Mounts	18
Low Profile Satdome Adapters	19-20
Direct Mount Wedges	23

CAMERA & SEARCH LIGHT MOUNTS

Camera & Search Light Mounts	21-22
------------------------------------	-------

SAILBOAT MOUNTS

Mast Mounts	22, 25-26
Pole Mounts	27-28

INSTRUMENT MOUNTS

Sail Instrument Pods	29
Deck Instrument Pods	30
Sail, Deck & Rail Pod Reference Guide	31
Rail Instrument Pods	32

CABLE GLAND

Cable Gland	33-34
-------------------	-------

PERSONALIZED OPTIONS

Personalized Mast Options	35-38
Commercial Masts	39

MANUFACTURER TESTIMONIALS

Manufacturer Testimonials	41-42
---------------------------------	-------

“Seaview worked closely with us to supply a mast with our fairly extensive custom modification requests.”

Gary Johnson
Applied Engineering Manager
Navatek Ltd.



"We rig them to be "dream boats" with every conceivable option and technology. Seaview's flexible line of electronics mounting solutions makes it easy to fit our full system including radar, satellite TV and thermal night vision. Their customizable masts and mounts are rugged, reliable and they look fantastic too. They blend seamlessly with the design of today's modern sport-fishing boats and look totally built-in, not bolt-on. That's really appreciated by the boat builders we work with on these projects too."

Jim McGowan
Americas Marketing Manager
FLIR Maritime and Raymarine

Image courtesy of Raymarine.
(Seaview PMA-DM2-M2 & ADAR1DMLTB shown.)

HERE'S WHY YOU SHOULD CHOOSE SEAVIEW



PERFORMANCE

Seaview mounts will properly elevate your electronics to eliminate interference, safely clear those on board and encourage longevity of the electronics.



DURABLE

Unlike any other mount available, Seaview takes the finish to another level. We Chem-Film (same process used by Boeing) each high grade aluminum part prior to our standard 3 part epoxy prime and powder coat to ensure the best possible finish and corrosion resistance.



MODULAR DESIGN

Simple 3 step system to choose your Seaview mount and accessories. Visit the website for a simple selector guide.

1. Pick Mount Style
2. Select Top Plate
3. Choose Accessories



SPACE SAVING

Compact Seaview mounts help you get all of your marine electronics with one simple solution. Small footprints and one center hole for wiring point of entry.



HIGH QUALITY

Our Robotic Welding provides maximum efficiency while producing consistently superior welds. The Lincoln Fanuc 55E Single Station, AM120iC/12L with 6 axis robotic arm and 2 axis turntable was specifically programmed to weld our Seaview products.

This robot is operated by our very experienced welding team, manufacturing our Seaview products for stock, commercial and military applications including OEM parts.

"Monterey Boats exclusively uses Seaview mounts for all of their sport yachts and enjoys the quality and relationship they have with Seaview."

Mark Owens
Vice President of Design & Engineering
Monterey Boats



5 MODULAR MOUNTS

Image courtesy of Monterey Boats.
(Seaview PMA-57-M1 and LTB-R shown.)

FOR RADARS, THERMAL CAMERAS, SATDOMES & SEARCHLIGHTS

MODULAR MOUNTS

EASY 3 STEP SOLUTION

STEP 1 REQUIRED

Choose Mount Style & Height
Pages 7 - 10



STEP 2 REQUIRED

Select Modular Top Plate
Page 11



STEP 3 OPTIONAL

Pick Optional Accessories
Page 12 - 14



STEP 1 CHOOSE A MODULAR MOUNT

FORWARD LEANING



Fits  

- 18" - 25" closed dome radars
- 16" diameter or smaller satdomes
- 10" tall mounts are not to be used with open array radars

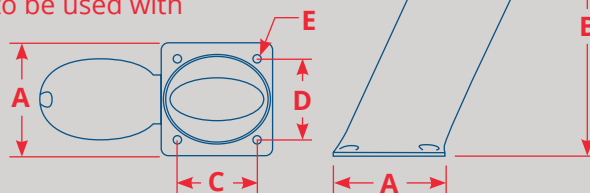

Model #	A inch /mm	B inch /mm	C & D inch /mm	E inch /mm
PMF-57-M1	7 / 177.8	5 / 127	5 / 127	.5 / 12.7
PMF-107-M1	7 / 177.8	10 / 254	5 / 127	.5 / 12.7

AFT LEANING



Fits  

- 18" - 25" closed dome radars
- 16" diameter or smaller satdomes
- 10" - 36" tall mounts are not to be used with open array radars

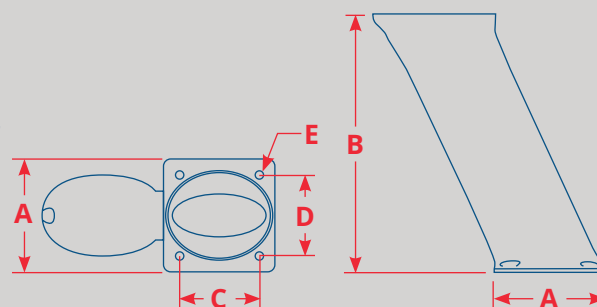

Model #	A inch /mm	B inch /mm	C & D inch /mm	E inch /mm
PMA-57-M1 (WHITE)	7 / 177.8	5 / 127	5 / 127	.5 / 12.7
PMA-57-M1BLK (BLACK)	7 / 177.8	5 / 127	5 / 127	.5 / 12.7
PMA-107-M1	7 / 177.8	10 / 254	5 / 127	.5 / 12.7
PMA-167-M1	7 / 177.8	16 / 406.4	5 / 127	.5 / 12.7
PMA-247-M1	7 / 177.8	24 / 609.6	5 / 127	.5 / 12.7
PMA-367-M1	8 / 203.2	36 / 914.4	6.5 / 165.1	.5 / 12.7

VERTICAL



Fits  

- 18" - 25" closed dome radars
- 24" diameter or smaller satdomes
- Not to be used with open array radars

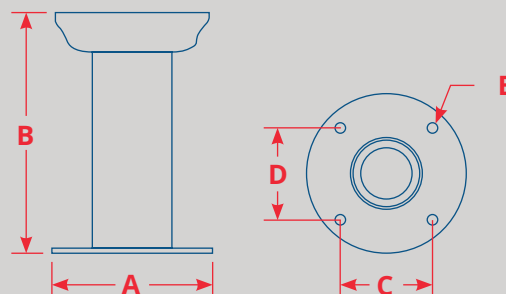

Model #	A inch /mm	B inch /mm	C & D inch /mm	E inch /mm
AM5-M1	8 / 203.2	5 / 127	4.77 / 121.2	0.5 / 12.7
AM12-M1	8 / 203.2	12 / 304.8	4.77 / 121.2	0.5 / 12.7
AM18-M1	8 / 203.2	18 / 457.2	4.77 / 121.2	0.5 / 12.7

OPEN ARRAY & LG SATDOME MOUNTS



- Fits
- 16" - 24" diameter satdomes
 - Available in Aft leaning
 - Up to 6' Open Array Radar

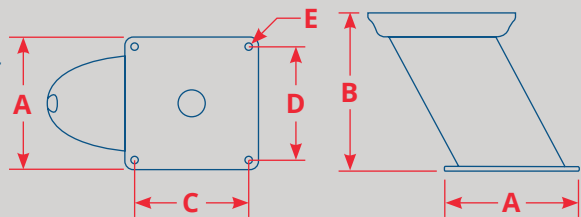

Model #	A inch /mm	B inch /mm	C & D inch /mm	E inch /mm
PMA-57-M1	7 / 177.8	5 / 127	5 / 127	0.5 / 12.7
PMF-57-M1 (FWD Leaning)	7 / 177.8	5 / 127	5 / 127	0.5 / 12.7
PMA-1210-M2	10 / 254	12 / 304.8	8.5 / 215.9	0.5 / 12.7
PMA-1810-M2	10 / 254	18 / 457.2	8.5 / 215.9	0.5 / 12.7



“Seaview removes the engineering and fabrication headaches associated with mounting marine electronics while providing extremely high quality, great looking products.”

Travis Duffield
Vice President
Duffield Yachts

Duffield 58.
Image courtesy of Duffield Yachts.
(Seaview PMADM2M2, ADAS2, LTBSF & LTBP1197 shown)

STEP 1

CHOOSE A MODULAR MOUNT

PMA-DM1-M2 (WHITE) PMA-DM1-M2BLK (BLACK)



- Fits
- 18" - 25" closed dome radars
 - 16" - 24" satdomes
 - Cameras
 - Spotlights

Comes with Seaview Cable Gland for water tight radar cable entry into the mast.

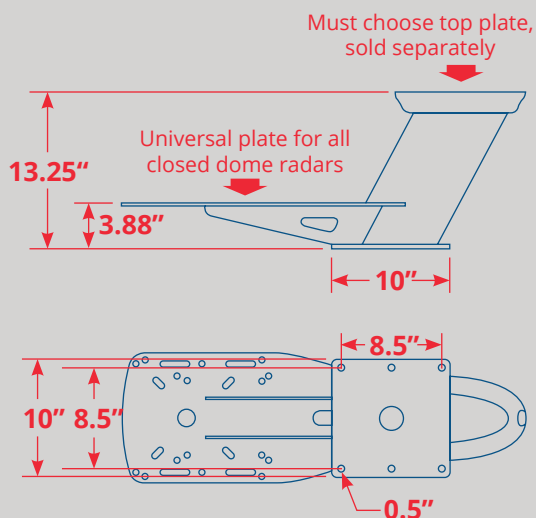

PMA-DM124-M2



- Fits
- 18" - 25" closed dome radars
 - 16" - 18" satdomes
 - Cameras
 - Spotlights

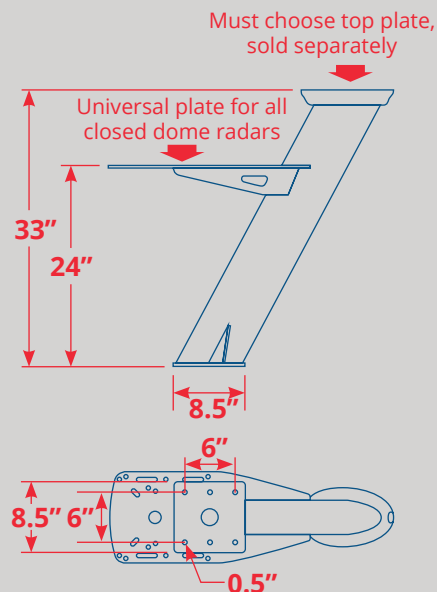

PMA-DM2-M2 (WHITE) PMA-DM2-M2BLK (BLACK)



- Fits
- Up to 4.5' open array radars
 - 16" - 24" satdomes
 - Cameras
 - Spotlights

Comes with Seaview Cable Gland for water tight radar cable entry into the mast.

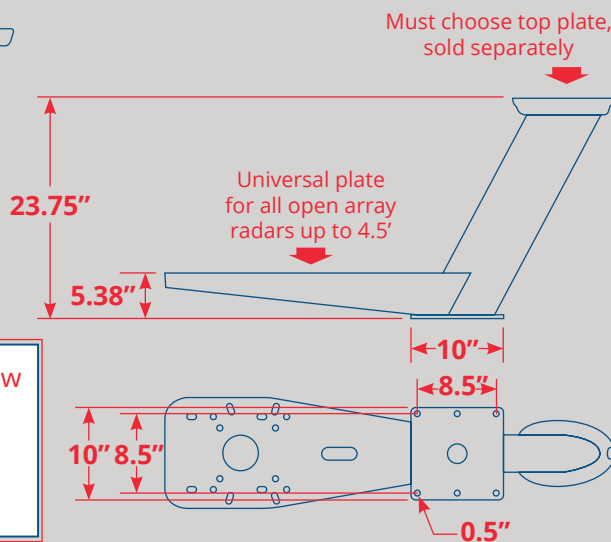

PMA-DM3-M1 (WHITE) PMA-DM3-M1BLK (BLACK)



- Fits
- Up to 4.5' open array radars
 - 16" - 18" satdomes

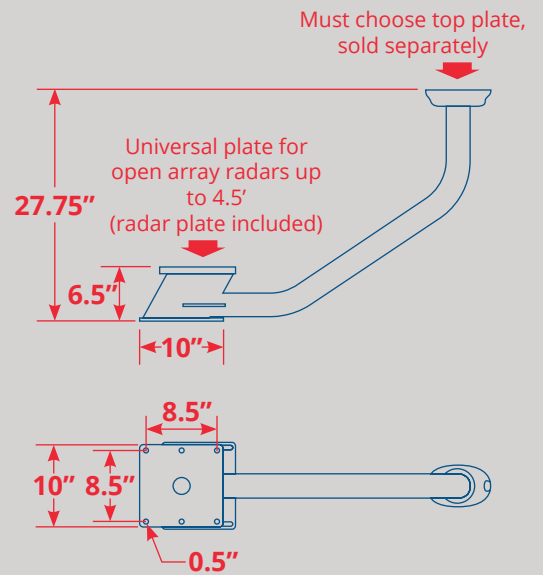

PMA-DM4-M1



- Fits
- 18" - 25" closed dome radars
 - 16" - 24" satdomes
 - Cameras
 - Spotlights

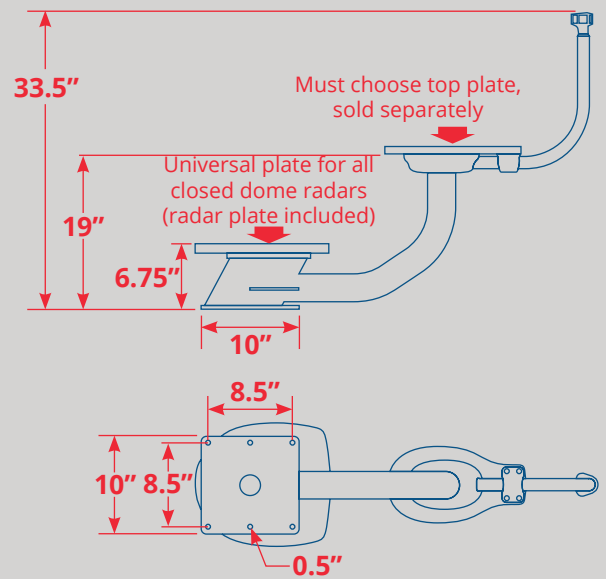

Key
1" = 25.4mm

SOUTHPORT 33DC.
Image courtesy of Southport Boats.
(Seaview PMADM1M2, ADAS1, SP2MOD & LTBS shown)

MODULAR MOUNTS 10

STEP 2

SELECT A TOP PLATE

NOTE: If you have selected a modular mount ending in “M1” use the M1 column below. Mounts ending in “M2” use M2 column.

M1 fits modular mounts ending in M1. Example: PMA-57-M1

M2 fits modular mounts ending in M2. Example: PMA-DM1-M2

M1

M2

Light Bar

ACR

RCL50B, RCL75, RCL85, RCL95, RCL100, RCL1000	ADA-BLANK	ADA-BLANK	LTB13
RCL300	CALL	CALL	CALL

COMNAV

Explorer V2/V3	ADA-F1	ADA-F1	LTB-S
----------------	--------	--------	-------

FLIR

MD324, MD625, M324XP, M324L, M324S, M324CS, M625XP, M625L, M625S, M625CS, M612L, M617CS, M618CS, T200, T300, T400	ADA-F1	ADA-F1	LTB13
M132, M232 Series (Hiko)	ADA-F2	ADA-F2	LTB13
M300C, M332, M364, M364C and M364C LR	ADA-F3	ADA-F3	LTB-S

FURUNO

SC30, SC703, SC1303, DRS4DL, DRS4D, DRS4D-NXT	ADA-R1	ADAR1DMLTB	LTB-R
DRS6A-NXT	ADA-R1	ADAR1DMLTB	LTB-OA or LTB-OA-6
Open array radar 1942	ADA-R2	ADAR1DMLTB	LTB-OA

GARMIN

FANTOM18, GMR18(HD), GMR18x(HD)	ADA-R1	ADAR1DMLTB	LTB-R
FANTOM24, GMR24(HD), GMR24x(HD)	ADA-R1	ADAR1DMLTB	LTB-R
Fantom, 4'-6' open array radar	ADA-R1	ADAR1DMLTB	LTB-OA or LTB-OA-6

GLOMEX

20" - 27" Satdome	ADA-S1	ADA-S2	LTB-S24
Pandora	ADA-S3	ADA-S3	LTB-S

HUMMINBIRD

HB2124 Chirp Radar	ADA-R1	ADAR1DMLTB	LTB-R
RH44, RH45 4' - 6' open array radar	ADA-R1	ADAR1DMLTB	LTB-OA or LTB-OA-6

INTELLIAN

i2 (FB150 in i2 matching dome)	ADA-S1	ADA-S3	LTB-S
i3 (FB150 in i3 matching dome)	ADA-S1	ADA-S1	LTB-S
i4, i4P (FB150 in i4 matching dome)	ADA-S2	ADA-S2	LTB-S
i5	ADA-S2	ADA-S2	LTB-S24
i6, i6P, S6HD, FB500	ADA-S2	ADA-S2	LTB-S24
FB150, FB250	ADA-S4	ADA-S4	LTB-S

JRC

15" radar domes	ADA-R1	ADAR1DMLTB	LTB-R
24" radar domes	ADA-R2	ADAR1DMLTB	LTB-R

KODEN

18" - 25" radar domes	ADA-R1	ADAR1DMLTB	LTB-R
4' - 6' open array radar	ADA-R1	ADAR1DMLTB	LTB-OA or LTB-OA-6

KVH

M1DX, M1, TV1, LTE-1	ADA-S1	ADA-S3	LTB-S
M2, M3, M3DX, M3ST, V3, V3-IP, TV3, V3-HTS	ADA-S1	ADA-S1	LTB-S
M5, TV5, FB250 (18")	ADA-S2	ADA-S2	LTB-S
M7, M7SK, HD7, V7, TV6, FB500(26"), F55, V3-IP(24")	ADA-S2	ADA-S2	LTB-S24
V7-IP, V3-HTS (24") 8.49"x8.49" bolt pattern	CALL	CALL	CALL
FB150(10.8"), FB250(14"), Fleet One, Fleet33	ADA-S4	ADA-S4	LTB-S

The list of top plates below are all available in black.

*ADA-R1BLK

*ADA-S1BLK

*ADA-S2BLK

*ADA-F1BLK

*ADA-F2BLK

(any others available in black upon request)

	M1	M2	Light Bar
--	----	----	-----------

LOWRANCE

3G, 4G radar domes	ADA-R1	ADAR1DMLTB	LTB-R
--------------------	--------	------------	-------

LORENZ

12" - 24" radar domes	ADA-R1	ADAR1DMLTB	LTB-R
4' - 6' open array radar	ADA-R1	ADAR1DMLTB	LTB-OA or LTB-OA-6

RAYMARINE

RD418D, RD418HD, RD424D, RD424HD, Quantum, Quantum 2	ADA-R1	ADAR1DMLTB	LTB-R
RA1048(S)HD, RA3048(S)HD, Magnum 4'	ADA-R1	CALL	LTB-OA
RA1072(S)HD, RA3072(S)HD, Magnum 6'	ADA-R1	CALL	LTB-OA-6
33STV	ADA-S1	ADA-S3	LTB-S
37STV	ADA-S1	ADA-S1	LTB-S
45STV	ADA-S2	ADA-S2	LTB-S
60STV	ADA-S2	ADA-S2	LTB-S24

SEA-TEL (COBHAM)

ST14, FX150 (16.5")	ADA-S2	ADA-S2	LTB-S24
C18, FX250 (24")	ADA-S2	ADA-S2	LTB-S24

SIMRAD

3G, 4G, HALO20(+), HALO24	ADA-R1	ADAR1DMLTB	LTB-R
DX64S	ADA-R2	N/A	LTB-R
TX06S	ADA-R1	ADAR1DMLTB	LTB-OA
TX10S	ADA-R1	ADAR1DMLTB	LTB-OA6
4' - 6' Halo™ open array radar	ADA-R1 + ADA-HALO-3	N/A	LTB-OA or LTB-OA-6
4' - 6' RB series open array radar	ADA-R1	ADAR1DMLTB	LTB-OA or LTB-OA6

SITEX

18" (T760/T921) radar domes	ADA-R1	ADAR1DMLTB	LTB-R
24" (MDS12) radar	ADA-R1	ADAR1DMLTB	LTB-R
24" (T761) radar domes	ADA-R2	N/A	LTB-R
25" radar domes	ADA-R1	ADAR1DMLTB	LTB-R
4'-6' open array radar	ADA-R1	ADAR1DMLTB	LTB-OA or LTB-OA-6

THRANE & THRANE

FB150, FB250, Fleet 33, 33+	ADA-S4	ADA-S4	LTB-S
Sailor FB500, Fleet 55+	ADA-S1	ADA-S3	LTB-S24

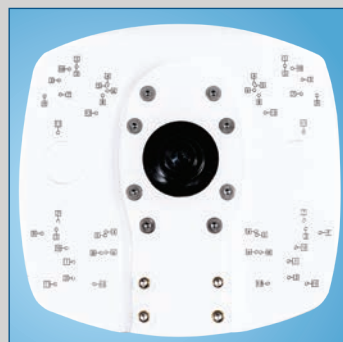

Seaview Top Plates now come with the drill template stamped on the top plate to make for very easy installation (no more lose drill template)!

11 TOP PLATES

STEP 3

CHOOSE OPTIONAL ACCESSORIES

LIGHT BARS



LTB-R (WHITE)
LTB-RBLK (BLACK)

For 18" - 24" closed dome radars.
This light bar can fold over 90°.



LTB-S (WHITE)
LTB-SBLK (BLACK)

For 20" or smaller satdomes. This
light bar can fold over 90°.

LTB-S24 (WHITE)
LTB-S24BLK (BLACK)

For 26" or smaller satdomes. This
light bar can fold over 90°.



LTB-OA (WHITE)
LTB-OABLK (BLACK)

For open array radars up to 4½'.

LTB-OA-6

For 6' open array radars.



LTB-SF

A 2" diameter Light Bar designed
to work with search lights. Contact
Seaview directly to make sure this
light bar is right for your boat. Not
intended for fast ocean going boats.
Will not work with 24" satdomes.
This will clear 20" satdomes or
smaller.

LTB-SF2

A 2" diameter Light Bar designed to
work with FLIR M100/M200
Series. Contact Seaview directly to
make sure this light bar is right for
your boat. Not intended for fast
ocean going boats. **Will not work
with 24" satdomes.** This will clear
20" satdomes or smaller.

LTB13

A 1.25" Light Bar 14" tall for FLIR
cameras and Searchlights. Can fold
over 90°.



Note that Light Bars do not
come with a light. Select a
Light Bar top for your Light
Bar on page 13.

LTB90

Bolt on kit that allows you to quickly
fold over the Light Bar without any
tools.

**This kit will only work with Seaview
AFT leaning mounts and top plates
ADAR1, ADAS1 & ADAS2. Contact
Seaview if this is needed for
another application.**



STEP 3

CHOOSE OPTIONAL ACCESSORIES

LIGHT BAR TOPS



LTBP-1197

Perko 1197 Incandescent Combination Masthead / White All-Round Light with 7' of wire (12v). Can be converted to 24v with Perko Bulb 0072001CLR.



LTBP-1697

Perko 1697 LED Combination Masthead / White All-Round Light with 7' of wire (12v).



LTB-BOX

(4"x4½") Black Box Top to fit three navigation lights or similar. Note that this does not come with lights.



LTB-BOX-W

(4"x4½") White Box Top to fit three navigation lights or similar. Note that this does not come with lights.



LTB-U1A

(2½"x7") Allows you to mount a single light or a GPS and a light. Lights and GPS not included.



PM-U2A

Allows you to mount a single light and two GPS units. Light and GPS not included.



LTB-U

Adapter to mount a GPS or wind transducer. The threads are 1-14.



LTB-U-SS

Stainless steel adapter to mount a GPS or wind transducer. The threads are 1-14.



LTBU1A1697

Perko 1697 LED nav light on a 12.75" post with 7' of wire (12v). USCG approved for boats up to 20 meters (65.6') in length. 1-14 threads for GPS or similar.



LTBU1A1197

Perko 1197 incandescent nav light on a 12.75" post with 7' of wire (12v). USCG approved for boats up to 20 meters (65.6') in length. 1-14 threads for GPS or similar.

13 LIGHT BAR TOPS

LIGHT BAR ACCESSORIES



PM-114LT-LED

LED Floodlight kit (9-33v). For Seaview 1¼" diameter light bars. Includes 1¼" stainless steel clamp, mounting hardware & Hella 0670 Sea Hawk LED Floodlight.

STEP 3

CHOOSE OPTIONAL ACCESSORIES

SPREADER KITS



SP1-MOD

Fits all Seaview mounts that end in "M1". For example PMA-57-M1.

SP2-MOD

Fits all Seaview mounts that end in "M2". For example PMA-DM2-M2.

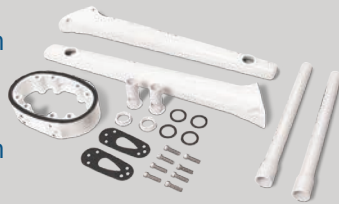

SPREADER KIT ACCESSORIES

SP-LT-LED Enhance your visibility with a Seaview spreader LED floodlight kit. This kit includes stainless steel bracket, mounting hardware & Hella 0670 Sea Hawk LED Floodlight. (9-33v)

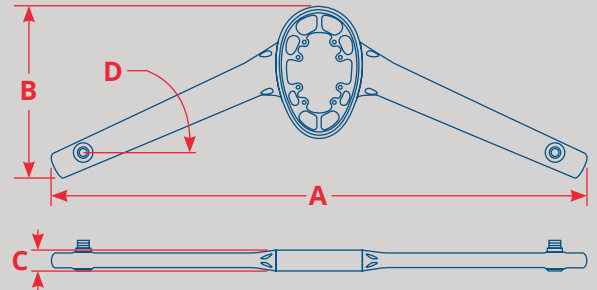

Part #	A inch / mm	B inch / mm	C inch / mm	D
SP1-MOD	42.4 / 1077	12.625 / 320.67	1.75 / 44.45	25°
SP2-MOD	44.5 / 1130.3	14.282 / 362.76	1.75 / 44.45	25°



Do **NOT** use 4' or taller fiberglass antennas on nylon or plastic adapters! 4' or smaller stainless steel whip antennas ok. If you need to mount 4' or taller fiberglass antennas you must use this stainless steel 1-14 threaded insert. (Sold separately, part **#SP7-SS**)

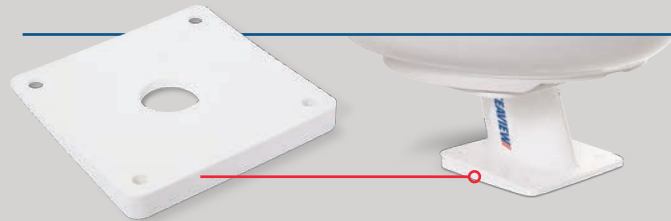

BASE WEDGES

Most common planing attitude requires 3-4° of adjustment. If you are unsure which to choose then we recommend the 4° wedge. We do however offer 2° & 6° wedges if you feel a little more or a little less is better for your application.



Part #	Angle of Wedge	A inch / mm	B inch / mm	C inch / mm
PM-W2-7	2°	7 / 177.80	0.37 / 9.37	0.125 / 3.18
PM-W4-7	4°	7 / 177.80	0.61 / 15.6	0.125 / 3.18
PM-W6-7	6°	7 / 177.80	0.86 / 21.87	0.125 / 3.18
PM-W4-8	4°	8 / 203.20	0.68 / 17.37	0.191 / 4.84
PM-W4-10	4°	10 / 254	0.95 / 24.13	0.25 / 6.35



HINGE ADAPTERS

Captive knobs means these will stay with the hinge when it's open or closed.



The hinge adapter can hinge back 180°. Allowing you to have the most clearance possible.

Part #	Description
PM-H7	For 7"x7" base plate. Fits 5" - 24" tall radar mounts.
PM-H8	For 8"x8" base plate. Fits 36" tall radar mounts.
PM-H10	For 10"x10" base plate. Not to be used for PMA-DM2-M2 or PMA-200 series mounts.

TAPERED MASTS

FOR MOST CLOSED & OPEN ARRAY RADARS

Removeable Spreaders

All Seaview Tapered Masts feature removeable spreaders for easier shipping. Standard 1-14 threaded fittings are used on the spreaders and are made out of nylon to eliminate corrosion.

For Just About Any Radar

Three different models are available to fit just about any marine electronic combination.

High Visibility

Mounting plate for lights on all Seaview Tapered Masts. Example shown on PMA-200 image.

If you plan to use 4' or taller antennas on the spreaders you should use a stainless steel adapter (**SP7-SS**) shown below.

PMA-100S and PMA-BC-37S come with Seaview Cable Gland for water tight radar cable entry into the mast.



PMA-100S

Mounting plate will accept most standard 18" and 24" radar domes.



PMA-BC-37S

Mounting plate will accept most standard 18" and 24" radar domes. Features a welded platform for cameras or search lights.



PMA-200

Mounting plate will accept most open array radars up to 4 1/2 feet. Comes with a 10"x10" backing plate.



Do **NOT** use 4' or taller fiberglass antennas on nylon or plastic adapters! 4' or smaller stainless steel whip antennas ok. If you need to mount 4' or taller fiberglass antennas you must use this stainless steel 1-14 threaded insert. (Sold separately, part #**SP7-SS**)



PMA-BC-37S pictured above.

DIMENSIONS

Key
1" = 25.4mm

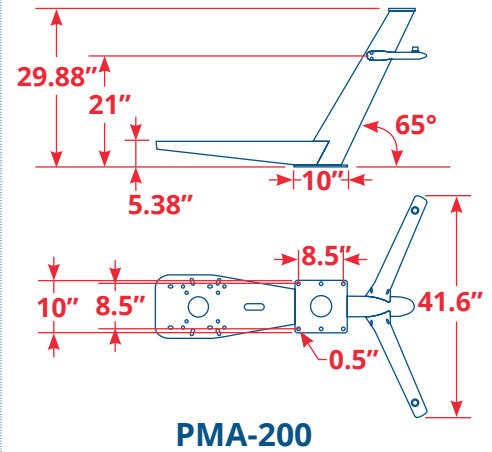
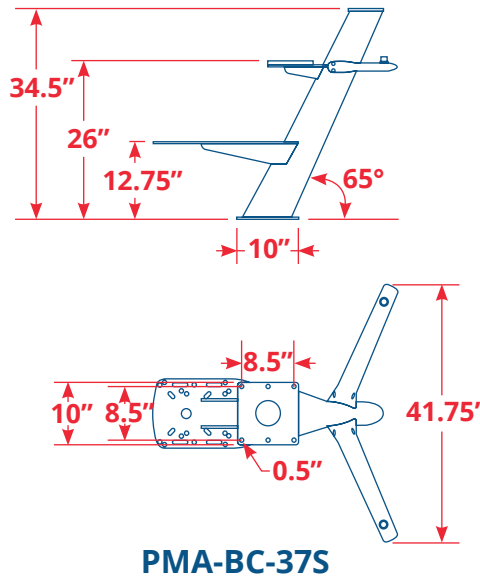
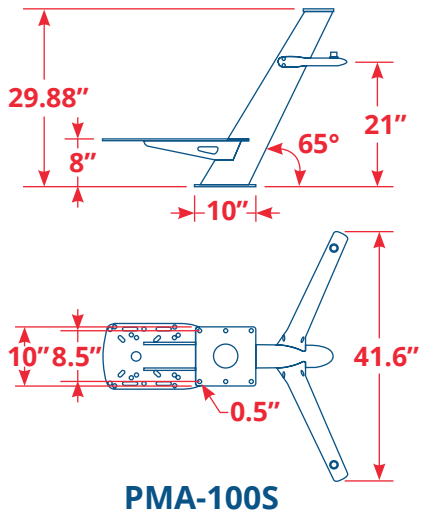

"Back Cove Yachts offers 5 different models and produces 60+ boats per year. We require parts and materials to be delivered on a schedule and be of excellent quality. We have been able to rely on Seaview to deliver the parts we need, when we need them and maintain the quality levels we expect. Seaview has remained a significant source in our supply chain. In part because of the reasons mentioned above, but also due to outstanding customer service and engineering support. We look forward to continuing an exceptional partnership for years to come."

Keith Warren
Engineering Manager
Back Cove Yachts



Image courtesy of Back Cove Yachts
(Seaview PMA-BC-37S mast shown.)

"Afina 3950 by Floe International uses Seaview mounts exclusively. The sport yacht seamless appearance, rugged quality and ease of installation are appreciated."

Steve Gillman
Product Development Manager
FLOE Craft



STAINLESS STEEL MOUNTS

FOR MOST CLOSED DOME & OPEN ARRAY RADARS

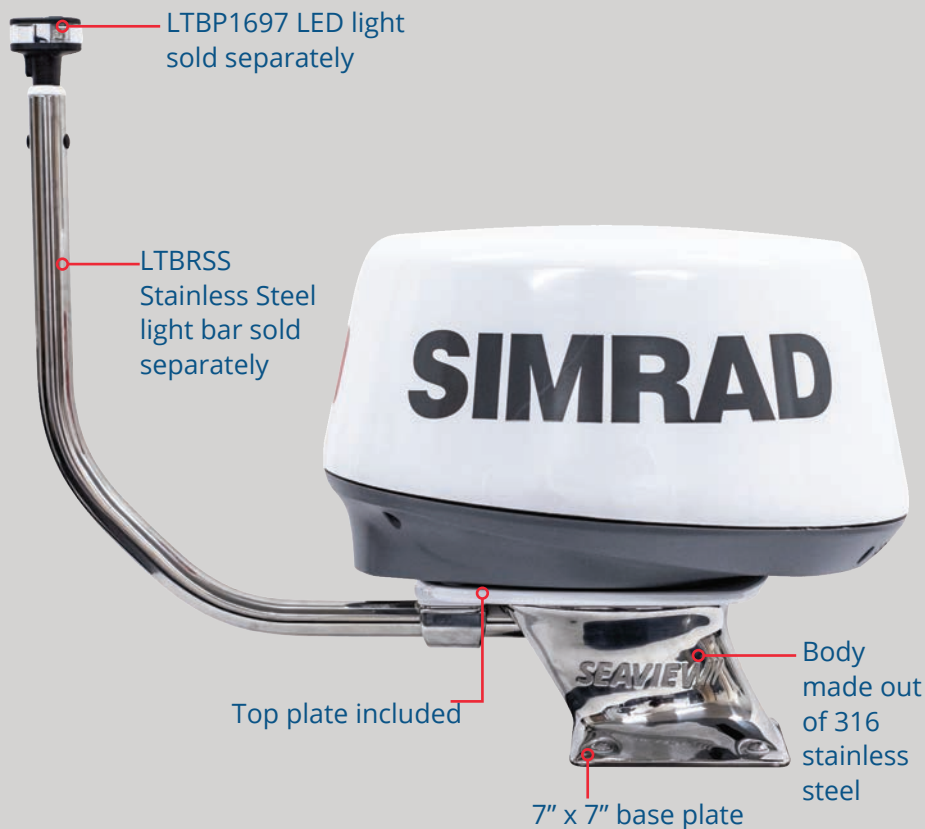

STAINLESS STEEL LIGHT BARS



LTBRSS

Polished 316 Stainless Steel 1 1/4" light bar for closed dome radar. Comes with S.S. saddle assembly to properly secure to the PMA57LSS radar mount. Must choose a light bar top from page 13.

PART NUMBER GUIDE

FURUNO

15" - 24" radar domes	PMA57LSS
4' - 6' open array radars	PMA57LSS

GARMIN

18" - 24" radar domes	PMA57LSS
Fantom, 4' - 6' open array radars	PMA57LSS

HUMMINBIRD

HB2124 Chirp Radar	PMA57LSS
4' - 6' open array radars	PMA57LSS

JRC

15" radar domes	PMA57LSS
-----------------	----------

KODEN

18" - 25" radar domes	PMA57LSS
4' - 6' open array radars	PMA57LSS

LOWRANCE

3G, 4G, HALO20(+), HALO24	PMA57LSS
---------------------------	----------

LORENZ

12" - 24" radar domes	PMA57LSS
4' - 6' open array radars	PMA57LSS

RAYMARINE

18" - 24" Radomes	PMA57LSS
Quantum, Quantum 2 radar	PMA57LSS
4' - 6' open array radars	PMA57LSS

SIMRAD

3G, 4G, HALO20(+), HALO24	PMA57LSS
TX06S, TX10S	PMA57LSS
4' Halo™ open array radar	PMA57LSS + ADAHALO3
4' - 6' RB Series open array radars	PMA57LSS

SITEX

18" - 25" radar domes	PMA57LSS
4' - 6' open array radars	PMA57LSS

DIMENSIONS

Part #	A inch /mm	B inch /mm	C inch /mm	D Degrees	E inch /mm
PMA57LSS	7 / 177.8	5.91 / 150	5 / 127	80°	0.25 / 6.35

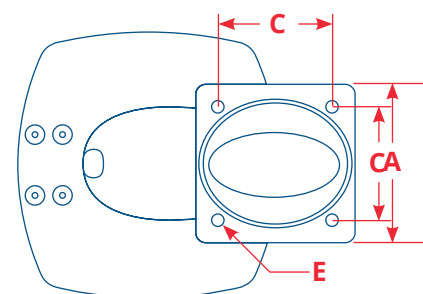
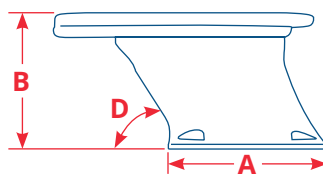

LOW PROFILE ADAPTERS

FOR MOST SATDOMES



AMA16

UV stable white ABS plastic

Marine grade aluminum



AMAGXF

OPTIMIZE YOUR SATELLITE DOME INSTALLATION

The Seaview Low Profile Adapters will reduce the footprint of your satdome. Add an AMA-W wedge to your installation to level your satdome when installing on sloped surfaces.

- The AMA18, AMA18IP & AMA24 are made with ABS plastic with an internal anodized aluminum plate for superior strength
- The AMAGXF is made of powder coated marine grade aluminum
- Small mounting base for space limited installations
- Hides cables

ACCESSORY | AMA-W



By rotating the AMA-W wedge halves you can achieve 0° - 12° of adjustment. The AMA-W wedge works with AMA-16, AMA-18, AMA18IP, AMA-24 and AMA-GXF only.

DIMENSIONS

Part #	A inch /mm	B inch /mm	C inch /mm
AMA-14	8 / 203.2	4.75 / 120.6	3.35 / 85.09
AMA-16	12 / 304.8	8 / 203.2	2.75 / 69.85
AMA-18	14.25 / 362	8 / 203.2	2.65 / 67.31
AMA-18IP	14.25 / 362	8 / 203.2	3 / 76.2
AMA-24	19 / 482.6	8 / 203.2	2.70 / 68.58
AMA-GXF	12 / 304.8	8 / 203.2	3 / 76.20

AMA-14 / AMA-16 / AMA-18 / AMA-18IP / AMA-24

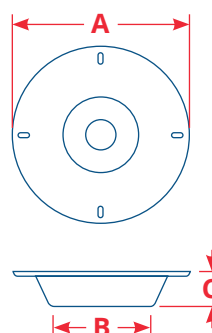

AMA-GXF

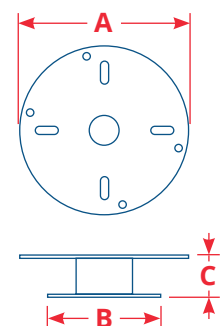

LOW PROFILE SATDOME PART # GUIDE

Find your satdome below to find the correct Low Profile mount part number. If you do not see your satdome below please give us a call.

GLOMEX	
Pandora, 20" - 27" satdomes	AMA-GXF
INTELLIAN	
i2	AMA-GXF
i3	AMA-16
i4, i4P, i5	AMA-18
i6, i6P, S6HD, FB500	AMA-24
i9, S80hd	Contact Seaview
FB150, FB250	AMA-14
KVH	
M1, M1DX, TV1, LTE-1	AMA-GXF
M2, M3, M3DX, M3ST, V3, V3-IP, TV3	AMA-16
M5, TV5, FB250(18")	AMA-18
M7, M7SK, HD7, TV6, V7, FB500 (26"), F55	AMA-24
V3-IP (24"), TV7-IP, V7HTS	AMA-18IP
TV8, HD11, FB500 (35"), F77	Contact Seaview
FB150 (10.8"), FB250 (11"), Fleet 33, Fleet One	AMA-14

RAYMARINE	
33STV	AMA-GXF
37STV	AMA-16
45STV	AMA-18
60STV	AMA-24
SEA TEL / COBHAM	
ST14, FX150 (16.5")	AMA-18
C18, FX250 (24")	AMA-18
THRANE & THRANE	
FB150, FB250, Fleet 33, Fleet 33+	AMA-14
SAILOR FB500, Fleet 55+	AMA-GXF

Aluminum insert shown inside the AMA-24. The AMA-18 and AMA-18IP are also reinforced with the aluminum insert. This provides superior strength and durability.



"Intellian is happy to work with Seaview to provide our customers with a professional, stylish and cost effective mounting solution for the complete range of Satellite TV and Communication products."

Paul Comyns
VP Global Marketing
Intellian



CAMERA & SEARCH LIGHT MOUNTS

VERTICAL MOUNTS



PM5FMH8



PM5FM38

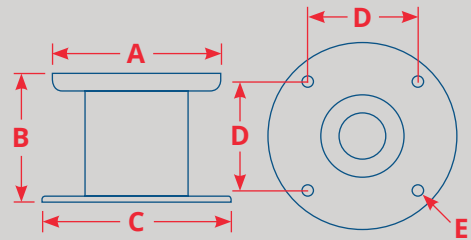

	CAMERA				SEARCH LIGHT
	PM5-FMT-8 inch /mm	PM5-FMD-8 inch /mm	PM5-FMH-8 inch /mm	PM5FM38 inch /mm	PM5-SL-8 inch /mm
A	7.12 / 182.6	6 / 152.4	7.75 / 196.9	10.75 / 273.05	7.6 / 193
B	5.63 / 143	5.63 / 143	5.75 / 146	5.75 / 146.05	6.38 / 162
C	8 / 203.2	8 / 203.2	8 / 203.2	8 / 203.2	8 / 203.2
D	4.77 / 121.2	4.77 / 121.2	4.77 / 121.2	4.77 / 121.2	4.77 / 121.2
E	0.5 / 12.7	0.5 / 12.7	0.5 / 12.7	0.5 / 12.7	0.5 / 12.7

AFT LEANING MOUNTS



PMA5FMT7



PMA12FSL7

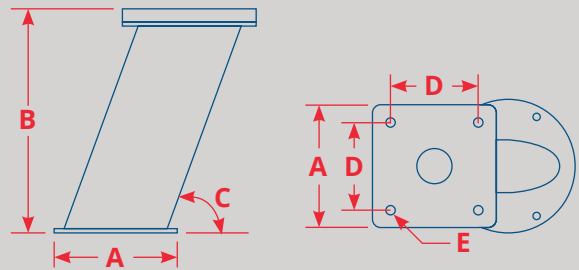

	A inch /mm	B inch /mm	C inch /mm	D inch /mm	E inch /mm
CAMERAS					
PMA-5FMT-7	7 / 178	5.25 / 140	70°	5 / 127	0.5 / 12.7
PMA-5FM3-7	7 / 178	5.5 / 139.7	70°	5 / 127	0.5 / 12.7
PMA-12FMT-7	7 / 178	12.75 / 323.85	70°	5 / 127	0.5 / 12.7
PMA-12FM3-7	7 / 178	12.5 / 317.5	70°	5 / 127	0.5 / 12.7
SEARCH LIGHTS					
PMA-5FSL-7	7 / 178	5.25 / 140	70°	5 / 127	0.5 / 12.7
PMA-12FSL-7	7 / 178	12.75 / 323.85	70°	5 / 127	0.5 / 12.7

DUAL MOUNT

* PMA-DM4-M1 also available, refer to page 10.

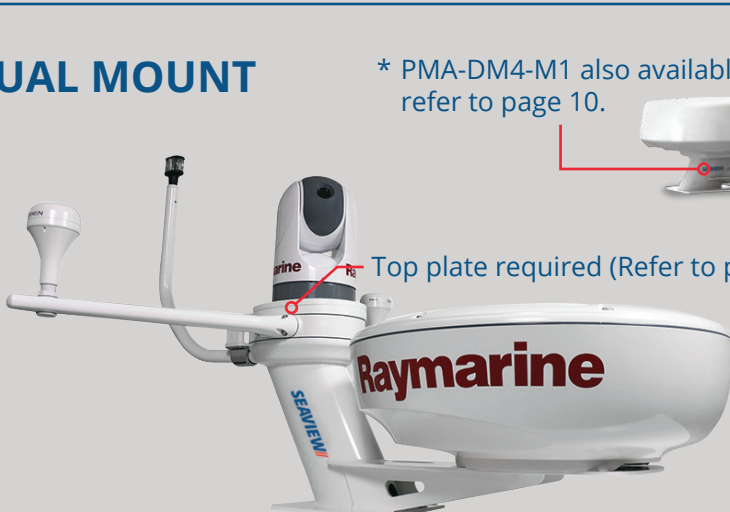

Top plate required (Refer to page 11).

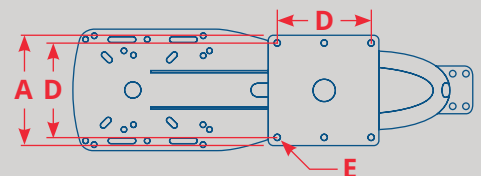
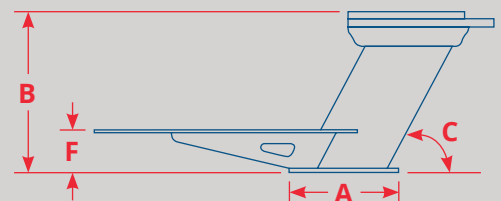

	A inch /mm	B inch /mm	C inch /mm	D inch /mm	E inch /mm	F inch /mm
PMA-DM1-M2	10 / 254	14.5 / 368.3	62°	8.5 / 216	0.5 / 12.7	3.88 / 98.43

TOP DOWN RISER

Designed in cooperation with FLIR / Raymarine engineers. Tested and approved by FLIR / Raymarine as recommended mounting for their night vision cameras.

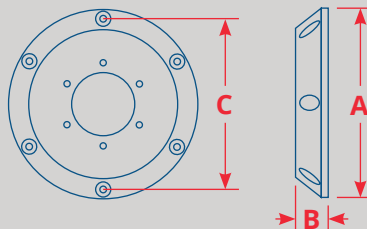

	CAMERAS		
	FTDR2	FTDR3	FTDR4
	inch / mm	inch / mm	inch / mm
A	8.86 / 225	7.75 / 196.85	12.75 / 323.85
B	2 / 50.8	1.5 / 38	2.4 / 60.96
C	8 / 203	7 / 177.8	11.75 / 298.45



The **FTDR-2**, **FTDR-3** and **FTDR-4** mounts allow you to mount FLIR or Raymarine thermal cameras upside down or vertically.

MAST MOUNT

SM14F
SM14F2
SM14F3

Key
1" = 25.4mm



A **SM-14-F** mast mount for thermal cameras.

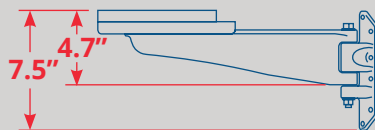
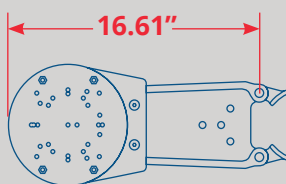

RAIL MOUNT

RM-GOL-1



A **RM-GOL-1** rail mount for search lights. Fits rails 3/4" to 1 1/4" in diameter.

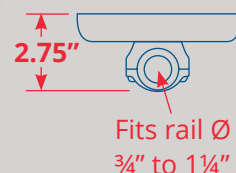
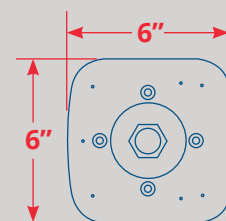

CAMERA & SEARCH LIGHT MOUNT PART # GUIDE

Part #	CAMERA								SEARCH LIGHT							
	FLIR				NVTI	COMNAV	VEI	ACR				GOLIGHT	JABSCO			
	MD324, MD625	M132, M232 (Hiko)	M324S, M324L, M324CS, M324XP, M625S, M625L, M625CS, M625XP, M612L, M617CS, M618CS	M300C, M332, M364, M364C, M364CLR	M400, M400XR, M500	NV2020, NV1018, NV1020	EXPLORER V2, V3	APOLLO II, II HD	RCL50, RCL100	RCL75	RCL85	RCL95	RCL300	ALL MODELS	ALL MODELS	
FTDR2			.													
FTDR3	.															
FTDR4					.											
PM5-FMT-8			.				.									
PM5-FMD-8	.															
PM5-FMH-8		.														
PM5-FM3-8				.												
PM5-SL-8						
PM5-SL-85											.					
PM5-SL-95												.				
PMA-5FMH-7		.														
PMA-12FMH-7		.														
PMA-5FM3-7				.												
PMA-12FM3-7				.												
PMA-5FMT-7	.		.				.									
PMA-12FMT-7	.		.				.									
PMA-5FSL-7						
PMA-12FSL-7						
RM-GOL-1														.		
PMA-DM1-M2*		
SM-14-F	.		.													
SM-14-F2		.														
SM-14-F3				.												

* Top plate required

DIRECT MOUNT WEDGES

OPTIMIZES RADAR BEAM



4° direct mount radar wedge



3-4° is most commonly need to compensate for planing attitude. This is why Seaview only offers the 4° direct mount wedge. We can provide custom wedges upon request.

DIRECT MOUNT ANGLED WEDGES PART # GUIDE

B&G

3G, 4G, HALO20(+), HALO24 **RW4-2**

FURUNO

DRS4DL, 15" - 20" radar domes **RW4-1**

DRS4D, DRS4DNXT, 24" radar domes **RW4-6**

DRS6A-NXT, 4' - 6' open array radars **RW4-3**

GARMIN

Fantom18, Fantom24, GMR18(HD), **RW4-2**

GMR18x(HD), GMR24(HD), GMR24x(HD)

Fantom 4 & 6, 4' - 6' open array radars **RW4-3**

HUMMINBIRD

HB2124 Chirp Radar **RW4-2**

RH44, RH45 4' - 6' open array radars **RW4-5**

JRC

15" radar domes **RW4-6**

24" radar domes **RW4-5**

4' - 6' open array radars **RW4-5**

KODEN

18" (MDC 900 series) radar domes **RW4-1**

25" (MDC 900 series) radar domes **RW4-2**

Some 4' - 6' open array radars **RW4-3**

HDS10 open array radar **RW4-5**

LORENZ

12" - 24" radar domes **RW4-1**

4' - 6' open array radar **RW4-5**

LOWRANCE

3G, 4G, HALO20(+), HALO24 **RW4-2**

4' - 6' open array radar **RW4-5**

RAYMARINE

RD418D, RD418HD, RD424D, RD424HD, **RW4-2**

Quantum, Quantum 2 radar domes

RA1048(S)HD, RA3048(S)HD, RA1072(S)HD, **RW4-4**

RA3072(S)HD, Magnum open array radars

SIMRAD

3G, 4G, HALO20(+), HALO24 **RW4-2**

DX64S radar domes **RW4-6**

TX06S, TX10S open array radar **RW4-5**

4' open array radar (RB7 Series) **RW4-3**

4' Halo™ open array radar **RW4-7**

SITEX

18" (T760 / T921) radar domes **RW4-1**

24" (T761, MDS12) radar domes **RW4-6**

25" radar domes **RW4-2**

4' - 6' open array radars **RW4-3**

DIMENSIONS



	RW4-1	RW4-2	RW4-3	RW4-4	RW4-5	RW4-6	RW4-7
	inch / mm	inch / mm	inch / mm	inch / mm	inch / mm	inch / mm	inch / mm
A	0.31 / 7.87	0.53 / 13.46	0.25 / 6.35	0.15 / 3.81	0.25 / 6.35	0.67 / 17.02	0.29 / 7.37
B	0.95 / 24.13	1.40 / 35.56	0.95 / 24.13	0.95 / 24.13	0.77 / 19.56	1.50 / 38.10	1 / 25.4



ADAPTER PLATE

FOR SIMRAD® HALO™ OPEN ARRAY RADAR

This Simrad Halo™ adapter plate is a great solution when replacing an existing Simrad Broadband 3G™, Broadband 4G™, Raymarine or Garmin closed dome radar. Mounting holes pick up existing radar brands mentioned above and the Simrad Halo™ open array. Halo24 works without adapter plate.

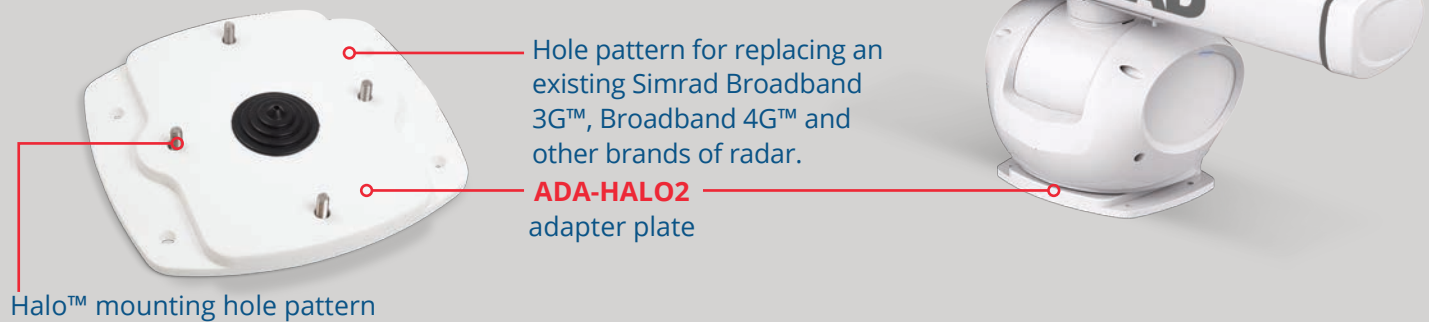

"With new electronics coming out all the time and installations getting even more complex we are always looking for innovative ways to mount everything. For our clients there is nothing worse than simple "bolt ons". Seaview offers a wide variety of options that are customizable and adaptable to meet the needs of virtually every installation with the added bonus of quality and style that are second to none. That is what our customers demand and why Seaview is our solution."

Todd Albrecht
Vice President
Jupiter Marine



MAST PLATFORMS

FOR MOST RADARS & SATDOMES



Solid underbody construction not only greatly improves strength but also hides radar cables.

Predrilled to receive accessories such as a flood light or horn.

ADJUSTABILITY



The SM-18-R is designed with fore and aft adjustable rails so that you can have the radar as close as possible to the mast.

STRENGTH



Six stainless steel rivets with nylon washers to protect powder coat finish per foot are used to hold the heavy duty mounting feet to the mast.

DIMENSIONS

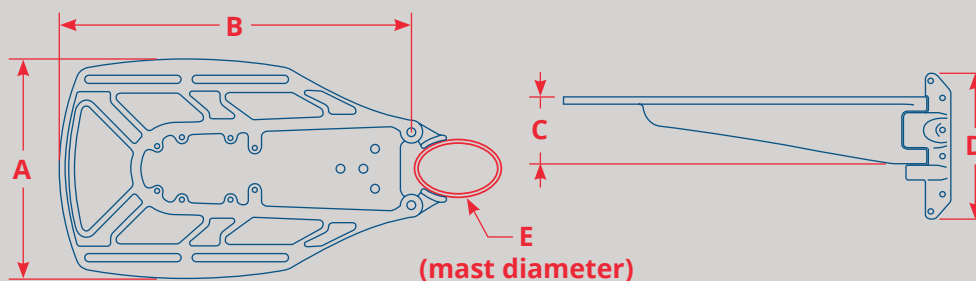

	SM-14-A inch / mm	SM-15-A inch / mm	SM-18-A inch / mm	SM-18-U inch / mm	SM-18-R inch / mm	SM-24-A inch / mm	SM-24-U inch / mm	SM-24-R inch / mm
A	8.23 / 209	12 / 304.8	18.5 / 469.9	12 / 304.80	11.28 / 286.5	18.50 / 470	11.75 / 298.45	11.75 / 298.45
B	15.9 / 403.1	16.25 / 412.75	24.25 / 616	15.65 / 397.51	18.01 / 457.5	24.25 / 616	20 / 508	20 / 508
C	4.11 / 104.4	6 / 152.4	6 / 152.4	3.44 / 87.4	3.44 / 87.4	6 / 152.4	6 / 152.4	6 / 152.4
D	7.44 / 189	6.50 / 165.1	6.50 / 165.1	7.44 / 189	7.44 / 189	6.50 / 165.1	6.50 / 165.1	6.50 / 165.1
E	≤ 2.63 / 66.68	≤ 2.63 / 66.68	≤ 3.63 / 92.08	≤ 2.63 / 66.68	≤ 2.63 / 66.68	≤ 3.63 / 92.08	≤ 3.63 / 92.08	≤ 3.63 / 92.08

MAST PLATFORM PART # GUIDE

	Mast Mount Part #	Stainless Steel Guard Part #
B&G		
3G, 4G, HALO20(+)	SM-18-R	SM-G18-U
HALO24	SM-18-R	SM-G24-U
FLIR		
MD324, MD625, M324XP, M324L, M324S, M324CS, M625XP, M625L, M625S, M625CS, M612L, M617CS, M618CS	SM-14-F	NA
M300C, M332, M364, M364C, M364C LR	SM-14-F3	NA
M132, M232 Series (Hiko)	SM-14-F2	NA
FURUNO		
DRS4DL, DRS4W	SM-18-U	SM-G18-U
SC30, SC703, SC1303	SM-24-U	NA
DRS4D, DRS4DNXT	SM-24-U	SM-G24-U
GARMIN		
GMR18(HD), GMR18x(HD), Fantom18	SM-18-R	SM-G18-U
GMR24(HD), GMR24x(HD), Fantom24	SM-24-R	SM-G24-U
HUMMINBIRD		
HB2124 Chirp Radar	SM-18-R	SM-G24-U
INTELLIAN		
FB150, FB250	SM-14-A	SM-G18-U
i2, i3 (FB150 in i3 matching dome)	SM-15-A	SM-G18-U
i4, i4P (FB150 in i4 matching dome)	SM-18-A	SM-G18-U
i5, i6, i6P, S6HD, FB500	SM-24-A	SM-G24-U
FB150, FB250	SM-14-A	SM-G18-U

	Mast Mount Part #	Stainless Steel Guard Part #
JRC		
JUE 250, JUE 33 (14")	SM-14-A	SM-G18-U
JMA 1032 (18")	SM-18-U	SM-G18-U
JUE 500 (24")	SM-24-A	SM-G24-U
JMA-5104, NKE-2042 (24")	SM-24-U	SM-G24-U
KODEN		
18" (MDC 900 series) radomes	SM-18-U	SM-G18-U
25" (MDC 900 series) radomes	SM-24-U	SM-G24-U
KVH		
FB150 (10.8"), FB250 (14"), Fleet 33, Fleet One	SM-14-A	SM-G18-U
M1DX, M1, TV1, M2, M3, M3DX, M3ST, V3, V3-IP, TV3, LTE-1	SM-15-A	SM-G18-U
M5, TV5, FB250 (18")	SM-18-A	SM-G18-U
M7, M7SK, HD7, V7, TV6, FB500 (26"), V3-IP (24"), TV7-IP	SM-24-A	SM-G24-U
FB150 (10.8"), FB250 (14"), Fleet33, Fleet One	SM-24-U	SM-G24-U
LORENZ		
12" - 24" radomes	SM-18-U	SM-G18-U
LOWRANCE		
3G, 4G, HALO20(+)	SM-18-R	SM-G18-U
RAYMARINE		
RD418D, RD418HD	SM-18-R	SM-G18-U
RD424D, RD424HD	SM-24-R	SM-G24-U
Quantum, Quantum 2 radar	SM-18-R	SM-G24-U
33STV, 37STV	SM-15-A	SM-G18-U
45STV	SM-18-A	SM-G18-U
60STV	SM-24-A	SM-G24-U
T200, T300, T400	SM-14-F	NA

	Mast Mount Part #	Stainless Steel Guard Part #
SEA TEL / COBHAM		
ST14, FX150 (16.5")	SM-18-A	SM-G18-U
C18, FX250 (24")	SM-24-A	SM-G24-U
SIMRAD		
3G, 4G, HALO20(+)	SM-18-R	SM-G18-U
HALO24	SM-18-R	SM-G24-U
DX64S	SM-24-U	SM-G24-U
SITEX		
18" (T760 / T921) radomes	SM-18-U	SM-G18-U
24" (T761, MDS12) radomes	SM-24-U	SM-G24-U
25" radomes	SM-24-A	SM-G24-U
THRANE & THRANE		
FB150, FB250, Fleet 33, Fleet 33+, Fleet One	SM-14-A	SM-G18-U
Sailor FB500, Fleet 55+	SM-24-A	SM-G24-U
VDO		
Ocean Line 132 (18")	SM-18-U	SM-G18-U
Ocean Line 337 (15")	SM-18-A	SM-G18-U
Ocean Line 345 (18")	SM-24-A	SM-G24-U
Ocean Line 360, 445, 460 (24")	SM-24-A	SM-G24-U

MAST PLATFORM ACCESSORIES



Stainless steel guard for most closed dome radars. Part number **SM-G18-U** and **SM-G24-U**. (Refer to guide above)



SM-AD-ISO Isomat adapter for boats with Isomat masts (Integral Track at the Front).



SM-AD-FB Flybridge adapter kit for smaller mast mounts. Fits the following Seaview mast mounts: SM-18-R, SM-18-U, SM-14-F. Will allow for 35° of adjustment.

RADAR MAST POLE KITS

RADAR MASTS FOR SAILBOATS & TRAWLERS

Seaview offers a pole mount for just about any application. The two most common pole kits are the 8' or 10' tall pole kits. Additional sizes are available, please call to special order. The adjustable base has a small 5¼" x 3" footprint, and water tight Seaview Cable Gland, which can be easily disassembled for pole removal.

NOTE: Each pole kit comes with the Seaview modular top, top plate to fit most closed dome radars, 8' pole (3" diameter) and adjustable base with cable gland integration. The only variable between the three common pole kits below are the secondary support kits.

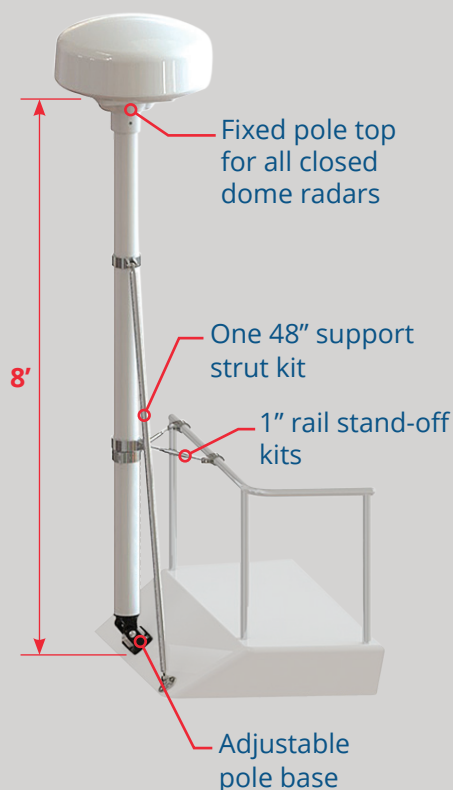

RM8148 8' Tall Kit

- Fixed pole top
- One 48" strut
- One 1" rail stand off kit
- Adjustable base

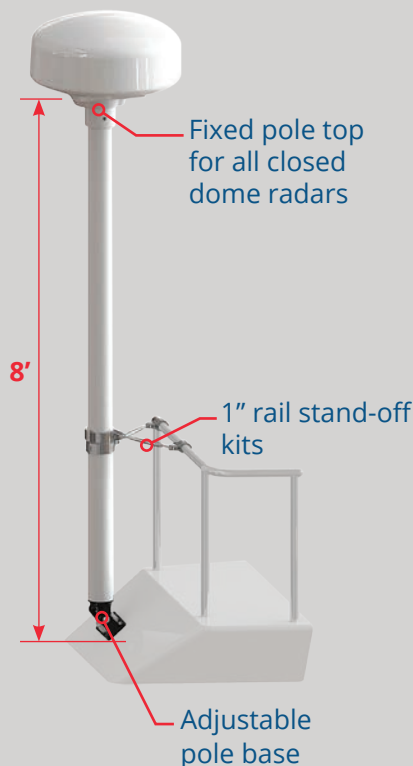

RM8KT1 8' Tall Kit

- Fixed pole top
- One 1" rail stand off kit
- Adjustable base

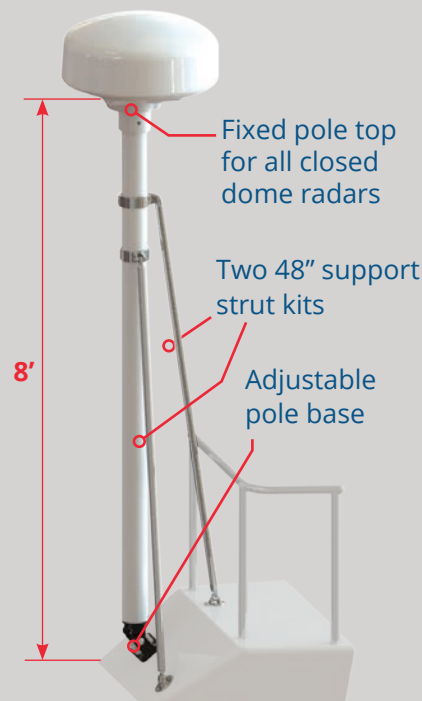

RM848S 8' Tall Kit

- Fixed pole top
- Two 48" strut kits
- Adjustable base

8' TALL POLE KIT (For 3" Diameter Mast)

Fixed Top, Adj. Base, Pole & 48" Strut Kit & One Rail Stand-Off Kit

RM8148

Fixed Top, Adjustable Base, Pole & One Rail Stand-Off Kit

RM8KT1

Fixed Top, Adjustable Base, Pole & Two 48" Strut Kits

RM848S

NOTE: Top plate included with each pole kit to fit most closed dome radars

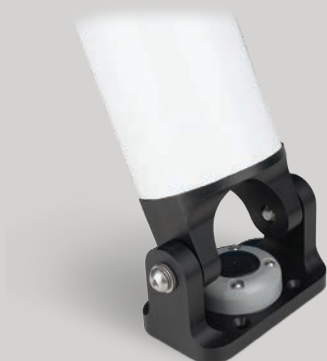

ADJUSTABLE BASE

All Seaview Pole Kits feature a anodized adjustable base with a water tight Seaview Cable Gland.



HEAVY DUTY SUPPORTS

High polished stainless steel strut supports. Not offered in the RM8KT1 Pole kit.



RAIL STAND-OFF KIT

The rail stand-off kit includes two turnbuckle style struts that are adjustable from 6" - 12", two stainless steel 3" pole clamps and two stainless steel 1" rail clamps. 1 1/4" clamps are available upon special request.



SAIL PODS - SPOD

FOR MOST INSTRUMENTS & DISPLAYS



PRECISE VIEWING

The Seaview SPOD fits the majority of steering gear in the market place including Jefa, Whitlock and Edson.

- Clamps onto 1", 1½" or 1¼" rails
- Fits standard 12", 9½" & non standard guard rails
- UV resistant ABS plastic
- Water tight gasket
- Tamper resistant security screws



Two high polished stainless steel clamps are used to secure your SPOD to a 1", 1½" or 1¼" (25mm to 32mm) rails. The SPOD fits standard 12", 9½" and non standard guard rails.



The **SP1BOX** is an add-on accessory that allows you to mount additional instruments to your SPOD. This optional add-on will fit single instruments 4.125" x 4.125" or smaller. Depending on the pod box size you can fit up to 4 of these onto a single SPOD.

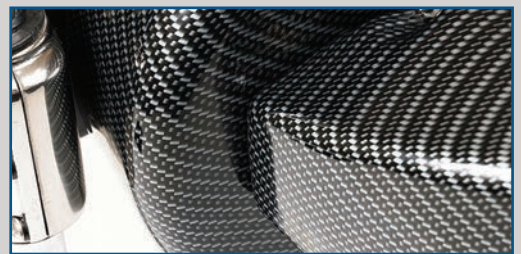

Carbon fiber look available upon special request. Contact Seaview for more information.

ACHIEVE THE PERFECT VIEW

The SPOD has a wide mounting angle, allowing for precise viewing. Angle is set during installation.



DECK PODS - DPOD

FOR MOST INSTRUMENTS & DISPLAYS



QUICK ON THE FLY ADJUSTMENTS

When you are just about to catch a huge one the last thing you want to worry about is adjusting your fish finder. With the quick adjustment knob on the DPOD simply pull the knob out and rotate.

- Rotates up to 350°
- Anodized aluminum base
- UV protected ABS plastic housing
- Water tight gasket
- Tamper resistant security screws



Tamper proof screws are used to secure the UV protected ABS plastic housing of the SPOD, DPOD and Rail Pods.

Need help with finding the right SPOD or DPOD for you?

Check out our reference guide on page 33!

The Seaview DPOD is very easy to adjust. Just simply grab the sides of the DPOD and turn either direction. It's perfect for quick adjustments!



SAIL, DECK & RAIL POD

PART NUMBER GUIDE

Diagram illustrating the dimensions of a pod. The top view shows dimensions A (width), B (height), C (base width), F1 (inner width), F2 (outer width), G1 (inner height), and G2 (outer height). The side view shows dimensions D (height), E (width), H° (height angle), and I° (width angle).

Note: All pods are uncut. Seaview can pre-cut upon request.

Max Cut Out Area

Max Usable Face

NOTE: Electronics change often. Please refer to website for most up to date reference guide.

		A	B	C	D	E	F ¹	G ¹	F ²	G ²	H	I
		inch / mm	inch / mm	inch / mm	inch / mm	inch / mm	inch / mm	inch / mm	inch / mm	inch / mm		
SPOD / RAIL POD		Overall Dimensions					Max Usable Face		Max Cut Out Area			
	SP1S	5.04 / 127.97	NA	NA	5.16 / 131.14	3.125 / 79.38	4.63 / 117.47	4.63 / 117.47	4.125 / 104.77	4.125 / 104.77	NA	NA
	SP1S2	5.38 / 136.53	NA	NA	5.38 / 136.53	3.38 / 85.73	5 / 127	5 / 127	4.38 / 111.13	4.38 / 111.13	NA	NA
	SP2S / SP2S1	12.30 / 312.55	NA	NA	7.56 / 191.89	5.08 / 129.03	11.75 / 298.45	7 / 177.80	11 / 279.40	6.125 / 155.57	26°	12°
	SP3S / SP3S1	14.25 / 361.95	NA	NA	9.5 / 241.30	5.15 / 130.73	13.75 / 349.25	9 / 228.60	12.94 / 328.63	8.125 / 206.37	32°	30°
	SP4S	17.5 / 444.50	NA	NA	12.75 / 323.85	5.7 / 144.78	16.94 / 430.23	12.25 / 311.15	16 / 406.40	11.25 / 285.75	10°	7°
DPOD	SP5S / SP5S1	15.25 / 387.35	NA	NA	5.5 / 139.70	3.19 / 80.90	14.75 / 374.65	5 / 127	13.88 / 352.42	4.125 / 104.77	6°	6°
	SP2P	12.30 / 312.55	9.37 / 238	4 / 101.6	7.56 / 191.89	5.08 / 129.03	11.75 / 298.45	7 / 177.80	11 / 279.40	6.125 / 155.57	NA	NA
	SP3P	14.25 / 361.95	11.31 / 287.27	4 / 101.6	9.5 / 241.30	5.15 / 130.73	13.75 / 349.25	9 / 228.60	12.94 / 328.63	8.125 / 206.37	NA	NA
Accessory	SP5P	15.25 / 387.35	7.31 / 185.67	4 / 101.6	5.5 / 139.70	3.19 / 80.90	14.75 / 374.65	5 / 127	13.88 / 352.42	4.125 / 104.77	NA	NA
	SP1BOX	5.04 / 127.97	NA	NA	5.16 / 131.14	3.125 / 79.38	4.63 / 117.47	4.63 / 117.47	4.125 / 104.77	4.125 / 104.77	NA	NA
	SP1BOX2	5.38 / 136.53	NA	NA	5.38 / 136.53	3.38 / 85.73	5 / 127	5 / 127	4.38 / 111.13	4.38 / 111.13	NA	NA

PART NUMBER GUIDE	SPOD	DPOD	RAIL POD
B&G			
Triton2	SP1S2	—	SP1S2
Vulcan 5, Vulcan 7,Vulcan 9, Zeus2 7, Z7, Touch 7, Zeus3, Zeus2 9 (W9), Zeus3 9, H5000	SP2S	SP2P	SP2S1
Z8, Vulcan 12, Touch 8	SP3S	SP3P	SP3S1
Zeus2 12 (Z12), Touch 12, Zeus3 12, T12, Zeus2 Glass Helm ZM 16	SP4S	—	—
FURUNO			
GP39, GP1670, GP1670F, GP1870, GP1870F, GP7800	SP2S	SP2P	SP2S1
GP170, GP170D, GS100, 1623, 1715	SP3S	SP3P	SP3S1
TZTL12F, MFD12	SP4S	—	—
GARMIN			
echoMAP 50 series, echoMAP CHIRP 52cv - 54cv, GPSMAP 722, 722xsv, 742, 742xsv, Striker 5, Striker 7, 441, 441S, 527, 547, 620, 640, 720, 721, 740, 741, 741xsv, 70s, 7407xsv, 7607xsv, echoMAP 70 & 90 series, echoMAP CHIRP 92sv - 95sv, 75sv, 74sv, 73sv 72sv, 74cv, 73cv, GPSMAP 922, 922xsv, 942, 942xsv, 6008, 6208, 8008, 8208, 7408xsv, 7608xsv, 62cv, 64cv, 65cv, 72cv, 75cv, 93cv, Striker 9	SP2S	SP2P	SP2S1
820, 840, 4008, 4208, 5008, 5208, 7410xsv, 7610xsv, 7412xsv, 7612xsv, GPSMAP 1022, 1022xsv, 1042xsv, 8612xsv, 8412xsv, 8610xsv, 8410xsv	SP3S	SP3P	SP3S1
1020, 1040, 4010, 4210, 4012, 4212, 5012, 5212, 8012, 8212, 7416xsv, 7616xsv, 8015, 8215, GPSMAP 1222, 1222xsv, 1242xsv, 8616xsv, 8416xsv, 8617, 8417	SP4S	—	—

HUMMINBIRD			
Helix 5, 50 0 Series, 700 Series, Helix 7, 800 Series, 900 Series	SP2S	SP2P	SP2S1
Helix 9, Helix 10, ONIX 8, ONIX 10	SP3S	SP3P	SP3S1
ION 10, ION 12, 1100 Series, Helix 12, Solix 12, Solix 12Si, Solix 15, Solix 15Si	SP4S	—	—
KODEN			
KGP-913MkII, 913MkIID, KGP-915, KGP-925, KGP-920, KGC-222, CVS-126, CVR-010, KTN-70A	SP2S	SP2P	SP2S1
CVS-126, CVR-010	SP3S	SP3P	SP3S1
CVS-128, CVS-128B, MRD-103, MRD-103A	SP4S	—	—

PART NUMBER GUIDE	SPOD	DPOD	RAIL POD
LOWRANCE			
TROPHY-5M, HDS-5, HOOK5, 5X, HDS-7, HDS-7 Gen3, 7M, Elite 7, Elite-5Ti, Elite-7Ti, HDS-9, HDS-9 Gen3, Elite-9Ti, HOOK 7, 7x, HOOK 9, 9x, Elite 9, 9x	SP2S	SP2P	SP2S1
HDS-8, HDS-8M, HDS-10, HDS-10M, HDS-12 Gen2, HDS-12 Gen3, Elite-12Ti	SP3S	SP3P	SP3S1
RAYMARINE			
a65, a67, a68, a75, a77, a78, e7, e7D, Axiom 7 (+), eS75, eS77, eS78, c95, c97, e95, e97, Axiom 9 (+), Element 7HV, Element 9HV	SP2S	SP2P	SP2S1
eS97, eS98, a95, a97, a98, gS95, Axiom 9 (+), Axiom 12 (+)	SP3S	SP3P	SP3S1
a125, a127, a128, eS127, eS128, gS125, e165, gS165, Axiom Pro 12, Element 12HV	SP4S	—	—
SIMRAD			
NSS7, NSS7 evo2, NSS7 evo3, GO5 XSE, GO7 XSE, GO9 XSE, NSS9 evo2, NSS9 evo3, Cruise5/7/9	SP2S	SP2P	SP2S1
NSS8, NSE8, GO12	SP3S	SP3P	SP3S1
NSS12, NSE12, NSS12 Evo 2, NSS12 Evo 3, MO16-T, MO16-P, NSO Evo3 16	SP4S	—	—
SITEK			
SVS-560CF, EC5E, EC5I, EC5FE, EC5FI, SNS 700	SP2S	SP2P	SP2S1
EC7E, EC7I, EC7FE, EC7FI	SP3S	SP3P	SP3S1
EC11, SNS 1100	SP4S	—	—
STANDARD HORIZON			
CP150, CP150C, CP155C, CP170C, CP175C, CPN700i, CP190i, CP390i, CPF190i, CPF180i, CPF300i	SP2S	SP2P	SP2S1
CPN1010i, CP1000C	SP3S	SP3P	SP3S1
CP590	SP4S	—	—
ICOM			
MA-500TR	SP2S	SP2P	SP2S1
MXD5000	SP4S	—	—

RAIL POD

FOR MOST INSTRUMENTS & DISPLAYS



OPTIMIZE YOUR VIEW

Seaview offers a solution to the age old problem of figuring out where to mount all your instruments on your sailboat. The Rail Pod allows you to mount smaller displays and instruments directly to the rail, allowing you to position the instrument where it is most optimal for you.

- Fits 1", 1½" or 1¼" (25mm to 32mm) rails
- Cables routed internally through the clamp and into the rail
- UV protected ABS plastic housing
- Water tight gasket
- Tamper resistant security screws



FAQ's

1. Will Seaview Rail Pod fit my electronic device?

Yes, several pod box sizes to fit your electronic device. Plus with the accessory pod option you are able to mount small screens just about anywhere.

2. Is it easy to install your instrument pods?

Seaview instrument pods are very easy to install and only requires basic tools and a drill.

3. Are these durable?

Yes! Our pods are made from UV resistant ABS plastic. The clamps are made from 316 stainless steel. So you can be sure our pods can withstand the harshest of conditions.

4. Will the instrument pod protect my electronic instrument?

Yes, our instrument pods use a rubber gasket to keep water out. A GORE™ vent also lets hot air out without letting water in. Tamper resistant screws are also used to hold everything together.

5. Are these instrument pods uncut or pre-cut?

For ease of stocking purposes Seaview instrument pods are uncut. We do offer a pre-cut service however.



RETROFIT CABLE GLANDS

FOR MARINE ELECTRONIC CABLES



Part #CG20PG2

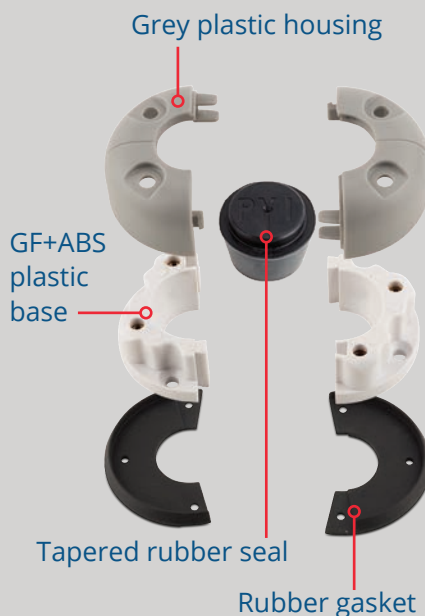

- ✓ **Install with cable in place!**
- ✓ Paintable to match color of choice.
- ✓ Tapered rubber seal forms watertight installation.

EASY INSTALLATION

- Captive nuts.
- No need to remove cable connectors during installation.
- No need to remove the cable at all, simply install with cable already in place.
- All hardware provided for easy installation.

WATERTIGHT INSTALLATION

- IPX6 & IPX7 waterproof rating.
- Undrilled tapered watertight rubber seal.
- Rubber base gasket.

IMPROVED SHAPE AND DESIGN

- Strong impact resistant.
- Low profile design.
- No sharp edges.
- Flush top design means no place for water to collect.

IPX6 & IPX7 TESTED & APPROVED

What does this mean?

- IPX6 test means these pass 100L/min of water sprayed from 2.5 to 3 meters away for 3 min.
- IPX7 test means these pass a 30 minute submersion under 1 meter of water.



"The Seaview cable gland model CG30SB that we used is ideal, easy to install and matched the other Yamaha and Uflex through holes. This is a new product that improves on other designs, looks good and works well."

Rob Bright
Pacific Yacht Management

CABLE GLANDS

FOR MARINE ELECTRONIC CABLES

WATERTIGHT INSTALLATION FOR YOUR ELECTRONIC CABLES



Part #CG30SB

Undrilled seal allows a wide variety of cables to be used.

COLOR / MATERIALS



GREY ABS PLASTIC

BLACK POWDER COATED S.S.

316 STAINLESS STEEL

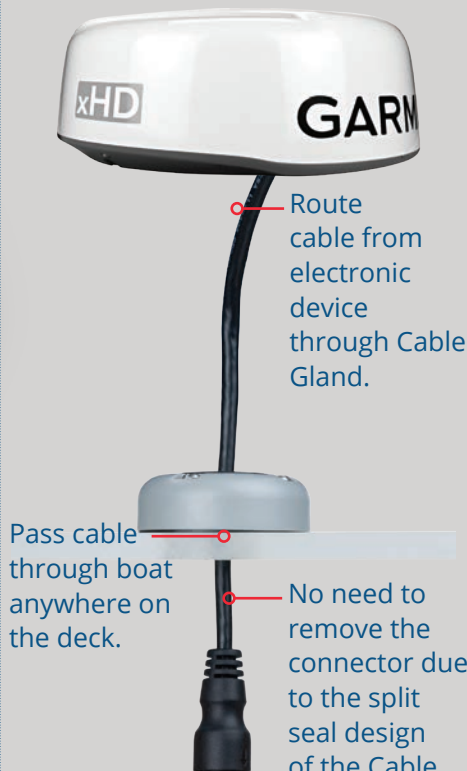

Pass cable through boat anywhere on the deck.

Route cable from electronic device through Cable Gland.

No need to remove the connector due to the split seal design of the Cable Gland.

IMPROVED SHAPE AND DESIGN

Low profile design for a strong, impact-resistant and clean installation. No sharp edges.

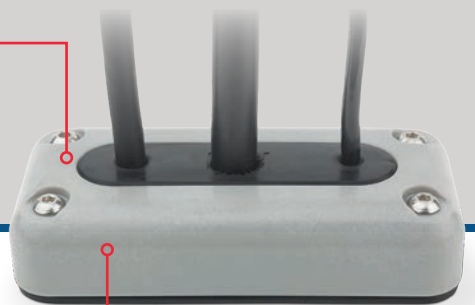

Part #CGM17P-G

Grey plastic, black powder coated S.S. or polished stainless steel housing



Tapered rubber seal

GF+ABS plastic base

Rubber gasket

CABLE GLAND PART NUMBER GUIDE

	# OF CABLES	COLOR / MATERIAL	CONNECTOR DIAMETER	CABLE SIZE	PART #
CABLE GLAND	1	Grey ABS Plastic	Up to 20mm / 0.81"	Up to 13.5mm / 0.53"	CG20P-G
		Black S.S.	Up to 20mm / 0.81"	Up to 13.5mm / 0.53"	CG20S-B
		Stainless Steel	Up to 20mm / 0.81"	Up to 13.5mm / 0.53"	CG20-SS
	1 or 2	Grey ABS Plastic	Up to 34mm / 1.38"	Up to 27.5mm / 1.08"	CG30P-G
		Black S.S.	Up to 34mm / 1.38"	Up to 27.5mm / 1.08"	CG30S-B
		Stainless Steel	Up to 34mm / 1.38"	Up to 27.5mm / 1.08"	CG30-SS
	Multiple	Grey ABS Plastic	Up to 17mm / 0.67"	Up to 10.6mm / 0.5"	CGM17P-G
		Black S.S.	Up to 17mm / 0.67"	Up to 10.6mm / 0.5"	CGM17S-B
		Stainless Steel	Up to 17mm / 0.67"	Up to 10.6mm / 0.5"	CGM17-SS
RETROFIT CABLE GLAND	1	Grey ABS Plastic	Up to 20mm / 0.81"	Up to 13.5mm / 0.53"	CG20PG2
	1 or 2	Grey ABS Plastic	Up to 34mm / 1.38"	Up to 27.5mm / 1.08"	CG30PG2

"As a semi-custom yacht builder, Kadey-Krogen Yachts requires vendors to provide superior quality products, custom built to order and within the needed timeframe to keep our production moving. Seaview does all that, while also providing excellent engineering support and customer service support before and after the product is complete."

Tom Button
VP Operations
Kadey-Krogen Yachts, Inc.



Image courtesy of Kadey Krogen.
(Seaview builds arch and masts for Kadey Krogen)



Image courtesy of Protector USA Inc.

"Seaview provides our customers with a simple and elegant solution for our boats. Seaview has also provided us with very punctual service when it comes to custom modifications to their mounting solutions."

Andrew Carleton
Protector USA Inc.

PERSONALIZED OPTIONS

COMPLETE PERSONALIZED MOUNTS FOR RECREATIONAL BOATS

Seaview can custom fabricate a mount specific to your personal design and needs. Our expert design team can turn your ideas into a reality. By utilizing our experience, skills and software we can provide you with the ability to visualize your design with multiple viewing angles using interactive 3-D models. Costly mistakes can be avoided and difficult to foresee aesthetic decisions can be made prior to fabrication. With our experienced team of fabricators and well equipped facility we can handle whatever project you bring our way. It is our guarantee that our work will be done with quality in mind. Artistic design and functionality partnered with technology based fabrication is groundwork for excellence in our products.

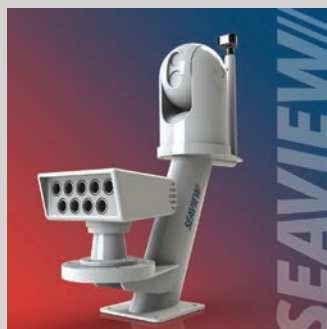

MODEL 57



MODEL 58



MODEL 59



MODEL 60

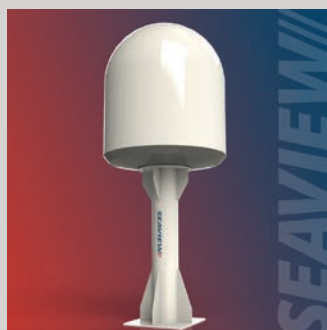

MODEL 61



MODEL 62



MODEL 63



MODEL 64

A Seaview custom arch
for a Beneteau 58



PERSONALIZED OPTIONS

COMPLETE PERSONALIZED MOUNTS FOR RECREATIONAL BOATS



MODEL 65



MODEL 66



MODEL 67



MODEL 68



MODEL 70



MODEL 71



MODEL 72

For more examples visit our website at
www.seaviewglobal.com





COMMERCIAL MARINE MASTS

MOUNTING SOLUTIONS FOR COMMERCIAL MARINE MARKETS

For over 20 years Seaview has been designing and manufacturing mounting solutions for commercial, industrial, governmental agencies, military and Coast Guard applications. A few mast examples are shown below. We can provide a 3D design to fit your application within 48 hours, and a completed mount in 4 weeks depending on design.

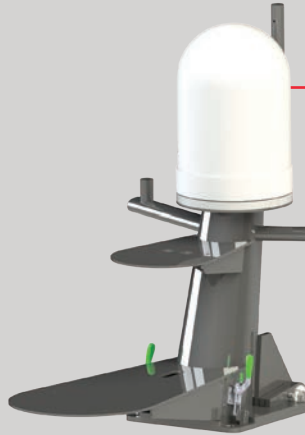



"Meridian Yachts is one of the top selling bridge boat brands in the world. Superior design and proven materials make the Meridian fleet among the finest on the water. Meridian has partnered with Seaview because of a shared promise to deliver exceptional quality and value to its customers. The Seaview products have proven over time to meet our needs and those of our customers."

Bill Gowan
Director Of Engineering
Meridian Yachts

Image courtesy of Meridian
(Seaview PMA-24-ROALM shown)

TESTIMONIALS

HERE'S WHAT THEY HAVE TO SAY ABOUT

SEAVIEW



Raymarine

"Seaview has been a tremendous help to Raymarine USA on all of our demonstration boat projects. These high-performance boats make appearances at boat shows, industry events, fishing tournaments, on TV, and at lots of other high-impact events. Both consumers and members of the boating press and media come onboard to see the latest Raymarine technologies in-action.

We rig them to be "dream boats" with every conceivable option and technology. Seaview's flexible line of electronics mounting solutions makes it easy to fit our full system including radar, satellite TV and thermal night vision. Their customizable masts and mounts are rugged, reliable and they look fantastic too. They blend seamlessly with the design of today's modern sport-fishing boats and look totally built-in, not bolt-on. That's really appreciated by the boat builders we work with on these projects too.

Another thing that always impresses is Seaview's ability to deliver their systems quickly and accurately. No matter what combination of scanners, sensors and antennas I need to mount topsides, Seaview's team always seems to have the correct parts ready to go, and they deliver them on-time. The Seaview team is truly a pleasure to work with."

Jim McGowan
Americas Marketing Manager
FLIR Maritime and Raymarine



GARMIN

"Garmin is proud to work with Seaview and we'd recommend them as a partner to do business with. In today's market, customer expectations are at an all-time high and aesthetics and functionality are at the forefront. Seaview has a proven track record of consistently delivering a professional and reliable product, and because of that, Garmin incorporates their products as often as we can in our demo boats and trade show displays."

David Dunn
Garmin Sr. Manager Marine Sales & Marketing

SI-TEX
KODEN



"We have been working with Seaveiw for a number of years now. Whenever a customer calls our SI-TEX Customer Service department and asks us to recommend a supplier for a Radar Antenna Mount, we instantly recommend Seaveiw. Our experience working with Seaveiw makes us very confident that they will have the right radar antenna mount for the customers installation no matter what type of boat it is or the size of the radar antenna.

Jason, and the staff at Seaveiw go above and beyond researching all of our different SI-TEX and Koden radar antennas each year to make sure they will always have the right product for our customers."

Allen Schneider
Vice President
SI-TEX Marine Electronics

SIMRAD



"From fit to finish, SEAVIEW offers up the cleanest and best solutions for mounting on both my sail and power boat. Plus they are always bringing in great ideas like their new folding running light option! From tapered masts to deck glands to electronics pods, Seaview also has all the right parts to make the fit perfect and professionally eye catching. Add in excellent technical and customer service, my boat would not have anything mounted without SEAVIEW!"

Steve Hamber
Business Development/Sales Training, Americas, Navico



FURUNO

"Seaview has been an excellent company for Furuno to work with for a number of years. Their off the shelf solutions have been fool-proof and we don't hesitate to recommend them for any boater. It's a very responsible company. Jason and the Seaview team recently helped us on very short notice with a one-off, custom mount for a tricky demonstration and it went off on-time, under budget and without any problems at all. You can be confident you're getting great products and great support with Seaview!"

Matt Wood
National Sales Manager
Furuno USA

Seaview is proud to support the world's leading marine electronic manufacturers. Here is what some of them have to say about us!

Intellian

"Intellian is happy to work with Seaview to provide our customers with a professional, stylish and cost effective mounting solution for the complete range of Satellite TV and Communication products."

Paul Comyns
VP Global Marketing
Intellian

KVH®

"Our customers have nothing but great things to say about Seaview products. They are well designed and look great, complimenting many of our KVH antennas well. With all the mounting options available for KVH products, Seaview is the recommended choice for any installation."

Ryan Smith
Leisure Marine - National Sales Manager
KVH Industries, Inc.



Riviera 4800 Sport Yacht
Image courtesy of Riviera Australia Pty Ltd
(Seaview PMA57M1, ADAR1, L1BR, LTBBOX)

WWW.SEAVIEWGLOBAL.COM



SEAVIEW//

USA OFFICE

Tel: 509-795-0977
Toll Free: 800-655-7922
www.seaviewglobal.com

EUROPEAN OFFICE

Tel: +33 4 94 53 27 70
www.seaviewprogress.com



YouTube