

# Portable **TOILETS**

CATALOGUE/PRICE LIST 2016



MADE IN  
ITALY



**ROTOTEC** s.p.a.



# Portable **TOILETS**

CATALOGUE/PRICE LIST 2016

---

	<b>p.4</b>
Introduction	
<hr/>	
	<b>p.6</b>
Construction characteristics	
<hr/>	
	<b>p.8</b>
Standard equipment	
<hr/>	
	<b>p.10</b>
Portable toilet range	
<hr/>	
	<b>p.12</b>
Collapsible portable toilet characteristics	
<hr/>	
	<b>p.14</b>
Collapsible toilet range	
<hr/>	
	<b>p.16</b>
Portable disabled toilets	
<hr/>	
	<b>p.18</b>
Accessories	
<hr/>	
	<b>p.20</b>
Custom finishes	
<hr/>	
	<b>p.22</b>
Standards	
<hr/>	

# ADVANTAGES OF POLYETHYLENE:

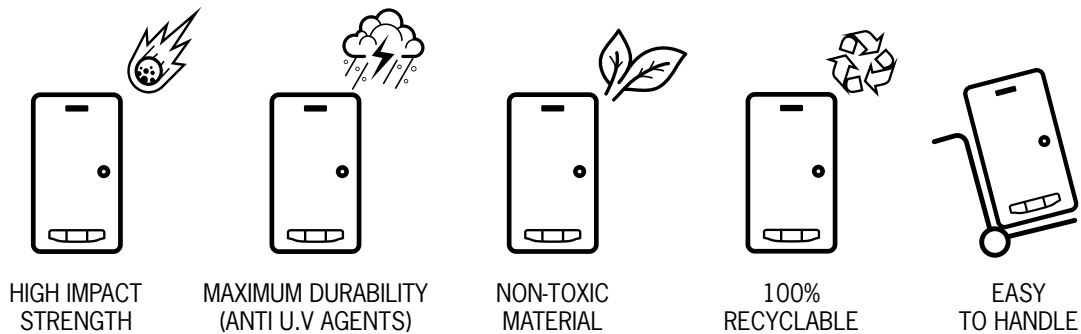

When organising and managing events, promoters today are obliged to provide adequate and fully equipped toilet facilities. These same needs are also applicable to building sites, and even more so in the emergency co-ordination sector where health and hygiene standards are of vital importance.

**Rototec** offers an innovative and full range of chemical and flush toilets manufactured in polyethylene (PE) using rotational moulding technology. Portable chemical toilets, in both the “sit” and “squat” versions, comply with the new standards governing the sector and can be equipped with various accessories that make them more comfortable to use.

**Rototec** also offers customised toilet cabin exteriors. The application of an exterior graphic finish in line with the particular application can limit visual impact or highlight the presence of the cabins.









**Rototec** portable toilets are made up of special structural elements that make their use and handling that much easier. The cabin, in fact, is equipped with all the fittings needed to ensure maximum safety during transport and maximum comfort during use. The portable toilets are delivered ready for use.

---



① Vent

---



② Polyethylene hinge

---



③ Latch with vacant/engaged indicator and key lock

---



④ Steel eye bolts for lifting and handling (on request, only for Firenze model)

---



⑤ Ventilation holes

---

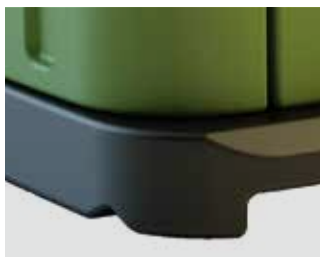

⑥ Raised base for handling with a fork lift, hand grips to facilitate truck loading/unloading and cut-outs for manual trolley use (see accessories) over ground

---

# Portable TOILET



# INTERNAL FITTINGS

Standard accessories installed on all toilets



Mirror / clothes hook



Double toilet roll holder



Non-slip floor

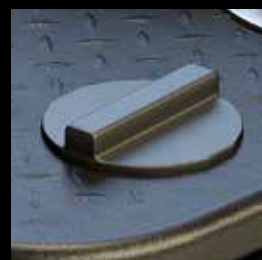

Bayonet plug for filling with clean water (where provided for)



# INTERNAL FITTINGS

## Types and operation

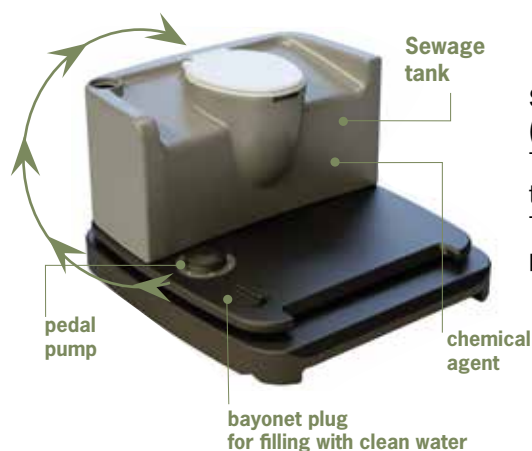

### Seat with chemical toilet and clean water flush (model MILANO page 10 and model PARIGI page 14)

The toilet has two completely separate tanks, one for the sewage in which the degradation agent is housed and one (corresponding to the footboard) containing clean water. The clean water tank is used to flush the bowl by means of a pedal operated diaphragm pump.

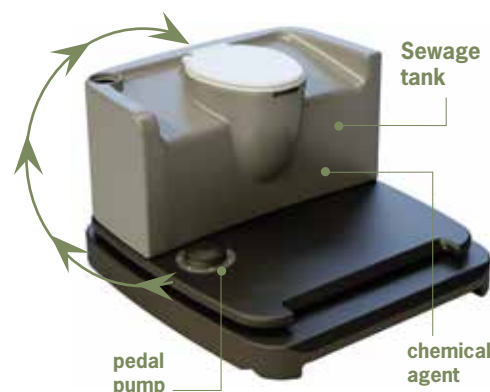

### Seat with chemical toilet and recirculation flush (model ROMA page 10 and model BRUXELLES page 14)

The sewage enters the tank and is treated with a degradation agent. The waste water is then re-used to flush the bowl by means of a pedal diaphragm pump.

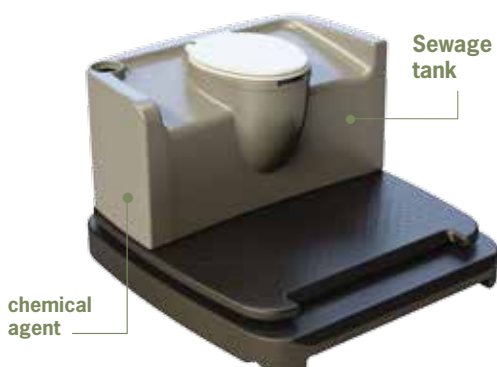

### Seat with drop tank chemical toilet (model TORINO page 10 and model VIENNA page 14)

The sewage enters the waste tank without seat in which it is treated with the degrading agent. On request, it is possible to install a recirculation kit (see page 13) that makes use of a manual pump to recycle the waste water to flush the bowl.

**Chemical squat pan and flush with recirculation  
(model BOLOGNA page 11 and model MADRID page 15 )** The sewage enters the tank and is treated with a degradation agent. It is then re-used to flush the squat pan by means of a pedal diaphragm pump.

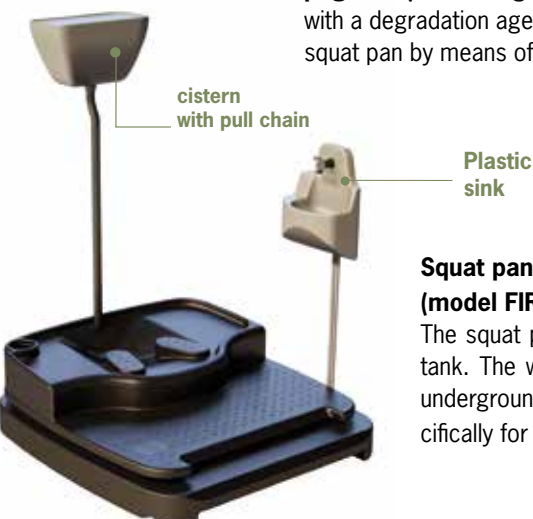

### Squat pan with mains water flush (model FIRENZE page 11 and model BERLINO page 15 )

The squat pan is flushed from the cistern which is fed with mains water or from a storage tank. The waste matter is discharge through a syphon directly to the public sewer, to an underground holding tank or a septic tank for treatment. This type of toilet is designed specifically for fixed installations.

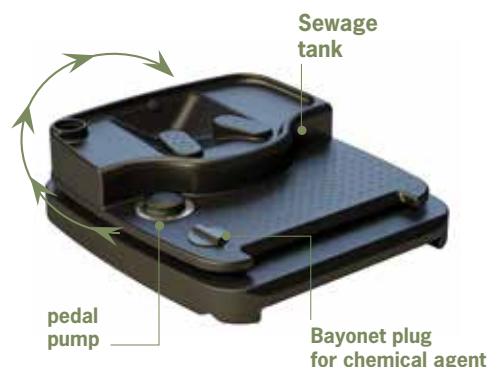



## MILANO

### PORTABLE CHEMICAL TOILET WITH CLEAN WATERFLUSH

Portable chemical toilet with seat and clean water flush using a pedal-operated diaphragm pump. Supplied with all standard accessories (see page 8).

Item	Colour	Width (mm)	Depth (mm)	H (mm)	Door opening (mm)	Weight (kg)	Vol. (litres) sewage	Vol. (litres) clean water	Uses	Price €
BWA100VV	Green	1100	1200	2450	600 x 2000	95	170	115	200 approx.	1,740.00
BWA100BB	Blue	1100	1200	2450	600 x 2000	95	170	115	200 approx.	1,740.00
BWA100GG	Grey	1100	1200	2450	600 x 2000	95	170	115	200 approx.	1,740.00



## ROMA

### PORTABLE CHEMICAL TOILET WITH RECIRCULATION

Portable chemical toilet with seat and recycled water flush using a pedal-operated diaphragm pump. Supplied with all standard accessories (see page 8).

Item	Colour	Width (mm)	Depth (mm)	H (mm)	Door opening (mm)	Weight (kg)	Vol. (litres) sewage	Uses	Price €
BWR100VV	Green	1100	1200	2450	600 x 2000	95	170	200 approx.	1,700.00
BWR100BB	Blue	1100	1200	2450	600 x 2000	95	170	200 approx.	1,700.00
BWR100GG	Grey	1100	1200	2450	600 x 2000	95	170	200 approx.	1,700.00



## TORINO

### PORTABLE DROP TANK CHEMICAL TOILET

Portable chemical toilet with seat and holding tank, without bowl or flush. Optional recirculation kit for bowl flush. Supplied with all standard accessories (see page 8).

Item	Colour	Width (mm)	Depth (mm)	H (mm)	Door opening (mm)	Weight (kg)	Vol. (litres) sewage	Uses	Price €
BWC100VV	Green	1100	1200	2450	600 x 2000	95	170	200 approx.	1,300.00
BWC100BB	Blue	1100	1200	2450	600 x 2000	95	170	200 approx.	1,300.00
BWC100GG	Grey	1100	1200	2450	600 x 2000	95	170	200 approx.	1,300.00



## BOLOGNA

### PORTABLE CHEMICAL SQUAT TOILET WITH RECIRCULATION

Portable chemical squat toilet with recirculation water flush using a pedal-operated diaphragm pump. Supplied with all standard accessories (see page 8).

Item	Colour	Width (mm)	Depth (mm)	H (mm)	Door opening (mm)	Weight (kg)	Vol. (litres) sewage	Uses	Price €
BTR100V	Green	1100	1200	2450	600 x 2000	90	170	200 approx.	1,670.00
BTR100BB	Blue	1100	1200	2450	600 x 2000	90	170	200 approx.	1,670.00
BTR100GG	Grey	1100	1200	2450	600 x 2000	90	170	200 approx.	1,670.00



## FIRENZE

### PORTABLE SQUAT TOILET WITH SYPHON AND MAINS WATER FLUSH

Portable squat toilet with flushing cistern fed from the water mains or from a storage tank, with plastic sink and tap. The discharge is syphoned directly to the public sewer, holding tank or Imhoff septic tank. Ideal for fixed installation. Supplied with all standard accessories (see page 8).

Item	Colour	Width (mm)	Depth (mm)	H (mm)	Door opening (mm)	Weight (kg)	Ø Outlet pipe (mm)	Price €
BTS100GV	Grey/Green	1100	1200	2450	600 x 2000	85	110	1,310.00
BTS100GB	Grey/Blue	1100	1200	2450	600 x 2000	85	110	1,310.00
BTS100GA	Grey/Orange	1100	1200	2450	600 x 2000	85	110	1,310.00

## INSTALLATION EXAMPLES OF PORTABLE SQUAT TOILETS WITH SYPHON



DISCHARGE TO HOLDING TANK



DISCHARGE TO IMHOFF SEPTIC TANK



DISCHARGE TO PUBLIC SEWER

\* for the transport costs, please contact our sales office.

# Portable TOILET

Rototec introduces a revolutionary concept of the one-piece portable toilet. Its originality lies in the fact that it is also available in a collapsible version.

The engineering behind this new toilet allows it to be dismantled, and this is where its strength lies, saving transport costs, optimising transport space and simplifying storage. Aspects of vital importance on both a national and international scale.



**1.**  
Latch with  
vacant/engaged  
indicator  
and key lock



**2.**  
Raised base for  
handling with a  
fork lift and  
transpallet



**3.**  
Vent



**4.**  
Polyethylene  
hinge



**5.**  
Ventilation  
holes





## INTERNAL FITTINGS

Standard accessories installed on all toilets



**Mirror / clothes hook**



**Double toilet roll holder**



**Non-slip floor**

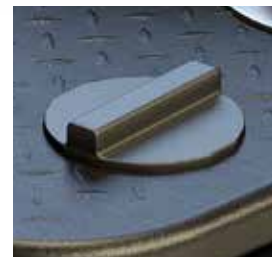

**Bayonet plug for filling  
with clean water  
(where provided for)**



## PARIGI

### PORTABLE CHEMICAL TOILET WITH CLEAN WATERFLUSH

Portable chemical toilet with seat and clean water flush using a pedal-operated diaphragm pump. Supplied with all standard accessories (see page 8).

Item	Colour	Width (mm)	Depth (mm)	H (mm)	Door opening (mm)	Weight (kg)	Vol. (litres) sewage	Vol. (litres) clean water	Uses	Price €
BWA100VV	Green	1100	1200	2450	600 x 2000	95	170	115	200 approx.	1,740.00
BWA100BB	Blue	1100	1200	2450	600 x 2000	95	170	115	200 approx.	1,740.00
BWA100GG	Grey	1100	1200	2450	600 x 2000	95	170	115	200 approx.	1,740.00



## BRUXELLES

### PORTABLE CHEMICAL TOILET WITH RECIRCULATION

Portable chemical toilet with seat and recycled water flush using a pedal-operated diaphragm pump. Supplied with all standard accessories (see page 8).

Item	Colour	Width (mm)	Depth (mm)	H (mm)	Door opening (mm)	Weight (kg)	Vol. (litres) sewage	Uses	Price €
BWR100VV	Green	1100	1200	2450	600 x 2000	95	170	200 approx.	1,700.00
BWR100BB	Blue	1100	1200	2450	600 x 2000	95	170	200 approx.	1,700.00
BWR100GG	Grey	1100	1200	2450	600 x 2000	95	170	200 approx.	1,700.00



## VIENNA

### PORTABLE DROP TANK CHEMICAL TOILET

Portable chemical toilet with seat and holding tank, without bowl or flush. Optional recirculation kit for bowl flush. Supplied with all standard accessories (see page 8).

Item	Colour	Width (mm)	Depth (mm)	H (mm)	Door opening (mm)	Weight (kg)	Vol. (litres) sewage	Uses	Price €
BWC100VV	Green	1100	1200	2450	600 x 2000	95	170	200 approx.	1,300.00
BWC100BB	Blue	1100	1200	2450	600 x 2000	95	170	200 approx.	1,300.00
BWC100GG	Grey	1100	1200	2450	600 x 2000	95	170	200 approx.	1,300.00



## MADRID

### PORTABLE CHEMICAL SQUAT TOILET WITH RECIRCULATION

Portable chemical squat toilet with recirculation water flush using a pedal-operated diaphragm pump. Supplied with all standard accessories (see page 8).

Item	Colour	Width (mm)	Depth (mm)	H (mm)	Door opening (mm)	Weight (kg)	Vol. (litres) sewage	Uses	Price €
BTR100V	Green	1100	1200	2450	600 x 2000	90	170	200 approx.	1,670.00
BTR100BB	Blue	1100	1200	2450	600 x 2000	90	170	200 approx.	1,670.00
BTR100GG	Grey	1100	1200	2450	600 x 2000	90	170	200 approx.	1,670.00



## BERLINO

### PORTABLE SQUAT TOILET WITH SYPHON AND MAINS WATER FLUSH

Portable squat toilet with flushing cistern fed from the water mains or from a storage tank, with plastic sink and tap. The discharge is syphoned directly to the public sewer, holding tank or Imhoff septic tank. Ideal for fixed installation. Supplied with all standard accessories (see page 8).

Item	Colour	Width (mm)	Depth (mm)	H (mm)	Door opening (mm)	Weight (kg)	Ø Outlet pipe (mm)	Price €
BTS100GV	Grey/Green	1100	1200	2450	600 x 2000	85	110	1,310.00
BTS100GB	Grey/Blue	1100	1200	2450	600 x 2000	85	110	1,310.00
BTS100GA	Grey/Orange	1100	1200	2450	600 x 2000	85	110	1,310.00

## COLLAPSIBLE PORTABLE TOILET

N.B. For further information on the collapsible version, contact our sales office.

For the range of colours available, see page 20.

\* for the transport costs, please contact our sales office.



# PORTABLE DISABLED TOILETS

Standard accessories installed on all toilets



Grab rails



Double toilet roll holder



Ventilation grills



Non-slip floor



# INTERNAL FITTINGS

## Types and operation

**Rototec** has developed the Disabled Portable Toilet to meet needs of physically impaired persons and to allow everyone to participate at events. The wide entrance door and obstacle-free access are designed to allow the passage of a wheelchair. Internally, the user can quite easily move in total safety, thanks to the spaciousness of the compartment, the presence of grab rails on the walls and a floor in special non-slip material enabling full 360° mobility and easy seating. The Portable Toilet is built in anti-UV stabilised polyethylene (PE) and is 100% recyclable.

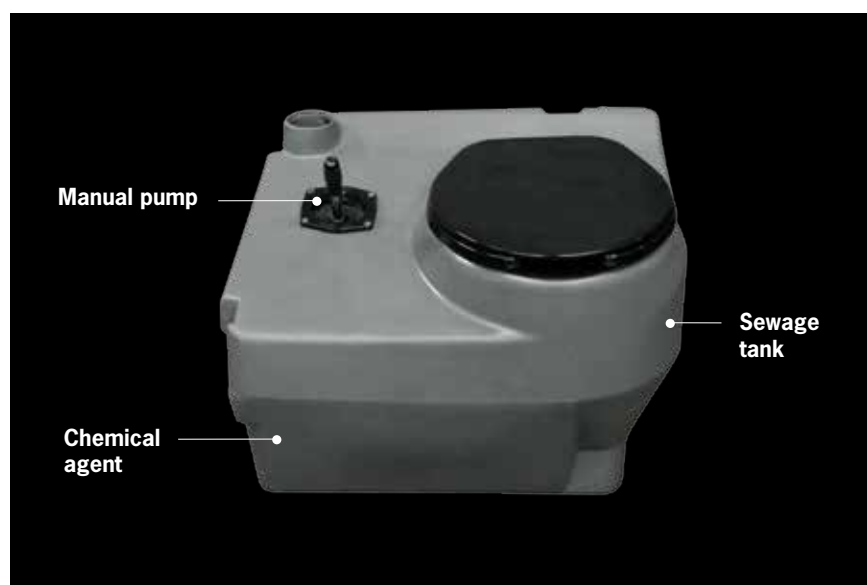

### Seat with chemical toilet and recirculation flush

The sewage enters the specially designed tank and is treated with a deodorising and decomposing agent. The waste water is then re-used to flush the bowl by means of a manually operated diaphragm pump.

Plenty of manoeuvring space, ergonomic, easy access thanks to the step-free ramp.

## MAXI PRAGA

### PORTABLE TOILET WITH CHEMICAL TOILET AND RECIRCULATION FLUSH

Item	Colour	Width (mm)	Depth (mm)	H (mm)	Door opening (mm)	Weight (kg)	Vol. sewage (lt)	H sewage tank (mm)	Price €
BDWR500VV	Green	1550	1550	2200	900 x 1870	127	150	495	4.700,00
BDWR500ZZ	Light blue	1550	1550	2200	900 x 1870	127	150	495	4.700,00

\* for the transport costs, please contact our sales office.



## SEWAGE HOLDING TANK

Item	Volume (litre)	Ø (mm)	Length x Width (mm)	Height (mm)	Ø inspection (mm)	Extension
PI1000	1040	1200	-	1050	300	PP35
PI2000	2075	1500	-	1330	400	PP45
CI3000	3100	-	2090 x 1500	1720	630	PP75
CI5700	5700	-	2420 x 1920	2100	630	PP75
CI10700	10700	-	2780 x 2430	2580	630	PP75



## IMHOFF SEPTIC TANK

Item	User	Volume (litre)	Ø (mm)	Height (mm)	Ø inspection (mm)	Extension
NIM1000	18	850	1150	1220	400-200	PP45-PP30
NIM1500	27	1268	1150	1720	400-200	PP45-PP30
NIM2600	40	2061	1710	1350	400-300	PP45-PP35

NB. For other models, refer to the Sewage Treatment and Water division catalogues



## WASHBASIN

Washbasin with pedal-operated diaphragm pump, complete with fill plug.

Item	Capacity (litres)	N. of uses	Price €
BLAV 100	60	170	280.00



## HAND WASH GEL

Self-drying neutral refill. Pack of 18 pieces.

Item	Quantity (ml)	N. of uses	Price €
BGEL	800	1600	380.00

\*quantity and number of uses per single piece, pack of 18 pieces



## DISPENSER

Hand wash gel dispenser.

Item	Price €
BDISP	58,00



## RICIRCULATION KIT

Manual pumping system for toilet bowl flushing with recirculated water. Consisting of a manual pump, scratch-proof sanitaryware bowl and piping with filter. Available for the Torino model.

Item	Price €
BKRC	360.00



## URINAL

Wall-mounted urinal. Outlet discharges to the sewage holding tank. Available for the Milano, Roma and Torino models.

Item	Price €
BORI	50,00



## URINAL TABLETS

Perfumed tablets with lemon fragrance

Item	Quantity (pcs)	Price €
BPORI 20	20	11,00
BPORI 50	50	28,00



## CHEMICAL DEGRADATION AGENT

Masking and deodorising degradation syrup.

Item	Capacity (lt)	Price €
BLDIS 5	5	130,00
BLDIS 20	20	520,00
BLDIS 50	50	1250,00
BLDIS 100	100	2500,00



## CHEMICAL DEODORIZING AND DECOMPOSING AGENT PLUS

Soluble packets for use in the case of high temperatures and heavy traffic.

Item	Quantity (pcs)	Price €
BBDIS 50	50	80,00



## DEODORANT DISKS

Felt disks impregnated with a blackberry fragrance, for hanging in the toilet.

Item	Quantity (pcs)	Price €
BPDEO 100	100	48,00



## CHEMICAL DEODORIZING AND DECOMPOSING AGENT EVENT

Soluble packets for use during events and on a daily basis.

Item	Quantity (pcs)	Price €
BBDIS 100	80	40,00



## TROLLEY

Solid wheel axle for manually transporting one toilet cabin. Fitted to the cut-outs in the underside of the toilet cabin.

Item	Price €
BCAR	130,00

# CUSTOM GRAPHICS

As always, Rototec attentively follows the new market trends and is always ready offer innovative products. For this reason, the Rototec Portable Toilets are not only manufactured with different coloured finishes but can also be personalised with **custom finishes and graphics**. In this way, the finishes have a dual function: respect for the surrounding environment by **reducing the visual impact of the toilet cabin to zero** (e.g.: perfect camouflage for a golf course) or highlighting its presence and making the product recognisable by means of **impact graphics** (e.g.: publicity for cities of art). The toilet cabin is further transformed into a true and proper item of furniture and communication, acquiring added value without losing its primary function.



NATURE THEME

## COLOUR RANGE

### STANDARD SINGLE COLOUR



### STANDARD TWO-COLOUR



### CUSTOM COLOUR

minimum order 24 units

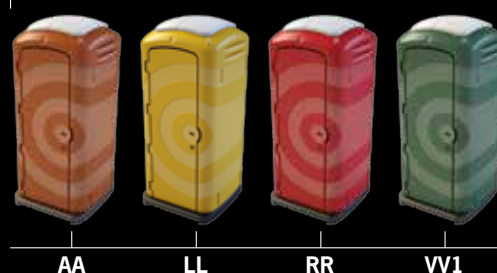





**SPORT THEME**

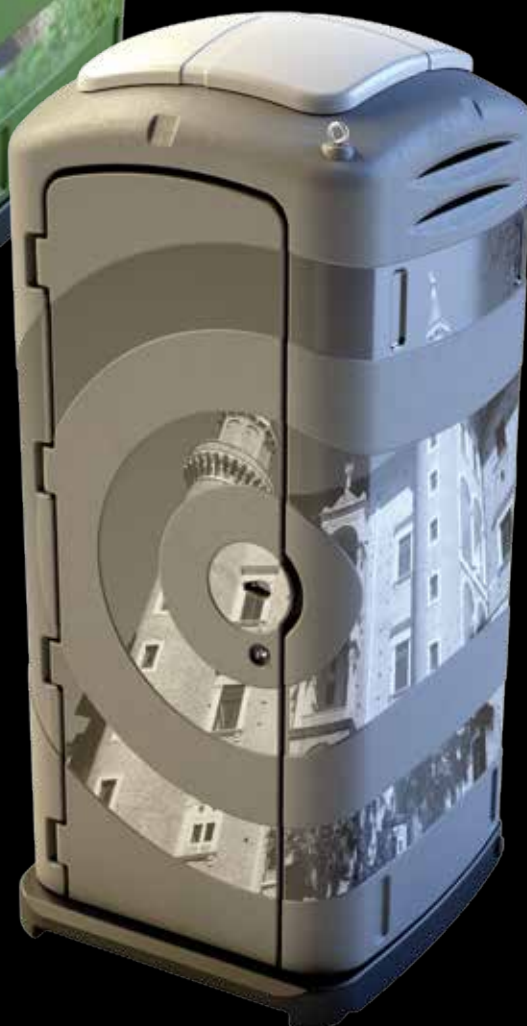

**URBAN THEME**



**FRONT GRAPHICS LOGO APPLICATION**



**REAR GRAPHICS LOGO APPLICATION**



**DOOR GRAPHICS**



**COMPLETE GRAPHICS**

NB. for commercial information regarding custom graphics contact the agency in question or ROTOTEC spa directly.

# SUMMARY OF STANDARD **UNI EN 16194:2012** (MOBILE NON-SEWER CONNECTED TOILET CABINS: REQUIREMENTS OF SERVICES AND PRODUCTS RELATING TO THE DEPLOYMENT OF CABINS AND SANITARY PRODUCTS).

**Introduction** - Over the last ten years, the use of portable toilets (so-called "chemical toilets") has become more and more widespread, to the extent that now they can be seen in all building and road construction sites, at all public open-air events, during emergencies, etc. Up until now, there were no standards governing this service, not even those laying down the minimum performance requirements to guarantee to the user. Now, finally, a new UNI standard has been introduced to fill this gap. The corresponding European Standard EN 16194 has been formally implemented as from the start of 2012 and came into force in Italy on 12th April 2012 with the Italian standard UNI EN 16194.

**A standard for the Service** - Standard UNI EN 16194 not only lays down the requirements for the toilets, but also specifies the essential requirements for the service itself, starting with the number of toilets to be installed according to the number of expected users. In fact, for construction sites, the standard specifies one portable toilet for every 10 users, including both site workers and subcontractors. It specifies that the maximum distance from each work station to the toilet must not exceed 100 metres and that, in the case where the sites are on more than one level, there must be at least one toilet every 2 levels. For events open to the public, the standard adopts the table prepared by the American association PSIA (Portable Sanitation Association International) which defines the minimum number of toilets to be installed as a function of the number of expected users and the duration of the event.

**Minimum toilet requirements** - The portable toilet is defined in broad terms without any detailed specifications, giving each manufacturer sufficient freedom to propose innovations and variants. The minimum requirements, however, are fixed. Each toilet must have a minimum internal area of at least 1m<sup>2</sup> and an internal height of at least 2 metres, sufficient ventilation and adequate internal lighting. The door must be self-closing, must be fitted with a vacant/engaged indicator, must be openable from the inside and from the outside and must be lockable from the inside (e.g. with a key or bolt). It must also be openable from the outside in case of an emergency.

The interior of the toilet must have a container for toilet paper, a clothes hook and a container for waste matter equipped with a top or other support suitable for a seating position.

The waste matter container must vent to air and can be one of three types:

- a - drop type
- b - recirculation type  
(with hand or pedal-operated pump)
- c - clean water type  
(with hand or pedal-operated pump)

Supplementary accessories are allowed but are not obligatory, such as a mirror, light, urinal, hand washer, soap and/or disinfectant dispenser and/or paper towel dispenser.

**Toilets for the disabled** - Toilets for the disabled, up until now available at some events but not all, now play a role. The standard, in fact, defines the obligation to provide at least one toilet for the disabled, i.e. wheelchair-friendly, at each event. To this end, the door must be at least 80 cm wide and the interior must have a width and depth of at least 140 cm. The ability of the wheelchair to rotate one complete revolution inside the toilet is not required, though the entrance must be at ground level, i.e. not steps or ramps.

**Short-term or long-term hire** - The standard defines the information that must be provided for stipulating a short-term or long-term hire contract. The aim is to render the rapport between supplier and hirer that must easier by simplifying discussions on content as much as possible.

**Requirements of services** - In this section, the standard lists the operations that must be carried out when providing the service, such as complete emptying of waste matter, cleaning of single components (listed one by one), replacement of agreed consumable materials, addition of sanitizing concentrate and water. Damaged toilets must be repaired on site or replaced. The requirements for delivering the toilets are also defined (they must be ready for use, complete with sanitizing solution and agreed consumable materials, such as toilet paper, soap, etc. Similarly for collection of the toilet following complete emptying of the waste matter and removal of consumable materials.

**Conformity declaration for the service** - The hire company complying with the requirements of standard UNI EN 16194 is authorised to communicate same in its communications with customers and the public, in advertisements and on adhesives applied to the toilets, etc., with the declaration: "SERVICE PROVIDED IN ACCORDANCE WITH UNI EN 16194".

## MINIMUM NUMBER OF TOILETS TO PROVIDE AT EVENTS OPEN TO THE PUBLIC (50% male - 50% female)

Number of user	Toilets necessary (for events up to 6 hours)	Toilets necessary (for events up to 12 hours)
Up to 249	2	3
From 250 to 499	3	5
From 500 to 999	6	9
From 1000 to 1999	12	18
From 2000 to 2999	25	38
From 3000 to 3999	38	57
From 4000 to 4999	50	75
From 5000 to 5999	63	95
From 6000 to 6999	75	113
From 7000 to 7999	88	132
From 8000 to 8999	100	150
From 9000 to 9999	113	170
From 10000 to 12499	125	188
From 12500 to 14999	156	234
From 15000 to 17499	188	282
From 17500 to 19999	219	329
20000	250	375
Over 20000	To be assessed case by case	

For the complete standard, contact: UNI, Via Sannio, 2 - 20137 Milan; [www.store.uni.com](http://www.store.uni.com) or [www.uni.com](http://www.uni.com)

## GENERAL CONDITIONS OF SALE

**Introduction** All buyers are considered as being aware of these conditions of sale. Unless otherwise specified, all sales are effected in line with the general conditions that follow. Any orders transmitted imply the buyer's adhesion to the conditions without reservation.

**Orders** Purchase orders arriving by fax, e-mail or from our own sales network are always understood as being effected in accordance with the general conditions that follow and, "unless otherwise approved by the vendor", definitively accepted only on presentation of the order confirmation, which must be returned signed for acceptance.

**Prices / Invoicing / Payment** Each product is sold at the list price in force at the time of ordering exclusive of VAT. Our offers are provided without obligation and, unless expressly indicated, are governed by these general conditions of sale. A validity period is specified for the offers which are available for the time period fixed. The products will be invoiced within the reference month of the delivery at the prices in force at the time of ordering and with the application of the VAT in force on the date of invoicing. The invoice will be made out in the same name as the order and will be issued in accordance with current tax legislation. It will, therefore, be the buyer's responsibility, at the time of ordering and prior to the issue of the invoice, to check and inform the vendor of any variations or additions that may modify the information in the possession of Rototec. Payment for the supply will be made adopting the methods and times provided for in the order confirmation. Delays in the payment, including partial, of the invoices and any extra-contractual renewal of the effects will give rise to interest on arrears at the official discount rate increased by 3 points. Furthermore, any stamp charges will be totally at the cost of the customer. Delayed or non-payment of the invoices will give Rototec the right to request advance payment for any remaining orders or contracts in course, and to consider them rescinded, or suspend or annul them, without the buyer having any right to demand compensation, damages or reservations on the matter.

**Ownership of the goods** The ownership of the goods is transferred to the buyer on receipt of the final balance of the agreed price.

**Claims** Any claims must be forwarded in writing at the time of unloading of the goods and with an entry on the delivery note. When reporting concealed defects, all necessary documentation required by Rototec technicians (photographs, reports, etc.) for the determination of that disputed must also be sent. Following an assessment by Rototec technicians, if the complaint is deemed as valid, excluding that for which Rototec is not answerable under the terms of the guarantee described below, the company's obligation is limited to replacing the goods at the same place of delivery of the initial supply and subject to the return of the faulty items. The buyer has no rights whatsoever to request the termination of the contract or a reduction in price, or compensation for damages or reimbursement of any costs sustained whatsoever. Claims do not give the buyer any right to suspend payment of the invoice for the contested goods.

**Shipment / Transport / Packing / Delivery times** Rototec products do not require packing unless otherwise specified at the time of order confirmation. The goods are intended as delivered "free ex works". Unless otherwise agreed on the order confirmation, the goods are delivered free to destination in the case of orders of not less than € 1,000.00, net of any discounts. For orders below this amount, Rototec, when in agreement with the buyer,

is willing to organise transport free to destination, debiting the transport costs according to the volume of the goods and according to the list price of the transporter as indicated on the order confirmation. The goods are transported at the risk of the customer, including when sold free port and transported using Rototec vehicles. Destinations of goods other than the registered/administrational offices of the company must be indicated at the time of ordering. The contact person and the respective telephone numbers to call at the time of delivery must also be indicated. The buyer is also responsible for ensuring that all the requirements for receiving and unloading the goods have been met. Rototec will not be held liable for damage occurring during the transport of the goods, as a result of which their condition must be verified on receipt. Any claims or disputes arising from product defects must be made immediately on unloading and must be reported on the delivery note, and then sent to Rototec via fax or e-mail in order that the company can take the necessary action. The delivery times indicated in the offer and on the order confirmation are purely indicative. Under no circumstances can any delays in delivery lead to the payment of damages or cancellation, even partial, of the contract, that is unless these conditions have been expressly accepted by the company at the time of contract signing or order confirmation. In all cases, delivery time and organisation of the shipment will be undertaken with the due care and in line with experience, with communication to the customer when the goods are ready for shipment.

**Guarantee** Rototec guarantees that all materials fully comply with the characteristics and conditions specified in the order confirmation and in the certificates/technical data sheet issued by the technical office. Rototec will not be held liable for applications, installation, inspections or any operations undertaken at the buyer's premises or installation site. Any products with defects resulting from carelessness, incompetence or negligence during use or due to incorrect installation or maintenance by unauthorised or unqualified personnel, or damage caused as a result of circumstances that cannot be traced back to fabrication defects, are not covered by the guarantee. Rototec will not be held liable for injury or damage either directly or indirectly deriving from incorrect installation, use or maintenance of the products sold. Rototec products are supplied with technical data sheets, certification in accordance with current legislation and installation and maintenance instructions developed with the due care and know-how. The customer is informed when the goods are ready for shipment.

**Force majeure** In cases of force majeure and any other provided for by law, including red alerts, mobilisation, war, fire, occupation of works, etc. or any other impediment that is not the fault of Rototec, the buyer does not have any right to receive damages, compensation or reimbursement and must, where requested, pay for any finished or partly finished products.

**Competent court** The buyer agrees that any disputes relating to the application, interpretation and execution of this contract fall within the jurisdiction of the Urbino Law Courts.

The data reported in this catalogue is purely indicative and for information purposes only. ROTOTEC reserves the right to modify or improve the products illustrated without prior notification. ROTOTEC can make its technical office available for the design and realisation of customised products and/or for satisfying the particular needs of its clientèle. Dimensional tolerance  $\pm 3\%$ , capacity tolerance  $\pm 5\%$ .



**SEWAGE TREATMENT DIVISION**



**WATER DIVISION**



**INFINITANK**



**Rototec S.p.a.**  
via dell'Artigianato, 6  
61026 Lunano (PU)  
tel. (+39) 0722 7228  
fax (+39) 0722 70599

**www.rototec.it**  
info@rototec.it

Rototec S.p.A. is a company  
belonging to the  
**SYSTEM  
GROUP**  
www.tubi.net

