



PETERSEN
STAINLESS RIGGING LTD



WIRE & ROD TURNBUCKLES & TERMINATIONS FOR SAILING YACHTS



CONTENTS

COMPANY OVERVIEW

STAINLESS STEEL WIRE ROPE & NITRONIC 50 ROD

Nitronic 50 Straightened and Polished Rod
Construction 1X19
Construction Compacted Strand 1X7
Construction Compacted Strand 1X19
Construction Compacted Strand 1X36
Construction Compacted Strand 1X31
Construction 7X7
Construction 7X19
Metric Swaging Diameters

STAINLESS STEEL SWAGE FITTINGS

Stainless Steel Swage Terminal Machined Swage Eyes
Stainless Steel Swage Terminal Forged Swage Eye
Stainless Steel Swage Terminal Swage Strap Toggle
Stainless Steel Swage Terminal Swage Fork
Stainless Steel Swage Terminal Swage Stud RH & LH
with Imperial Threads
Stainless Steel Swage Terminal Swage Stud RH & LH w
with Metric Threads
Stainless Steel Swage Terminal Swage Shackle Toggle
Stainless Steel Mast Terminal Stemball
Stainless Steel Mast Terminals Shroud
Stainless Steel Mast Swage Tee Terminals
Stainless Steel Mast Terminal for Chord
Stainless Steel Swage Mast Backing Plates

STAINLESS STEEL COMPRESSION FITTINGS

Swageless Compression Terminal Eye End
Swageless Compression Terminal Fork End
Swageless Compression Terminal Toggle End
Swageless Compression Terminal Threaded End -
Imperial Threads
Swageless Compression Terminal Extenders
Swageless Compression Terminal In-Line Links
Compression Cones
Crown Rings

03 TURNBUCKLES AND RIGGING SCREWS

- 05 Turnbuckle Bodies Open And Closed Design
06 Turnbuckles GT Body With Swage Stud And Toggle
06 Turnbuckles GT Body With Compression Stud And Toggle
06 Turnbuckles GT Body With Swage Stud And Eye
06 Turnbuckles GT Body With Swage Stud And Stemball
06 Turnbuckles GT Body With Toggle And Fork
06 Turnbuckles GT Body With Fork And Eye
06 Turnbuckles GT Body With Toggle Blank
07 Rigging Screw Closed Body With Stud And Toggle
07 Rigging Screw Closed Body With Compression Stud
and Toggle
08 Rigging Screw Closed Body With Stud And Fork
08 Rigging Screw Closed Body With Stud And Eye
08 Rigging Screw Closed Body With Fork And Toggle
09 Rigging Screw Closed Body With Fork And Eye
09 Rigging Screw Closed Body With Eye And Eye

10 COMPONENTS

- 11 Stainless Steel Thread Eye Threaded Terminals -
Eye Studs RH & LH
12 Stainless Steel Thread Fork Threaded
Terminals - Fork Studs RH & LH
13 Stainless Steel Thread Toggle Threaded
Terminals - Stud Studs RH & LH
14 Stainless Steel Shackle Toggle Threaded Terminals -
Shackle Toggle Studs RH & LH
Threaded Shroud Terminals

15 INSULATORS

- 16 Wire Rigging Insulators
17 Rod Rigging Insulators

18 TOGGLES

- 18 Stainless Steel Toggles Double Jaw Toggles
19 Stainless Steel Toggles Eye Jaw Toggles
19 Stainless Steel Toggles Bar Toggles

20 GUARD RAIL FITTINGS, PINS & SPARES

- 21 Stainless Steel Clevis Pin Including Split Pins and Split Rings
22 Stainless Steel Nut Round Locking Nuts And
Hexagonal Locking Nuts
23 Stainless Steel Grade 316 Halyard Cleat
24 Stainless Steel Grade 316 Lacing Eyes
24 Stainless Steel Grade 316 Boat Rings
24 Stainless Steel Thimbles
25 Wire Rope Clips - Stainless Steel 316
26 Guard Rail/ Life Line Studs, Pelican Hooks and Gate Eyes

27 ROD RIGGING FITTINGS

- 27 Rod Caps
28 Rod Marine Eye Assemblies
28 Rod Studs
29 Rod Terminal Toggle End
30 316L Rod Stemball
30 Rod Shroud Terminals
30 Super Duplex Rod Stemball
31 Rod Nose
32 316L Spreader Bend
32 Tip Turnbuckle
32 Tip Cups

33 SHACKLES

- 33 Shackle Pin Types
33 Marine Shackles High Resistance Shackles
33 Marine Shackles Retained Shake Proof Pins and
Socket Head Pin Shackle
34 Marine Shackles Stainless Steel 316 Bow
35 Marine Shackles Stainless Steel 316 D and Wide D
35 Marine Shackles Stainless Steel 316 Long D and Twist
35 Marine Shackles Stainless Steel 316 Twist

36 TERMS & CONDITIONS

- 37 54

THE COMPANY WAS ORIGINALLY FOUNDED IN BERGEN, NORWAY IN THE EARLY 1900S AS AN ENGINEERING BLACKSMITH SERVING THE MARINE AND AGRICULTURAL INDUSTRIES. AFTER DEVELOPING THE SPECIALISATION IN STAINLESS STEEL THE BUSINESS WAS RELOCATED TO ENGLAND IN 1978. AT THIS POINT IN TIME PETERSEN OFFERED A STANDARD RANGE OF STAINLESS STEEL FITTINGS AND SHACKLES FOR MARINE AND INDUSTRIAL USES. THROUGH SPECIALISING IN THE TURNING, UPSETTING AND FORMING OF STAINLESS STEEL BAR, A WIDE VARIETY OF PRODUCTS TO CUSTOMER SPECIFICATION WERE MANUFACTURED FOR USE IN OTHER INDUSTRIES.

Throughout the 1980s the company focused on product development. Supplying stainless steel wire terminals enabled Petersen Stainless Rigging to expand both market and manufacturing capability. The strategy proved to be very successful and consequently prompted the company to move to a large modern manufacturing facility at Blaydon-on-Tyne in 1988.

With a design team focused on finding solutions to problems, product innovation has always formed a strong part of development at Petersen: the Shake-Proof Shackle incorporating the smart-lock pin, the Shackle Toggle for wide chain-plates, the failsafe Hi-MOD backstay insulator, the easy-fit Hi-MOD swageless terminal, and most recently the slim-line and light-weight GT turnbuckle body were all developed after many hours of customer consultation.

The stainless steel hardware business has been a challenging one over the past 20 years as a whole new economics of production and consumption has radically changed the global market. Petersen have steadfastly refused to join the race to the bottom and instead have invested heavily in quality programs, staff training, and production systems to ensure we win the race to the top. We now operate an ISO9001 quality system and are certified to the much more stringent aerospace industry standard AS9100:C. Material certificates and certificates of conformity are always available on request, even after goods have shipped. In the unlikely event we discover a problem with a batch of material we can tell you exactly which invoice it was shipped on to minimise the disruption to your business and your customers.

Our dedication to quality goes far beyond the physical parts we produce. We set targets for and monitor response times to enquiries, on-time deliveries, shipments right-first-time and many other measures to ensure we always give the best possible service.

Petersen operate out of offices in the UK, Sweden, the Netherlands and Malaysia in order to offer the best possible service to our customers regardless of where they are in the world.





STAINLESS STEEL WIRE ROPE & NITRONIC 50 ROD

STAINLESS WIRE ROPES

Petersen Stainless Rigging supply stainless steel wire rope in a variety of different constructions and sizes. Our wire rope is manufactured in Europe from high quality European AISI 316 stainless steel grade 1.4401 polished wire in the fully austenitic condition to give maximum corrosion resistance.

Dimensions and tensile grades conform to EN 12385 and EN 10264 which stipulate tolerances on nominal diameter and minimum tensile strength for wire sizes and minimum breaking forces for strands and ropes. Our stainless steel wire rope can be provided cut to length or as full reels. If you have any requirement for a construction or size not listed in our brochure please do not hesitate to contact us.

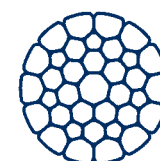
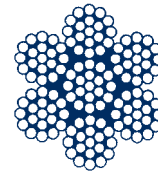
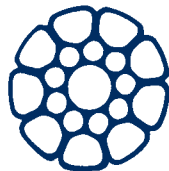
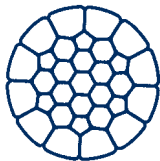

NITRONIC 50 STRAIGHTENED AND POLISHED ROD

PRODUCT CODE	ROD SIZE	D IN (MM)	M.B.L (Kg)	WEIGHT (Kg/m)	STRETCH (MM/MM 1000Kg)
NITRONIC50-04	-4	4.37	2130	0.118	0.003865
NITRONIC50-06	-6	5.03	2860	0.156	0.002916
NITRONIC50-08	-8	5.72	3720	0.202	0.002258
NITRONIC50-10	-10	6.35	4670	0.249	0.001829
NITRONIC50-12	-12	7.14	5670	0.314	0.001448
NITRONIC50-15	-15	7.52	6460	0.349	0.001305
NITRONIC50-17	-17	8.38	7940	0.434	0.001050
NITRONIC50-22	-22	9.53	10200	0.560	0.000813
NITRONIC50-30	-30	11.10	13600	0.761	0.000599
NITRONIC50-40	-40	12.7	17200	0.996	0.000457
NITRONIC50-48	-48	14.27	21800	1.258	0.000362
NITRONIC50-60	-60	16.76	27200	1.735	0.000262

STAINLESS STEEL WIRE ROPE

	CONSTRUCTION 1X19				
	PRODUCT CODE	DIAMETER (MM)	M.B.L (kN)	M.B.L (Kg)	WEIGHT Kg/100m
	WR01(1x19)	1.0	0.87	99	0.49
	WR015(1x19)	1.5	1.86	190	1.11
	WR02(1x19)	2.0	3.30	337	1.98
	WR025(1x19)	2.5	5.15	525	3.10
	WR03(1x19)	3.0	7.42	757	4.46
	WR035(1x19)	3.5	10.10	1,030	6.07
	WR04(1x19)	4.0	13.20	1,350	7.93
	WR05(1x19)	5.0	20.60	2,100	12.40
	WR06(1x19)	6.0	29.70	3,030	17.80
	WR07(1x19)	7.0	37.80	3,850	24.30
	WR08(1x19)	8.0	49.40	5,040	31.70
	WR10(1x19)	10.0	77.20	7,870	49.50
	WR12(1x19)	12.0	104.00	10,600	71.30
	WR14(1x19)	14.0	139.00	14,174	97.10
	WR16(1x19)	16.0	181.00	18,457	127.00
	WR19(1x19)	19.0	233.00	23,751	176.00
	WR22(1x19)	22.0	299.00	30,479	236.00
	WR26(1x19)	26.0	416.00	42,405	330.00



1x7



1x19

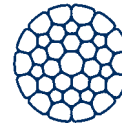

1x36

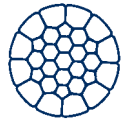

1x31

CONSTRUCTION COMPACTED STRAND 1X7

PRODUCT CODE	DIAMETER (MM)	CONSTRUCTION	M.B.L (kN)	M.B.L (Kg)	WEIGHT Kg/100m
WR02(1x7)-C	2.0	1x7	4.11	440	2.2
WR025(1x7)-C	2.5	1x7	6.76	690	3.4
WR03(1x7)-C	3.0	1x7	9.81	1,000	4.9
WR035(1x7)-C	3.5	1x7	13.33	1,360	6.8
WR04(1x7)-C	4.0	1x7	17.46	1,780	8.8

CONSTRUCTION COMPACTED STRAND 1X19

PRODUCT CODE	DIAMETER (MM)	CONSTRUCTION	M.B.L (kN)	M.B.L (Kg)	WEIGHT Kg/100m
WR04(1x19)-C	4.0	1x19	17.46	1,780	9.1
WR05(1x19)-C	5.0	1x19	25.49	2,600	14.2
WR06(1x19)-C	6.0	1x19	35.29	3,600	20.5
WR07(1x19)-C	7.0	1x19	49.02	5,000	27.9
WR08(1x19)-C	8.0	1x19	61.76	6,300	36.5
WR10(1x19)-C	10.0	1x19	98.04	10,000	57.0
WR12(1x19)-C	12.0	1x19	143.15	14,500	82.1

CONSTRUCTION COMPACTED STRAND 1X36

PRODUCT CODE	DIAMETER (MM)	CONSTRUCTION	M.B.L (kN)	M.B.L (Kg)	WEIGHT Kg/100m
WR14(1x36)-C	14.0	1x36	194.11	19,800	115.0
WR16(1x36)-C	16.0	1x36	253.92	25,900	149.9

CONSTRUCTION COMPACTED STRAND 1X31

PRODUCT CODE	DIAMETER (MM)	CONSTRUCTION	M.B.L (kN)	M.B.L (Kg)	WEIGHT Kg/100m
WR19(1x31)-C	19.0	1x31	313.92	32,000	206



CONSTRUCTION 7X7

PRODUCT CODE	DIAMETER (MM)	M.B.L (kN)	M.B.L (Kg)	WEIGHT Kg/100m
WR01(7x7)	1.0	0.56	57	0.38
WR012(7x7)	1.2	1.13	115	0.50
WR015(7x7)	1.5	1.26	128	0.86
WR018(7x7)	1.8	1.82	186	1.30
WR02(7x7)	2.0	2.24	228	1.54
WR025(7x7)	2.5	3.49	356	2.40
WR03(7x7)	3.0	5.03	513	3.46
WR04(7x7)	4.0	8.94	912	6.14
WR05(7x7)	5.0	14.00	1,430	9.60
WR06(7x7)	6.0	20.10	2,050	13.80
WR07(7x7)	7.0	27.40	2,790	18.80
WR08(7x7)	8.0	35.80	3,650	24.60
WR10(7x7)	10.0	55.90	5,700	38.40
WR012(7x7)	12.0	81.10	8,270	55.30
WR14(7x7)	14.0	109.84	11,200	82.32
WR16(7x7)	16.0	144.16	14,700	107.52
WR18(7x7)	18.0	182.40	18,600	131.32



CONSTRUCTION 7X19

PRODUCT CODE	DIAMETER (MM)	M.B.L (kN)	M.B.L (Kg)	WEIGHT Kg/100m
WR015(7x19)	1.5	1.25	128	0.90
WR02(7x19)	2.0	2.08	212	1.49
WR025(7x19)	2.5	3.26	332	2.33
WR03(7x19)	3.0	4.69	478	3.35
WR035(7x19)	3.5	6.39	652	4.56
WR04(7x19)	4.0	8.34	850	5.95
WR05(7x19)	5.0	13.00	1,330	9.30
WR06(7x19)	6.0	18.80	1,920	13.40
WR07(7x19)	7.0	25.50	2,600	18.20
WR08(7x19)	8.0	33.40	3,410	23.80
WR10(7x19)	10.0	52.10	5,310	37.20
WR12(7x19)	12.0	75.10	7,660	53.60
WR14(7x19)	14.0	102.00	10,100	72.90
WR16(7x19)	16.0	133.00	13,600	95.50

METRIC SWAGING DIAMETERS

WIRE SIZE MM	DIAMETER BEFORE SWAGING	DIAMETER AFTER SWAGING	WIRE SIZE MM	DIAMETER BEFORE SWAGING	DIAMETER AFTER SWAGING
1.6	4.06/3.94	3.50/3.40	12E	20.08/20.00	17.80/17.60
2.5	5.53/5.41	4.82/4.70	14	25.00/24.88	22.23/22.00
3	6.35/6.22	5.58/5.44	16	28.17/28.05	25.40/25.15
4	7.54/7.42	6.35/6.23	19	34.52/34.40	31.75/31.44
5	9.12/9.00	7.95/7.83	22	40.46/40.21	36.50/36.20
5.5	10.84/10.72	9.50/9.35	25	46.02/45.77	41.28/40.97
6	12.54/12.42	11.12/10.95	28	50.0	44.00/44.50
7	14.30/14.18	12.70/12.50	32	58.0	51.00/51.50
8	16.13/16.01	14.30/14.07	36	65.0	57.00/57.80
9-10	17.85/17.73	15.90/15.70	38-40	72.0	63.20/64.00
11	19.83/19.63	17.47/17.27	42 - 44	75.0	66.00/67.00
12	21.44/21.32	19.05/18.82			

SWAGE FITTINGS

SWAGE FITTINGS

Our swaged terminals are all made from European grade 316L stainless steel. We stock sizes from 3mm to 26mm as standard and larger sizes available on request with thread sizes from 1/4" UNF to 1-3/8" UNF. Metric thread swage studs are also available as standard. All our fittings are machined from solid bar or are electrically upset-forged. We do not use any welds. The electrical upsetting process gives beneficial grain structure to eyes, stemballs and t-terminals, minimising internal stress levels to improve fatigue performance. All swaged fittings are supplied with a high quality polished finish. As all of our fittings are made in our UK facility we can provide custom, non-standard fittings quickly and cost effectively. Please contact our sales team with your requirements. Inspection certificates to BS EN 10204 3.1B and certificates of conformity are available on request.

NOTE: Throughout this catalogue we use the following convention – the pin size is the smallest diameter hole that our pin will fit into, the hole size is the largest diameter pin that will fit in the hole. For example if we list a pin as being 12mm then the pin will fit into a 12mm diameter hole and conversely if we list a hole as being 16mm then a 16mm diameter pin will fit in the hole. If in doubt please ask.



STAINLESS STEEL SWAGE TERMINALS MACHINED SWAGE EYES

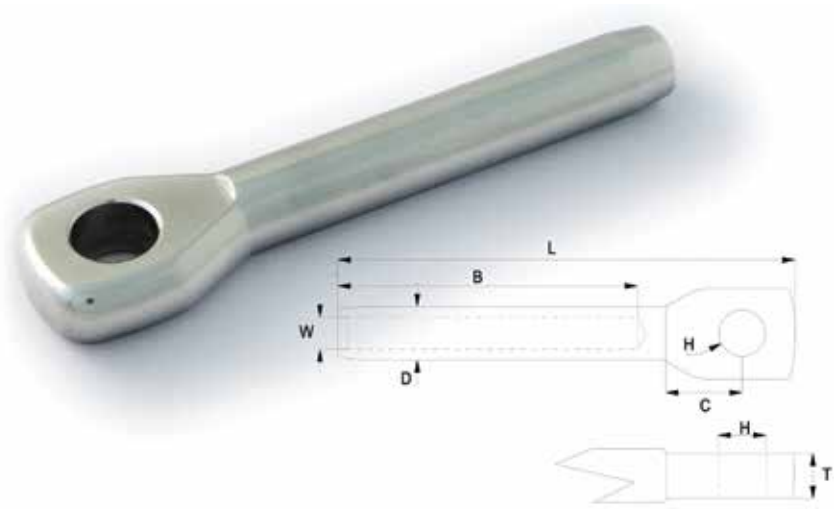

PRODUCT CODE	WIRE	H	B	D	C	T	L	NOMINAL WEIGHT
MSE04	4mm	6.35mm	45mm	7.5mm	14mm	6.5mm	72mm	23g
MSE05	5mm	8.0mm	52mm	9.1mm	17mm	7.8mm	85mm	42g
MSE06	6mm	9.53mm	64mm	12.5mm	20mm	9.5mm	103mm	100g
MSE06US	6mm	11.1mm	64mm	12.5mm	23mm	11.5mm	110mm	109g
MSE07	7mm	12.7mm	70mm	14.3mm	23mm	11.5mm	114mm	129g
MSE08DS	8mm	12.7mm	80mm	16.0mm	23mm	11.5mm	123mm	152g
MSE08	8mm	14.28mm	80mm	16.0mm	24mm	13.5mm	130mm	178g
MSE08US	8mm	16.0mm	80mm	16.0mm	29mm	15mm	134mm	202g
MSE10	10mm	16.0mm	100mm	18.0mm	29mm	15mm	155mm	245g
MSE12	12mm	19.05mm	132mm	21.4mm	34mm	17.5mm	197mm	462g
MSE14	14mm	22.2mm	156mm	25.0mm	40mm	21.5mm	235mm	721g
MSE16	16mm	25.4mm	176mm	28.2mm	46mm	23.5mm	264mm	1090g
MSE16US	16mm	28.6mm	176mm	28.2mm	51mm	27mm	274mm	1430g
MSE19	19mm	28.6mm	210mm	34.5mm	51mm	27.5mm	308mm	1780g
MSE22	22mm	32.0mm	242mm	40.3mm	58mm	31mm	356mm	2704g
MSE26	26mm	35.0mm	290mm	45.9mm	63mm	33.5	414mm	3855g

PRODUCT CODE	WIRE	H	B	D	C	T	OD	L	NOMINAL WEIGHT
FSE03	3mm	6.35mm	39mm	6.3mm	11.0mm	5mm	14.3mm	60mm	12g
FSE04	4mm	8.0mm	45mm	7.5mm	14.0mm	6.5mm	18mm	72mm	24g
FSE05	5mm	9.53mm	52mm	9.1mm	17.0mm	7.8mm	21mm	84mm	36g
FSE06	6mm	11.1mm	64mm	12.5mm	20.0mm	9.5mm	25mm	102mm	82g
FSE07	7mm	12.7mm	70mm	14.3mm	23.0mm	11.5mm	28mm	113mm	120g
FSE08DS	8mm	12.7mm	80mm	16.0mm	23.0mm	11.5mm	28mm	125mm	120g
FSE08	8mm	14.28mm	80mm	16.0mm	24.0mm	13.5mm	32mm	128mm	170g
FSE08US	8mm	16.0mm	80mm	16.0mm	29.0mm	15mm	34mm	136mm	195g
FSE10	10mm	16.0mm	100mm	18.0mm	29.0mm	15mm	34mm	155mm	234g
FSE12	12mm	19.05mm	132mm	21.4mm	34.0mm	17.5mm	42mm	197mm	442g
FSE14	14mm	22.2mm	156mm	25.0mm	40.0mm	21.5mm	48mm	232mm	708g
FSE16	16mm	25.4mm	176mm	28.2mm	46.0mm	23.5mm	58mm	262mm	1005g

STAINLESS STEEL SWAGE TERMINALS FORGED SWAGE EYE

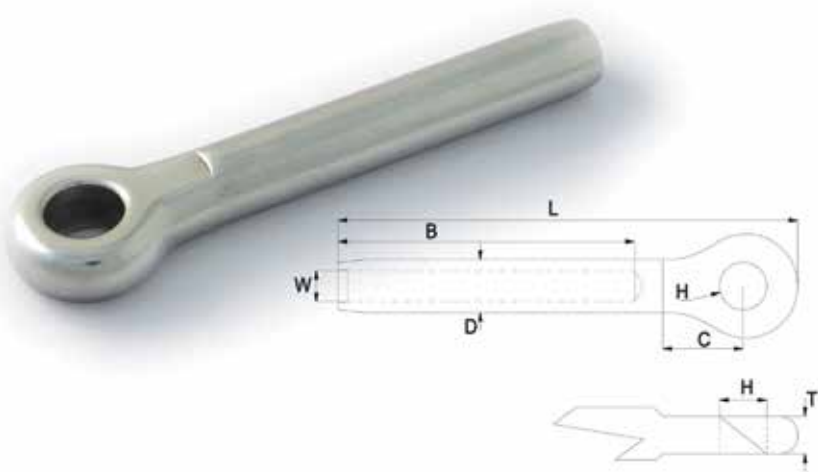

STAINLESS STEEL SWAGE TERMINALS
SWAGE STRAP TOGGLE

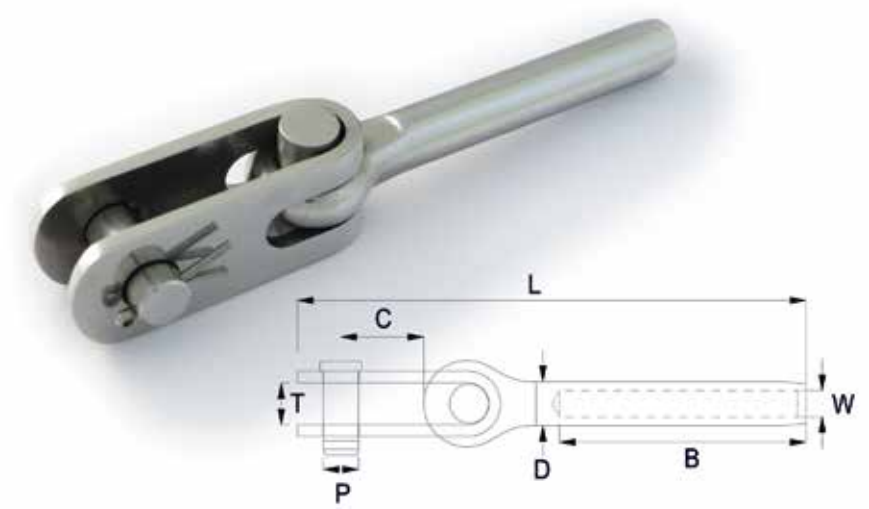

PRODUCT CODE	WIRE	P	D	C	T	B	L	NOMINAL WEIGHT
MST03	3mm	6.0mm	6.3mm	14mm	8mm	39mm	84mm	25g
MST04	4mm	8.0mm	7.5mm	19mm	9mm	45mm	103mm	45g
MST05	5mm	9.5mm	9.1mm	21mm	11mm	52mm	111mm	89g
MST06	6mm	11.0mm	12.5mm	25mm	13mm	64mm	146mm	230g
MST07	7mm	12.7mm	14.3mm	26mm	15mm	70mm	168mm	271g
MST08DS	8mm	12.7mm	16.0mm	26mm	15mm	80mm	169mm	295g
MST10	10mm	16.0mm	18.0mm	38mm	19mm	100mm	212mm	569g
MST12	12mm	19.0mm	21.4mm	38mm	22mm	132mm	278mm	1409g
MST14	14mm	22.0mm	25.0mm	52mm	25mm	156mm	328mm	1912g
MST16	16mm	25.0mm	28.2mm	66mm	28mm	176mm	364mm	2516g
MST19	19mm	28.0mm	34.5mm	68mm	32mm	210mm	430mm	4147g
MST22	22mm	32.0mm	40.3mm	83mm	35mm	242mm	496mm	6039g
MST26	26mm	35.0mm	45.9mm	97mm	38mm	290mm	571mm	8428g

PRODUCT CODE	WIRE	P	D	C	T	B	L	NOMINAL WEIGHT
SF03	3mm	6mm	6.3mm	12.5mm	6.2mm	39mm	70mm	20g
SF04	4mm	8mm	7.5mm	17mm	7.9mm	45mm	83mm	36g
SF05	5mm	9.5mm	9.1mm	19mm	9.9mm	52mm	97mm	64g
SF06	6mm	11mm	12.5mm	22mm	10.9mm	64mm	113mm	142g
SF07	7mm	12mm	14.3mm	25mm	12.7mm	70mm	128mm	172g
SF08DS	8mm	12mm	16.0mm	25mm	12.7mm	80mm	140mm	196g
SF08	8mm	14mm	16.0mm	28mm	13.8mm	80mm	144.5mm	278g
SF10	10mm	16mm	18.0mm	32mm	15.8mm	100mm	174mm	376g
SF12	12mm	19mm	21.4mm	38mm	17.8mm	132mm	227mm	1097g
SF14	14mm	22mm	25.0mm	45mm	22mm	156mm	258mm	1105g
SF16	16mm	25mm	28.2mm	50mm	25mm	176mm	295.5mm	1683g
SF19	19mm	28mm	34.5mm	58mm	28.2mm	210mm	342mm	2580g
SF22	22mm	32mm	40.3mm	64mm	31.8mm	242mm	391mm	3611g
SF26	26mm	35mm	45.9mm	70mm	34.8mm	290mm	451.5mm	5019g

STAINLESS STEEL SWAGE TERMINALS SWAGE FORK

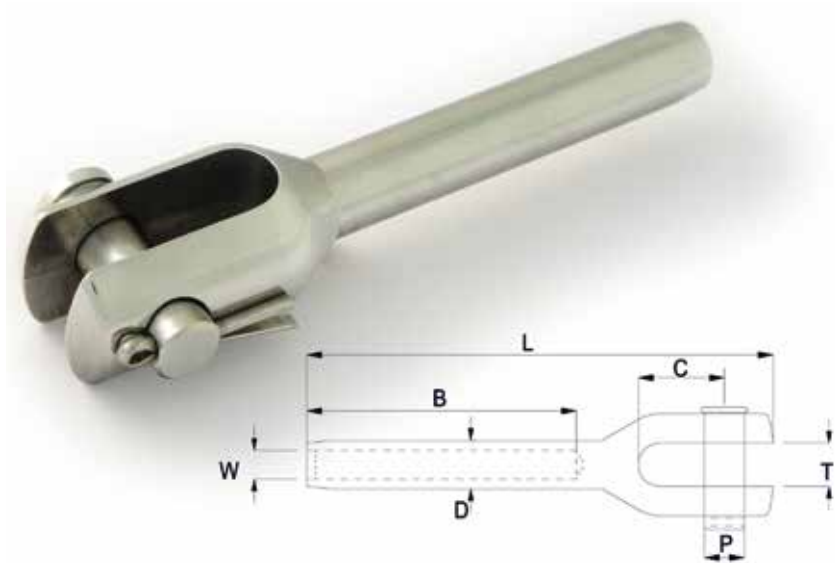

STAINLESS STEEL SWAGE TERMINALS
STUD RH & LH WITH IMPERIAL THREADS

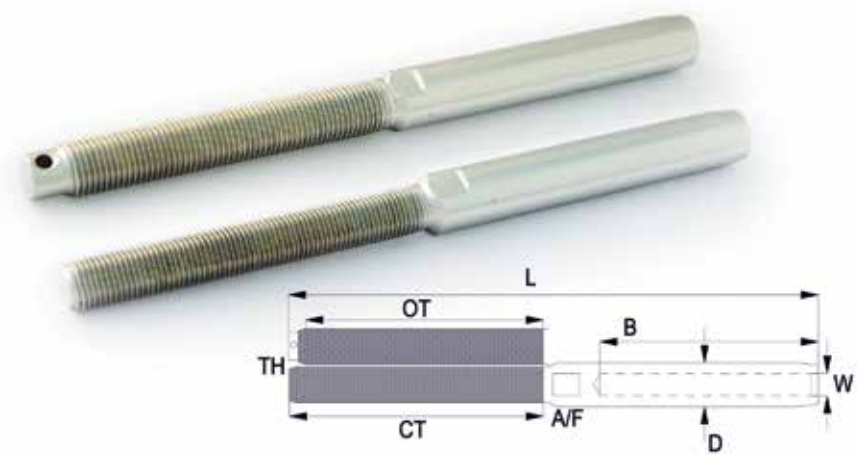

PRODUCT CODE	WIRE	TH	D	B	L	CT	OT	A/F	NOMINAL WEIGHT
S#1/4x025	2.5mm	1/4" unf	6.3mm	39mm	97mm	49mm	45mm	5mm	24g
S#1/4x3	3.0mm	1/4" unf	6.3mm	39mm	97mm	47mm	42mm	5mm	24g
S#1/4x4	4.0mm	1/4" unf	7.5mm	45mm	104mm	47mm	42mm	5mm	30g
S#5/16x4	4.0mm	5/16" unf	7.5mm	45mm	113mm	54mm	49mm	6mm	36g
S#5/16x5	5.0mm	5/16" unf	9.1mm	52mm	123mm	54mm	49mm	6mm	51g
S#3/8x5	5.0mm	3/8" unf	9.1mm	52mm	135mm	68mm	63mm	8mm	60g
S#3/8x6	6.0mm	3/8" unf	12.5mm	64mm	149mm	68mm	63mm	8mm	85g
S#7/16x6	6.0mm	7/16" unf	12.5mm	64mm	154mm	75mm	68mm	11mm	108g
S#7/16x7	7.0mm	7/16" unf	14.3mm	70mm	161mm	75mm	68mm	11mm	130g
S#1/2x8	8.0mm	1/2" unf	16.0mm	80mm	190mm	90mm	83mm	14mm	196g
S#5/8x10	10.0mm	5/8" unf	18.0mm	100mm	223mm	100mm	93mm	16mm	306g
S#3/4x12	12.0mm	3/4" unf	21.4mm	132mm	277mm	120mm	111mm	19mm	550g
S#7/8x14	14.0mm	7/8" unf	25.0mm	156mm	325mm	140mm	130mm	22mm	874g
S#1x16	16.0mm	1" unf	28.2mm	176mm	369mm	160mm	150mm	25mm	1275g
S#11/8x19	19.0mm	1 1/8" unf	34.5mm	210mm	425mm	180mm	168mm	28mm	2050g
S#11/4x19	19.0mm	1 1/4" unf	34.5mm	210mm	445mm	200mm	188mm	28mm	2512g
S#11/4x22	22.0mm	1 1/4" unf	40.3mm	242mm	482mm	200mm	188mm	32mm	3200g
S#13/8x26	26.0mm	1 3/8" unf	45.9mm	290mm	557mm	220mm	208mm	36mm	4000g

Replace # with C for closed body style or O for open style. Suffix R or L for right or left hand thread.

PRODUCT CODE	WIRE	TH	D	B	L	CT	A/F	NOMINAL WEIGHT
SCM6x3	3mm	M6	6.3mm	39mm	97mm	47mm	5mm	24g
SCM6x4	4mm	M6	7.5mm	45mm	105mm	47mm	6mm	33g
SCM8x4	4mm	M8	7.5mm	45mm	113mm	54mm	6mm	36g
SCM8x5	5mm	M8	9.1mm	52mm	122mm	54mm	8mm	54g
SCM10x5	5mm	M10	9.1mm	52mm	135mm	68mm	8mm	60g
SCM10x6	6mm	M10	12.5mm	64mm	154mm	75mm	11mm	108g
SCM12x6	6mm	M12	12.5mm	64mm	170mm	90mm	11mm	119g
SCM12x7	7mm	M12	14.3mm	70mm	177mm	90mm	12mm	162g
SCM12x8	8mm	M12	16.0mm	80mm	190mm	90mm	14mm	196g
SCM14x8	8mm	M14	18.0mm	80mm	190mm	92mm	14mm	211g
SCM16x8	8mm	M16	16.0mm	80mm	201mm	100mm	14mm	260g
SCM16x10	10mm	M16	18.0mm	100mm	223mm	100mm	16mm	306g
SCM20x12	12mm	M20	21.4mm	132mm	277mm	120mm	19mm	550g
SCM22x14	14mm	M22	25.0mm	156mm	325mm	140mm	22mm	874g
SCM27x16	16mm	M27	28.2mm	176mm	371mm	160mm	25mm	1275g
SCM30x20	20mm	M30	34.6mm	210mm	427mm	184mm	30mm	1460g

STAINLESS STEEL SWAGE TERMINALS
STUD RH & LH WITH METRIC THREADS

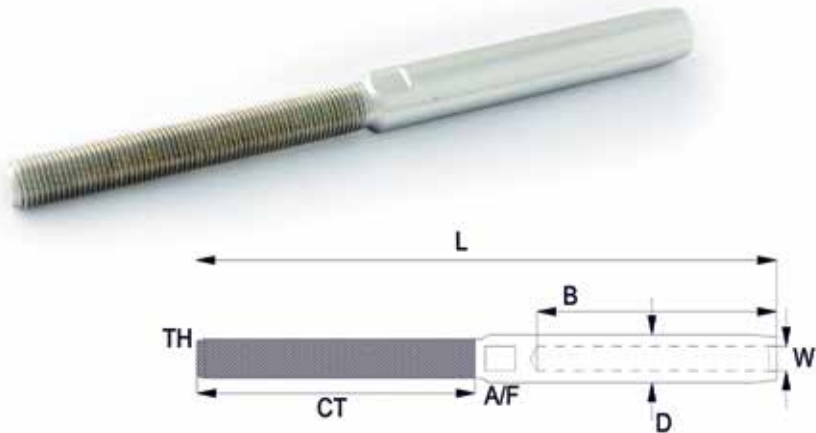

STAINLESS STEEL SWAGE TERMINALS SWAGE SHACKLE TOGGLE

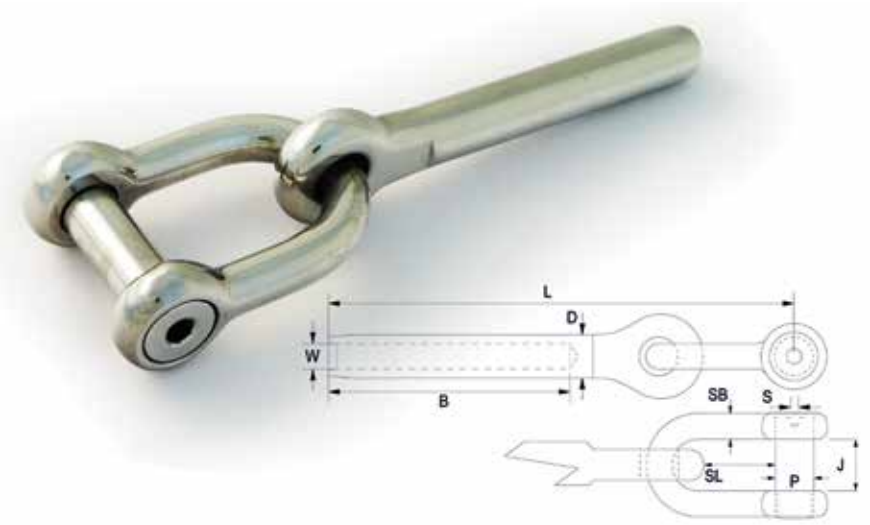

PRODUCT CODE	WIRE	P	D	B	SB	SL	S	J	L	NOMINAL WEIGHT
SST03	3mm	6.0mm	6.3mm	39mm	5.0mm	14mm	3mm	14mm	82mm	25g
SST04	4mm	8.0mm	7.5mm	45mm	6.0mm	16mm	4mm	20mm	101mm	48g
SST05	5mm	9.5mm	9.1mm	52mm	8.0mm	22mm	4mm	22mm	118mm	89g
SST06	6mm	11.0mm	12.7mm	64mm	9.5mm	27mm	5mm	25mm	141mm	179g
SST07	7mm	12.7mm	14.3mm	70mm	11.0mm	32mm	5mm	27mm	158mm	273g
SST08	8mm	14.0mm	16.0mm	80mm	12.7mm	36mm	5mm	29mm	179mm	407g
SST10	10mm	16.0mm	18.0mm	100mm	14.3mm	42mm	6mm	29mm	216mm	684g
SST12	12mm	19.0mm	21.4mm	132mm	16.0mm	45mm	6mm	32mm	263mm	1027g
SST14	14mm	22.0mm	25.0mm	156mm	19.0mm	63mm	8mm	38mm	309mm	1508g
SST16	16mm	25.4mm	28.2mm	176mm	22.0mm	63mm	8mm	45mm	351mm	2525g

All Hi-MOD products are produced to a high degree of quality control, using modern lean manufacturing processes, resulting in a reliable and consistent product. Unique to Petersen Stainless Rigging.

PRODUCT CODE	WIRE	D	B	W	R	SD	CD
SB03-065	3mm	12.5mm	39mm	3.4mm	6.4mm	6.3mm	6.8mm
SB04-090	4mm	17.0mm	45mm	4.4mm	8.9mm	7.5mm	8mm
SB05-090	5mm	17.0mm	52mm	5.4mm	8.9mm	9.1mm	9.7mm
SB05-110	5mm	21.0mm	52mm	5.4mm	10.9mm	9.1mm	9.7mm
SB06-110	6mm	21.0mm	64mm	6.5mm	10.9mm	12.5mm	13.4mm
SB07-110	7mm	21.0mm	70mm	7.5mm	10.9mm	14.3mm	15.3mm
SB07-140	7mm	27.0mm	70mm	7.5mm	13.9mm	14.3mm	15.3mm
SB08-140	8mm	27.0mm	80mm	8.5mm	13.9mm	16.1mm	17.3mm
SB10-160	10mm	31.0mm	100mm	10.6mm	15.8mm	17.8mm	19.1mm
SB12-180	12mm	35.0mm	132mm	12.8mm	17.8mm	21.4mm	23mm

STAINLESS STEEL MAST TERMINALS STEMBALL TERMINALS

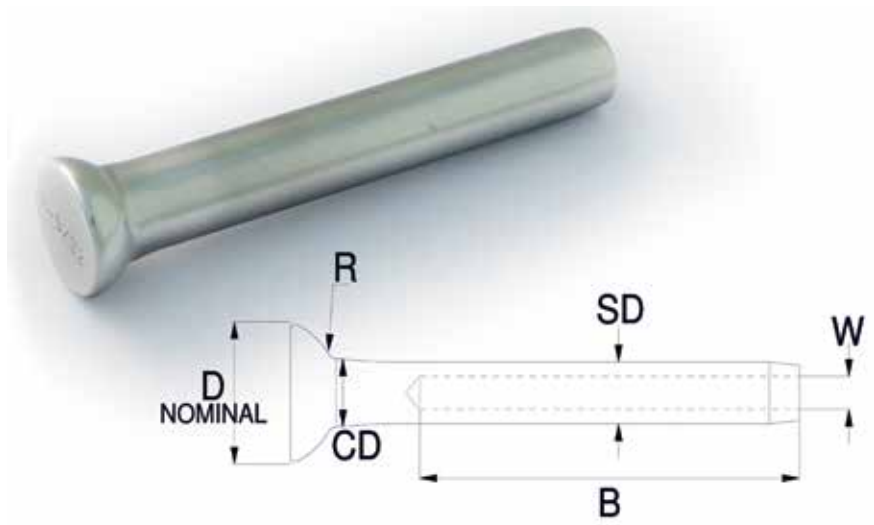

STAINLESS STEEL MAST TERMINALS SHROUD TERMINALS

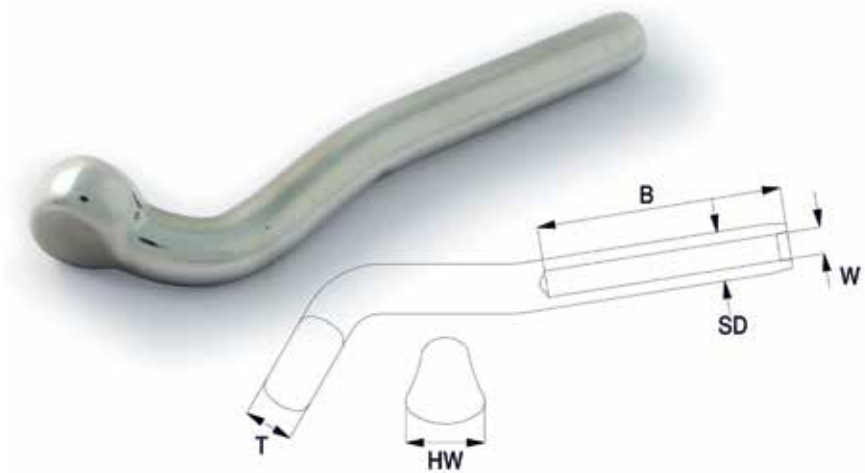

PRODUCT CODE	WIRE	T	B	W	SD	HW
SH03	3mm	6.3mm	39mm	3.4mm	6.3mm	12mm
SH04	4mm	7.5mm	45mm	4.4mm	7.5mm	16mm
SH05	5mm	9.1mm	52mm	5.4mm	9.1mm	19mm
SH06	6mm	12.5mm	64mm	6.5mm	12.5mm	22mm
SH07	7mm	14.3mm	70mm	7.5mm	14.3mm	28mm
SH08	8mm	16.0mm	80mm	8.5mm	16.0mm	30mm
SH10	10mm	17.8mm	100mm	10.6mm	18.0mm	32mm
SH11	11mm	20.0mm	136mm	11.0mm	20.0mm	38mm
SH12	12mm	21.4mm	132mm	12.8mm	21.4mm	38mm

PRODUCT CODE	WIRE	T	B	W	SD	HW
STT03	3mm	6.3mm	39mm	3.4mm	6.3mm	16.6mm
STT04	4mm	9.0mm	45mm	4.4mm	7.5mm	17.5mm
STT05	5mm	11.1mm	52mm	5.4mm	9.1mm	20mm
STT06	6mm	14.3mm	64mm	6.5mm	12.5mm	28mm
STT07	7mm	14.3mm	70mm	7.5mm	14.3mm	28mm
STT08	8mm	17.8mm	80mm	8.5mm	16.1mm	32mm
STT10	10mm	17.8mm	100mm	10.6mm	17.8mm	32mm

STAINLESS STEEL MAST SWAGE TEE MAST TERMINALS

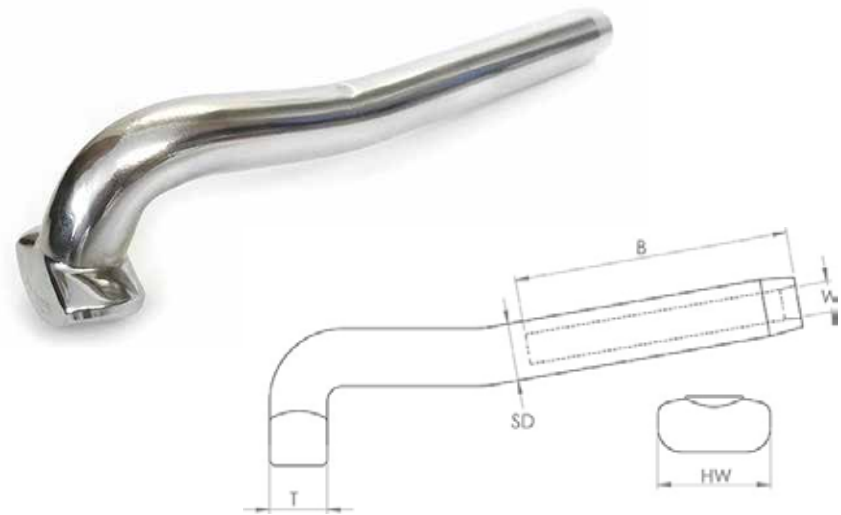

STAINLESS STEEL MAST TERMINAL FOR CHORD

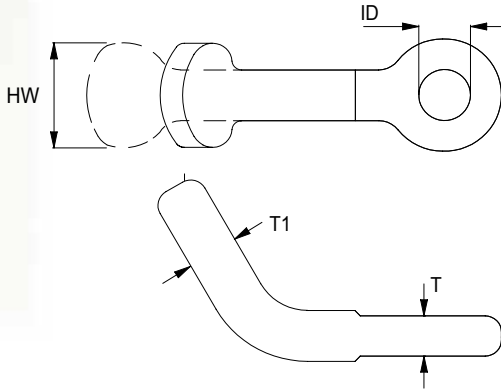

PRODUCT CODE	ROPE SIZE	BACKING PLATE	T	T1	HW	ID
MFFC03	3mm	3mm	5.0mm	6.35mm	16.6mm	7.5mm
MFFC05	4mm	4mm	8.0mm	9.0mm	17.5mm	9.5mm
MFFC07	5/6mm	7mm	12.0mm	14.3mm	28.0mm	13.5mm
MFFC10	7/8mm	10mm	16.0mm	17.8mm	32.0mm	17.5mm

PRODUCT CODE	L	W	H	NO. OF RIVETS	MAST HOLE SIZE	SWAGE SHROUD PART CODE
SBP-08	120mm	39.7mm	6.6mm	3	40.2mm	SH08
SBP-10	150mm	44.2mm	6.6mm	4	44.7mm	SH10
SBP-12	177mm	51.3mm	6.6mm	5	51.8mm	SH12

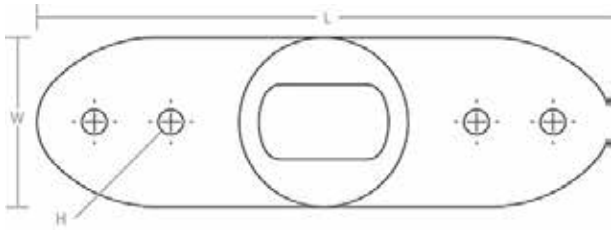

Number and positioning of rivet holes vary by size

MAST BACKING PLATES



COMPRESSION FITTINGS

COMPRESSION FITTINGS

Hi-MOD compression fittings are at least as strong as the rated breaking load of the wire rope. The unique star shaped Crown Ring positions and holds the wires in place, eliminating the requirement for awkward wire end bending. The shallow-angled cone establishes direct mechanical grip on the core and all the outer strands. Stainless steel grade EN10088 1.4404 (316L) is used on all parts with the exception of the Crown Ring which is manufactured from Aluminium Bronze so no sealant required.

Fittings are available for 7 strand and Compacted-strand wire ropes as well as 1x7 and 1x19. Because of their design, Hi-MOD compression fittings can be assembled on compacted-strand ropes as easily as any other construction of wire without the need for forming tools and long handled spanners.

The Hi-MOD compression fitting is supplied in a retail-pack with assembly instructions unless requested otherwise at time of order.

SPECIAL FEATURES OF THE PETERSEN STAINLESS RIGGING COMPRESSION FITTING.

Special Star Shaped Crown Ring holds wire strands in place, preventing awkward 'wire end bending'. Crown Ring prevents wire strands from being trapped in cone slots. Works equally well with Right or Left hand lay wire. Shallow angle on cone establishes more direct mechanical contact over a greater area providing a tighter grip. Can be dismantled for maintenance and re-used without the need for new parts. All parts are re-usable providing that no overloading has occurred.

There are three main reasons why we recommend that you do not use sealant:

Regardless of how much sealant and pressure you apply to the terminal, we do not believe that you will completely fill the cavity, thus leaving a small air pocket which will get some water in it (usually somewhere near the centre of the cable where it is difficult to get at). Stainless Steel is protected by a very thin chrome-oxide

layer. If the oxide layer becomes damaged it needs more oxygen to replenish that layer. Any water that makes its way in past the sealant will become stale (oxygen depleted) over time. It is safer to allow fresh water into the terminal on a regular basis which will not only clean and wash away any built up salt residues but will also maintain the oxide layer of the stainless steel.

The main mechanical components of the compression fittings are manufactured from stainless steel grade 316L. This material has high anti-corrosive properties and is ideal for use in a constant sea-water environment. The design of the terminal and its components has been developed in such a way that it is acceptable to use this material. Other designs of this type of terminal may not benefit from these design features.

The design of the compression terminal is such that you can dismantle the terminal at any time allowing you to inspect and clean the internal components. If you use a sealant, it would make this operation very difficult and you may not be able to see all of the inner components properly.



SWAGELESS COMPRESSION TERMINAL EYE END

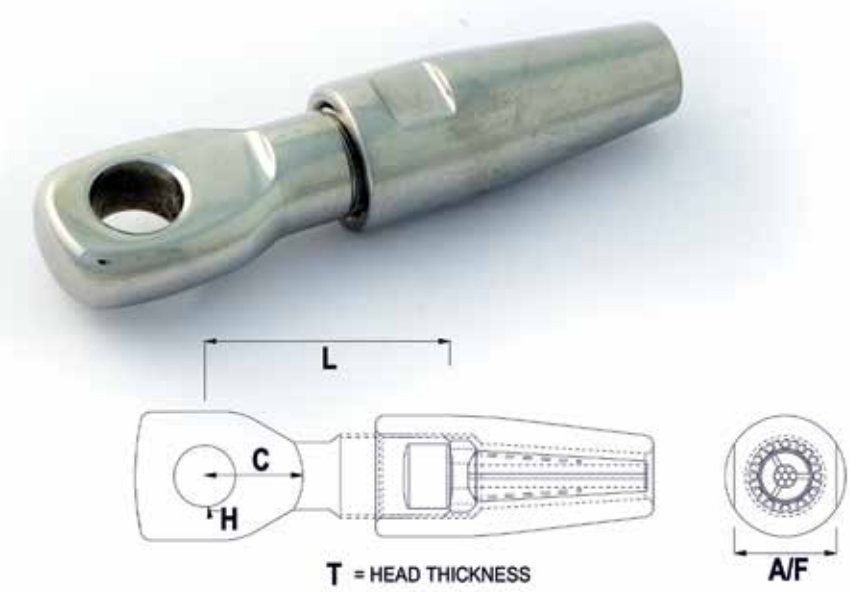

PRODUCT CODE	WIRE	H	C	L	T	A/F	NOMINAL WEIGHT
CTE03	3mm	6.35mm	11mm	22mm	5.0mm	9.5mm	21g
CTE04	4mm	8.0mm	14mm	28mm	6.5mm	11.0mm	39g
CTE04US	4mm	9.53mm	16mm	36mm	7.8mm	14.0mm	60g
CTE05	5mm	9.53mm	17mm	32mm	7.8mm	14.0mm	65g
CTE06	6mm	11.1mm	20mm	38mm	9.5mm	17.0mm	126g
CTE06US	6mm	12.7mm	23mm	43mm	11.5mm	17.0mm	140g
CTE07	7mm	12.7mm	23mm	45mm	11.5mm	20.0mm	165g
CTE08DS	8mm	12.7mm	23mm	48mm	11.5mm	22.0mm	235g
CTE08	8mm	14.28mm	24mm	52mm	13.5mm	22.0mm	355g
CTE08US	8mm	16.0mm	29mm	56mm	15.0mm	22.0mm	390g
CTE10	10mm	16.0mm	29mm	59mm	15.0mm	26.0mm	462g
CTE10US	10mm	19.05mm	34mm	65mm	17.5mm	26.0mm	600g
CTE11	11mm	19.05mm	34mm	65mm	17.5mm	26.0mm	600g
CTE12	12mm	19.05mm	34mm	79mm	17.5mm	32.0mm	912g
CTE14	14mm	22.2mm	40mm	86mm	21.5mm	36.0mm	1344g
CTE16	16mm	25.4mm	46mm	94mm	23.5mm	40.0mm	1867g
CTE19	19mm	28.58mm	51mm	98mm	27.5mm	44.0mm	2227g
CTE22	22mm	32.0mm	58mm	108mm	31.0mm	52.0mm	3440g
CTE26	26mm	35.0mm	63mm	144mm	33.5mm	64.0mm	5575g

Suffix -C after product code for compacted strand wire or -7 for 7x7 strand wire.

PRODUCT CODE	WIRE	P	C	T	L	A/F B	NOMINAL WEIGHT
CTF03	3mm	6mm	12.5mm	6.2mm	30mm	9.5mm	29g
CTF04	4mm	8mm	17mm	7.9mm	40mm	11mm	60g
CTF05	5mm	9.5mm	19mm	9.9mm	47mm	14mm	103g
CTF06	6mm	11mm	22mm	10.9mm	50mm	19mm	159g
CTF07	7mm	12mm	25mm	12.7mm	58mm	20mm	239g
CTF08DS	8mm	12mm	25mm	12.7mm	63mm	22mm	323g
CTF08	8mm	14mm	28mm	13.8mm	70mm	22mm	395g
CTF08US	8mm	16mm	32mm	15.8mm	72mm	22mm	490g
CTF10	10mm	16mm	32mm	15.8mm	78mm	26mm	542g
CTF12	12mm	19mm	38mm	17.8mm	93mm	32mm	918g
CTF14	14mm	22mm	45mm	22mm	106mm	36mm	1464g
CTF16	16mm	25mm	50mm	25mm	126mm	40mm	2125g
CTF19	19mm	28mm	58mm	28.2mm	133mm	44mm	2616g
CTF22	22mm	32mm	64mm	31.8mm	146mm	52mm	3890g
CTF26	26mm	35mm	70mm	34.8mm	167mm	64mm	6393g

Suffix -C after product code for compacted strand wire or -7 for 7x7 strand wire.

SWAGELESS COMPRESSION TERMINAL FORK END

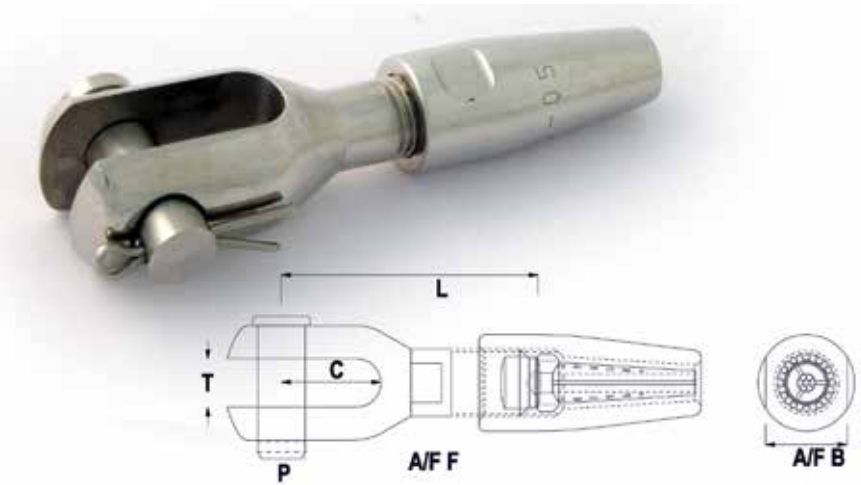

SWAGELESS COMPRESSION TERMINAL TOGGLE END

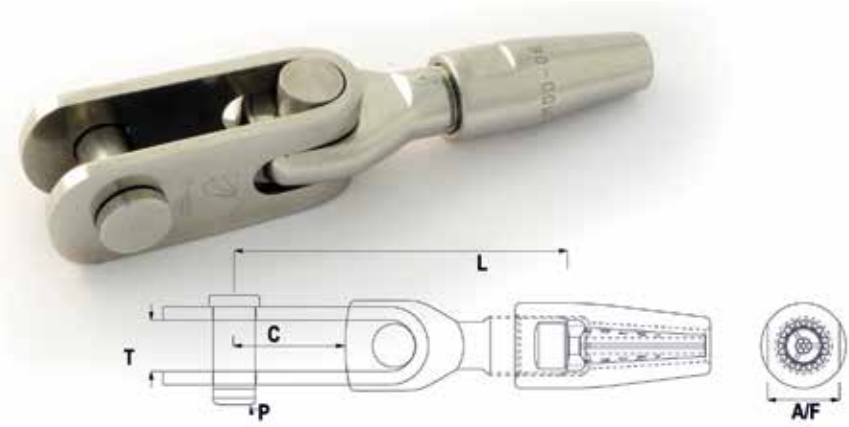

PRODUCT CODE	WIRE	P	C	T	L	A/F	NOMINAL WEIGHT
CTT03	3mm	6.0mm	14mm	8mm	45mm	9.5mm	37g
CTT04	4mm	8.0mm	20mm	9mm	53mm	11mm	71g
CTT05	5mm	9.5mm	21mm	11mm	64mm	14mm	125g
CTT06	6mm	11mm	25mm	13mm	78mm	19mm	258g
CTT07	7mm	12.7mm	27mm	15mm	89mm	20mm	327g
CTT08DS	8mm	12.7mm	27mm	15mm	92mm	22mm	397g
CTT08US	8mm	16mm	38mm	19mm	116mm	22mm	700g
CTT10	10mm	16mm	38mm	19mm	116mm	26mm	800g
CTT12	12mm	19mm	44mm	22mm	157mm	32mm	1242g
CTT14	14mm	22mm	53mm	25mm	174mm	36mm	2302g
CTT16	16mm	25mm	63mm	28mm	194mm	40mm	3037g
CTT19	19mm	28mm	67mm	32mm	215mm	44mm	4280g
CTT22	22mm	32mm	83mm	35mm	235mm	52mm	6518g
CTT26	26mm	35mm	97mm	38mm	296mm	64mm	9591g

Suffix -C after product code for compacted strand wire or -7 for 7x7 strand wire.

PRODUCT CODE	WIRE	THREAD	T	L	A/F S	A/F B	NOMINAL WEIGHT
CTS03	3mm	1/4" unf	47mm	68mm	6mm	9.5mm	24g
CTS04DS	4mm	1/4" unf	47mm	68mm	8mm	11mm	35g
CTS04	4mm	5/16" unf	54mm	77mm	8mm	11mm	42g
CTS04US	4mm	3/8" unf	68mm	87mm	8mm	11mm	58g
CTS05DS	5mm	5/16" unf	54mm	82mm	9mm	14mm	65g
CTS05	5mm	3/8" unf	68mm	91mm	9mm	14mm	75g
CTS05US	5mm	7/16" unf	75mm	97mm	9mm	14mm	85g
CTS06DS	6mm	3/8" unf	68mm	97mm	11mm	17mm	110g
CTS06	6mm	7/16" unf	75mm	101mm	11mm	17mm	130g
CTS06US	6mm	1/2" unf	90mm	119mm	11mm	17mm	145g
CTS07	7mm	1/2" unf	90mm	121mm	14mm	20mm	199g
CTS08DS	8mm	1/2" unf	90mm	129mm	16mm	22mm	297g
CTS08	8mm	5/8" unf	100mm	137mm	16mm	22mm	347g
CTS10	10mm	5/8" unf	100mm	143mm	17mm	26mm	458g
CTS10US	10mm	3/4" unf	120mm	163mm	19mm	26mm	790g
CTS11	11mm	3/4" unf	120mm	163mm	19mm	26mm	790g
CTS12	12mm	3/4" unf	120mm	173mm	22mm	32mm	892g
CTS14	14mm	7/8" unf	140mm	201mm	24mm	36mm	1379g
CTS16	16mm	1" unf	160mm	232mm	28mm	40mm	1970g
CTS19	19mm	1 1/8" unf	180mm	250mm	32mm	44mm	2699g
CTS22	22mm	1 1/4" unf	200mm	277mm	36mm	52mm	4240g
CTS26	26mm	1 3/8" unf	220mm	320mm	44mm	64mm	6675g

Suffix -C after product code for compacted strand wire or -7 for 7x7 strand wire.

SWAGELESS COMPRESSION TERMINAL THREADED END
- IMPERIAL THREADS

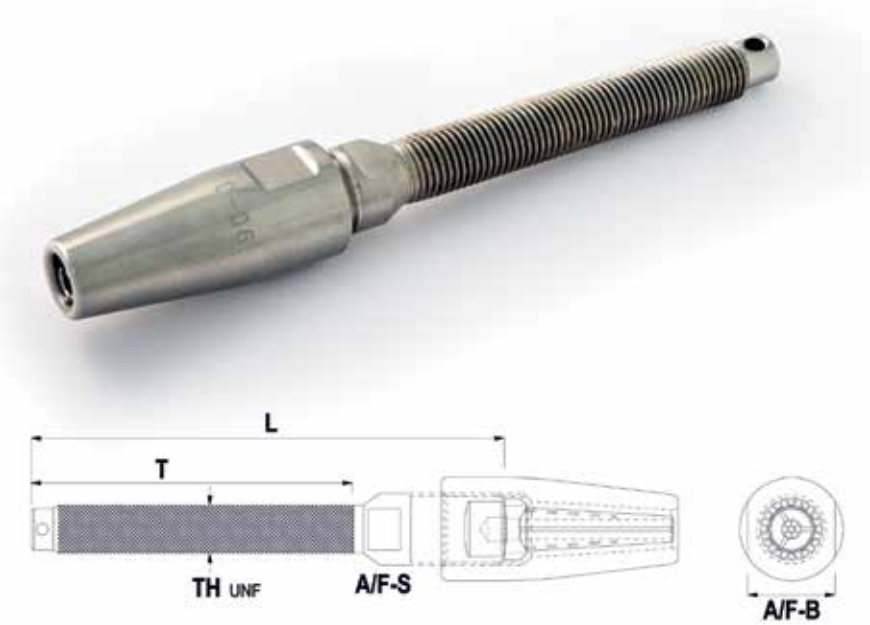

SWAGELESS COMPRESSION TERMINAL EXTENDERS

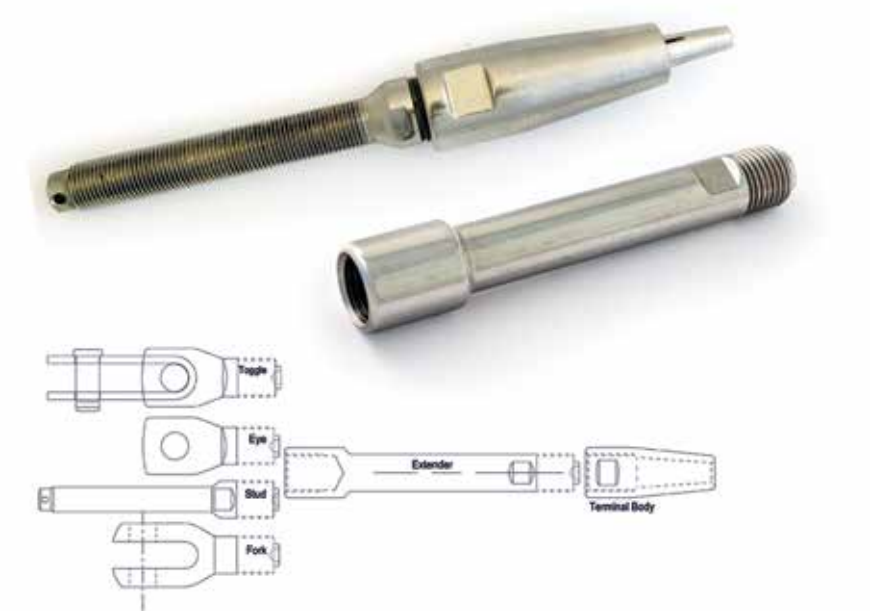

PRODUCT CODE	WIRE	EXT	A/F L	A/F S	OD	NOMINAL WEIGHT
CTX03	3mm	45mm	6mm	9.5mm	11mm	24g
CTX04	4mm	60mm	8mm	11mm	13mm	39g
CTX05	5mm	75mm	9mm	14mm	16mm	100g
CTX06	6mm	90mm	11mm	17mm	19mm	131g
CTX07	7mm	105mm	13mm	20mm	22mm	207g
CTX08	8mm	120mm	16mm	22mm	26mm	311g
CTX10	10mm	150mm	17mm	26mm	30mm	536g
CTX12	12mm	180mm	22mm	32mm	39mm	1023g
CTX14	14mm	210mm	24mm	36mm	44mm	1637g
CTX16	16mm	240mm	28mm	40mm	48mm	2136g
CTX19	19mm	285mm	32mm	44mm	51mm	2807g
CTX22	22mm	330mm	34mm	52mm	57mm	4098g
CTX26	26mm	390mm	44mm	64mm	77mm	8591g

PRODUCT CODE	WIRE	WD	A/F L	A/F S	OD	NOMINAL WEIGHT
CTL03	3mm	26mm	6mm	9.5mm	11mm	10g
CTL04	4mm	27mm	8mm	11mm	13mm	14g
CTL05	5mm	33mm	9mm	14mm	16mm	24g
CTL06	6mm	35mm	11mm	17mm	19mm	43g
CTL07	7mm	43mm	13mm	20mm	22mm	63g
CTL08	8mm	55mm	16mm	22mm	26mm	115g
CTL10	10mm	62mm	17mm	26mm	30mm	180g
CTL12	12mm	72mm	22mm	32mm	38mm	350g
CTL14	14mm	85mm	24mm	36mm	45mm	518g
CTL16	16mm	97mm	28mm	40mm	47mm	671g
CTL19	19mm	97mm	32mm	44mm	51mm	811g
CTL22	22mm	111mm	34mm	52mm	58mm	1268g
CTL26	26mm	131mm	44mm	64mm	77mm	2519g

Suffix -C after product code for compacted strand wire or -7 for 7x7 strand wire.

SWAGELESS COMPRESSION TERMINAL IN-LINE LINKS

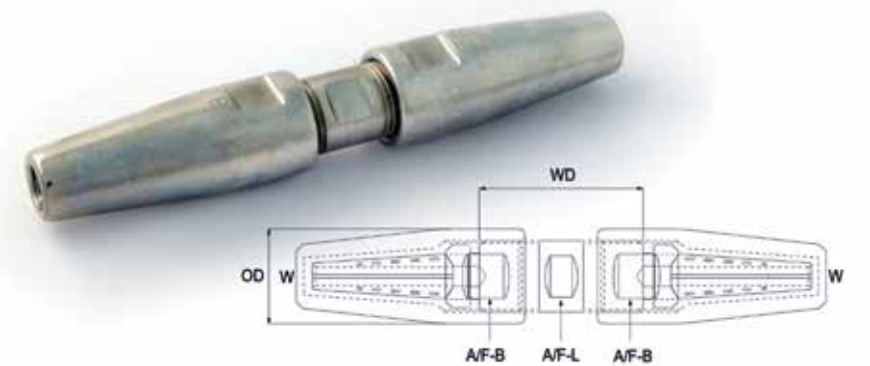

COMPRESSION CONES & CROWN RINGS

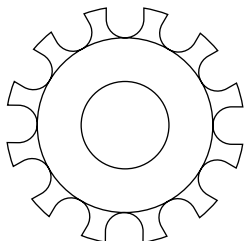

1x19

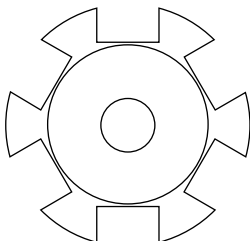

1x7, 7x7, 7x19

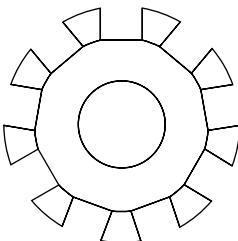

1x19 Compacted

WIRE SIZE	PRODUCT CODES	
	CROWN RING	COMPRESSION CONE
3mm	CTCR03	CTC03
4mm	CTCR04	CTC04
5mm	CTCR05	CTC05
6mm	CTCR06	CTC06
7mm	CTCR07	CTC07
8mm	CTCR08	CTC08
10mm	CTCR10	CTC10
12mm	CTCR12	CTC12
14mm	CTCR14	CTC14
16mm	CTCR16	CTC16
19mm	CTCR19	CTC19
22mm	CTCR22	CTC22
26mm	CTCR26	CTC26

Cone: Suffix -7 for 1x7, 7x7, 7x19 strandor -C for compacted strand after product code.
Crown Ring: Suffix -C after product for copacted strand

TURNBUCKLES AND RIGGING SCREWS

TURNBUCKLES AND RIGGING SCREWS

Traditionally turnbuckle bodies are manufactured by forging a soft bronze to produce the desired shape. Our unique GT design lets us machine the bodies from naval grade, ultrasonically inspected aluminium bronze. Using this process has allowed us to reduce weight by 20% without reducing the strength. Each body is individually hand polished and chrome plated to give an excellent finish.

Our closed 'rigging screw' body is made from stainless steel grade 316L. Sizes up to 1/2" are manufactured from seamless pressure-tube. Sizes 5/8" and above have aluminium bronze thread inserts to prevent galling. Closed bodies can be slotted to allow locking with split pins - please contact for details.

Traditional 'figure-8' chromed-bronze bodies are available from thread size 7/8" and above. These are machined from the same high specification aluminium bronze as the GT bodies to ensure ultimate reliability.

All raw materials used to manufacture these parts are certified to EN10204 3.1b

Inspection certificate BS EN 10204 3.1B available on request (This must be specified at the time of order).

NOTE: Throughout this catalogue we use the following convention – the pin size is the smallest diameter hole that our pin will fit into, the hole size is the largest diameter pin that will fit in the hole. For example if we list a pin as being 12mm then the pin will fit into a 12mm diameter hole and conversely if we list a hole as being 16mm then a 16mm diameter pin will fit in the hole. If in doubt please ask.



TURNBUCKLE BODIES OPEN AND CLOSED DESIGN



TYPE CB

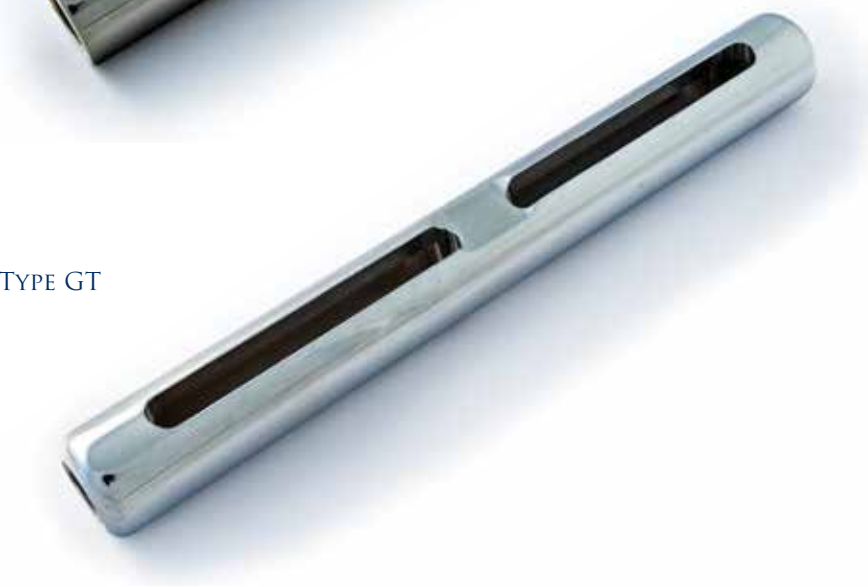

TYPE GT

THREAD UNF	NOMINAL WIRE SIZE	OD	L	WEIGHT	OD	L	WEIGHT
		TYPE CB			TYPE GT		
1/4" unf	3mm	9.5mm	86mm	20g	10.9mm	103mm	34g
5/16" unf	4mm	12mm	98mm	36g	13.8mm	119mm	62g
3/8" unf	5mm	15mm	124mm	72g	15.8mm	147mm	98g
7/16" unf	6mm	17mm	136mm	102g	18.8mm	163mm	148g
1/2" unf	7mm	19mm	164mm	164g	21.9mm	203mm	252g
5/8" unf	8mm/10mm	25.4mm	210mm	454g	28.0mm	228mm	508g
3/4" unf	12mm	28.5mm	248mm	626g	31.6mm	265mm	736g
7/8" unf	14mm	35mm	278mm	955g	37.7mm	310mm	1149g
1" unf	16mm	38mm	332mm	1264g	43.6mm	356mm	1875g
1 1/8" unf	19mm	44.5mm	369mm	2250g	49.5mm	401mm	2731g
1 1/4" unf	22mm	50.8mm	400mm	3290g	53.8mm	443mm	3425g
1 3/8" unf	26mm	54mm	460mm	4337g	59.8mm	476mm	4766g

The product code for a turnbuckle body is the body type followed by the thread size for example, CB5/16 or GT11/4

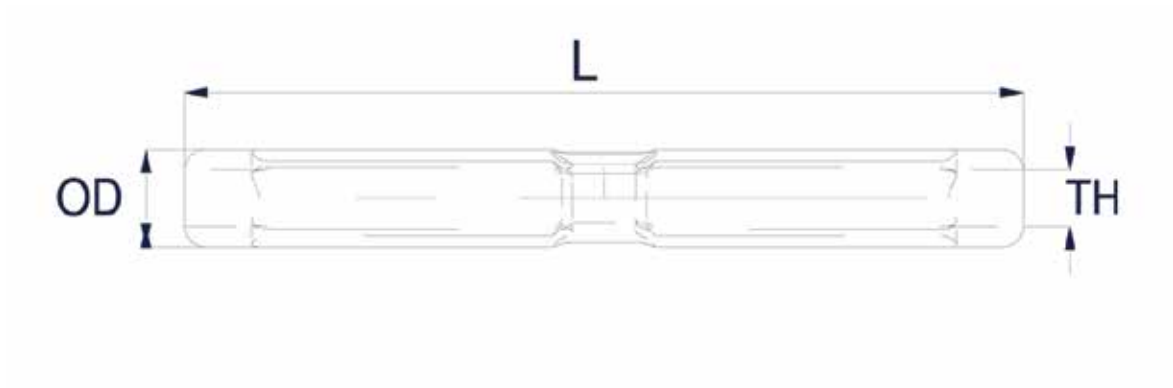

TURNBUCKLES GT BODY WITH SWAGE STUD AND TOGGLE



PRODUCT CODE	WIRE	THREAD	P	C	T	MIN L	MAX L	NOMINAL WEIGHT
GTCT03	3mm	1/4" unf	6.0mm	14.0mm	8.0mm	157.5mm	229.5mm	104g
GTCT04DS	4mm	1/4" unf	6.0mm	14.0mm	8.0mm	158.0mm	230.0mm	175g
GTCT04	4mm	5/16" unf	8.0mm	20.0mm	9.0mm	185.5mm	265.5mm	190g
GTCT04US	4mm	3/8" unf	9.5mm	20.0mm	11.0mm	216.5mm	320.5mm	245g
GTCT05DS	5mm	5/16" unf	8.0mm	20.0mm	9.0mm	190.5mm	270.5mm	285g
GTCT05	5mm	3/8" unf	9.5mm	21.0mm	11.0mm	221.0mm	325.0mm	303g
GTCT05US	5mm	7/16" unf	11.0mm	25.0mm	13.0mm	246.0mm	358.0mm	394g
GTCT06DS	6mm	3/8" unf	9.5mm	21.0mm	11.0mm	226.5mm	330.5mm	365g
GTCT06	6mm	7/16" unf	11.0mm	25.0mm	13.0mm	249.5mm	361.5mm	516g
GTCT06US	6mm	1/2" unf	12.7mm	27.0mm	15.0mm	306.0mm	446.0mm	667g
GTCT07	7mm	1/2" unf	12.7mm	27.0mm	15.0mm	307.5mm	447.5mm	759g
GTCT08DS	8mm	1/2" unf	12.7mm	27.0mm	15.0mm	315.5mm	455.5mm	851g
GTCT08US	8mm	5/8" unf	16.0mm	38.0mm	19.0mm	358.0mm	508.0mm	1265g
GTCT10	10mm	5/8" unf	16.0mm	38.0mm	19.0mm	363.5mm	513.5mm	1505g
GTCT10US	10mm	3/4" unf	19.0mm	44.0mm	22.0mm	419.5mm	599.5mm	2359g
GTCT12	12mm	3/4" unf	19.0mm	44.0mm	22.0mm	428.0mm	608.0mm	2488g
GTCT14	14mm	7/8" unf	22.0mm	53.0mm	25.0mm	497.0mm	707.0mm	4283g
GTCT16	16mm	1" unf	25.0mm	63.0mm	28.0mm	571.5mm	811.5mm	4659g
GTCT19	19mm	1 1/8" unf	28.0mm	67.0mm	32.0mm	635.5mm	905.5mm	7465g
GTCT22	22mm	1 1/4" unf	32.0mm	83.0mm	35.0mm	702.0mm	1002.0mm	12458g
GTCT26	26mm	1 3/8" unf	35.0mm	97.0mm	38.0mm	784.5mm	1104.5mm	16985g

PRODUCT CODE	WIRE	THREAD	P	C	T	MIN L	MAX L
GTST03	3mm	1/4" unf	6.0mm	14.0mm	8.0mm	148.5mm	220.5mm
GTST04DS	4mm	1/4" unf	6.0mm	14.0mm	8.0mm	149.5mm	221.5mm
GTST04	4mm	5/16" unf	8.0mm	20.0mm	9.0mm	177.5mm	257.5mm
GTST04US	4mm	3/8" unf	9.5mm	21.0mm	11.0mm	214.5mm	318.5mm
GTST05DS	5mm	5/16" unf	8.0mm	20.0mm	9.0mm	180.5mm	260.5mm
GTST05	5mm	3/8" unf	9.5mm	21.0mm	11.0mm	214.5mm	318.5mm
GTST05US	5mm	7/16" unf	11.0mm	25.0mm	13.0mm	235.5mm	347.5mm
GTST06DS	6mm	3/8" unf	9.5mm	21.0mm	11.0mm	217.5mm	321.5mm
GTST06	6mm	7/16" unf	11.0mm	25.0mm	13.0mm	237.5mm	349.5mm
GTST06US	6mm	1/2" unf	12.7mm	27.0mm	15.0mm	286.0mm	426.0mm
GTST07	7mm	1/2" unf	12.7mm	27.0mm	15.0mm	286.0mm	426.0mm
GTST08DS	8mm	1/2" unf	12.7mm	27.0mm	15.0mm	289.0mm	429.0mm
GTST08US	8mm	5/8" unf	16.0mm	38.0mm	19.0mm	339.5mm	489.5mm
GTST10	10mm	5/8" unf	16.0mm	38.0mm	19.0mm	341.5mm	491.5mm
GTST10US	10mm	3/4" unf	19.0mm	44.0mm	22.0mm	391.5mm	571.5mm
GTST12	12mm	3/4" unf	19.0mm	44.0mm	22.0mm	393.0mm	573.0mm
GTST14	14mm	7/8" unf	22.0mm	53.0mm	25.0mm	457.5mm	667.5mm
GTST16	16mm	1" unf	25.0mm	63.0mm	28.0mm	529.0mm	769.0mm
GTST19	19mm	1 1/8" unf	28.0mm	67.0mm	32.0mm	588.0mm	858.0mm
GTST22	22mm	1 1/4" unf	32.0mm	83.0mm	35.0mm	662.5mm	962.5mm
GTST26	26mm	1 3/8" unf	35.0mm	97.0mm	38.0mm	727.0mm	1047.0mm

TURNBUCKLES GT BODY WITH COMPRESSION STUD AND TOGGLE

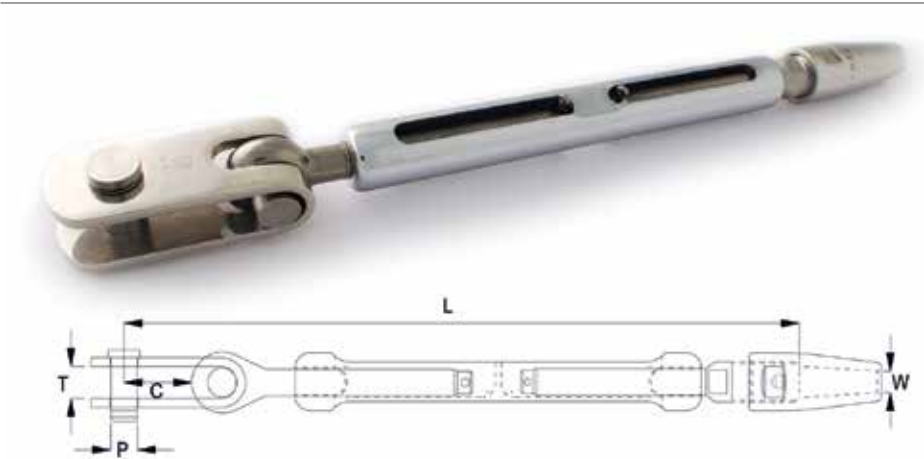

TURNBUCKLES GT BODY WITH SWAGE STUD AND EYE

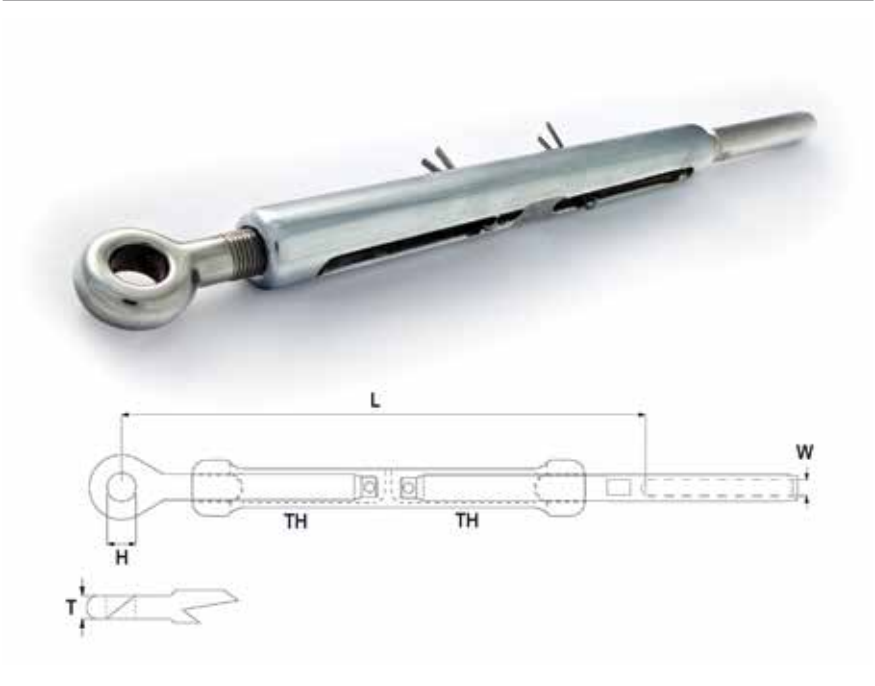

PRODUCT CODE	WIRE	THREAD	H	T	MIN L	MAX L
GTSE03	3mm	1/4" unf	6.35mm	5mm	127.0mm	199.0mm
GTSE04DS	4mm	1/4" unf	6.35mm	5mm	128.0mm	200.0mm
GTSE04	4mm	5/16" unf	8.0mm	6.5mm	149.5mm	229.5mm
GTSE04US	4mm	3/8" unf	9.53mm	7.8mm	182.0mm	286.0mm
GTSE05DS	5mm	5/16" unf	8.0mm	6.5mm	152.5mm	232.5mm
GTSE05	5mm	3/8" unf	9.53mm	7.8mm	182.0mm	286.0mm
GTSE05US	5mm	7/16" unf	11.1mm	9.5mm	196.5mm	308.5mm
GTSE06DS	6mm	3/8" unf	9.53mm	7.8mm	185.0mm	289.0mm
GTSE06	6mm	7/16" unf	11.1mm	9.5mm	198.5mm	310.5mm
GTSE06US	6mm	1/2" unf	12.7mm	11.5mm	244.5mm	384.5mm
GTSE07	7mm	1/2" unf	12.7mm	11.5mm	244.5mm	384.5mm
GTSE08DS	8mm	1/2" unf	12.7mm	11.5mm	247.5mm	387.5mm
GTSE08US	8mm	5/8" unf	14.28mm	15mm	284.5mm	434.5mm
GTSE10	10mm	5/8" unf	16.0mm	15mm	286.5mm	436.5mm
GTSE10US	10mm	3/4" unf	19.05mm	17.5mm	325.5mm	505.5mm
GTSE12	12mm	3/4" unf	19.05mm	17.5mm	327.0mm	507.0mm
GTSE14	14mm	7/8" unf	22.2mm	21.5mm	378.5mm	588.5mm
GTSE16	16mm	1" unf	25.4mm	23.5mm	435.0mm	675.0mm
GTSE19	19mm	1 1/8" unf	28.58mm	27.5mm	488.0mm	758.0mm
GTSE22	22mm	1 1/4" unf	32.0mm	31mm	543.5mm	843.5mm
GTSE26	26mm	1 3/8" unf	35.0mm	33.5mm	587.0mm	907.0mm

PRODUCT CODE	WIRE	THREAD	R	D	MIN L	MAX L
GTSB03	3mm	1/4" unf	6.3mm	13mm	127mm	199mm
GTSB04	4mm	3/8" unf	8.8mm	17mm	128mm	200mm
GTSB05	5mm	3/8" unf	8.8mm	17mm	182mm	286mm
GTSB06	6mm	7/16" unf	10.8mm	21mm	198mm	310mm
GTSB07	7mm	1/2" unf	10.8mm	21mm	244mm	384mm
GTSB08DS	8mm	1/2" unf	13.8mm	27mm	250mm	390mm
GTSB08	8mm	5/8" unf	13.8mm	27mm	284mm	434mm
GTSB10	10mm	5/8" unf	15.8mm	31mm	287mm	437mm
GTSB12	12mm	3/4" unf	17.8mm	35mm	327mm	507mm

Also available in closed body style.

TURNBUCKLES GT BODY WITH SWAGE STUD AND STEMBALL

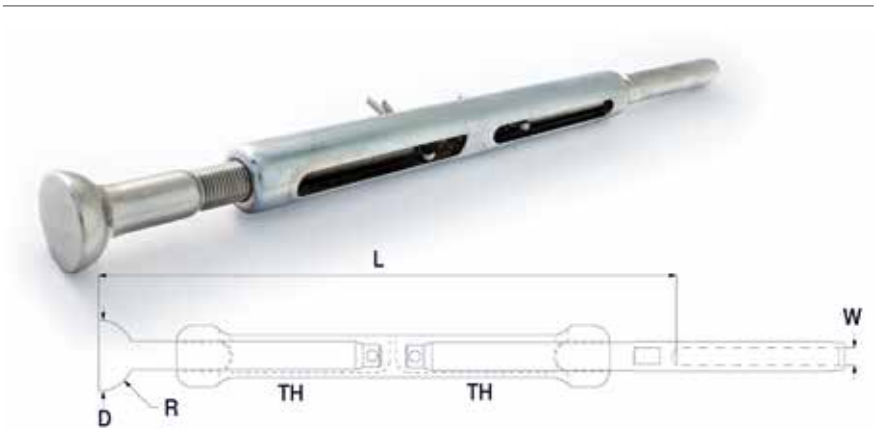

TURNBUCKLES GT BODY WITH TOGGLE AND FORK

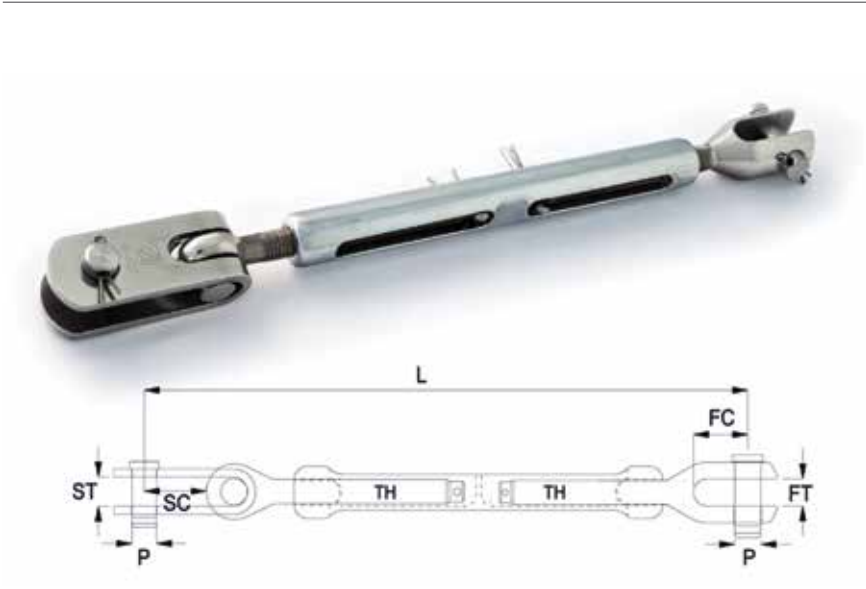

PRODUCT CODE	THREAD	P	ST	SC	FC	FT	MIN L	MAX L
GTFT03	1/4" unf	6.0mm	7.7mm	14.0mm	13.0mm	6.3mm	157.5mm	229.5mm
GTFT04	5/16" unf	8.0mm	9.0mm	20mm	16.0mm	8.0mm	192.0mm	272.0mm
GTFT05	3/8" unf	9.5mm	10.3mm	21mm	19.0mm	10.0mm	231.5mm	335.5mm
GTFT06	7/16" unf	11mm	14.0mm	25mm	22.0mm	11.0mm	260.5mm	372.5mm
GTFT07	1/2" unf	12.7mm	15.0mm	27mm	25.0mm	12.7mm	318.0mm	458.0mm
GTFT08	5/8" unf	14mm	19.0mm	38mm	28.0mm	14.0mm	368.5mm	518.5mm
GTFT10	5/8" unf	16mm	19.0mm	36mm	32.0mm	16.0mm	380.5mm	530.5mm
GTFT12	3/4" unf	19mm	22.0mm	44mm	38.0mm	19.0mm	443.5mm	623.5mm
GTFT14	7/8" unf	22mm	24.0mm	53mm	45.0mm	22.2mm	512.0mm	722.0mm
GTFT16	1" unf	25mm	28.0mm	63mm	50.0mm	25.4mm	583.5mm	823.5mm
GTFT19	1 1/8" unf	28mm	32.0mm	67mm	58.0mm	28.6mm	661.0mm	931.0mm
GTFT22	1 1/4" unf	32mm	36.0mm	83mm	64.0mm	32.0mm	730.5mm	1030.5mm
GTFT26	1 3/8" unf	35mm	38.0mm	97mm	70.0mm	35.0mm	801.5mm	1121.5mm

PRODUCT CODE	WIRE	THREAD	P	H	C	T	MIN L	MAX L
GTFE03	3mm	1/4" unf	6.0mm	6.35mm	12.5mm	5.0mm	136.0mm	208.0mm
GTFE04	4mm	5/16" unf	8.0mm	8.0mm	17.0mm	7.9mm	164.0mm	244.0mm
GTFE05	5mm	3/8" unf	9.5mm	9.53mm	19.0mm	9.9mm	199.0mm	303.0mm
GTFE06	6mm	7/16" unf	11.0mm	11.1mm	22.0mm	10.9mm	218.5mm	330.5mm
GTFE07	7mm	1/2" unf	12.0mm	12.7mm	25.0mm	12.7mm	266.5mm	406.5mm
GTFE08	8mm	5/8" unf	14.0mm	14.28mm	28.0mm	13.8mm	296.5mm	446.5mm
GTFE10	10mm	5/8" unf	16.0mm	16.0mm	32.0mm	15.8mm	320.5mm	470.5mm
GTFE12	12mm	3/4" unf	19.0mm	19.05mm	38.0mm	17.8mm	366.0mm	546.0mm
GTFE14	14mm	7/8" unf	22.0mm	22.2mm	45.0mm	22.0mm	419.5mm	629.5mm
GTFE16	16mm	1" unf	25mm	25.4mm	50.0mm	25.0mm	481.0mm	721.0mm
GTFE19	19mm	1 1/8" unf	28.0mm	28.58mm	58.0mm	27.5mm	543.0mm	813.0mm
GTFE22	22mm	1 1/4" unf	32.0mm	32.0mm	64.0mm	31.8mm	602.5mm	902.5mm
GTFE26	26mm	1 3/8" unf	35.0mm	35.0mm	70.0mm	34.8mm	648.0mm	968.0mm

TURNBUCKLES GT BODY WITH FORK AND EYE

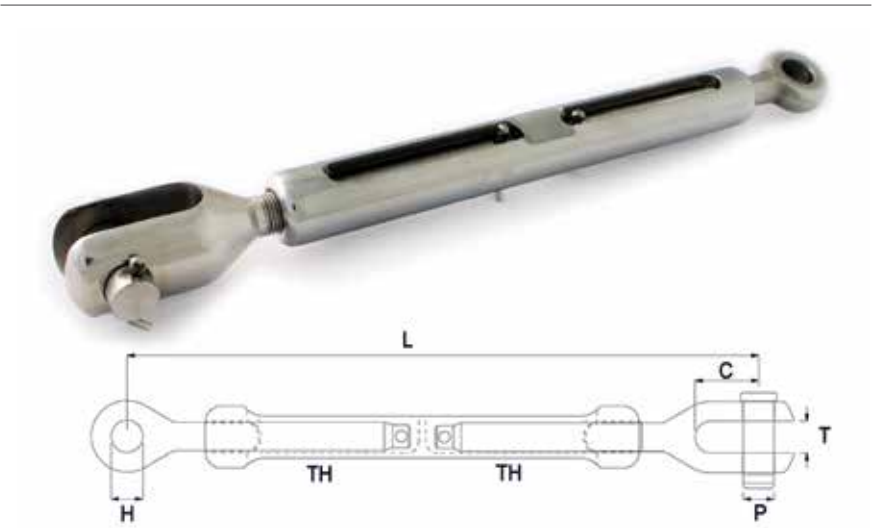

TURNBUCKLES GT BODY WITH TOGGLE BLANK



PRODUCT CODE	THREAD	PIN	ST	SC	STROKE
GTTB03	1/4 unf	6.0mm	7.7mm	14.0mm	36mm
GTTB04	5/16 unf	8.0mm	9.0mm	19.0mm	40mm
GTTB05	3/8 unf	9.5mm	1.3mm	20.0mm	52mm
GTTB06	7/16 unf	11.0mm	14.0mm	25.0mm	56mm
GTTB07	1/2 unf	12.7mm	15.0mm	27.0mm	70mm
GTTB08	5/8 unf	14.0mm	19.0mm	38.0mm	75mm
GTTB10	5/8 unf	16.0mm	19.0mm	36.0mm	75mm
GTTB12	3/4 unf	19.0mm	22.0mm	44.0mm	89mm
GTTB14	7/8 unf	22.0mm	24.0mm	53.0mm	105mm
GTTB16	1 unf	25.0mm	28.0mm	63.0mm	119mm
GTTB19	1-1/8 unf	28.0mm	32.0mm	67.0mm	135mm
GTTB22	1-1/4 unf	32.0mm	36.0mm	83.0mm	150mm
GTTB26	1-3/8 unf	35.0mm	38.0mm	97.0mm	160mm

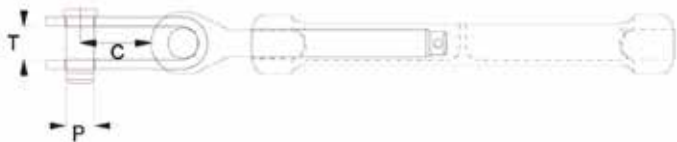

RIGGING SCREW CLOSED BODY WITH
STUD AND TOGGLE

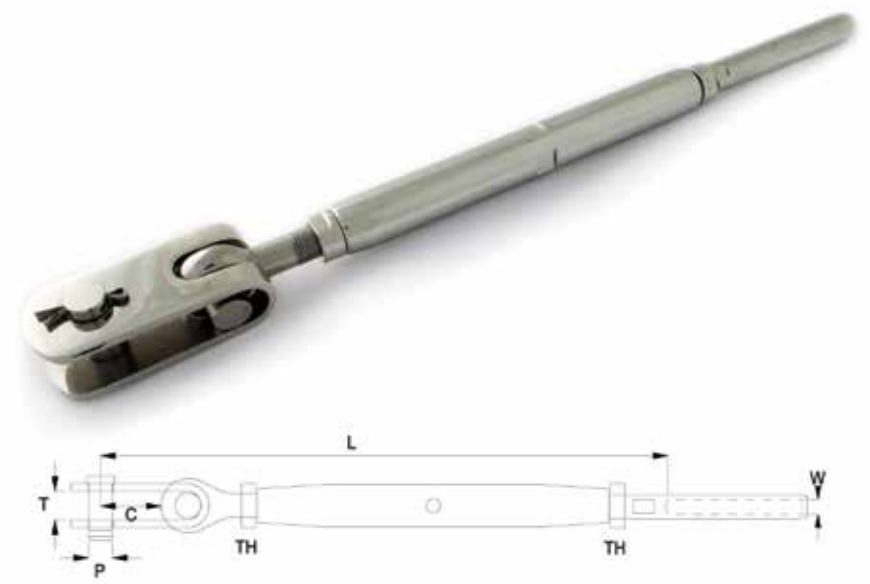

PRODUCT CODE	WIRE	THREAD	P	C	T	MIN L	MAX L	WEIGHT
RSST03	3mm	1/4" unf	6.0mm	14.0mm	8.0mm	139.5mm	209.5mm	76g
RSST04DS	4mm	1/4" unf	6.0mm	14.0mm	8.0mm	140.5mm	210.5mm	77g
RSST04	4mm	5/16" unf	8.0mm	19.0mm	9.0mm	167.5mm	245.5mm	140g
RSST04US	4mm	3/8" unf	9.5mm	21.0mm	11.0mm	204.5mm	304.5mm	220g
RSST05DS	5mm	5/16" unf	8.0mm	19.0mm	9.0mm	170.5mm	248.5mm	142g
RSST05	5mm	3/8" unf	9.5mm	21.0mm	11.0mm	204.5mm	304.5mm	250g
RSST05US	5mm	7/16" unf	11mm	26.0mm	13.0mm	227.5mm	335.5mm	254g
RSST06DS	6mm	3/8" unf	9.5mm	21.0mm	11.0mm	207.5mm	307.5mm	253g
RSST06	6mm	7/16" unf	11mm	26.0mm	13.0mm	229.5mm	337.5mm	430g
RSST06US	6mm	1/2" unf	12.7mm	28.0mm	15.0mm	274.0mm	406.0mm	595g
RSST07	7mm	1/2" unf	12.7mm	28.0mm	15.0mm	274.0mm	406.0mm	626g
RSST08DS	8mm	1/2" unf	12.7mm	28.0mm	15.0mm	277.0mm	409.0mm	660g
RSST08US	8mm	5/8" unf	16mm	37.0mm	19.0mm	348.5mm	504.5mm	1256g
RSST10	10mm	5/8" unf	16mm	37.0mm	19.0mm	350.5mm	506.5mm	1389g
RSST10US	10mm	3/4" unf	19mm	45.0mm	22.0mm	410.0mm	581.0mm	2021g
RSST12	12mm	3/4" unf	19mm	45.0mm	22.0mm	411.5mm	582.5mm	2278g
RSST14	14mm	7/8" unf	22mm	54.0mm	25.0mm	465.0mm	662.0mm	3803g
RSST16	16mm	1" unf	25mm	64.0mm	28.0mm	541.5mm	780.5mm	5162g
RSST19	19mm	1 1/8" unf	28mm	68.0mm	32.0mm	611.0mm	881.0mm	6098g
RSST22	22mm	1 1/4" unf	32mm	84.0mm	35.0mm	664.5mm	948.5mm	9039g
RSST26	26mm	1 3/8" unf	35mm	98.0mm	38.0mm	764.5mm	1088.5mm	16058g

PRODUCT CODE	WIRE	THREAD	P	C	T	MIN L	MAX L	NOMINAL WEIGHT
RSCT03	3mm	1/4" unf	6.0mm	14.0mm	8.0mm	152mm	217mm	76g
RSCT04	4mm	5/16" unf	8.0mm	18.0mm	9.0mm	173mm	246mm	146g
RSCT05	5mm	3/8" unf	9.5mm	21.0mm	11.0mm	209mm	304mm	265g
RSCT06	6mm	7/16" unf	11.0mm	25.0mm	13.0mm	263mm	338mm	452g
RSCT07	7mm	1/2" unf	12.7mm	27.0mm	15.0mm	274mm	399mm	663g
RSCT08DS	8mm	1/2" unf	12.7mm	27.0mm	15.0mm	282mm	407mm	761g
RSCT08US	8mm	5/8" unf	16.0mm	36.0mm	19.0mm	360mm	508mm	1541g
RSCT10	10mm	5/8" unf	16.0mm	36.0mm	19.0mm	365mm	513mm	1541g
RSCT12	12mm	3/4" unf	19.0mm	45.0mm	22.0mm	436mm	598mm	2620g
RSCT14	14mm	7/8" unf	22.0mm	53.0mm	25.0mm	489mm	676mm	4308g
RSCT16	16mm	1" unf	25.0mm	62.0mm	28.0mm	573mm	802mm	5857g
RSCT19	19mm	1 1/8" unf	28.0mm	63.0mm	32.0mm	641mm	900mm	6746g
RSCT22	22mm	1 1/4" unf	32.0mm	76.0mm	35.0mm	692mm	963mm	10079g
RSCT26	26mm	1 3/8" unf	35.0mm	92.0mm	38.0mm	805mm	1120mm	18733g

RIGGING SCREW CLOSED BODY WITH
COMPRESSION STUD AND TOGGLE

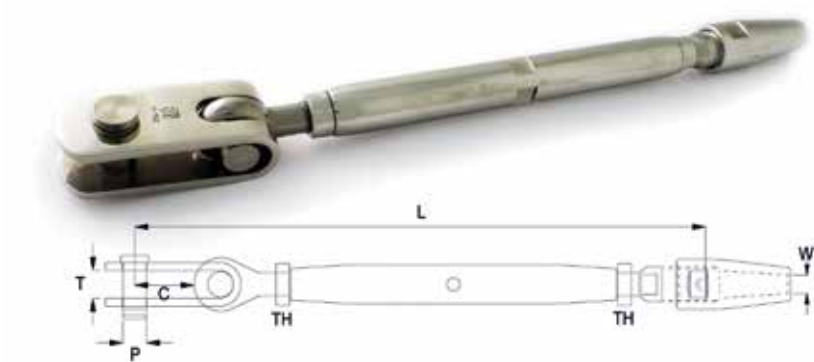

RIGGING SCREW CLOSED BODY WITH STUD AND FORK

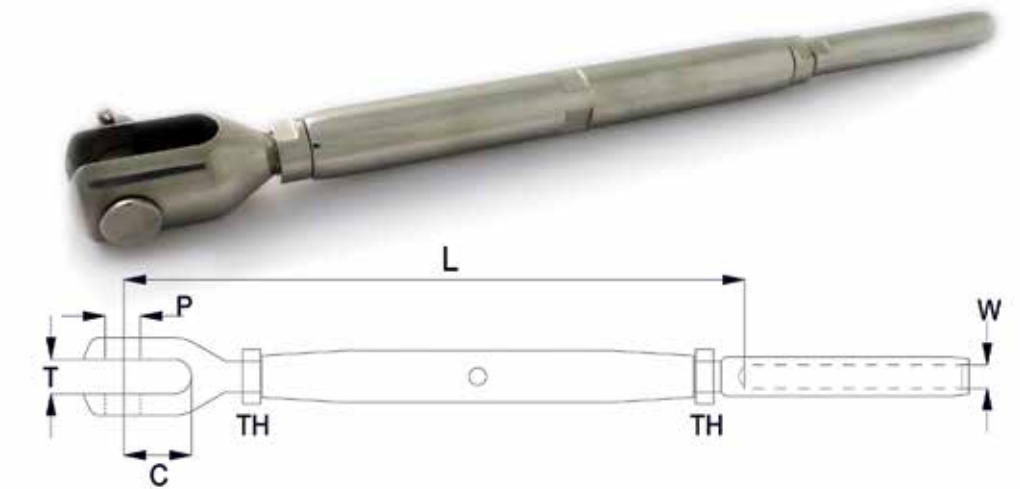

PRODUCT CODE	WIRE	THREAD	H	T	C	MIN L	MAX L	NOMINAL WEIGHT
RSSE03	3mm	1/4" unf	6.35mm	5.0mm	11.0mm	115mm	185mm	62g
RSSE04DS	4mm	1/4" unf	6.35mm	5.0mm	11.0mm	117mm	187mm	63g
RSSE04	4mm	5/16" unf	8.0mm	6.5mm	14.0mm	140mm	215mm	106g
RSSE05DS	5mm	5/16" unf	8.0mm	6.5mm	14.0mm	142mm	217mm	108g
RSSE05	5mm	3/8" unf	9.53mm	7.8mm	17.0mm	170mm	270mm	194g
RSSE06DS	6mm	3/8" unf	9.53mm	7.8mm	17.0mm	173mm	273mm	197g
RSSE06	6mm	7/16" unf	11.1mm	9.5mm	20.0mm	190mm	295mm	298g
RSSE07DS	7mm	7/16" unf	11.1mm	9.5mm	20.0mm	194mm	299mm	302g
RSSE07	7mm	1/2" unf	12.7mm	11.5mm	23.0mm	225mm	355mm	466g
RSSE08DS	8mm	1/2" unf	12.7mm	11.5mm	23.0mm	225mm	350mm	500g
RSSE08	8mm	5/8" unf	14.28mm	13.5mm	24.0mm	285mm	410mm	968g
RSSE08US	8mm	5/8" unf	16.0mm	15.0mm	29.0mm	290mm	445mm	1032g
RSSE10	10mm	5/8" unf	16.0mm	15.0mm	29.0mm	290mm	445mm	1032g
RSSE12	12mm	3/4" unf	19.05mm	17.5mm	34.0mm	335mm	505mm	1626g
RSSE14	14mm	7/8" unf	22.2mm	21.5mm	40.0mm	375mm	570mm	2657g
RSSE16	16mm	1" unf	25.4mm	23.5mm	46.0mm	440mm	680mm	3694g
RSSE19	19mm	1 1/8" unf	28.58mm	27.5mm	51.0mm	495mm	765mm	3670g
RSSE22	22mm	1 1/4" unf	32.0mm	31.1mm	58.0mm	535mm	820mm	5442g
RSSE26	26mm	1 3/8" unf	35.0mm	33.5mm	63.0mm	615mm	940mm	11404g

PRODUCT CODE	WIRE	THREAD	P	C	T	MIN L	MAX L	NOMINAL WEIGHT
RSSF03	3mm	1/4" unf	6.0mm	12.5mm	6.2mm	125mm	195mm	79g
RSSF04DS	4mm	1/4" unf	6.0mm	12.5mm	6.2mm	126mm	196mm	80g
RSSF04	4mm	5/16" unf	8.0mm	17mm	7.9mm	150.5mm	228.5mm	151g
RSSF04US	4mm	3/8" unf	9.5mm	19mm	9.9mm	184mm	284mm	152g
RSSF05DS	5mm	5/16" unf	8.0mm	17mm	7.9mm	153.5mm	231.5mm	153g
RSSF05	5mm	3/8" unf	9.5mm	19mm	9.9mm	184mm	284mm	257g
RSSF05US	5mm	7/16" unf	11.0mm	22mm	10.9mm	200mm	308mm	260g
RSSF06DS	6mm	3/8" unf	9.5mm	19mm	9.9mm	187mm	287mm	261g
RSSF06	6mm	7/16" unf	11.0mm	22mm	10.9mm	202mm	310mm	386g
RSSF06US	6mm	1/2" unf	12.0mm	25mm	12.7mm	236mm	368mm	450g
RSSF07	7mm	1/2" unf	12.0mm	25mm	12.7mm	236mm	368mm	591g
RSSF08DS	8mm	1/2" unf	12.0mm	25mm	12.7mm	239mm	371mm	625g
RSSF08	8mm	5/8" unf	14.0mm	28mm	14.0mm	300mm	455mm	1185g
RSSF08US	8mm	5/8" unf	16.0mm	32mm	15.8mm	310mm	466mm	1185g
RSSF10	10mm	5/8" unf	16.0mm	32mm	15.8mm	312mm	468mm	1340g
RSSF10US	10mm	3/4" unf	19.0mm	38mm	17.8mm	359.5mm	530.5mm	1950g
RSSF12	12mm	3/4" unf	19.0mm	38mm	17.8mm	361mm	532mm	2218g
RSSF14	14mm	7/8" unf	22.0mm	45mm	22.0mm	403mm	600mm	3376g
RSSF16	16mm	1" unf	25.0mm	50mm	25.0mm	472mm	711mm	4925g
RSSF19	19mm	1 1/8" unf	28.0mm	58mm	28.2mm	531mm	801mm	5318g
RSSF22	22mm	1 1/4" unf	32.0mm	64mm	31.8mm	575mm	859mm	7711g
RSSF26	26mm	1 3/8" unf	35.0 mm	70mm	34.9mm	655mm	979mm	14085g

RIGGING SCREW CLOSED BODY WITH STUD AND EYE

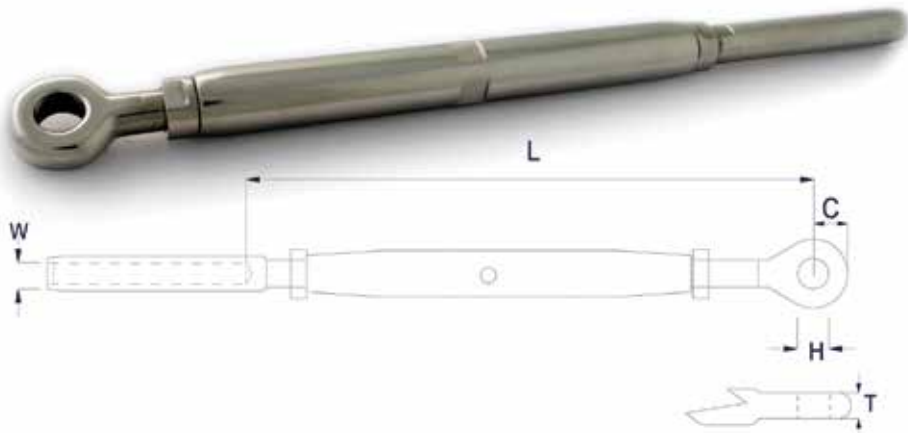

RIGGING SCREW CLOSED BODY WITH FORK AND TOGGLE

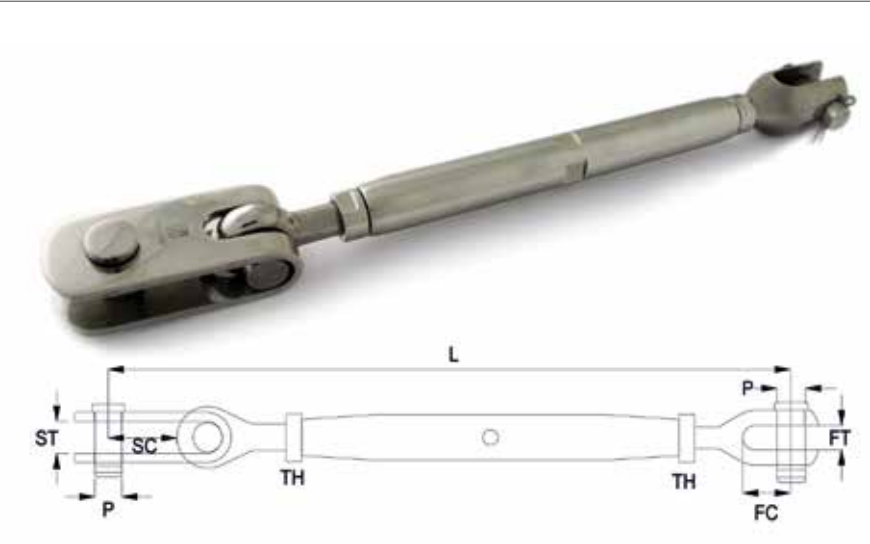

PRODUCT CODE	WIRE	THREAD	P	ST	SC	FC	FT	MIN L	MAX L	NOMINAL WEIGHT
RSFT03	3mm	1/4" unf	6.0mm	8.0mm	14.0mm	12.5mm	6.2mm	148.5mm	218.5mm	103g
RSFT04	4mm	5/16" unf	8.0mm	9.0mm	19.0mm	17.0mm	7.9mm	182.0mm	260.0mm	191g
RSFT05	5mm	3/8" unf	9.5mm	11.0mm	21.0mm	19.0mm	9.9mm	221.5mm	321.5mm	294g
RSFT06	6mm	7/16" unf	11.0mm	13.0mm	26.0mm	22.0mm	10.9mm	249.5mm	357.5mm	450g
RSFT07	7mm	1/2" unf	12.7mm	15.0mm	28.0mm	25.0mm	12.7mm	296.0mm	428.0mm	686g
RSFT10	10mm	5/8" unf	16.0mm	19.0mm	37.0mm	32.0mm	15.8mm	384.5mm	540.5mm	1384g
RSFT12	12mm	3/4" unf	19.0mm	22.0mm	45.0mm	38.0mm	17.8mm	450.5mm	621.5mm	2302g
RSFT14	14mm	7/8" unf	22.0mm	25.0mm	54.0mm	45.0mm	22.0mm	506.0mm	703.0mm	3666g
RSFT16	16mm	1" unf	25mm	28.0mm	64.0mm	50.0mm	25.0mm	587.5mm	826.5mm	5124g
RSFT19	19mm	1 1/8" unf	28.0mm	32.0mm	68.0mm	58.0mm	28.2mm	666.0mm	936.0mm	7743g
RSFT22	22mm	1 1/4" unf	32.0mm	35.0mm	84.0mm	64.0mm	61.8mm	723.5mm	1007.5mm	11290g
RSFT26	26mm	1 3/8" unf	35.0mm	38.0mm	98.0mm	70.0mm	34.8mm	825.5mm	1149.5mm	15693g

PRODUCT CODE	WIRE	THREAD	P	H	C	ET	FT	MIN L	MAX L	NOMINAL WEIGHT
RSFE03	3mm	1/4" unf	6mm	6.35mm	12.5mm	5.0mm	6.2mm	127.0mm	197.0mm	67g
RSFE04	4mm	5/16" unf	8mm	8.0mm	17.0mm	6.5mm	7.9mm	154.0mm	232.0mm	135g
RSFE05	5mm	3/8" unf	9.5mm	9.53mm	19.0mm	7.8mm	9.9mm	189.0mm	289.0mm	235g
RSFE06	6mm	7/16" unf	11mm	11.1mm	22.0mm	9.5mm	10.9mm	207.5mm	315.5mm	332g
RSFE07	7mm	1/2" unf	12mm	12.7mm	25.0mm	11.5mm	12.7mm	244.5mm	376.5mm	521g
RSFE08	8mm	5/8" unf	14mm	14.28mm	28.0mm	13.5mm	13.8mm	300.5mm	456.5mm	1093g
RSFE10	10mm	5/8" unf	16mm	16.0mm	32.0mm	15.0mm	15.8mm	324.5mm	480.5mm	1198g
RSFE12	12mm	3/4" unf	19mm	19.05mm	38.0mm	17.5mm	17.8mm	373.0mm	544.0mm	1952g
RSFE14	14mm	7/8" unf	22mm	22.2mm	45.0mm	21.5mm	22.0mm	413.5mm	610.5mm	3048g
RSFE16	16mm	1" unf	25mm	25.4mm	50.0mm	23.5mm	25.0mm	485.0mm	724.0mm	4407g
RSFE19	19mm	1 1/8" unf	28mm	28.58mm	58.0mm	27.5mm	28.2mm	548.0mm	818.0mm	4364g
RSFE22	22mm	1 1/4" unf	32mm	32.0mm	64.0mm	31.0mm	31.8mm	595.5mm	879.5mm	5992g
RSFE26	26mm	1 3/8" unf	35mm	35.0mm	70.0mm	33.5mm	34.8mm	672.0mm	996.0mm	12122g

RIGGING SCREW CLOSED BODY WITH FORK AND EYE

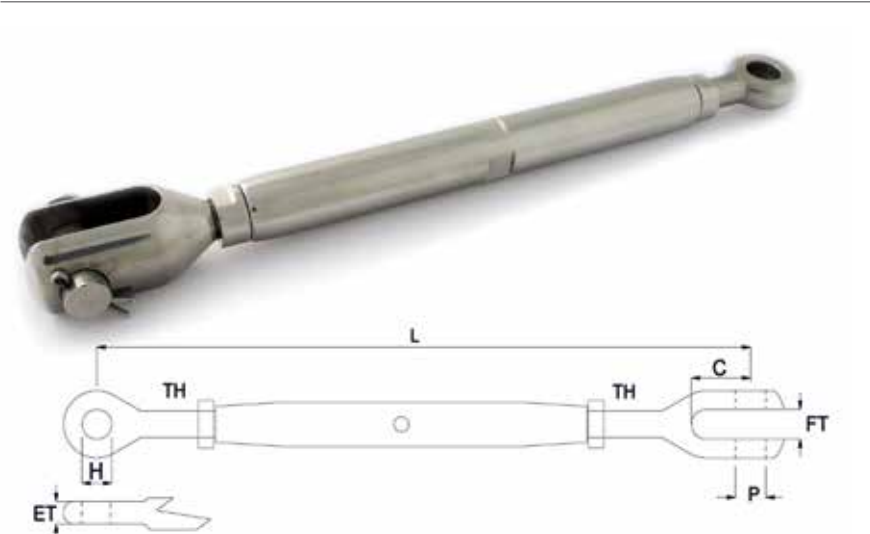

RIGGING SCREW CLOSED BODY WITH EYE AND EYE

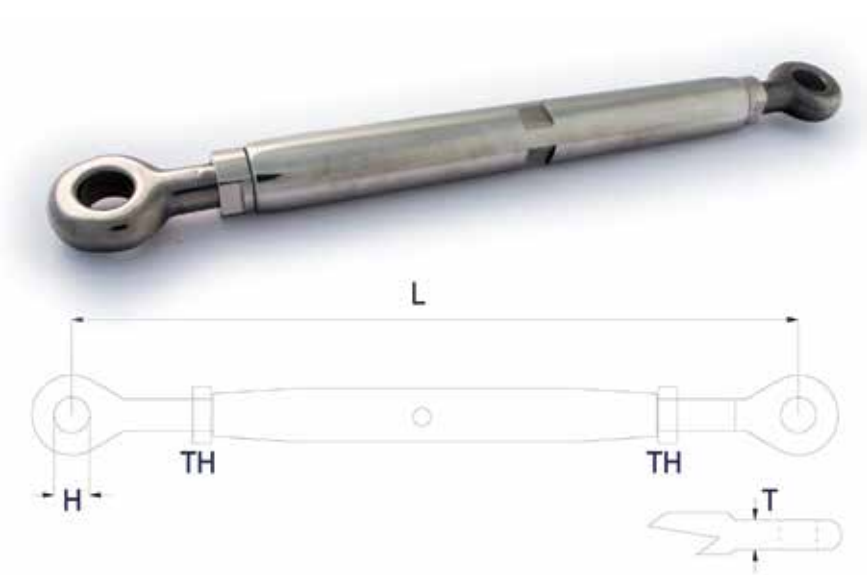

PRODUCT CODE	WIRE	THREAD	H	T	MIN L	MAX L	NOMINAL WEIGHT
RSEE03	3mm	1/4" unf	6.35mm	5.0mm	120mm	190mm	54g
RSEE04	4mm	5/16" unf	8.0mm	6.5mm	143mm	221mm	100g
RSEE05	5mm	3/8" unf	9.53mm	7.8mm	177mm	277mm	188g
RSEE06	6mm	7/16" unf	11.1mm	9.5mm	193mm	301mm	266g
RSEE07	7mm	1/2" unf	12.7mm	11.5mm	231mm	363mm	428g
RSEE08	8mm	5/8" unf	14.28mm	13.5mm	279mm	435mm	926g
RSEE10	10mm	5/8" unf	16.0mm	15.0mm	303mm	459mm	962g
RSEE12	12mm	3/4" unf	19.05mm	17.5mm	346mm	517mm	1486g
RSEE14	14mm	7/8" unf	22.2mm	21.5mm	383mm	580mm	2519g
RSEE16	16mm	1" unf	25.4mm	23.5mm	452mm	691mm	3474g
RSEE19	19mm	1 1/8" unf	28.58mm	27.5mm	510mm	780mm	3710g
RSEE22	22mm	1 1/4" unf	32.0mm	31.0mm	557mm	841mm	4273g
RSEE26	26mm	1 3/8" unf	35.0mm	33.5mm	628mm	952mm	10159g

COMPONENTS

COMPONENTS

Individual component parts are available for purchase giving you maximum flexibility. As we do all of our manufacturing in-house we have the ability to design and make specific parts to customer requirements out a wide range of materials; Stainless Steels (including Duplex and Precipitation-Hardening), Aluminium Bronze, Nitronic, Aluminium and Titanium. We can provide parts with a wide range of specialised coatings for specific applications including anodizing, PVD, galvanizing and Xylan (Teflon). For special components that you cannot see listed please contact one of our sales staff.

NOTE: Throughout this catalogue we use the following convention – the pin size is the smallest diameter hole that our pin will fit into, the hole size is the largest diameter pin that will fit in the hole. For example if we list a pin as being 12mm then the pin will fit into a 12mm diameter hole and conversely if we list a hole as being 16mm then a 16mm diameter pin will fit in the hole. If in doubt please ask.



STAINLESS STEEL THREAD EYE THREADED TERMINALS - EYE STUDS RH & LH

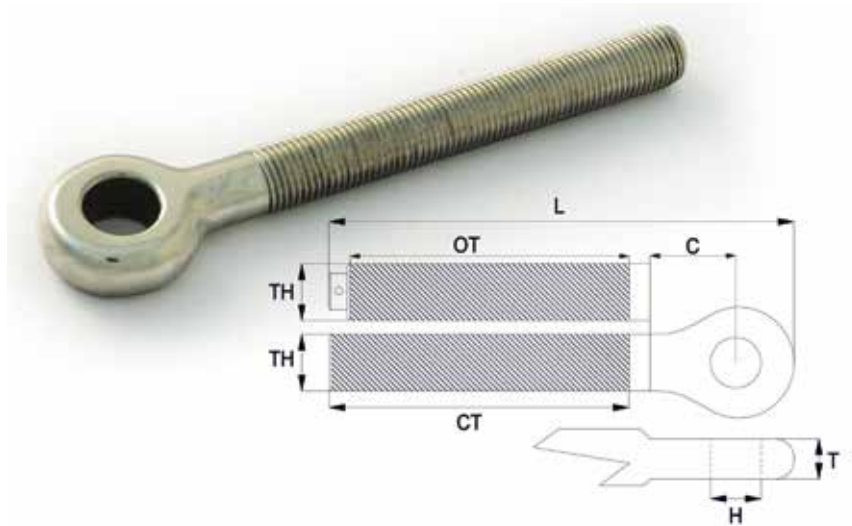

PRODUCT CODE	THREAD	H	C	L	T	CT	OT	NOMINAL WEIGHT
ES#03	1/4" unf	6.35mm	11mm	68mm	5.0mm	47mm	42mm	16g
ES#04	5/16" unf	8.0mm	14mm	81mm	6.5mm	54mm	49mm	30g
ES#05	3/8" unf	9.53mm	17mm	99mm	7.8mm	68mm	63mm	54g
ES#06	7/16" unf	11.1mm	20mm	108mm	9.5mm	75mm	68mm	76g
ES#07	1/2" unf	12.7mm	23mm	130mm	11.5mm	90mm	83mm	124g
ES#08	5/8" unf	14.28mm	24mm	148mm	13.5mm	100mm	93mm	218g
ES#10	5/8" unf	16.0mm	29mm	153mm	15.0mm	100mm	93mm	236g
ES#12	3/4" unf	19.05mm	34mm	178mm	17.5mm	120mm	111mm	410g
ES#14	7/8" unf	22.2mm	40mm	205mm	21.5mm	140mm	130mm	736g
ES#16	1" unf	25.4mm	46mm	235mm	23.5mm	160mm	150mm	1055g
ES#19	1 1/8" unf	28.58mm	51mm	264mm	27.5mm	180mm	168mm	1490g
ES#22	1 1/4" unf	32.0mm	58mm	896mm	31.0mm	200mm	188mm	2031g
ES#26	1 3/8" unf	35.0mm	63mm	326mm	33.5mm	220mm	208mm	2755g

Replace # with C for closed body style or O for open style. Suffix R or L for right or left hand thread.

PRODUCT CODE	THREAD	R	D	L	OT	NOMINAL WEIGHT
BSO14-065	1/4" unf	6.3mm	13mm	68mm	42mm	16g
BSO516-090	5/16" unf	8.8mm	17mm	81mm	48mm	30g
BSO38-090	3/8" unf	8.8mm	17mm	99mm	61mm	54g
BSO716-110	7/16" unf	10.8mm	21mm	108mm	66mm	76g
BSO12-110	1/2" unf	10.8mm	21mm	130mm	81mm	124g
BSO12-140	1/2" unf	13.8mm	27mm	134mm	81mm	150g
BSO58-140	5/8" unf	13.8mm	27mm	148mm	91mm	214g
BSO58-160	5/8" unf	15.8mm	31mm	153mm	91mm	236g
BSO34-180	3/4" unf	17.8mm	35mm	178mm	110mm	410g

Suffix R or L for right or left hand thread.

STAINLESS STEEL THREAD EYE THREADED STEMBALL TERMINALS - STEMBALL STUDS RH & LH

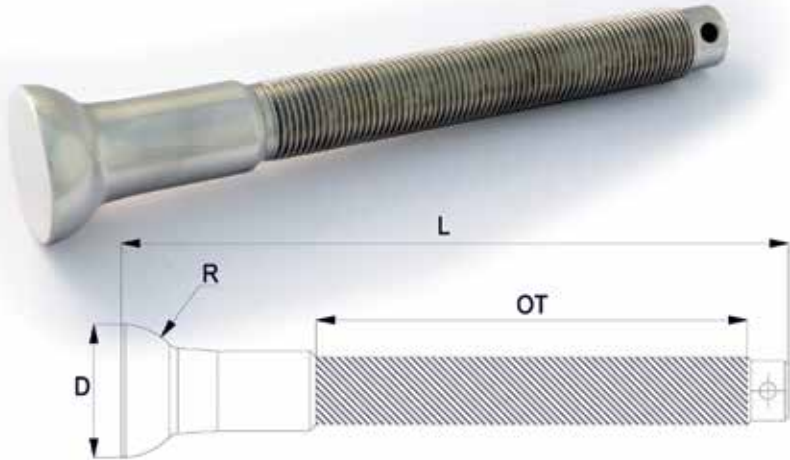

STAINLESS STEEL THREAD FORK THREADED
TERMINALS - FORK STUDS RH & LH

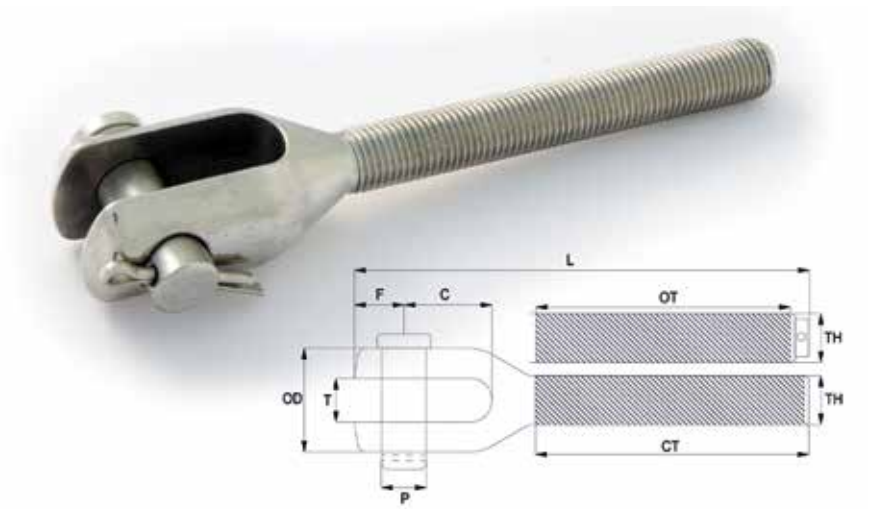

PRODUCT CODE	THREAD	P	L	F	C	T	OD	CT	OT	NOMINAL WEIGHT
FS#03	1/4" unf	6.0mm	76mm	7mm	12.5mm	6.2mm	14.3mm	47mm	42mm	25g
FS#04	5/16" unf	8mm	91mm	9mm	17mm	7.9mm	18.0mm	54mm	49mm	55g
FS#05	3/8" unf	9.5mm	111mm	11mm	19mm	10.0mm	22.2mm	68mm	63mm	85g
FS#06	7/16" unf	11mm	122mm	12mm	22mm	11.0mm	25.4mm	75mm	68mm	120g
FS#07	1/2" unf	12mm	144mm	15mm	25mm	12.7mm	28.6mm	90mm	83mm	185g
FS#08	5/8" unf	14mm	162mm	17mm	28mm	14.0mm	34.9mm	100mm	93mm	335g
FS#10	5/8" unf	16mm	175mm	18mm	32mm	16.0mm	38.1mm	100mm	93mm	400g
FS#12	3/4" unf	19mm	207mm	23mm	38mm	19.0mm	47.6mm	120mm	111mm	750g
FS#14	7/8" unf	22mm	236mm	26mm	45mm	22.2mm	54.0mm	140mm	130mm	1075g
FS#16	1" unf	25mm	271mm	31mm	50mm	25.4mm	63.5mm	160mm	150mm	1690g
FS#19	1 1/8" unf	28mm	303mm	33mm	58mm	28.6mm	69.9mm	180mm	163mm	2350g
FS#22	1 1/4" unf	32mm	338mm	39mm	64mm	32.0mm	76.2mm	200mm	188mm	3200g
FS#26	1 3/8" unf	35mm	372mm	44mm	70mm	35.0mm	82.5mm	220mm	208mm	4000g

Replace # with C for closed body style or O for open style. Suffix R or L for right or left hand thread.

PRODUCT CODE	THREADS	P	T	C	L	OT	NOMINAL WEIGHT
TS#03	1/4" unf	6mm	8mm	14mm	82mm	42mm	30g
TS#04	5/16" unf	8mm	9mm	19mm	100mm	49mm	64g
TS#05	3/8" unf	9.5mm	11mm	21mm	120mm	63mm	110g
TS#06	7/16" unf	11mm	13mm	26mm	134mm	68mm	208g
TS#07	1/2" unf	12.7mm	15mm	28mm	158mm	83mm	284g
TS#10	5/8" unf	16mm	19mm	37mm	190mm	93mm	593g
TS#12	3/4" unf	19mm	22mm	45mm	223mm	111mm	1062g
TS#14	7/8" unf	22mm	25mm	54mm	259mm	130mm	1882g
TS#16	1" unf	25mm	28mm	64mm	299mm	150mm	2523g
TS#19	1 1/8" unf	28mm	32mm	68mm	334mm	168mm	3917g
TS#22	1 1/4" unf	32mm	35mm	84mm	380mm	188mm	5628g
TS#26	1 3/8" unf	35mm	38mm	98mm	425mm	208mm	7409g

Replace # with C for closed body style or O for open style. Suffix R or L for right or left hand thread.

STAINLESS STEEL THREAD TOGGLE THREADED
TERMINALS - TOGGLE STUDS RH & LH

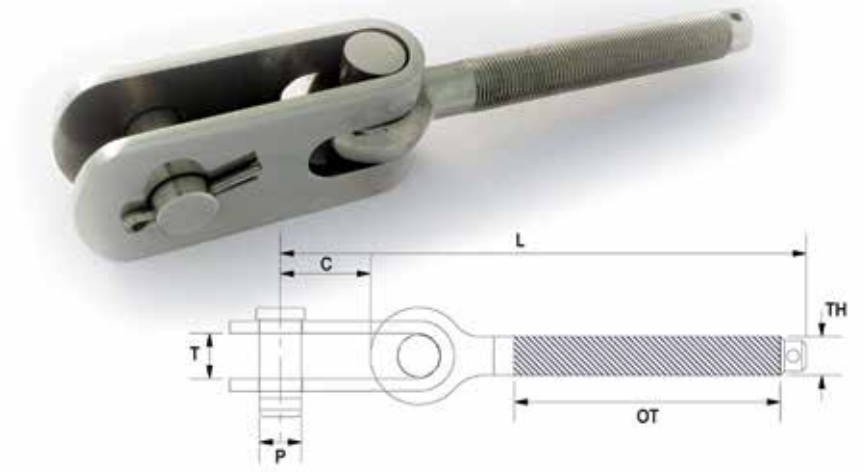

STAINLESS STEEL SHACKLE TOGGLE THREADED TERMINALS - SHACKLE TOGGLE STUDS RH & LH

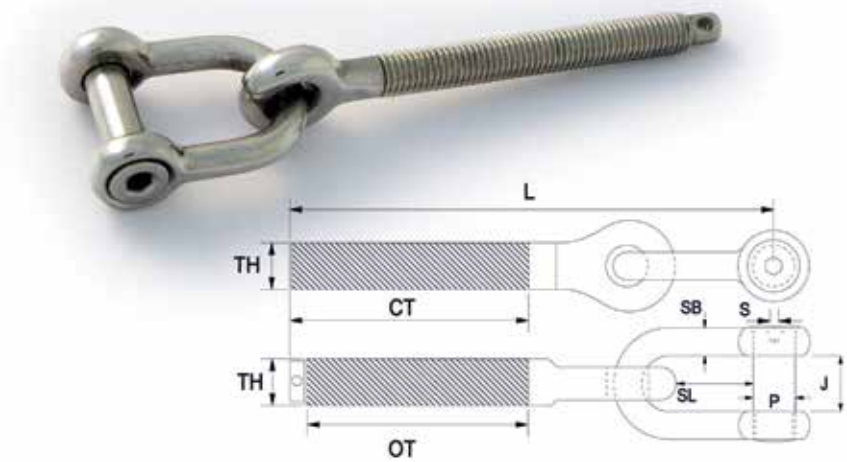

PRODUCT CODE	THREAD	P	SB	SL	S	J	L	CT	OT	NOMINAL WEIGHT
STS#03	1/4" unf	6mm	5mm	14mm	3mm	14mm	82mm	47mm	42mm	23g
STS#04	5/16" unf	8mm	6mm	16mm	4mm	20mm	101mm	54mm	49mm	43g
STS#05	3/8" unf	9.5mm	8mm	22mm	4mm	22mm	118mm	68mm	63mm	78g
STS#06	7/16" unf	11mm	9.5mm	27mm	5mm	25mm	141mm	75mm	68mm	129g
STS#07	1/2" unf	12mm	11mm	32mm	5mm	27mm	158mm	90mm	83mm	221g
STS#08	5/8" unf	14.3mm	12.7mm	36mm	5mm	29mm	179mm	100mm	93mm	455g
STS#10	5/8" unf	16mm	14.3mm	42mm	6mm	29mm	216mm	100mm	93mm	686g
STS#12	3/4" unf	19mm	16mm	45mm	6mm	32mm	263mm	120mm	111mm	995g
STS#14	7/8" unf	22.2mm	19mm	63mm	8mm	38mm	309mm	140mm	130mm	1536g
STS#16	1" unf	25.4mm	22mm	63mm	8mm	45mm	351mm	160mm	150mm	2575g

Replace # with C for closed body style or O for open style. Suffix R or L for right or left hand thread.

INSULATORS

INSULATORS

The only fail safe rigging insulator for wire available on the market today, the Hi-MOD backstay insulator has an internal ball-socket in the main body. The nut is insulated from the stainless steel body by a Tufnol™ socket, preventing electrical transference to the insulator body or opposite terminal. Should, for any reason, the Tufnol™ be compromised, the nut will bottom out against the stainless housing. While the backstay will loosen, the insulating studs will remain attached to the insulator body-allowing the rig to be re-tensioned until a repair can be made.

Available with swageless terminals, swage terminals, rod sockets and eye, fork and Toggle ends to suit any application. The insulators 'Demis' can be used in any combination for maximum flexibility. Swage stud insulators can be provided with the two demis not glued together allowing them to be swaged with a wiretechnik swaging machine – a special puller is required, please contact us for further information.



WIRE RIGGING INSULATORS

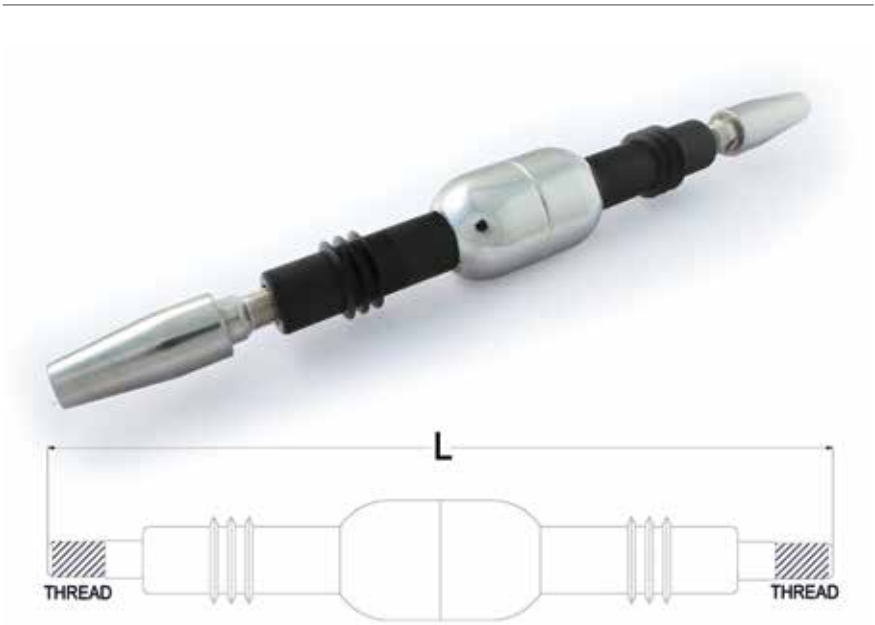

WIRE SIZE	PIN SIZE	HOLE SIZE	C-L	E-L	S-L	F-L	T-L	PULLER CODE
5mm	11mm	11.1mm	106mm	107mm	101mm	121mm	147mm	RIP7/16
6mm	11mm	11.1mm	110mm	107mm	101mm	121mm	147mm	RIP7/16
7mm	12.7mm	12.7mm	131mm	129mm	120mm	142mm	169mm	RIP1/2
8mm	14mm	14.28mm	153mm	151mm	140mm	164mm	212mm	RIP5/8
10mm	16mm	16.2mm	159mm	155mm	142mm	176mm	212mm	RIP5/8
12mm	19mm	19.05mm	192mm	180mm	168mm	207mm	258mm	RIP3/4
14mm	22mm	22.2mm	222mm	207mm	196mm	238mm	297mm	RIP7/8
16mm	25mm	25.4mm	258mm	237mm	226mm	271mm	337mm	RIP1

Larger sizes available, please ask for details.

C-L	E-L	S-L	F-L	T-L
CODE: C	CODE: E	CODE: S	CODE: F	CODE: T
Compression End	Eye End	Swage Stud End	Fork End	Toggle End

The product codes for rigging insulators are made up by suffixing “RI” with the relevant fittings followed by the wire size, for example, the above diagram would be coded RICC06. All insulators can be swaged using most types of swaging machines. WireTeknik machines require a special pulling tool, see the table below for the correct puller code.

PRODUCT CODE	ROD SIZE	SOCKET/CAP THREAD	THREAD LENGTH	LENGTH L	WEIGHT EACH	TYPICAL M.B.L
Rod Insulator - Complete Assembly including Rod Caps						
RIRR-8	-8	7/16" UNF RH	17mm	244mm		67kN
RIRR-10	-10	1/2" UNF RH	19mm	250mm		67kN
RIRR-12	-12	5/8" UNF RH	24mm	310mm		108kN
RIRR-15	-15	5/8" UNF RH	24mm	310mm		108kN
RIRR-17	-17	5/8" UNF RH	24mm	310mm		108kN
RIRR-22	-22	3/4" UNF RH	29mm	356mm		157kN
RIRR-30	-30	7/8" UNF RH	33mm	378mm		215kN
RIRR-40	-40	1" UNF RH	35mm			
Rod Insulator - Body Only						
RIRR-7/16		7/16" UNF RH	17mm	244mm	560g	67kN
RIRR-1/2		1/2" UNF RH	19mm	250mm	790g	67kN
RIRR-9/16		9/16" UNF RH	24mm	304mm	1360g	108kN
RIRR-5/8		5/8" UNF RH	24mm	310mm	1360g	108kN
RIRR-3/4		3/4" UNF RH	29mm	356mm	1490g	157kN
RIRR-7/8		7/8" UNF RH	33mm	378mm	1690g	215kN
RIRR-1		1" UNF RH	35mm			

ROD RIGGING INSULATORS



TOGGLES

TOGGLES

Our strap-Toggles are bent from high-quality 316L stainless plate with the same degree of care as our stainless steel lifting shackles resulting in a reliable and consistent product. Bar Toggles are machined from high-quality European made 316L bar. All Toggles are finished with a mirror polish finish.

NOTE: Throughout this catalogue we use the following convention – the pin size is the smallest diameter hole that our pin will fit into, the hole size is the largest diameter pin that will fit in the hole. For example if we list a pin as being 12mm then the pin will fit into a 12mm diameter hole and conversely if we list a hole as being 16mm then a 16mm diameter pin will fit in the hole. If in doubt please ask.



STAINLESS STEEL DOUBLE JAW TOGGLES

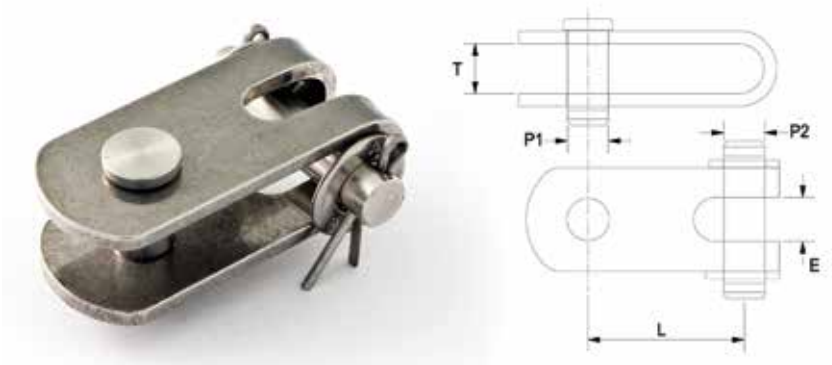

PRODUCT CODE	P1/P2	T	E	L
DJT06	6.0mm	8.0mm	5.8mm	21mm
DJT08	8.0mm	9.0mm	8.0mm	27mm
DJT10	9.5mm	11.0mm	9.0mm	32mm
DJT11	11.0mm	13.0mm	11.0mm	39mm
DJT12	12.7mm	15.0mm	13.0mm	41mm
DJT16	16.0mm	19.0mm	16.0mm	54mm
DJT19	19.0mm	22.0mm	18.5mm	66mm
DJT22	22.0mm	25.0mm	25.0mm	79mm
DJT26	25.0mm	28.0mm	25.0mm	94mm
DJT28	28.0mm	32.0mm	28.5mm	99mm
DJT32	32.0mm	35.0mm	32.0mm	119mm
DJT35	35.0mm	38.0mm	35.0mm	140mm

PRODUCT CODE	P	T	Y	L	OL	W	WEIGHT
EJT1/2	12.7mm	13mm	26mm	51mm	81mm	12.5mm	81g
EJT5/8	16mm	17mm	32mm	64mm	101mm	16mm	223g
EJT3/4	19mm	20mm	39mm	74mm	117mm	19mm	413g
EJT7/8	22mm	24mm	47mm	84mm	137mm	22mm	708g
EJT1	25mm	27mm	51mm	100mm	158mm	25mm	891g
EJT11/8	28mm	29mm	59mm	108mm	173mm	28mm	1481g
EJT11/4	32mm	34mm	66mm	123mm	197mm	32mm	1937g
EJT13/8	35mm	37mm	70mm	150mm	234mm	35mm	3164g

STAINLESS STEEL EYE JAW TOGGLES



STAINLESS STEEL BAR TOGGLES



PRODUCT CODE	P	C	T	H	OD	L	WEIGHT
TOG03	6.0mm	12.5mm	6.2mm	6.35mm	14.3mm	42mm	22g
TOG04	8.0mm	17mm	7.9mm	8.00mm	18.0mm	53mm	44g
TOG05	9.5mm	19mm	9.9mm	9.53mm	22.2mm	64mm	84g
TOG06	11.0mm	22mm	10.9mm	11.11mm	25.4mm	72mm	100g
TOG07	12.0mm	25mm	12.7mm	12.70mm	28.6mm	87mm	180g
TOG08	14.0mm	28mm	13.8mm	14.28mm	34.9mm	95mm	292g
TOG10	16.0mm	32mm	15.8mm	16.00mm	38.1mm	106mm	424g
TOG12	19.0mm	38mm	17.8mm	19.05mm	47.6mm	125mm	724g
TOG14	22.0mm	45mm	22.0mm	22.22mm	54.0mm	146mm	825g
TOG16	25mm	50mm	25.0mm	25.40mm	63.5mm	162mm	1790g
TOG19	28.0mm	58mm	28.2mm	28.58mm	69.9mm	184mm	2415g
TOG22	32.0mm	64mm	31.8mm	32.00mm	76.2mm	207mm	3229g
TOG26	35.0mm	70mm	34.8mm	35.00mm	82.5mm	227mm	5624g

GUARD RAIL FITTINGS, PINS & SPARES



STAINLESS STEEL CLEVIS PIN INCLUDING SPLIT PINS
AND SPLIT RINGS

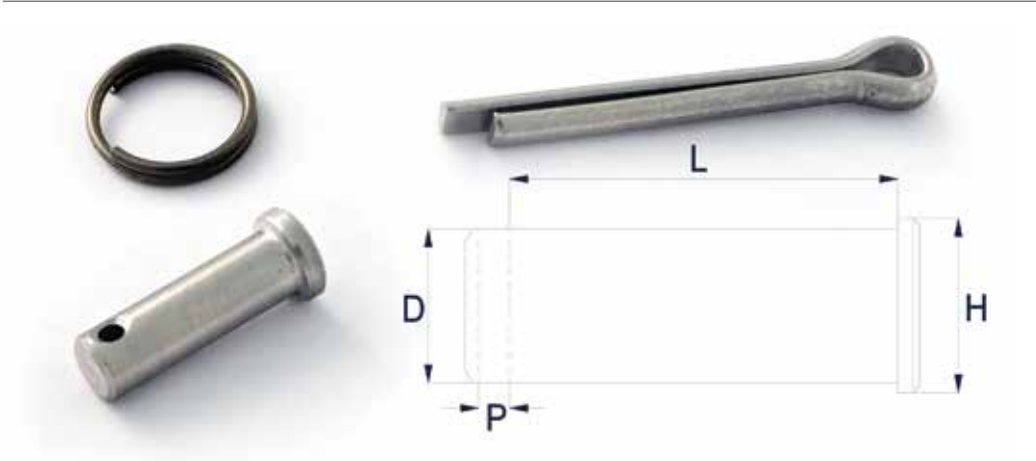

PRODUCT CODE	D	P	H	L	WEIGHT	PIN/RING
CP06	5.9mm	2.0mm	8.0mm	15.0mm	4g	SP-07/SR1
CP08	7.9mm	2.2mm	9.5mm	18.4mm	10g	SP-07/SR2
CP10	9.5mm	2.6mm	11.1mm	22.5mm	16g	SP-01
CP11	11.0mm	2.8mm	12.7mm	25.7mm	22g	SP-01
CP12	11.9mm	3.0mm	14.3mm	28.9mm	32g	SP-02
CP14	13.9mm	3.5mm	16.0mm	35.2mm	50g	SP-02
CP16	15.9mm	3.5mm	19.0mm	38.4mm	72g	SP-02
CP19	18.8mm	4.2mm	22.2mm	44.8mm	126g	SP-03
CP22	22.0mm	4.2mm	25.4mm	51.1mm	190g	SP-03
CP25	25.3mm	5.1mm	28.6mm	63.8mm	298g	SP-04
CP28	28.0mm	5.1mm	31.7mm	70.2mm	394g	SP-04
CP32	31.8mm	6.5mm	34.9mm	76.5mm	550g	SP-05
CP35	34.8mm	6.5mm	38.1mm	82.8mm	718g	SP-05

PRODUCT CODE	SIZE	PRODUCT CODE	SIZE	PRODUCT CODE	SIZE	PRODUCT CODE	SIZE
SP-01	3/32 x 3/4	SP-08	1/4 x 3	SR-1	10 x 1mm	SR-6	25 x 1.2mm
SP-02	1/8 x 1	SP-09	3/32 x 1/2	SR-2	14 x 1mm	SR-7	24 x 2mm
SP-03	3/32 x 1 1/4	SP-10	3/32 x 1	SR-3	3/4 x 1mm	SR-8	11 x 1mm
SP-04	3/16 x 1 1/2	SP-11	1/8 x 1 3/4	SR-4	7/8 x 1.2mm	SR-9	5/8 x 1mm
SP-05	1/4 x 2	SP-12	4x 63mm	SR-5	22 x 1mm		
SP-06	1/8 x 1 1/2	SP-13	3/8x 3 1/2				
SP-07	1/16 x 1/2						

PRODUCT CODE	THREAD SIZE	THREAD DIRECTION	WIDTH	OD	A/F
ROUND PATTERN - DESIGNED FOR USE WITH CLOSED BODY TURNBUCKLES					
RLN1/4	1/4" unf	RH or LH	3.8mm	10mm	8mm
RLN5/16	5/16" unf	RH or LH	5.4mm	13mm	10mm
RLN3/8	3/8" unf	RH or LH	6.3mm	14mm	12mm
RLN7/16	7/16" unf	RH or LH	7.8mm	16mm	13mm
RLN1/2	1/2" unf	RH or LH	7.8mm	19mm	16mm
RLN5/8	5/8" unf	RH or LH	11mm	22mm	19mm
RLN3/4	3/4" unf	RH or LH	13mm	27mm	24mm
RLN1	1" unf	RH or LH	14mm	38mm	33mm
RLN11/8	1 1/8" unf	RH or LH	16mm	44mm	37mm
RLN11/4	1 1/4" unf	RH or LH	18mm	50mm	40mm
RLN13/8	1 3/8" unf	RH or LH	20mm	54mm	46mm

STAINLESS STEEL ROUND LOCKING NUTS



STAINLESS STEEL HALYARD CLEATS, LACING EYES AND BOAT RINGS



STAINLESS STEEL GRADE 316 HALYARD CLEAT						
PRODUCT CODE	B	C	D	L	X	Y
HC55	6mm	10mm	3.4mm	55mm	7mm	3mm
HC75	8mm	11mm	5.0mm	75mm	9.4mm	4mm
HC90	9.5mm	15.8mm	6.3mm	90mm	12.5mm	5mm
HC120	12.7mm	21mm	6.3mm	120mm	20mm	6mm
HC150	16mm	25.5mm	7.9mm	150mm	24.5mm	7mm

STAINLESS STEEL GRADE 316 LACING EYES				
PRODUCT CODE	D	H	W	TYPE
4E	3.2mm	9.0mm	30mm	Round Bar
5E	6.5mm	12.0mm	41mm	Flat Bar
6E	6.3mm	10.5mm	45mm	Round Bar
8E	8.3mm	18.5mm	63mm	Round Bar

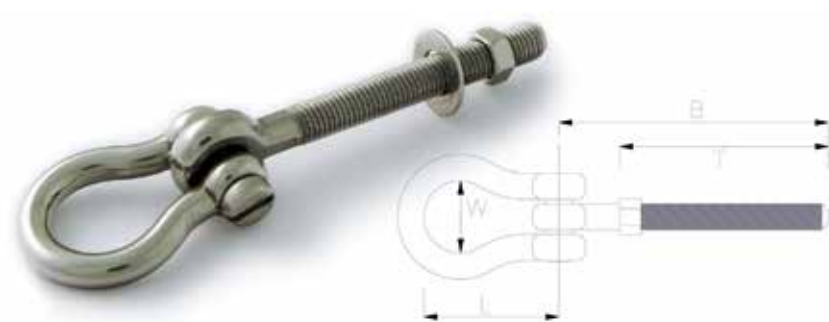

STAINLESS STEEL GRADE 316 BOAT RINGS					
PRODUCT CODE	B	L	T	W	THREAD SIZE
BR5/16	72mm	33mm	54mm	17mm	5/16" unf RH
BR3/8	88mm	39mm	68mm	20mm	3/8" unf RH

STAINLESS STEEL THIMBLES

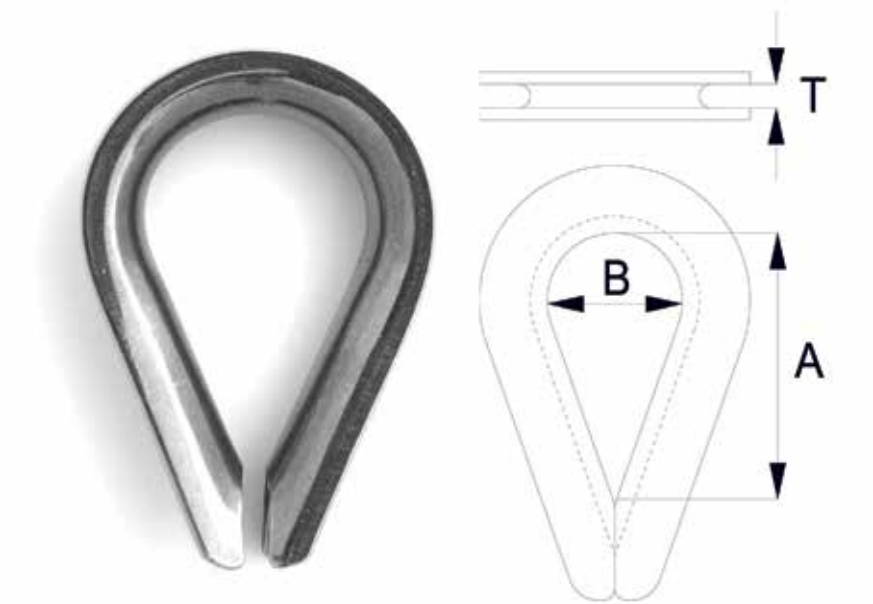

PRODUCT CODE	GROOVE WIDTH	A	B	THICKNESS	WEIGHT (kg)
THIM-020	2mm	12mm	8mm	1.0mm	0.003
THIM-2.50	2.5mm	16mm	10mm	1.0mm	0.004
THIM-030	3mm	16mm	10mm	1.0mm	0.004
THIM-040	4mm	17mm	11mm	1.0mm	0.005
THIM-050	5mm	20mm	13mm	1.0mm	0.006
THIM-060	6mm	25mm	16mm	1.2mm	0.01
THIM-070	7mm	28mm	18mm	1.2mm	0.012
THIM-080	8mm	32mm	20mm	1.4mm	0.018
THIM-100	10mm	40mm	26mm	1.6mm	0.029
THIM-120	12mm	45mm	28mm	2.0mm	0.046
THIM-140	14mm	56mm	34mm	2.2mm	0.09
THIM-160	16mm	62mm	37mm	2.5mm	0.104
THIM-180	18mm	68mm	42mm	2.8mm	0.171
THIM-200	20mm	75mm	46mm	3.4mm	0.277
THIM-220	22mm	85mm	50mm	3.6mm	0.297
THIM-240	24mm	94mm	58mm	4.5mm	0.549
THIM-260	26mm	102mm	66mm	4.5mm	0.605
THIM-280	28mm	115mm	75mm	4.5mm	0.88
THIM-320	32mm	125mm	80mm	6.0mm	1.4
THIM-360	36mm	160mm	100mm	6.0mm	1.85

PRODUCT CODE	WIRE ROPE DIAMETER	A	B1	B2	D	H1	H2	L	WEIGHT (kg)
CLIP-02	2mm	9mm	4mm	13mm	M3	18mm	11mm	14mm	0.008
CLIP-03	3mm	12mm	5mm	16mm	M4	25mm	12mm	17mm	0.015
CLIP-04	4mm	13mm	6mm	18mm	M4	25mm	14mm	19mm	0.029
CLIP-05	5mm	15mm	7mm	20mm	M5	29mm	15mm	24mm	0.031
CLIP-06	6mm	18mm	8mm	21mm	M6	31mm	17mm	27mm	0.040
CLIP-08	8mm	23mm	10mm	27mm	M8	41mm	21mm	34mm	0.077
CLIP-10	10mm	28mm	12mm	34mm	M10	52mm	25mm	45mm	0.17
CLIP-12	12mm	35mm	14mm	38mm	M12	61mm	28mm	51mm	0.265
CLIP-14	14mm	42mm	15mm	43mm	M12	68mm	32mm	52mm	0.31
CLIP-16	16mm	42mm	18mm	47mm	M14	76mm	36mm	60mm	0.5
CLIP-19	19mm	50mm	20mm	51mm	M14	79mm	40mm	62mm	0.58
CLIP-22	22mm	60mm	26mm	61mm	M16	98mm	46mm	72mm	0.8
CLIP-25	25mm	62mm	29mm	61mm	M16	110mm	49mm	76mm	1.08

WIRE ROPE CLIPS - STAINLESS STEEL 316

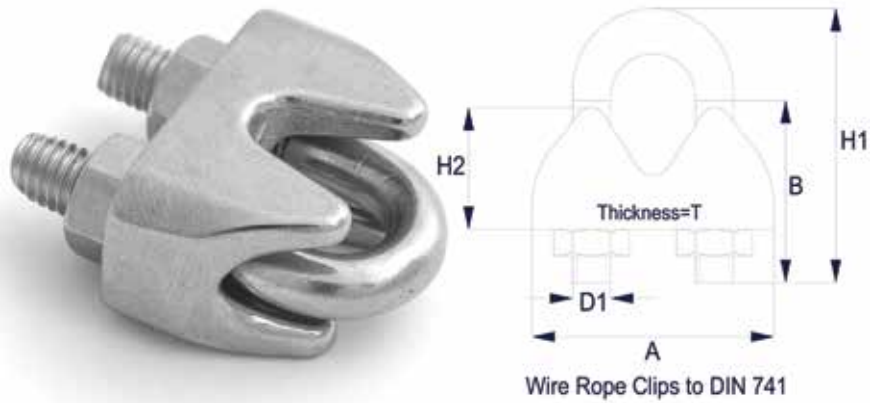

GUARD RAIL/LIFE LINE STUDS, PELICAN HOOKS AND GATE EYES

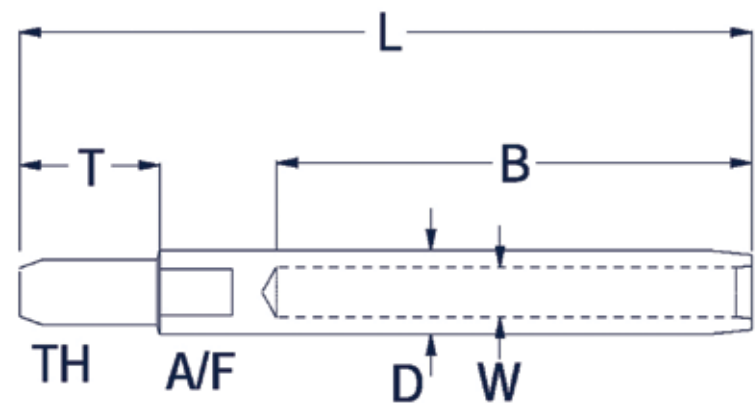

GUARD RAIL & LIFE LINE FITTINGS - PELICAN HOOKS AND GATE EYES

PRODUCT CODE	DESCRIPTION	LENGTH	THREAD SIZE	EYE ID	
H516PHL	5/16" Pelican Hook Body	101mm	5/16" unf LH	n/a	
H516PHR	5/16" Pelican Hook Body	101mm	5/16" unf RH	n/a	
H516GES	5/16" Single Gate Eye	43.5mm	5/16" unf LH	14.3mm	
H516GEI	5/16" Interlocking Gate Eye	75mm	5/16" unf LH	14.3mm	

GUARD RAIL & LIFE LINE FITTINGS

PRODUCT CODE	DESCRIPTION	WIRE	THREAD SIZE	D	B	L	A/F
GR55/16X4L	5/16" LH Short Stud for 4mm Wire	4mm	5/16" unf LH	7.5mm	45mm	113mm	6mm
GR55/16X5L	5/16" LH Short Stud for 5mm Wire	5mm	5/16" unf LH	9.1mm	52mm	123mm	6mm



ROD RIGGING FITTINGS

ROD RIGGING FITTINGS

Petersen fittings for NITRONIC50 Rod Rigging have been designed with a seat profile compatible with the majority of die sets in the market. If you have any doubts about your specific die set or wish a check to be made simply send us a short piece of headed rod and we will make sure it sits correctly in our rod seat.

All Petersen rod fittings are made in our UK factory from high quality European materials. All parts are fully traceable from the invoice number back to the raw material certificate. Material certificates and certificates of conformance can be provided on request.

Our flexible design and manufacturing allows us to create special parts quickly and cost-effectively. If you do not see the part you need please contact us.



ROD CAPS

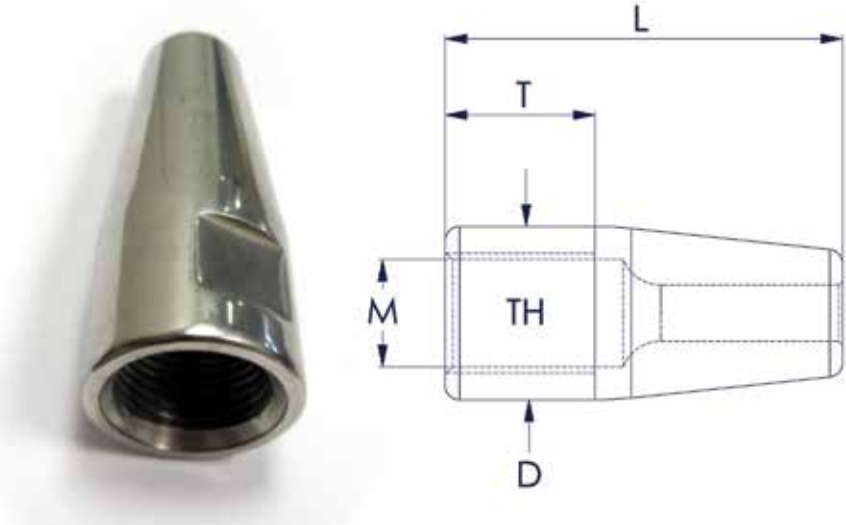

PRODUCT CODE	SIZE	THREAD	D	L	T	M	A/F
RCAP-4	-4	3/8"	12.5mm	29mm	12mm	8.3mm	11mm
RCAP-6	-6	7/16"	16mm	37mm	14mm	9.7mm	14mm
RCAP-8	-8	7/16"	16mm	37mm	14mm	9.7mm	14mm
RCAP-10	-10	1/2"	19mm	44mm	16mm	11.3mm	16mm
RCAP-12	-12	1/2"	19mm	44mm	16mm	11.3mm	16mm
RCAP-15	-15	5/8"	22mm	52mm	20mm	14.3mm	20mm
RCAP-17	-17	5/8"	22mm	52mm	20mm	14.3mm	20mm
RCAP-22	-22	3/4"	25mm	58mm	24mm	17.3mm	22mm
RCAP-30	-30	7/8"	30mm	69mm	28mm	20.3mm	30mm
RCAP-40	-40	1"	35mm	80mm	32mm	23.0mm	30mm
RCAP-48	-48	1-1/8"	38mm	88mm	36mm	26.2mm	34mm
RCAP-60	-60	1-1/4"	44mm	101mm	40mm	29.5mm	38mm

PRODUCT CODE	ROD	H	L	T
HMRE3/8-4	-4	9.53mm	22mm	7.8mm
HMRE7/16-6	-6	11.1mm	28mm	9.5mm
HMRE7/16-8	-8	11.1mm	32mm	9.6mm
HMRE1/2-8	-8	12.7mm	38mm	11.5mm
HMRE1/2-10	-10	12.7mm	43mm	11.5mm
HMRE1/2-12	-12	12.7mm	45mm	11.5mm
HMRE5/8-12	-12	16.0mm	48mm	15.0mm
HMRE5/8-15	-15	16.0mm	52mm	15.0mm
HMRE5/8-17	-17	16.0mm	56mm	15.0mm
HMRE5/8-22	-22	16.0mm	59mm	15.0mm
HMRE3/4-22	-22	19.05mm	65mm	17.5mm
HMRE7/8-30	-30	22.2mm	75mm	21.5mm
HMRE1-40	-40	25.4mm	94mm	23.5mm
HMRE11/8-48	-48	28.6mm	106mm	27.5mm
HMRE11/4-60	-60	32.0mm	101mm	31.0mm

ROD MARINE EYE ASSEMBLIES

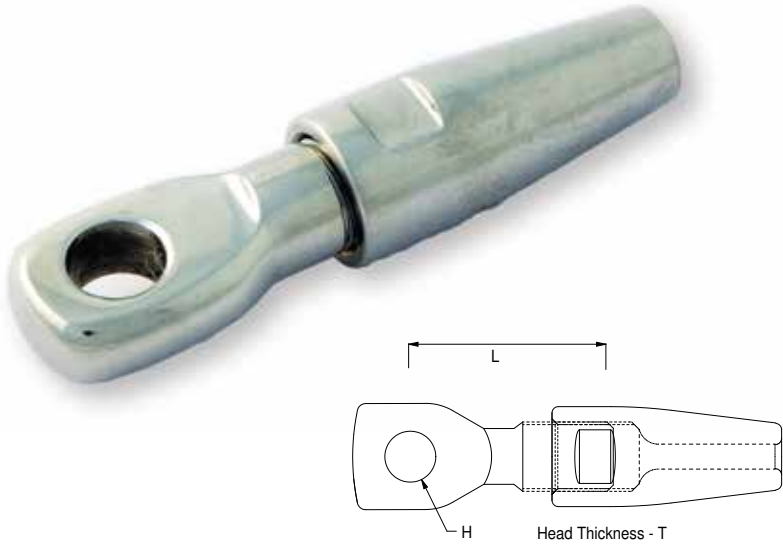

ROD STUDS

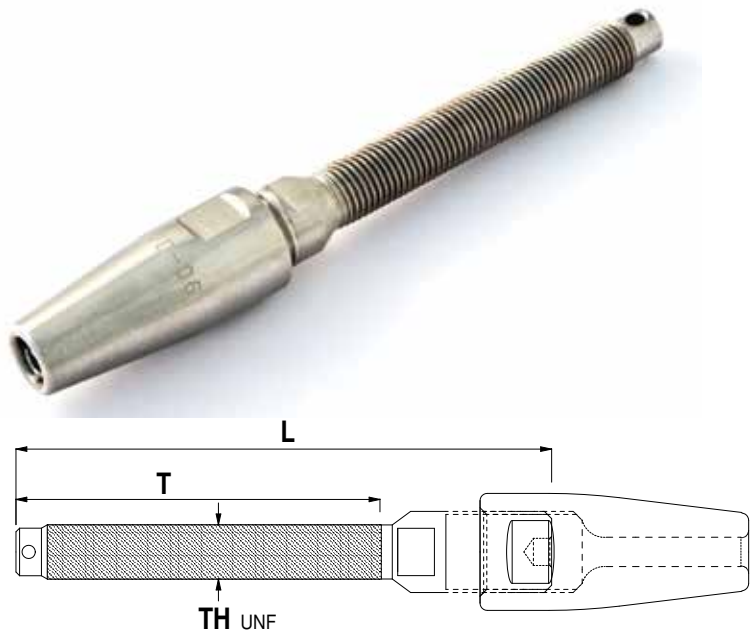

PRODUCT CODE	ROD	THREAD	T	L	A/F S	A/F B
HMR53/8-4	-4	3/8" unf	71mm	94mm	8mm	11mm
HMR57/16-6	-6	7/16" unf	80mm	105mm	9mm	14mm
HMR57/16-8	-8	7/16" unf	80mm	105mm	9mm	14mm
HMR51/2-8	-8	1/2" unf	88mm	113mm	11mm	14mm
HMR51/2-10	-10	1/2" unf	88mm	113mm	11mm	16mm
HMR51/2-12	-12	1/2" unf	88mm	113mm	11mm	16mm
HMR55/8-12	-12	5/8" unf	103mm	133mm	14mm	20mm
HMR55/8-15	-15	5/8" unf	103mm	137mm	14mm	20mm
HMR55/8-17	-17	5/8" unf	103mm	137mm	14mm	20mm
HMR55/8-22	-22	5/8" unf	103mm	137mm	14mm	22mm
HMR53/4-22	-22	3/4" unf	123mm	162mm	17mm	22mm
HMR57/8-30	-30	7/8" unf	143mm	198mm	20mm	27mm
HMR51-40	-40	1" unf	162mm	220mm	22mm	30mm
HMR511/8-48	-48	1 1/8" unf	180mm	250mm	24mm	34mm
HMR511/4-60	-60	1 1/4" unf	202mm	267mm	25mm	38mm

PRODUCT CODE	ROD	P	C	T	L
HMRT3/8-4	-4	9.5mm	21mm	11mm	52mm
HMRT7/16-6	-6	11mm	25mm	13mm	68mm
HMRT7/16-8	-8	11mm	25mm	13mm	68mm
HMRT1/2-8	-8	12.7mm	27mm	15mm	81mm
HMRT1/2-10	-10	12.7mm	27mm	15mm	86mm
HMRT1/2-12	-12	12.7mm	27mm	15mm	88mm
HMRT5/8-12	-12	16mm	36mm	19mm	105mm
HMRT5/8-15	-15	16mm	36mm	19mm	109mm
HMRT5/8-17	-17	16mm	36mm	19mm	109mm
HMRT5/8-22	-22	16mm	36mm	19mm	117mm
HMRT3/4-22	-22	19mm	45mm	22mm	122mm
HMRT7/8-30	-30	22mm	53mm	25mm	163mm
HMRT1-40	-40	25mm	62mm	28mm	194mm
HMRT11/8-48	-48	28mm	63mm	32mm	222mm
HMRT11/4-60	-60	32mm	76mm	35mm	226mm

ROD TERMINAL TOGGLE END

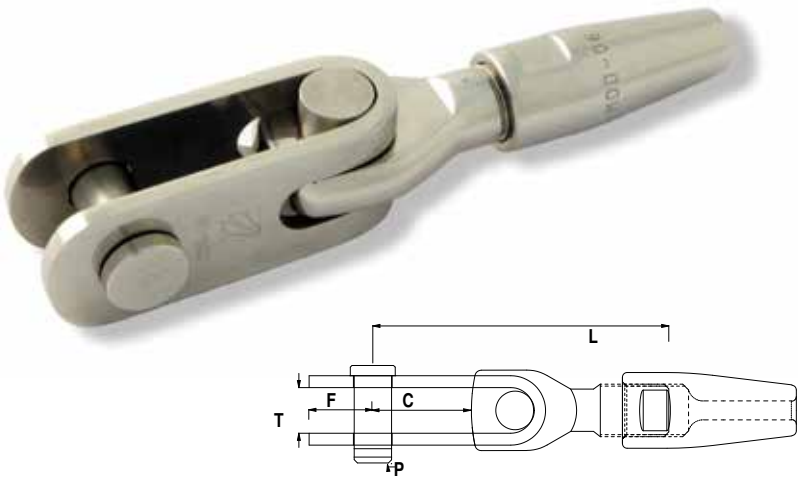

316L ROD STEMBALL

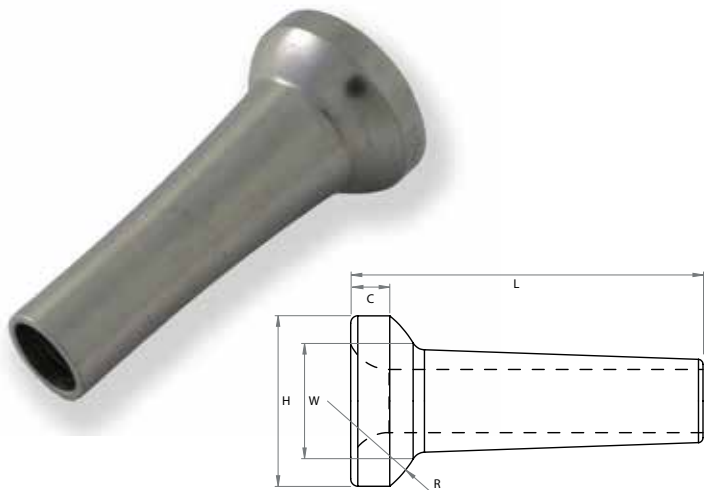

PRODUCT CODE	L	H	W	C	R	NOMINAL WEIGHT
RSB-4-079	26.4mm	12.1mm	8.39mm	3.14mm	7.94mm	7g
RSB-6-087	30.2mm	14.0mm	9.22mm	3.23mm	8.74mm	9g
RSB-8-111	34.3mm	17.3mm	11.89mm	4.67mm	11.11mm	19g
RSB-10-111	38.1mm	17.3mm	11.85mm	4.67mm	11.11mm	19g
RSB-12-127	42.9mm	19.6mm	13.69mm	5.28mm	12.7mm	28g
RSB-15-150	45.2mm	23.1mm	16.87mm	7.21mm	15.09mm	51g
RSB-17-150	50.3mm	23.1mm	16.68mm	6.11mm	15.09mm	49g
RSB-22-167	57.2mm	26.2mm	18.42mm	6.19mm	16.66mm	67g
RSB-30-190	66.5mm	30.2mm	20.73mm	6.81mm	19.05mm	98g
RSB-40-222	77mm	35.1mm	23.93mm	8.54mm	22.23mm	156g
RSB-48-254	86.6mm	38.9mm	27.61mm	11.04mm	25.4mm	233g
RSB-60-269	101.6mm	42.2mm	28.03mm	12.12mm	26.92mm	257g
RSB-76-302	107.4mm	48.9mm	30.54mm	10.38mm	30.23mm	356g
RSB-91-341	107.4mm	53.3mm	36.34mm	13.94mm	34.14 mm	557g

PRODUCT CODE		ROD SIZE	T	THR	HW
SHROUD	ROD CAP				
SH06-7/16	RCAP-6-12	-6	14.3mm	1/2X20	16.0mm
SH07-1/2	RCAP-8-12	-8	14.3mm	1/2X20	19.0mm
SH08-1/2	RCAP-10	-10	16.2mm	1/2X20	22.0mm
SH10-5/8	RCAP-12-58	-12	17.8mm	5/8X18	28.0mm
SH10-5/8	RCAP-15	-15	17.8mm	5/8X18	30.0mm
SH12-3/4	RCAP-17	-17	21.4mm	3/4X16	32.0mm
SH12-3/4	RCAP-22	-22	21.4mm	3/4X16	38.0mm

ROD SHROUD TERMINALS

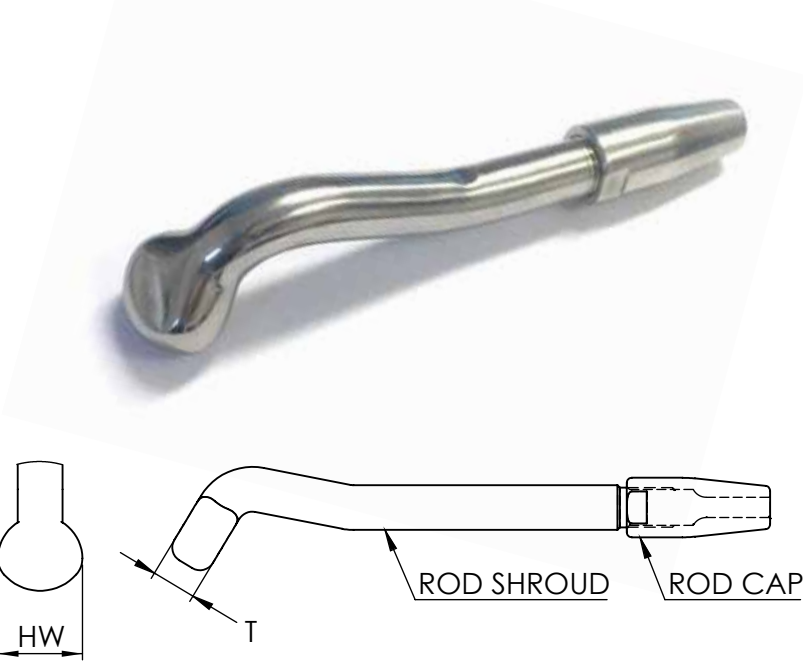

SUPER DUPLEX ROD STEMBALL

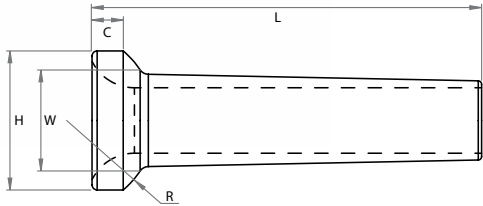

PRODUCT CODE	L	H	W	C	R	NOMINAL WEIGHT
RSB-4-063	26.4mm	9.4mm	7.02mm	2.27mm	6.35mm	3g
RSB-6-071	30.5mm	10.9mm	8.09mm	2.57mm	7.11mm	5g
RSB-8-079	34.5mm	12.4mm	8.82mm	2.68mm	7.95mm	7g
RSB-10-087	38.4mm	13.7mm	9.92mm	3.13mm	8.74mm	9g
RSB-12-100	43.2mm	15.3mm	11.34mm	3.54mm	10.01mm	14g
RSB-15-103	45.5mm	16.3mm	11.9mm	3.81mm	10.31mm	16g
RSB-17-119	50.8mm	18.0mm	13.4mm	4.20mm	11.91mm	23g
RSB-22-134	57.7mm	20.6mm	15.0mm	5.61mm	13.49mm	32g
RSB-30-158	67.1mm	24.1mm	18.5mm	5.54mm	15.88mm	58g
RSB-40-174	76.7mm	27.4mm	21.1mm	5.71mm	17.40mm	85g
RSB-48-198	86.4mm	31.0mm	23.7mm	7.08mm	19.84 mm	122g
RSB-60-235	101.3mm	36.3mm	28.2mm	8.33mm	23.50mm	205g
RSB-76-254	108.5mm	38.9mm	28.4mm	8.94mm	25.40mm	217g
RSB-91-270	118.1mm	42.2mm	30.8mm	9.45mm	27.00mm	282g

PRODUCT CODE	L	OD	THREAD	TL	A/F	NOMINAL WEIGHT
RN-4	23.81mm	9.5mm	3/8" - 24	14.3mm	7mm	7g
RN-6	27.69mm	11.1mm	7/16" - 20	16.7mm	8mm	15g
RN-8	27.96mm	11.1mm	7/16" - 20	16.7mm	8mm	14g
RN-10	31.75mm	12.7mm	1/2" - 20	19.1mm	9mm	21g
RN-12	31.75mm	12.7mm	1/2" - 20	19.1mm	9mm	19g
RN-15	40.26mm	16.1mm	5/8" - 18	24.2mm	12mm	45g
RN-17	40.26mm	16.1mm	5/8" - 18	24.2mm	12mm	42g
RN-22	47.63mm	19.0mm	3/4" - 16	28.6mm	16mm	73g
RN-30	55.56mm	22.2mm	7/8" - 14	33.3mm	18mm	116g
RN-40	63.50mm	25.4mm	1" - 12	38.1mm	20mm	173g
RN-48	71.45mm	28.6mm	1 1/8" - 12	42.9mm	22mm	248g
RN-60	79.38mm	31.8mm	1 1/4" - 12	47.6mm	24mm	327g
RN-76	87.25mm	34.9mm	1 3/8" - 12	52.4mm	26mm	441g
RN-91	87.25mm	34.9mm	1 3/8" - 12	52.4mm	28 mm	412g

ROD NOSE

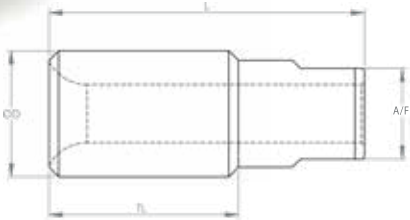
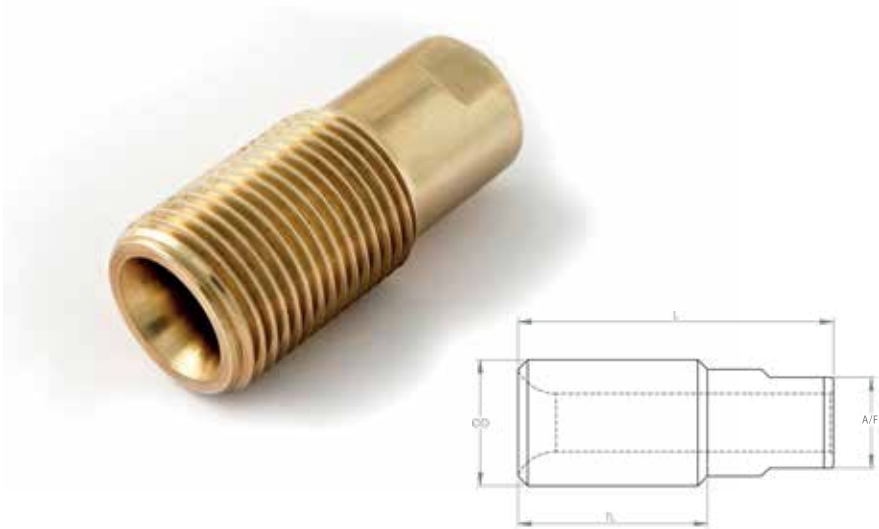

316L SPREADER BEND

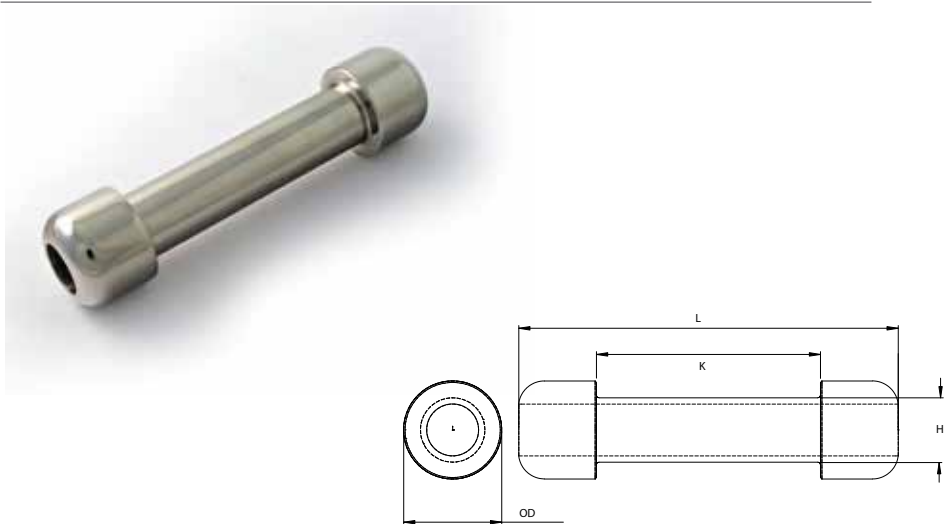

PRODUCT CODE	L	OD	K	H	NOMINAL WEIGHT
HMSB-4	43.0mm	11.1mm	28mm	7mm	15g
HMSB-6	48.0mm	11.1mm	30mm	8mm	18g
HMSB-8	49.5mm	12.7mm	30mm	9mm	24g
HMSB-10	57.0mm	14.3mm	36mm	10mm	34g
HMSB-12	72.8mm	14.3mm	50mm	10mm	36g
HMSB-15	74.0mm	15.9mm	50mm	11mm	49g
HMSB-17	77.0mm	15.9mm	50mm	12mm	53g
HMSB-22	83.0mm	19.1mm	53mm	13mm	75 g
HMSB-30	94.5mm	22.2mm	60mm	15mm	115g
HMSB-40	107.0mm	25.4mm	68mm	17mm	194g
HMSB-48	119.4mm	28.6mm	75mm	18mm	222g
HMSB-60	129.6mm	33.6mm	78mm	22mm	364g
HMSB-76	135.5mm	35.0mm	80mm	23mm	408g

DIAGONAL TBK PART NO.	LENGTH/ADJUSTMENT (+/-)	SUB ASSEMBLY ITEM CODE	DESCRIPTIONS
TT-4	50.0mm	TTB-516	Tip turnbuckle - 5/16 thread
		TTBN-4	Tip turnbuckle Nose for -4 rod
		BSO-516-TT	Stemball for upto -8 rod
TT-6	50.0mm	TTB-516	Tip turnbuckle - 5/16 thread
		TTBN-6	Tip turnbuckle nose for -6 rod
		BSO-516-TT	Stemball for upto -8 rod
TT-8	50.0mm	TTB-516	Tip turnbuckle - 5/16 thread
		TTBN-8	Tip turnbuckle nose for -8 rod
		BSO-516-TT	Stemball for upto -8 rod

TIP TURNBUCKLE

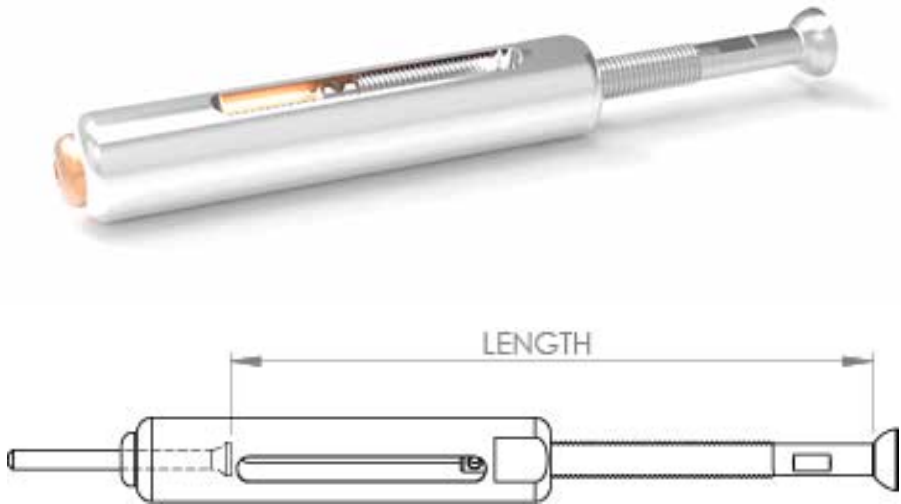

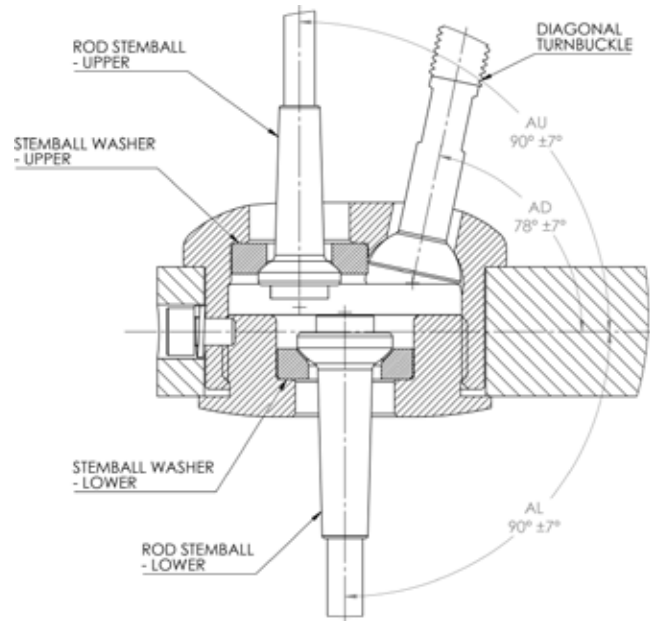

LOWER ROD SIZE	LOWER STEM-BALL PART NO.	LOWER WASHER PART NO.	UPPER ROD SIZE	UPPER STEMBALL PART NO.	UPPER WASHER PART NO.	DIAGONAL ROD SIZE	DIAGONAL TBK PART NO.
-4	RSB-04-079	RSBW-04-079	-4	RSB-04-079	RSBW-04-079	-4	TT-4
-6	RSB-06-087	RSBW-06-087	-4	RSB-04-079	RSBW-04-079	-4	TT-4
			-6	RSB-06-087	RSBW-06-087	-4	TT-4
			-6	RSB-06-087	RSBW-06-087	-6	TT-6
-8	RSB-08-111	RSBW-08-111	-4	RSB-04-079	RSBW-04-079	-4	TT-4
			-6	RSB-06-087	RSBW-06-087	-4	TT-4
			-6	RSB-06-087	RSBW-06-087	-6	TT-6
			-8	RSB-08-111	RSBW-08-111	-4	TT-4
			-8	RSB-08-111	RSBW-08-111	-6	TT-6
			-8	RSB-08-111	RSBW-08-111	-8	TT-8
-10	RSB-10-111	RSBW-10-111	-4	RSB-04-079	RSBW-04-079	-4	TT-4
			-6	RSB-06-087	RSBW-06-087	-4	TT-4
			-6	RSB-06-087	RSBW-06-087	-6	TT-6
			-8	RSB-08-111	RSBW-08-111	-4	TT-4
			-8	RSB-08-111	RSBW-08-111	-6	TT-6
			-8	RSB-08-111	RSBW-08-111	-8	TT-8
			-10	RSB-10-111	RSBW-10-111	-4	TT-4
			-10	RSB-10-111	RSBW-10-111	-6	TT-6
			-10	RSB-10-111	RSBW-10-111	-8	TT-8
-12	RSB-12-100	RSBW-12-100	-6	RSB-06-087	RSBW-06-087	-4	TT-4
			-6	RSB-06-087	RSBW-06-087	-6	TT-6
			-8	RSB-08-111	RSBW-08-111	-4	TT-4
			-8	RSB-08-111	RSBW-08-111	-6	TT-6
			-8	RSB-08-111	RSBW-08-111	-8	TT-8
			-10	RSB-10-111	RSBW-10-111	-4	TT-4
			-10	RSB-10-111	RSBW-10-111	-6	TT-6
			-10	RSB-10-111	RSBW-10-111	-8	TT-8
			-12	RSB-12-100	RSBW-12-100	-4	TT-4
			-12	RSB-12-100	RSBW-12-100	-6	TT-6
			-12	RSB-12-100	RSBW-12-100	-8	TT-8
-15	RSB-15-103	RSBW-15-103	-8	RSB-08-111	RSBW-08-111	-4	TT-4
			-8	RSB-08-111	RSBW-08-111	-6	TT-6
			-8	RSB-08-111	RSBW-08-111	-8	TT-8
			-10	RSB-10-111	RSBW-10-111	-4	TT-4
			-10	RSB-10-111	RSBW-10-111	-6	TT-6
			-10	RSB-10-111	RSBW-10-111	-8	TT-8
			-12	RSB-12-100	RSBW-12-100	-4	TT-4
			-12	RSB-12-100	RSBW-12-100	-6	TT-6
			-12	RSB-12-100	RSBW-12-100	-8	TT-8

SHACKLES

SHACKLES

Petersen Stainless Rigging Ltd. have been producing shackles since day one and the special manufacturing processes we use allows us to make the best quality shackles available on the market today.

Forged shackles are inherently stronger than cast ones (as most low-cost shackles are) as they make use of grain structure from the drawing process used to produce the blanks. Electrical upset forging takes things one stage further by ensuring the grain flows around the shackle head to give maximum strength. Furthermore electrical upsetting does not result in further cold-work which results in benefits for fatigue and corrosion resistance. Upset forging is also extremely flexible so we can make shackles on a custom basis to customers requirements in small quantities with little or no tooling cost.

Shackles are supplied as standard on backing cards. Each card details the product code, barcode, description, material and breaking load of the shackle. Shackles can be supplied bulk-packed for OEM customers - please contact us for further information.



SHACKLE PIN TYPES								
Suffix code with pin type. No suffix - Standard Pin RS - Shake Proof Pin C - Socket Head Pin								
PIN	DESCRIPTION	SIZES	PIN	DESCRIPTION	SIZES	PIN	DESCRIPTION	SIZES
	Standard Screw Pin	4mm to 19mm		Shake Proof Retain Pin	5mm to 16mm		Socket Head Pin	5mm to 19mm

MARINE SHACKLES HIGH RESISTANCE SHACKLES



PRODUCT CODE	PIN P	BODY B	JAW J	INSIDE L	M.B.L*	WEIGHT
HRD06	6mm	6mm	12mm	20mm	2,700kg	24g
HRD08	8mm	8mm	16mm	26mm	4,400kg	53g
HRD10	10mm	9.5mm	20mm	33mm	7,500kg	97g
HRD12	12mm	12.7mm	24mm	39mm	10,000kg	237g
HRD14	14mm	14.3mm	28mm	49mm	14,000kg	365g
HRD16	16mm	16mm	32mm	56mm	19,000kg	470g
HRD20	20mm	20mm	40mm	70mm	28,000kg	605g
Larger Sizes Available						

PIN SIZE	KEY SIZE
5mm	2mm
6mm	3mm
8mm	4mm
10mm	4mm
11mm	5mm
12mm	5mm
16mm	6mm
19mm	6mm

MARINE SHACKLES SOCKET HEAD PIN



MARINE SHACKLES STAINLESS STEEL 316 BOW



PRODUCT CODE	PIN P	BODY B	JAW J	BOW B	INSIDE L	M.B.L*	NOMINAL WEIGHT
B04	4mm	4mm	8mm	12mm	18mm	600kg	9g
B05	5mm	5mm	10mm	16mm	22mm	1200kg	14g
B06	6mm	6mm	13mm	19mm	28mm	1600kg	28g
B08	8mm	8mm	16mm	25mm	35mm	2400kg	59g
B10	9.5mm	9.5mm	19mm	28mm	38mm	3800kg	106g
B11	11mm	11mm	22mm	33mm	46mm	4800kg	161g
B12	12.7mm	12.7mm	26mm	38mm	52mm	6000kg	270g
B16	16mm	14.3mm	29mm	43mm	60mm	8000kg	500g
B19	19mm	16mm	32mm	50mm	68mm	10000kg	630g

Larger shackles manufactured to order. Refer to shake proof and socket head shackle specification sheet for details of pins. Specialist shackles to OEM design also available. Contact our sales department for a very competitive quote. * typical minimum breaking load

STAINLESS STEEL 316 D SHACKLES

PRODUCT CODE	PIN P	BODY B	JAW J	INSIDE L	M.B.L*	NOMINAL WEIGHT
D04	4mm	4mm	8mm	16mm	800kg	7g
D05	5mm	5mm	10mm	20mm	1500kg	13g
D06	6mm	6mm	13mm	25mm	1950kg	24g
D08	8mm	8mm	16mm	32mm	3000kg	53g
D10	9.5mm	9.5mm	19mm	38mm	4800kg	97g
D11	11mm	11mm	22mm	44mm	6000kg	152g
D12	12.7mm	12.7mm	26mm	52mm	7500kg	237g
D16	16mm	14.3mm	29mm	58mm	10000kg	450g
D19	19mm	16mm	32mm	64mm	14000kg	585g

STAINLESS STEEL GRADE 316 WIDE D SHACKLES

WD05	5mm	5mm	20mm	30mm	750kg	15g
WD06	6mm	6mm	25mm	32mm	1300kg	31g
WD08	8mm	8mm	32mm	48mm	2000kg	65g
WD10	10mm	10mm	40mm	60mm	3300kg	116g

MARINE SHACKLES STAINLESS STEEL 316 D AND WIDE D

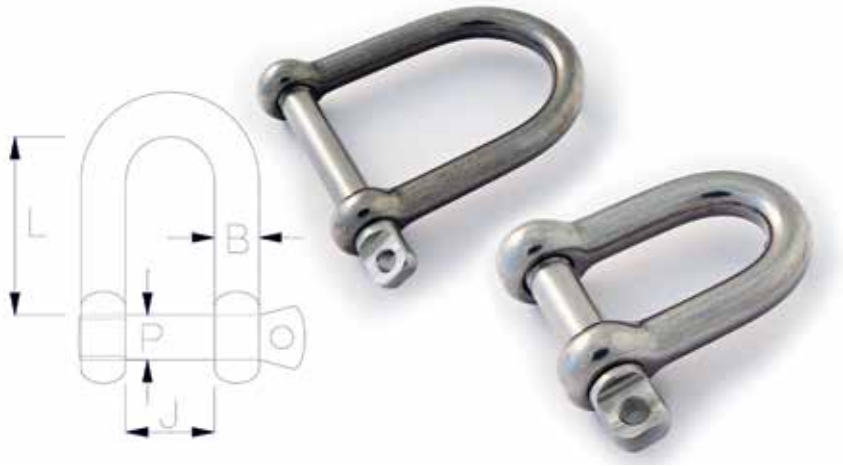

MARINE SHACKLES STAINLESS STEEL 316 LONG D AND TWIST

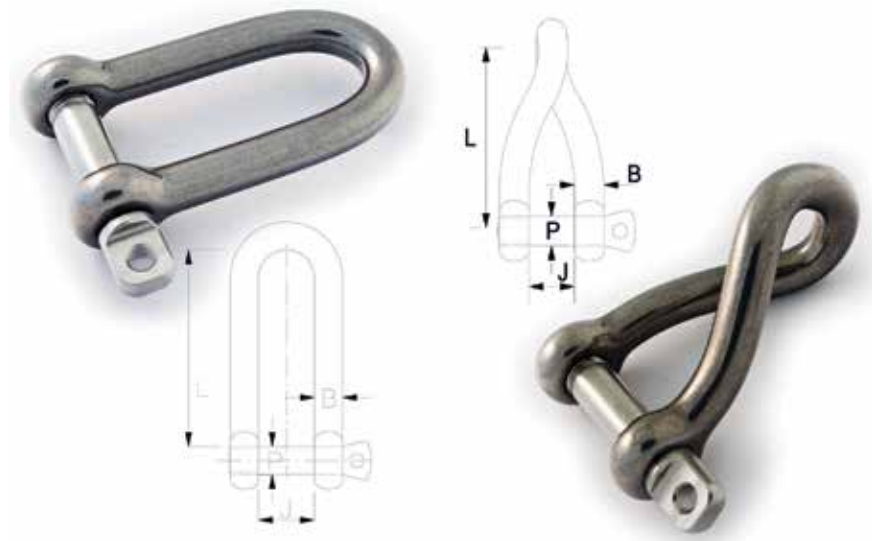

STAINLESS STEEL 316 LONG D SHACKLES						
PRODUCT CODE	PIN P	BODY B	JAW J	INSIDE L	M.B.L*	WEIGHT
LD04	4mm	4mm	8mm	24mm	600kg	12g
LD05	5mm	5mm	10mm	29mm	1200kg	20g
LD06	6mm	6mm	13mm	43mm	1600kg	32g
LD08	8mm	8mm	16mm	49mm	2400kg	69g
LD10	9.5mm	9.5mm	19mm	55mm	3800kg	117g
STAINLESS STEEL GRADE 316 LONG TWIST SHACKLES						
LT04	4mm	4mm	8mm	24mm	600kg	12g
LT05	5mm	5mm	10mm	28mm	1200kg	20g
LT06	6mm	6mm	13mm	38mm	1600kg	32g
LT08	8mm	8mm	16mm	45mm	2400kg	69g
LT10	9.5mm	9.5mm	19mm	50mm	3800kg	117g
Larger shackles manufactured to order.						

Inspection certificate BS EN10204 3.1b available on request. This must be specified at the time of order.

PRODUCT CODE	PIN P	BODY B	JAW J	INSIDE L	M.B.L*	NOMINAL WEIGHT
T04	4mm	4mm	8mm	15.5mm	600kg	7g
T05	5mm	5mm	10mm	17.5mm	1200kg	13g
T06	6mm	6mm	13mm	21mm	1600kg	24g
T08	8mm	8mm	16mm	26mm	2400kg	53g
T10	9.5mm	9.5mm	19mm	32mm	3800kg	97g
T11	11mm	11mm	22mm	39mm	4800kg	152g
T12	12.7mm	12.7mm	26mm	44mm	6000kg	237g
T16	16mm	14.3mm	29mm	50mm	8000kg	450g
T19	19mm	16mm	32mm	57mm	11000kg	585g

MARINE SHACKLES STAINLESS STEEL 316 TWIST



TERMS & CONDITIONS

1. Interpretation
- 1.1 In these Conditions "BUYER" means the person who accepts a quotation of the Seller for the sale of the Goods or whose order for the Goods is accepted by the Seller "GOODS" means the goods (including any instalment of the goods or any parts for them) which the Seller is to supply in accordance with these Conditions "SELLER" means PETERSEN STAINLESS RIGGING LIMITED [or any associated or subsidiary company of it] "CONDITIONS" means the standard terms and conditions of sale set out in this document and (unless the context otherwise requires) includes any special terms and conditions agreed in writing between the Buyer and the Seller "CONTRACT" means the contract for the purchase and sale of the Goods "WRITING" includes telex, cable, facsimile transmission and comparable means of communication
- 1.2 Any reference in these Conditions to any provision of a statute shall be construed as a reference to that provision as amended, re-enacted or extended at the relevant time.
2. Basis of the Sale
- 2.1 The Seller shall sell and the Buyer shall purchase the Goods in accordance with any written quotation of the Seller which is accepted by the Buyer, or any order of the Buyer which is accepted by the Seller, subject in either case to these Conditions, which shall govern the Contract to the exclusion of any other terms and conditions subject to which any such quotation is accepted or purported to be accepted, or any such order is made or purported to be made, by the Buyer.
3. Orders and Specifications
- 3.1 No order submitted by the Buyer shall be deemed to be accepted by the Seller unless and until confirmed in Writing by the Seller's authorised representative.
- 3.2 The Buyer shall be responsible to the Seller for ensuring the accuracy of the terms of any order (including any applicable specification) submitted by the Buyer, and for giving the Seller any necessary information relating to the Goods within a sufficient time to enable the Seller to perform the Contract in accordance with its terms.
- 3.3 The quantity, quality and description of and any specification for the Goods shall be those set out in the Seller's quotation (if accepted by the Buyer) or the Buyer's order (if accepted by the Seller).
- 3.4 If the Goods are to be manufactured or any process is to be applied to the Goods by the Seller in accordance with a specification submitted by the Buyer, the Buyer shall indemnify the Seller against all loss, damages, costs and expenses awarded against or incurred by the Seller in connection with or paid or agreed to be paid by the Seller in settlement of any claim for infringement of any patent, copyright, design, trade mark or other industrial or intellectual property rights of any other person which results from the Seller's use of the Buyer's specification.
- 3.5 The Seller reserves the right to make any changes in the specification of the Goods which are required to conform with any applicable statutory requirements or EC requirements or, where the Goods are to be supplied to the Seller's specification, which do not materially affect their quality or performance.
- 3.6 No order which has been accepted by the Seller may be cancelled by the Buyer except with the agreement in Writing of the Seller and on terms that the Buyer shall indemnify the Seller in full against all loss (including loss of profit), costs (including the cost of all labour and materials used), damages, charges and expenses incurred by the Seller as a result of cancellation.
4. Price of the Goods
- 4.1 The price of the Goods shall be the Seller's quoted price or, where no price has been quoted (or a quoted price is no longer valid), the price listed in the Seller's published price list current at the date of despatch of the order. Where the goods are for export from the United Kingdom, the Seller's published export price list shall apply. All prices quoted are valid for 30 days only or until earlier acceptance by the Buyer, after which time they may be altered by the Seller without giving notice to the Buyer.
- 4.2 The Seller reserves the right, by giving notice to the Buyer at any time before delivery, to increase the price of the Goods to reflect any increase in the cost to the Seller which is due to any factor beyond the control of the Seller (such as, without limitation, any foreign exchange fluctuation, currency regulation, alteration of duties, significant increase in the costs of labour, materials or other costs of manufacture), any change in delivery date, quantities or specifications for the Goods which is requested by the Buyer, or any delay caused by any instructions of the Buyer or failure of the Buyer to give the Seller adequate information or instructions.
- 4.3 Except as otherwise stated under the terms of any quotation or in any price list of the Seller, and unless otherwise agreed in Writing between the Buyer and the Seller, all prices are given by the Seller on a delivered basis, but where the Seller agrees to deliver the Goods otherwise than at the Seller's premises, the Buyer shall be liable to pay the Seller's additional charges for transport, packaging and insurance.
- 4.4 The price is exclusive of any applicable value added tax, which the Buyer shall be additionally liable to pay to the Seller at the prevailing rate applicable at the time of despatch of the goods.
5. Terms of Payment
- 5.1 Subject to any special terms agreed in Writing between the Buyer and the Seller, the Seller shall be entitled to invoice the Buyer for the price of the Goods on or at any time after delivery of the Goods, unless the Goods are to be collected by the Buyer or the Buyer wrongfully fails to take delivery of the Goods, in which event the Seller shall be entitled to invoice the Buyer for the price at any time after the Seller has notified the Buyer that the Goods are ready for collection or (as the case may be) the Seller has tendered delivery of the Goods.
- 5.2 The Buyer shall pay the price of the Goods within [30 days] of the date of the Seller's invoice, notwithstanding that delivery may not have taken place and the property in the Goods has not passed to the Buyer. The time of payment of the price shall be of the essence of the Contract. Receipts for payment will be issued only upon request.
- 5.3 If the Buyer fails to make any payment on the due date then, without prejudice to any other right or remedy available to the Seller, the Seller shall be entitled to cancel the contract or suspend any further deliveries to the Buyer, and charge the Buyer interest (both before and after any judgment) on the amount unpaid, at the rate of 3 per cent per annum above the base rate of Barclays Bank plc from time to time, until payment in full is made (a part of a month being treated as a full month for the purpose of calculating interest).
- 5.4 Where delivery is made by instalments each separate delivery shall constitute a separate order for the purposes of payment.
6. Delivery
- 6.1 Any dates quoted for delivery of the Goods are approximate only and the Seller shall not be liable for any delay in delivery of the Goods howsoever caused. Time for delivery shall not be of the essence unless previously agreed by the Seller in writing. The Goods or any part of them may be delivered by the Seller in advance of the quoted delivery date upon giving reasonable notice to the Buyer.
- 6.2 Where the Goods are to be delivered in instalments, each delivery shall constitute a separate contract and failure by the Seller to deliver any one or more of the instalments in accordance with these Conditions or any claim by the Buyer in respect of any one or more instalments shall not entitle the Buyer to treat the Contract as a whole as repudiated.
- 6.3 If the Seller fails to deliver the Goods for any reason other than any cause beyond the Seller's reasonable control or the Buyer's fault, the Buyer shall give written notice to the Seller within 7 days of the expected date of delivery and the Seller's liability shall be limited to the excess (if any) of the cost to the Buyer (in the cheapest available market) of similar goods to replace those not delivered over the price of the Goods.
- 6.4 If the Buyer fails to take delivery of the Goods or fails to give the Seller adequate delivery instructions at the time stated for delivery (otherwise than by reason of any cause beyond the Buyer's reasonable control or by reason of the Seller's fault) then, without prejudice to any other right or remedy available to the Seller, the Seller may store the Goods until actual delivery and charge the Buyer for the reasonable costs (including insurance) of the storage; or sell the Goods at the best price readily obtainable and (after deducting all reasonable storage and selling expenses) charge the Buyer for any shortfall below the price under the Contract.
7. Risk and Property
- 7.1 Risk of damage to or loss of the Goods shall pass to the Buyer:
- 7.1.1 in the case of Goods to be delivered otherwise than at the Buyer's premises at the time when the Seller notifies the Buyer that the Goods are available for collection; or
- 7.1.2 in the case of Goods to be delivered at the Buyer's premises, at the time of delivery or, if the Buyer wrongfully fails to take delivery of the Goods, the time when the Seller has tendered delivery of the Goods.
- 7.2 Notwithstanding delivery and the passing of risk in the Goods, or any other provision of these Conditions, the property in the Goods shall not pass to the Buyer until the Seller has received in cash or cleared funds payment in full of the price of the Goods and all other goods agreed to be sold by the Seller to the Buyer and previously invoiced whether or not actually delivered.
- 7.3 Until such time as the property in the Goods passes to the Buyer, the Buyer shall hold the Goods as the Seller's fiduciary agent and bailee, and shall keep the Goods separate from those of the Buyer and third parties and properly stored, protected and insured and identified as the Seller's property, but shall be entitled to re-sell or use the Goods in the ordinary course of its business.
- 7.4 Until such time as the property in the Goods passes to the Buyer (and provided the Goods are still in existence and have not been resold), the Seller shall be entitled at any time to require the Buyer to deliver up the Goods to the Seller and, if the Buyer fails to do so forthwith, to enter upon any premises of the Buyer or any third party where the Goods are stored and repossess the Goods.
- 7.5 The Buyer shall not be entitled to pledge or in any way charge by way of security for any indebtedness any of the Goods which remain the property of the Seller, but if the Buyer does so all moneys owing by the Buyer to the Seller shall (without prejudice to any other right or remedy of the Seller) forthwith become due and payable.
8. Warranties and Liability
- 8.1 Subject to the conditions set out below the Seller warrants that the Goods will correspond with their specification at the time of delivery which specifications shall be determined by the terms of the Contract and not by any drawings, photographs, illustrations or other descriptive matter accompanying the Seller's estimates or contained in any advertising matter.
- 8.2.1 the Seller shall be under no liability in respect of any defect in the Goods arising from any drawing, design or specification supplied by the Buyer;
- 8.2.2 the Seller shall be under no liability in respect of any defect arising from fair wear and tear, wilful damage, negligence, abnormal working conditions, failure to follow the Seller's instructions (whether oral or in writing) misuse or alteration or repair of the Goods without the Seller's approval;
- 8.2.3 the Seller shall be under no liability under the above warranty (or any other warranty, condition or guarantee) if the total price for the Goods has not been paid by the due date for payment;
- 8.2.4 the above warranty does not extend to parts, materials or equipment not manufactured by the Seller, in respect of which the Buyer shall only be entitled to the benefit of any such warranty or guarantee as is given by the manufacturer to the Seller.
- 8.3 Subject as expressly provided in these Conditions, and except where the Goods are sold to a person dealing as a consumer (within the meaning of the Unfair Contract Terms Act 1977), all warranties, conditions or other terms implied by statute or common law are excluded to the fullest extent permitted by law.
- 8.4 Any claim by the Buyer which is based on any defect in the quality or condition of the Goods or their failure to correspond with specification shall (whether or not delivery is refused by the Buyer) be notified to the Seller within 7 days from the date of delivery. If delivery is not refused, and the Buyer does not notify the Seller accordingly, the Buyer shall not be entitled to reject the Goods and the Seller shall have no liability for such defect or failure, and the Buyer shall be bound to pay the price as if the Goods had been delivered in accordance with the Contract.
- 8.5 Where any valid claim in respect of any of the Goods which is based on any defect in the quality or condition of the Goods or their failure to meet specification is notified to the Seller in accordance with these Conditions,
- 8.6 Except in respect of death or personal injury caused by the Seller's negligence, the Seller shall not be liable to the Buyer by reason of any representation, or any implied warranty, condition or other term, or any duty at common law, or under the express terms of the Contract, for any consequential loss or damage (whether for loss of profit or otherwise), costs, expenses or other claims for consequential whatsoever (and whether caused by the negligence of the Seller, its employees or agents or otherwise) which arise out of or in connection with the supply of the Goods or their use or resale by the Buyer, and the entire liability of the Seller under or in connection with the Contract shall not exceed the price of the Goods, except as expressly provided in these Conditions.
- 8.7 The Seller shall not be liable to the Buyer or be deemed to be in breach of the Contract by reason of any delay in performing, or any failure to perform, any of the Seller's obligations in relation to the Goods, if the delay or failure was due to any cause beyond the Seller's reasonable control. Without prejudice to the generality of the foregoing, the following shall be regarded as causes beyond the Seller's reasonable control:
- 8.7.1 Act of God, explosion, flood, tempest, fire or accident;
- 8.7.2 war or threat of war, sabotage, insurrection, civil disturbance or requisition;
- 8.7.3 acts, restrictions, regulations, by-laws, prohibitions or measures of any kind on the part of any governmental, parliamentary or local authority;
- 8.7.4 import or export regulations or embargoes;
- 8.7.5 strikes, lock-outs or other industrial actions or trade disputes (whether involving employees of the Seller or of a third party);
- 8.7.6 difficulties in obtaining raw materials, labour, fuel, parts or machinery;
- 8.7.7 power failure or breakdown in machinery.
9. Insolvency of Buyer
- 9.1 This clause applies if:
- 9.1.1 the Buyer makes any voluntary arrangement with its creditors or becomes subject to an administration order or (being an individual or firm) becomes bankrupt or (being a company) goes into liquidation (otherwise than for the purposes of amalgamation or reconstruction); or
- 9.1.2 an encumbrancer takes possession, or a receiver is appointed, of any of the property or assets of the Buyer; or
- 9.1.3 the Buyer ceases, or threatens to cease, to carry on business; or
- 9.1.4 the Seller reasonably apprehends that any of the events mentioned above is about to occur in relation to the Buyer and notifies the Buyer accordingly.
- 9.2 If this clause applies then, without prejudice to any other right or remedy available to the Seller, the Seller shall be entitled to cancel the Contract or suspend any further deliveries under the Contract without any liability to the Buyer, and if the Goods have been delivered but not paid for the price shall become immediately due and payable notwithstanding any previous agreement or arrangement to the contrary.
10. Export Terms
- 10.1 In these Conditions "Incoterms" means the international rules for the interpretation of trade terms of the International Chamber of Commerce as in force at the date when the Contract is made. Unless the context otherwise requires, any term or expression which is defined in or given a particular meaning by the provisions of Incoterms shall have the same meaning in these Conditions, but if there is any conflict between the provisions of Incoterms and these Conditions, the latter shall prevail.
- 10.2 Where the Goods are supplied for export from the United Kingdom, the provisions of this clause 11 shall (subject to any special terms agreed in writing between the Buyer and the Seller) apply notwithstanding any other provision of these Conditions.
- 10.3 The Buyer shall be responsible for complying with any legislation or regulations governing the importation of the Goods into the country of destination and for the payment of any duties thereon.
- 10.4 Unless otherwise agreed in writing between the Buyer and the Seller, Goods shall be delivered to the air or sea port of shipment and the Seller shall be under no obligation to give notice under section 32(3) of the Sale of Goods Act 1979.
- 10.5 Payment of all amounts due to the Seller shall be made by irrevocable letter of credit opened by the Buyer in favour of the Seller and confirmed by a bank in England acceptable to the Seller or, if the Seller has agreed in Writing on or before acceptance of the Buyer's order to waive this requirement, by acceptance by the Buyer and delivery to the Seller of a current account cheque in sterling drawn on a Bank in England within 30 days of the invoice date.
11. General
- 11.1 Any notice required or permitted to be given by either party to the other under these Conditions shall be in Writing addressed to that other party at its registered office or principal place of business or such other address as may at the relevant time have been notified pursuant to this provision to the party giving the notice.
- 11.2 No waiver by the Seller of any breach of the Contract by the Buyer shall be considered as a waiver of any subsequent breach of the same or any other provision.
- 11.3 If any provision of these Conditions is held by any competent authority to be invalid or unenforceable in whole or in part the validity of the other provisions of these Conditions and the remainder of the provision in question shall not be affected thereby.
- 11.4 The Contract shall be governed by the Laws of England and the parties agree to submit to the non-exclusive jurisdiction of the English Courts.

CONTACT US

Head Office

Petersen Stainless Rigging Limited
Cowen Road, Blaydon on Tyne
Tyne & Wear, NE21 5TW

t: +44 (0) 191 414 0156
f: +44 (0) 191 499 0041
e: sales@petersen-stainless.co.uk

Scandinavia and Baltic Region

Petersen Stainless Rigging AB
Gothenburg

t: +46 73-388 23 88
e: sales@petersen-stainless.se

East Asia and Australasia

Petersen Stainless SEA
Kuala Lumpur

e: SEA@petersen-stainless.co.uk

North & South America

Petersen Stainless USA

e: USA@petersen-stainless.co.uk