

# **Marine Solutions**

Fire Rated Bulkhead and Partition Walls





## A LEADER IN PASSIVE FIRE PROTECTION

Promat is a leading manufacturer of passive fire protection panels and systems for marine applications, offering an extensive range of products designed to meet the most stringent requirements of 21st century fire protection legislation.

The production of non-combustible calcium silicate boards and lightweight high performance insulation materials is one of Promat's best strengths. Promat's products for marine applications stand for: **high performance, significant space & weight savings**, fast installation and tailor-made system meeting the requirements of shipyards & clients. Our product portfolio includes PROMARINE®, PROMASOUND®, PROMAGUARD® and PROMASIL® MARINE ranges. All Promat marine products are designed to meet and exceed the most stringent marine legislation.



**Yacht / Mega Yacht**



**Cruise**



**Naval**



**OSV**

Promat's products can be used in cruise ships, ferry boats, mega yachts, living quarters and for all types of work boats.

### PROMARINE®-640

*Non-combustible decorative panel*  
Nominal density: 640kg/m<sup>3</sup>



PROMARINE®-640 is a non-combustible autoclaved calcium silicate board, reinforced with selected minerals and fibres. It is formulated without inorganic fibres and does not contain formaldehyde. The board is off-white in colour and has a smooth sanded surface. The board can easily be finished with high pressure laminates. It is resistant to the effects of moisture and will not physically deteriorate when used in damp or humid conditions.

### PROMARINE®-450

*Lightweight Non-combustible decorative panel* - Nominal density: 450kg/m<sup>3</sup>



PROMARINE®-450 is a non-combustible autoclaved calcium silicate board reinforced with selected minerals and fibres. It is formulated without inorganic fibres and does not contain formaldehyde. The board is off-white in colour and has a smooth sanded surface on both faces. The board can easily be finished with high pressure laminates. It is resistant to the effects of moisture and will not physically deteriorate when used in damp or humid conditions.

### PROMASIL®-MARINE

*Very lightweight Non-combustible board*  
Nominal density: 285kg/m<sup>3</sup>



PROMASIL® MARINE is one of the best insulating solutions. PROMASIL® MARINE boards are compact, self-bearing and lightweight; it is resistant to continuous temperatures of 1000°C. It also represents an alternative to mineral fibres due to its excellent dimensional stability, mechanical properties, durability and absence of organic binders. PROMASIL® MARINE is certified non-combustible in accordance with MED and U.S. Coast Guard Directives.

### PROMINA®-M

*High Humidity Resistant Non-Combustible Board* - Density: 1000kg/m<sup>3</sup>



PROMINA® M is a versatile mineral board, gypsum and silica-free. One side is a smooth finish and can be bonded with most surface finishes as used in the marine market. PROMINA® M retains its mechanical properties unaltered even in presence of high humidity. PROMINA® M offers high mass with low thicknesses providing significant noise reduction in the systems it is used in. Applications include walls, suspended ceilings and floating floors.

### PROMARINE®-PX1

*Non-Combustible Mineral Bound Calcium Silicate Board* - Density: < 885kg/m<sup>3</sup>

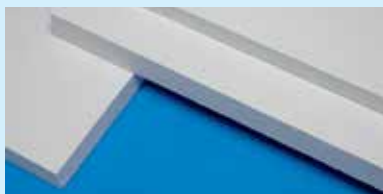

PROMARINE®-PX1 is a new generation of non-combustible mineral bound board, using the innovative PROMAXON® technology.

Providing superior strength, insulation and stability, PROMARINE®-PX1 is available in 12, 15 and 19mm thicknesses. When bonded with high-pressure laminates, PROMARINE®-PX1 can be installed as linings, partitions and ceilings on seagoing vessels and offshore platforms.

### PROMATECT®-H

*Non-Combustible Matrix Engineered Mineral Board* - Density: 870kg/m<sup>3</sup>



PROMATECT®-H is a non-combustible matrix engineered mineral board reinforced with selected fibres and fillers. It is formulated without organic fibres and does not contain formaldehyde.

The board can be left plain or can be easily finished with paints. PROMATECT®-H is resistant to the effects of moisture and will not physically deteriorate when used in damp or humid conditions. Performance characteristics are not degraded by age.



### LIGHTWEIGHT CUSTOMISED SOLUTIONS

Promat provides low weight fire protective solutions for interiors that can **save up to 30% of weight** compared to traditional solutions. All Promat's systems are A and/or B class MED certified. Where fire and acoustical performance is required, Promat can provide **integrated solutions that can cover both acoustic and thermal applications**.

Promat have the knowledge and the numerical simulation tools to engineer such **integrated applications**, which can help the designer at the very early design stage in order to optimise space and comfort. Improvement of the Energy Efficiency Design Index (EEDI) can also be achieved by the adoption of Promat integrated solutions.

### ADVANTAGES



#### FIRE RESISTANCE

Promat's solutions are all **A and B modules MED certified**. Each product is **certified non-combustible in accordance with MED**. Products are also tested under other local and international standards such as U.S. Coast Guard Directive or ISO standards.



#### ACOUSTIC INSULATION

Promat can provide a customised solution where both fire and acoustic applications are required. Promat boards can be combined with an additional acoustic barrier.



#### LIGHTWEIGHT

Promat's boards are lightweight. Thanks to this characteristic, **Promat boards can be integrated in many specifications where the weight is a key issue**.



#### AESTHETIC

Promat boards **can be painted or laminated** if necessary. Different shades, colors and textures are available upon request.

### EXAMPLES OF SOLUTION

#### EXAMPLE 1

Bulkhead A0 Class Certified with PROMARINE®-640 Panel

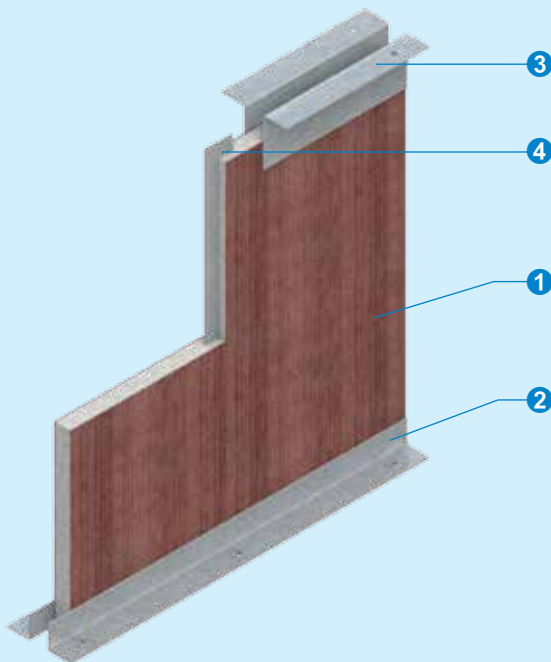

- ① 12.7mm PROMARINE®-640 2420 x 1210mm
- ② Bottom angle 20 x 20 x 1.2mm
- ③ Top angle 50 x 20 x 1.2mm
- ④ Solid spline 20 x 1mm

#### EXAMPLE 2

Bulkhead A60 Class Certified with PROMARINE®-450 Panel

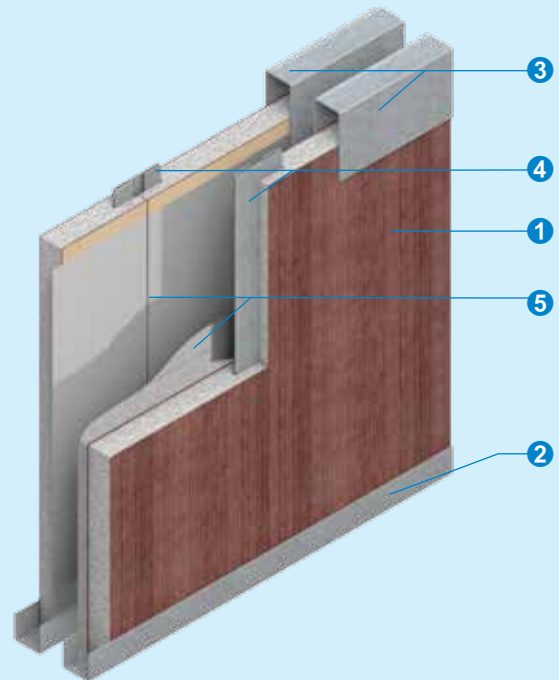

- ① 19mm PROMARINE®-450 2420 x 1210mm
- ② Bottom channel PC-15-E 20 x 22 x 20mm - 1.2mm thick
- ③ Top channel PC-17-G 50 x 22 x 50mm - 1.5mm thick
- ④ "C" spline PJ-1-A 38mm - 3.6mm overall thickness
- ⑤ Aluminium foil 0.025 mm + PROMASEAL® Glue fixed with 50 x 50mm dabs at 300mm centres



### HEAD OFFICE BELGIUM

#### Promat International N.V.

Bormstraat 24  
2830 Tisseelt  
Tel: +32 15 718 100  
Fax: +32 15 718 109  
Email: info@promat-international.com  
www.promat-international.com  
www.promat-tunnel.com  
www.promat-marine.com  
www.promat-oilandgas.com

### ASIA PACIFIC HEADQUARTERS, MALAYSIA

#### Promat International (Asia Pacific) Ltd.

Unit 19-02-01 - Level 2 PNB Damansara  
No.19 Lorong Dungun - Damansara Heights  
50490 Kuala Lumpur  
Tel: +60 3 2095 5111  
Fax: +60 3 2095 6111  
Email: info@promat-ap.com  
www.promat-ap.com

### AUSTRALIA

#### Promat Australia Pty. Ltd.

1 Scotland Road  
SA 5031 Mile End South  
Tel: 1800 Promat (776 628)  
Fax: +61 8 8352 1014  
Email: mail@promat.com.au  
www.promat-ap.com

### AUSTRIA

#### Promat GmbH

St.-Peter-Straße 25  
4021 Linz  
Tel: +43 732 6912 0  
Fax: +43 732 6912 3740  
Email: info@promat.at  
www.promat.at

#### Promat GmbH

IZ NÖ-Süd, Straße 16, Objekt 69  
1. OG, Top 2  
LKW Walter Business Park  
2355 Wiener Neudorf  
Tel: +43 2236 660915  
Fax: +43 669070  
Email: office@promat.at  
www.promat.at

### CHINA

#### Promat China Ltd.

Room 506, Block A, Qi Lin Plaza  
13-35 Pan Fu Road  
510180 Guangzhou  
Tel: +86 20 8136 1167  
Fax: +86 20 8136 1372  
Email: info@promat.com.cn  
www.promat.com.cn

### CZECH REPUBLIC

#### Promat s.r.o.

Okalova 22/784  
16000 Praha 6 - Bubeneč  
Tel: +420 2 2439 0811  
Fax: +420 2 3333 3576  
Email: promat@promatpraha.cz  
www.promatpraha.cz

### DENMARK

#### Promat Nordic

Kometvej 36  
6230 Rødovre  
Tel: +45 7020 0482  
Fax: +45 7466 1020  
Email: info@promat.nu  
www.promat.nu

### FRANCE

#### Promat S.A.S.

BP 66 Rue de L'Ammandier  
78540 Vernouillet  
Tel: +33 1 3979 6160  
Fax: +33 1 3971 1660  
Email: info@promat.fr  
www.promat.fr

### GERMANY

#### Promat GmbH

Scheifenkamp 16  
40878 Ratingen  
Tel: +49 2102 493 0  
Fax: +49 2102 493 111  
Email: mail@promat.de  
www.promat.de

### HONG KONG

#### Promat International (Asia Pacific) Ltd.

Room 1010, C.C. Wu Building  
302-308 Hennessy Road, Wanchai  
Tel: +852 2836 3692  
Fax: +852 2834 4313  
Email: apromath@promat.com.hk  
www.promat.com.hk

### INDIA

#### Promat (Malaysia) Sdn. Bhd. (India Representative Office)

610-611, Ansal Imperial Tower  
C-Block, Community Centre  
Naraina Vihar, Naraina  
110028 New Delhi  
Tel: +91 11 2577 8413  
Fax: +91 11 2577 8414  
Email: info-india@promat-asia.com  
www.promat-ap.com

### ITALY

#### Promat S.p.A.

Corso Paganini 39/3  
16125 Genova  
Tel: +39 010 248 8411  
Fax: +39 010 213 768  
Email: info@promat.it  
www.promat.it

### MALAYSIA

#### Promat (Malaysia) Sdn. Bhd.

Unit 19-02-01 - Level 2 PNB Damansara  
No.19 Lorong Dungun  
Damansara Heights  
50490 Kuala Lumpur  
Tel: +60 3 2095 8555  
Fax: +60 3 2095 2111  
Email: info@promat-ap.com  
www.promat-ap.com

### NETHERLANDS

#### Promat B.V.

Vleugelboot 22  
3991 CL Houten  
PO Box 475  
3990 GG Houten  
Tel: +31 30 241 0770  
Fax: +31 30 241 0771  
Email: info@promat.nl  
www.promat.nl

### POLAND

#### Promat TOP Sp. z o.o.

ul. Przeglawska 8  
03 879 Warszawa  
Tel: +48 22 212 2280  
Fax: +48 22 212 2290  
Email: top@promatop.pl  
www.promatop.pl

### RUSSIA

#### Promat A+B

Repräsentanz - ul. Kantemirovskaya 58  
115477 Moscow  
Tel: +7 495 325 4268  
Fax: +7 495 231 7977  
Email: gd@promat.ru  
www.promat.ru

### SINGAPORE

#### Promat Building System Pte. Ltd.

10 Science Park Road  
#03-14 The Alpha - Singapore Science Park II  
117684 Singapore  
Tel: +65 6776 7635  
Fax: +65 6776 7624  
Email: info@promat.com.sg  
www.promat-ap.com

### SOUTH EAST EUROPE

#### Promat SEE

Samoborska cesta 91 A,  
10 090 Zagreb, Croatia  
tel: +385-21-218294  
fax: +385-21-218295  
mob: +385-99-202 8000  
Email: marine@promat-see.com

### SOUTH KOREA

#### Promat International (Asia Pacific) Ltd.

(Korea Branch Office)  
Room 406, 811-2 - Yeoksam-dong Gangnam-gu  
135080 Seoul  
Tel: +82 70 7794 8216  
Email: apromath@promat.com.hk  
www.promat-ap.com

### SPAIN

#### Promat Ibérica S.A.

C/Velazquez, 47 - 6° izda  
28001 Madrid  
Tel: +34 91 781 1550  
Fax: +34 91 575 1597  
Email: info@promat.es  
www.promat.es

### SWITZERLAND

#### Promat AG

Stationsstrasse 1  
8545 Rickenbach-Sulz  
Tel: +41 52 320 9400  
Fax: +41 52 320 9402  
Email: office@promat.ch  
www.promat.ch

### UNITED ARAB EMIRATES

#### Promat Fire Protection LLC

Plot no. 597-921, Dubai Investment Park 2  
PO Box 123945, Dubai  
Tel: +971 4 2 32 9780  
Fax: +971 4 232 9781  
www.promatfp.ae

### UNITED KINGDOM

#### Promat UK Ltd.

The Sterling Centre, Eastern Road, Bracknell  
RG12 2TD Berkshire, Great Britain  
Tel: +44 1344 381 300/400  
Fax: +44 1344 381 301  
Email: marketinguk@promat.co.uk  
www.promat.co.uk

### USA

#### Promat Inc.

1731 Fred Lawson Drive  
TN 37801 Maryville  
Tel: +1 865 681 0155  
Fax: +1 865 681 0016  
Email: sales@promat.us  
www.promat.us