

QUICK TURNAROUND | COMPETITIVE PRICES | FRIENDLY SERVICE | HIGH PERFORMANCE | SPECIALIST MARINE | UK MADE

# ALROSE

british gas springs



MARINELINE™

Gas Springs designed specifically for  
harsh and exposed environments

97.9 % of stock springs can be supplied within 7 days

## What is Marineline?

Marineline gas springs have been specifically designed to operate in harsh marine or outdoor environments whilst still offering the design elegance of an Alrose Product. They are manufactured from 316L Stainless Steel and fitted with low friction Igus bearings, helping ensure smooth operating characteristics. The range is used on all types of commercial and pleasure craft from ribs and launches right up to multi-million pound super-yachts. Suitable for land based use also, the same design characteristics and aesthetic features make Marineline<sup>a</sup> springs the obvious choice for any application that is customer-facing or exposed to the elements.

Our Marineline<sup>a</sup> springs are held in stock ready for despatch and we can usually get your order to you anywhere in the world within a week.



---

## About Us

Alrose Products Ltd have been manufacturing and selling the highest quality gas springs for over 25 years.

From our facility near Peterborough, England we ship our products worldwide and have an ever growing network of distributors to assist you with product selection and aftercare.



---

## What We Do

We pride ourselves on our ability to manufacture gas springs in-house to our customers exacting specifications. Few jobs are too big, small or outlandish.

Our experienced design team can work directly with you to create detailed 3d drawings and ensure that you specify a gas spring fit for purpose.

The manufacturing team has the capability of volume and one off manufacture and assembly. Finally our precision filling capability ensures that the unit is developed to your exact pressure and force requirements.

Of course, all of the activities conducted within British Gas Springs are completed to BS EN ISO 9001:2008 standards. We have a constant R&D programme to ensure that our products meet market needs. As the company develops look out for further Gas Spring product developments.

In addition to gas springs we also have an extensive range of end fittings and mounting brackets held in stock. We even supply portable pressure reducing and filling kits.

---

## Why Alrose Products?

At British Gas Springs we understand how important reliable and consistent gas spring performance is. Whether it is a simple application helping to open a hatch on a boat, bus or aircraft, through to the activation of a design feature.

To ensure that customers around the world get high performance springs we have a complete in house engineering test facility and have adopted a culture of continuous improvement to ensure that we always strive for perfection.

Our knowledgeable and friendly customer service team is available to discuss solutions to your gas spring problems. You can call, email or visit our website for further information that might assist you.

Contact details are found on the back page.





# MARINELINE™ GS6-15

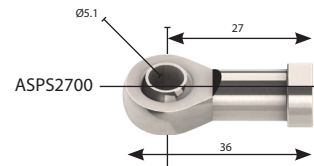
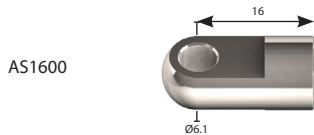
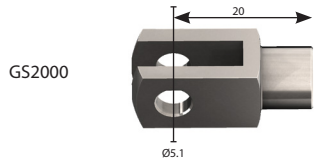
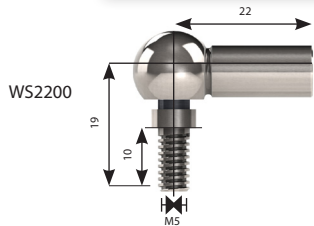
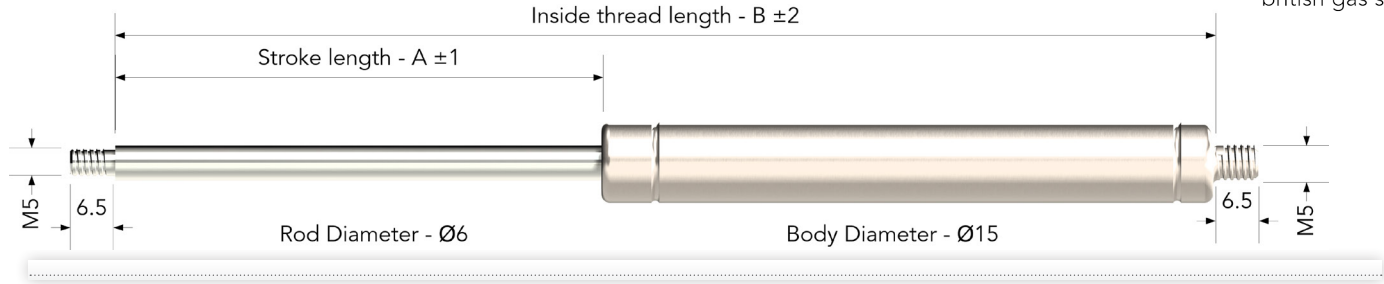

Rod Diameter	Body Diameter	Stroke Length - A	Inside thread length - B	End Fittings Thread Size		Force (minimum)	Force (maximum)
				Rod	Cylinder		
GS6	15	50	130	M5	M5	25N	400N
GS6	15	80	190	M5	M5	25N	400N
GS6	15	100	230	M5	M5	25N	400N
GS6	15	150	330	M5	M5	25N	400N
GS6	15	200	430	M5	M5	25N	400N

## Order example

GS6	15	50	172*	V†	WS2200	GS2000	250N
-----	----	----	------	----	--------	--------	------

\*Don't forget when specifying your spring to add on the end to centre lengths (L1/L2) of each end fitting (B + L1 + L2). This will be your extended centre value.  
† Marineline range comes with end valves as standard.

All dimensions are in mm.

We supply brackets also - see the brackets page for more details.

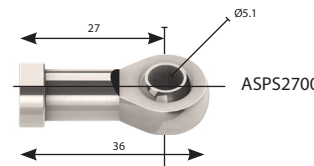
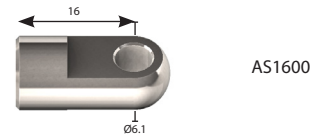
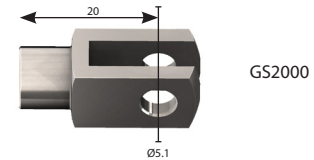
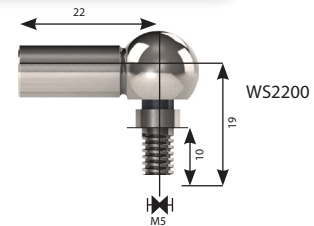





# MARINELINE™ GS8-18

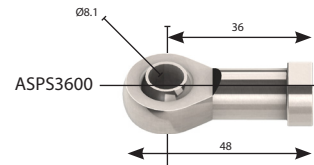
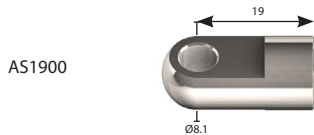
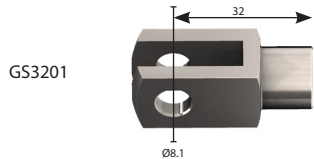
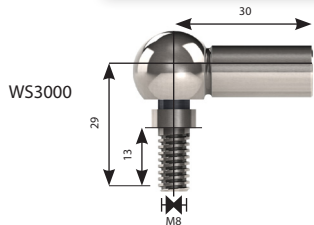
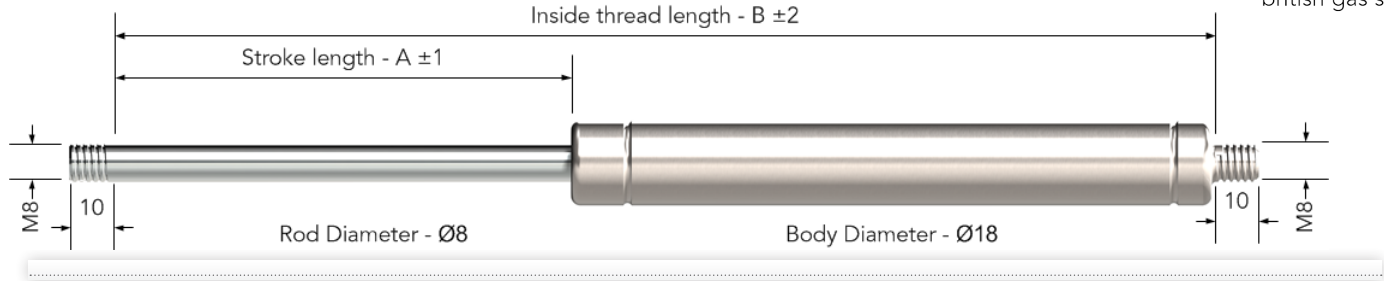

Rod Diameter	Body Diameter	Stroke Length - A	Inside thread length - B	End Fittings Thread Size		Force (minimum)	Force (maximum)
				Rod	Cylinder		
GS8	18	100	245	M8	M8	50N	750N
GS8	18	150	345	M8	M8	50N	750N
GS8	18	200	445	M8	M8	50N	750N
GS8	18	250	545	M8	M8	50N	750N

## Order example

GS8	18	100	245*	V†	NONE	NONE	250N
-----	----	-----	------	----	------	------	------

\*Don't forget when specifying your spring to add on the end to centre lengths (L1/L2) of each end fitting (B + L1 + L2). This will be your extended centre value.  
† Marineline range comes with end valves as standard.

All dimensions are in mm.

We supply brackets also - see the brackets page for more details.

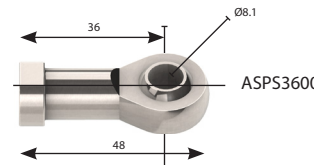
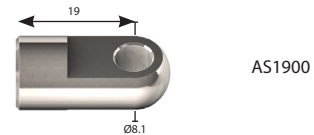
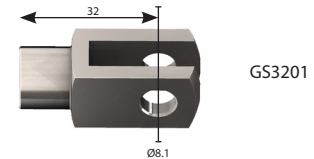
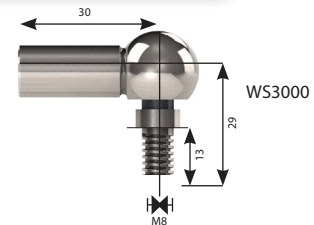





# MARINELINE™ GS10-23

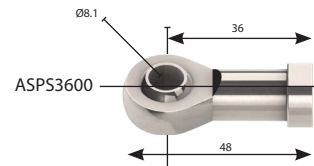
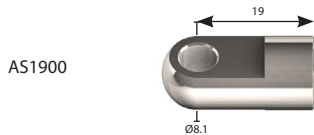
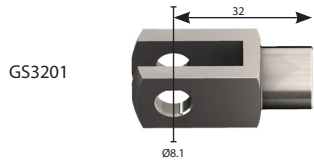
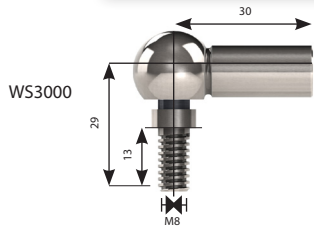
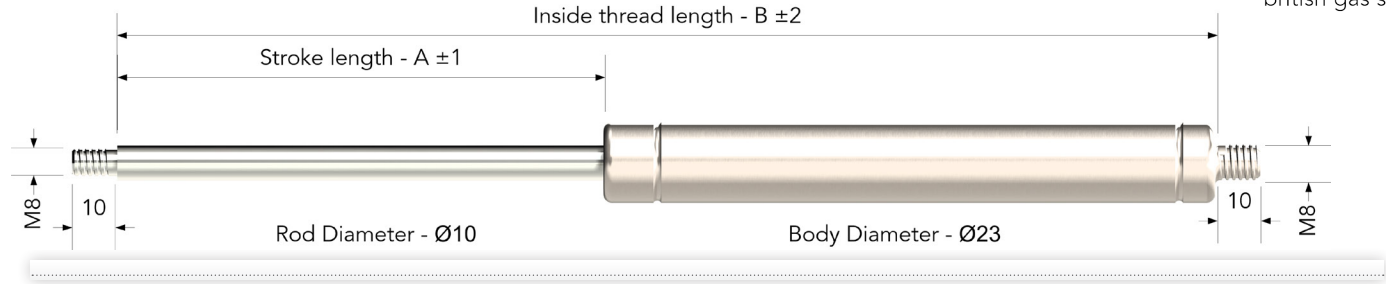

Rod Diameter	Body Diameter	Stroke Length - A	Inside thread length - B	End Fittings Thread Size		Force (minimum)	Force (maximum)
				Rod	Cylinder		
GS10	23	100	245	M8	M8	50N	1250N
GS10	23	150	345	M8	M8	50N	1250N
GS10	23	200	445	M8	M8	50N	1250N
GS10	23	250	545	M8	M8	50N	1250N
GS10	23	300	645	M8	M8	50N	1250N
GS10	23	400	845	M8	M8	50N	1250N

## Order example

GS10	23	100	305*	V†	WS3000	WS3000	500N
------	----	-----	------	----	--------	--------	------

\*Don't forget when specifying your spring to add on the end to centre lengths (L1/L2) of each end fitting (B + L1 + L2). This will be your extended centre value.  
† Marineline range comes with end valves as standard.

All dimensions are in mm.

We supply brackets also - see the brackets page for more details.

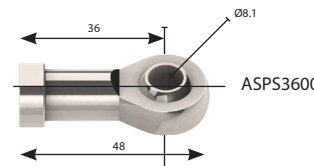
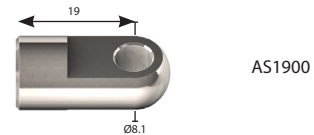
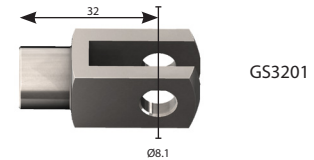
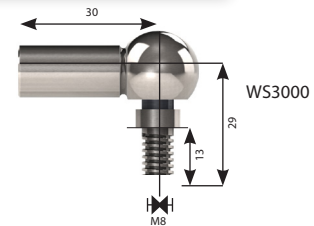



# MARINELINE™ GS14-28

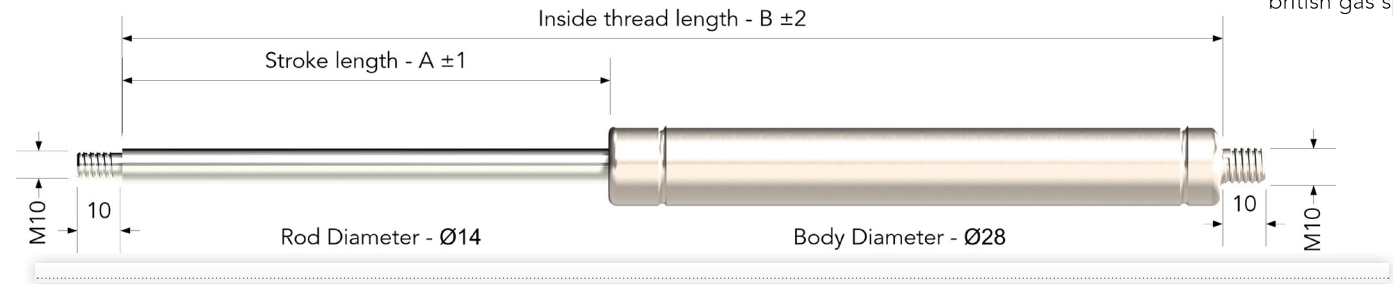

WS3500

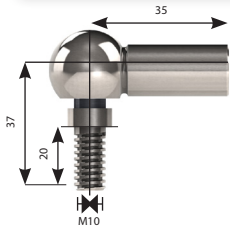

GS4000

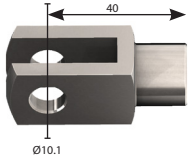

AS2700

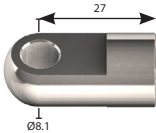

ASPS4300

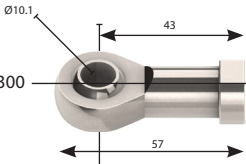

Rod Diameter	Body Diameter	Stroke Length - A	Inside thread length - B	End Fittings Thread Size		Force (minimum)	Force (maximum)
				Rod	Cylinder		
GS14	28	100	250	M10	M10	150N	2500N
GS14	28	150	350	M10	M10	150N	2500N
GS14	28	200	450	M10	M10	150N	2500N
GS14	28	250	550	M10	M10	150N	2500N
GS14	28	300	650	M10	M10	150N	2500N
GS14	28	350	750	M10	M10	150N	2500N
GS14	28	400	850	M10	M10	150N	2500N
GS14	28	500	1050	M10	M10	150N	2500N

## Order example

GS14	28	100	320*	V†	WS3500	WS3500	500N
------	----	-----	------	----	--------	--------	------

\*Don't forget when specifying your spring to add on the end to centre lengths (L1/L2) of each end fitting (B + L1 + L2). This will be your extended centre value.  
† Marineline range comes with end valves as standard.

All dimensions are in mm.

We supply brackets also - see the brackets page for more details.

WS3500

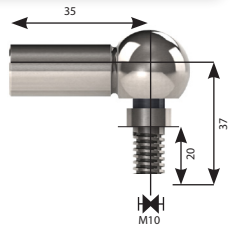

GS4000

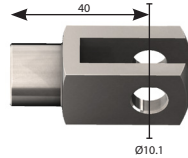

AS2700

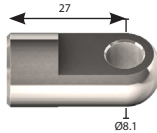

ASPS4300

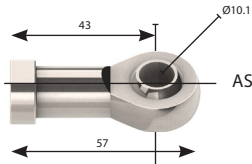



# BRACKETS

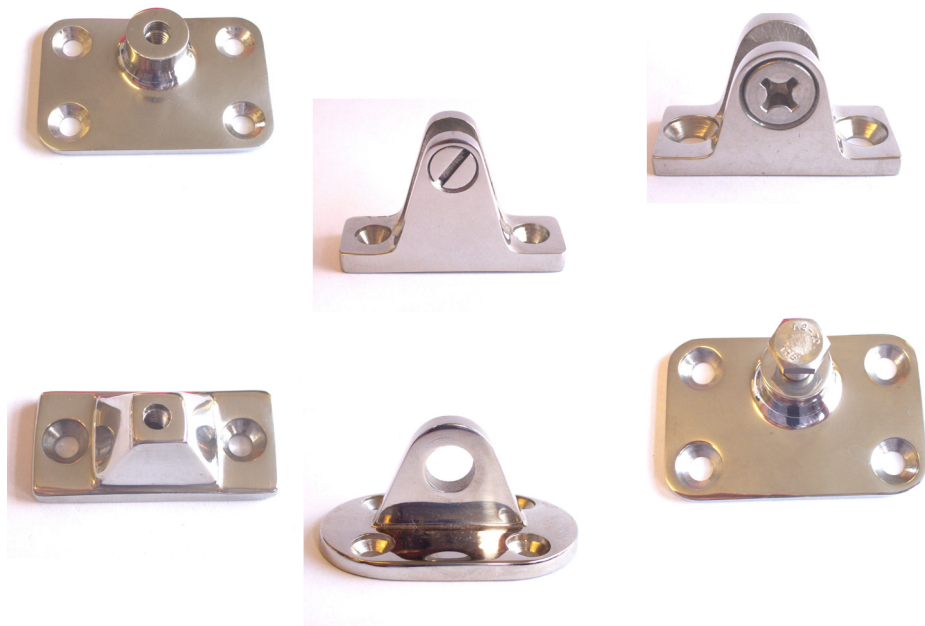

We stock a wide variety of highly polished stainless steel brackets of varying sizes. Here are some of our most common examples, available in a range of sizes to fit your gas spring.

Contact us for our full range and dimension details.

# SERVICES

---

## Replacing a British gas spring



If you are replacing a British Gas Spring then the product should be clearly labelled and by simply quoting the product reference batch number and part number we will be able to offer a quote for a replacement unit.

---

## Replacing an alternative manufacturers gas spring

If you are replacing an alternative gas spring then there are a number of options available:

- » Let us know the manufacturers part number and we can try to offer a like for like replacement.
- » If the product has no identification marks then simply provide the unit dimensions.

Note: It may be that depending on the type of unit the end fittings will need to be replaced

---

## Bespoke when required

If your requirements are not met by any of the products in this range then please contact us to discuss free bespoke spring design. We have manufactured springs from 40mm - 3000mm in length and capacities upto 10kN.

---

## Quick delivery of in-stock items

Our Marineline™ springs are held in stock ready for despatch and we can usually get your order to you anywhere in the world within a week.

---

## Where to get more help or product selection assistance

Our website contains full details of our product ranges - [www.gas-springs.com](http://www.gas-springs.com), alternatively please call our technical sales team on +44 (0)1778 561422 and they will be happy to help you find the right solution for you.

Full terms and conditions of sale can be found on our website.

# ALROSE



## british gas springs

Alrose Products Ltd (British Gas Springs)  
Units 3-4 King Street Industrial Estate  
Langtoft  
Peterborough  
PE6 9NF  
United Kingdom

[www.gas-springs.com](http://www.gas-springs.com)  
[sales@gas-springs.com](mailto:sales@gas-springs.com)

Tel: +44 (0)1778 561422  
Fax: +44 (0)1778 560400