



# WATER-PRO MODULAR B-90

By Eco-sistems watermakers

Carrer d'Horta 22 – 08203 Sabadell – Spain

[www.eco-sistems.com](http://www.eco-sistems.com)

+34 647 219 510 [export@eco-sistems.com](mailto:export@eco-sistems.com)

## SPECS WATER-PRO MODULAR B-90

Installation, packing list, dimensions, and options

# WATER-PRO MODULAR B-90 INSTALLATION

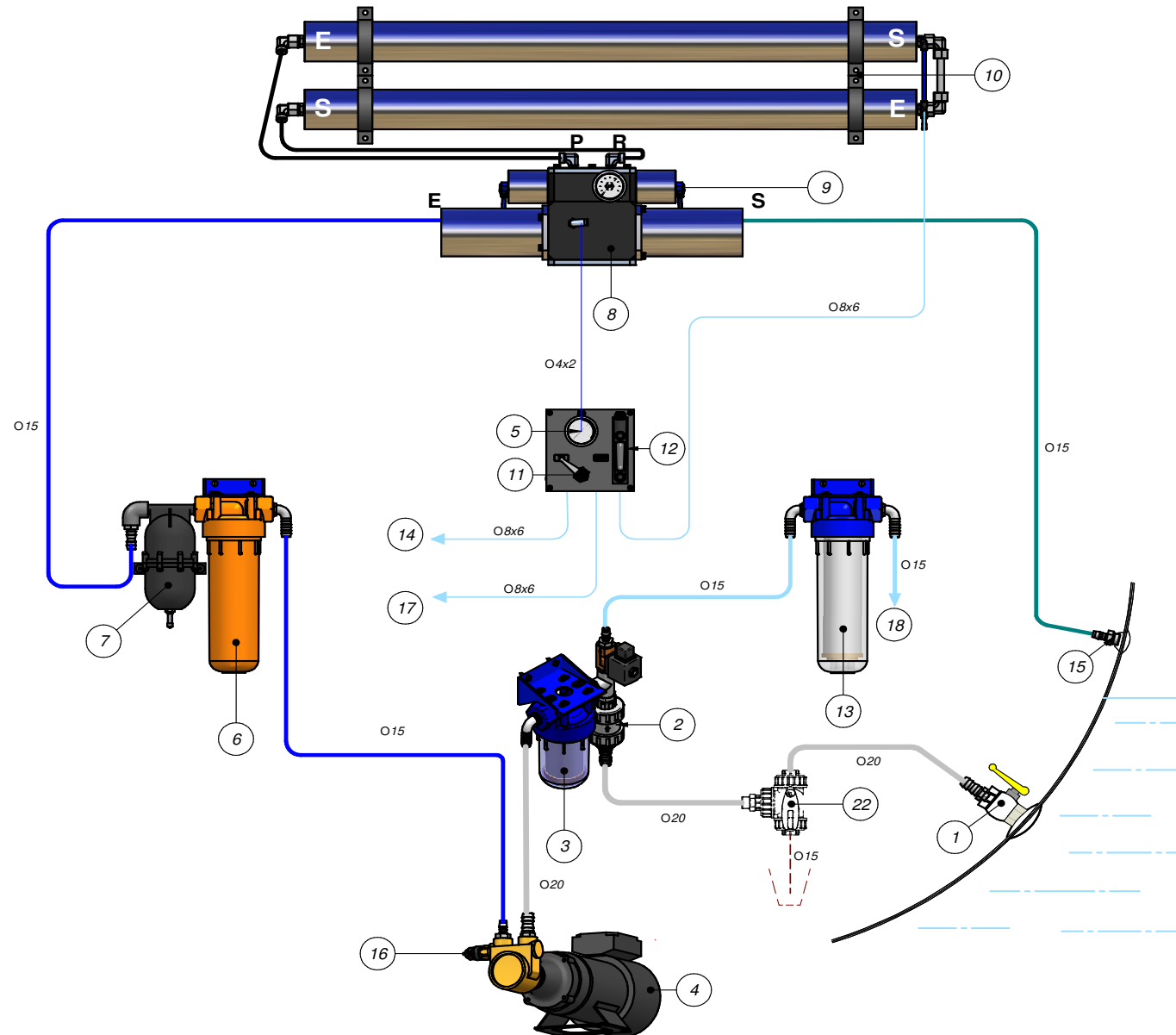

## SYSTEM COMPONENTS

1. - Seacock valve to uptake the seawater
2. - Three-way valve (production – flushing)
3. - Washable Strainer filter
4. - Low pressure booster pump
5. - Low pressure gauge
6. - 5 microns filter container
7. - Expansion vessel
8. - High pressure pump with energy recovery system ST-18/CERAMIC
9. - High pressure gauge
10. - R.O. Membrane and vessel
11. - Three ways valve for the produced water
12. - Flowmeter production
13. - Anti Cl carbon filter
14. - Produced water output to the tank
15. - Brine discharge thru-hull
16. - Pressure switch
17. - Direct produced water output (CONTROL)
18. - Boat freshwater input
22. - (OPTIONAL) Three-way valve for wintering

# WATER-PRO MODULAR B-90 PACKING LIST

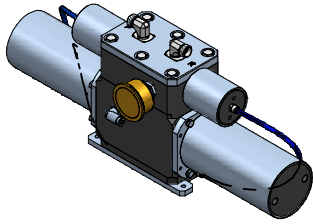

HIGH PRESSURE  
PUMP ST 18

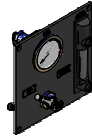

HYDRAULIC CONTROL  
PANEL

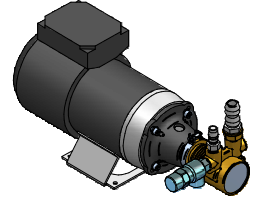

MOTOR PUMP

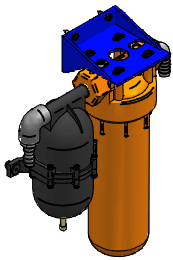

LOW PRESSURE FILTER SET

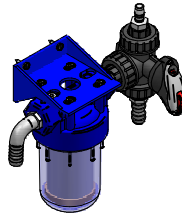

SEA STAINER SET

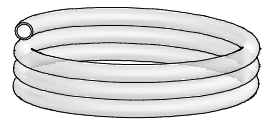

HOSE CLEAR BRAID Ø20

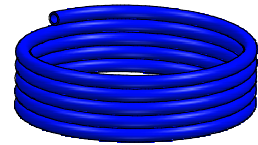

BLUE TUBE Ø15X22



BLUE TUBE Ø6X4

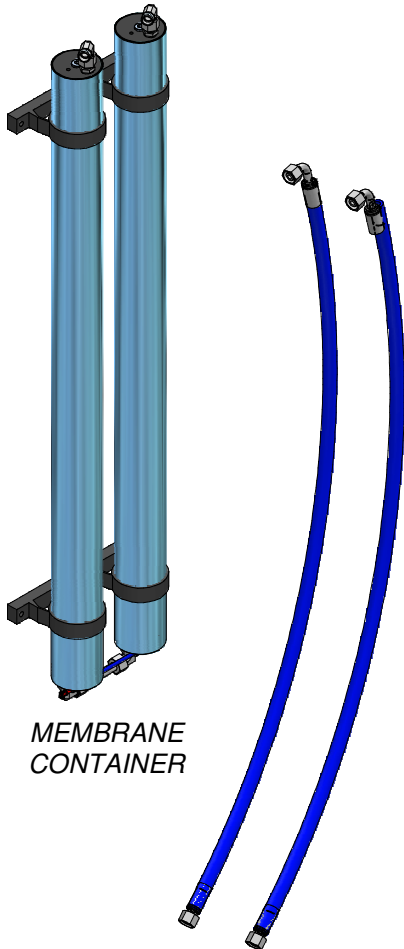

MEMBRANE  
CONTAINER

2-HIGH PRESSURE  
HOSE

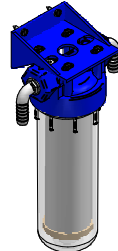

FWF FILTER SET



POLYAMIDE HOSE  
Ø4X2



4 – HOSE CLAMP  
16/27



10 – HOSE CLAMP  
12/22



CONNECTOR Ø6 TUBE X  
¼ BSP PLASTIC



ADAPTER ½ BSP X ¾  
BARB PVC



2-ADAPTER ½ BSP X  
½ BARB PVC



FILTER WRENCH

# WATER-PRO MODULAR B-90 PACKING LIST

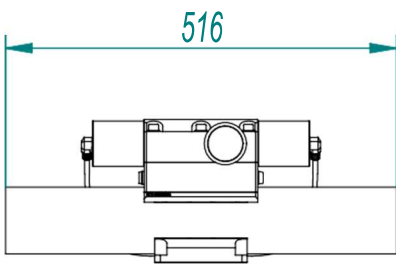

*HIGH PRESSURE  
PUMP  
ECOSISTEMS ST-18*

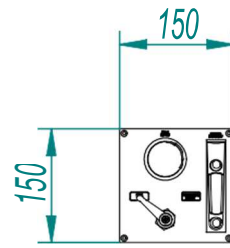
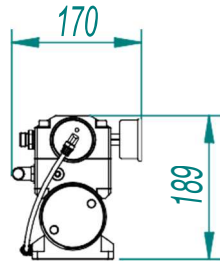

*HYDRAULIC PANEL*

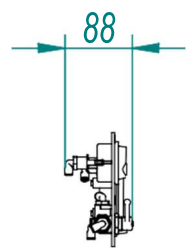

*MEMBRANE CONTAINER SET*

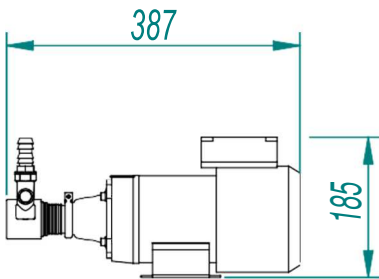
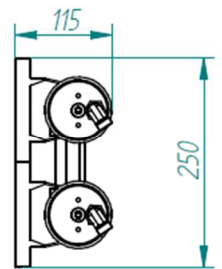

*BOOSTER PUMP SET*

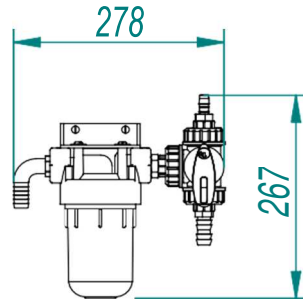
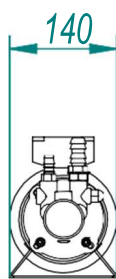

*STAINER FILTER SET*

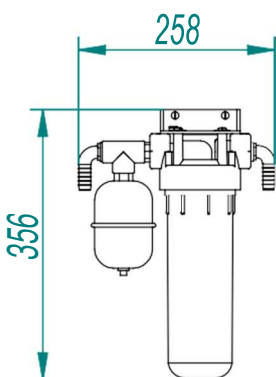
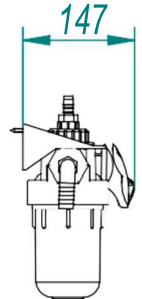

*LOW PRESSURE FILTER SET*

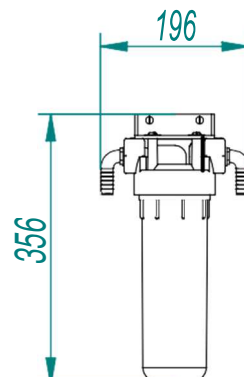
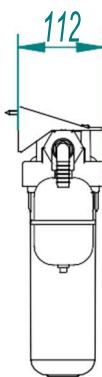

*CARBON FILTER SET*

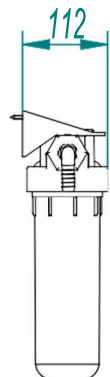

# WATER-PRO MODULAR B-90 SPECS

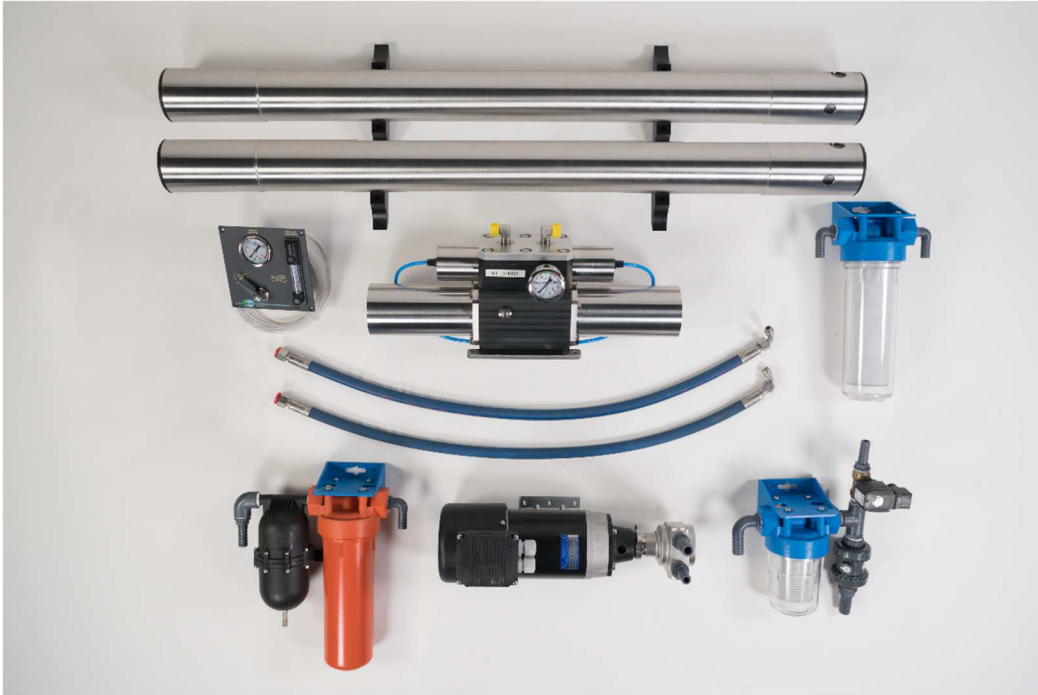

## Electrical specifications

- 750 W Motor – 12 V DC consumption: 48,7 Amps, 540 W\*
- 750 W Motor – 24 V DC consumption: 24,3 Amps, 540 W\*
- 750 W Motor – 220 V AC consumption: 2,4 Amps, 540 W\*
- Average consumption per litre: 6,5w\*

\*The consumption is estimated and might have some variation depending on the water temperature, salinity and system installation.

## Other specifications

- Booster pump minimum inlet pressure: + 0,05 bars
- Booster pump outlet pressure: 11 – 14 bars
- High pressure pump outlet pressure: 45 – 60 bars
- Feed flow: 900 litres / hour
- Average effective production: 90 litres / hour (+/- 10%)
- Conversion: 10 %
- Rejected/permeated ratio: 9 : 1
- Membrane type: 2 membranes 25/40

COMPONENTS	WEIGHT
High pressure pump	13 KG
Membrane container set	12 KG
Motor set	9 KG
Stainer filter set	1.2 KG
Low pressure filter set	1.5 KG
Carbon filter set	1.2 KG
Hydraulic panel	0.8 KG

# BASIC MODEL

- Automatic pressure regulation
- Energy recovery high pressure pump
- **Manual fresh flush:** you would only turn a valve into the correct position to perform a fresh flush or pass into production mode.
- **Hydraulic indicators:** Flowmeter, low pressure gauge, high pressure gauge
- **Carbon filter** – filters the chlorine from the tank to perform a fresh flush.



## Hydraulic control panel

This hydraulic control panel, included in the installation kit, allows to read the production and low pressure. Moreover, it is equipped with a three-way valve to send the produced water to the tank or to the kitchen.

# OPTIONS

## Wintering valve

This valve allows you to winterize your unit the easiest way possible.



## Maintenance kit

In this kit you will find all the spares you need to for one year navigation.

It includes two 5 microns filters, one rotary vane pump, one carbon filter and 250 g of membrane conservative.

