



WATER-PRO MODULAR B-60

By Eco-sistems watermakers

Carrer d'Horta 22 – 08203 Sabadell – Spain

www.eco-sistems.com

+34 647 219 510 export@eco-sistems.com

SPECS WATER-PRO MODULAR B-60

Installation, packing list, dimensions, and options

WATER-PRO MODULAR B-60 INSTALLATION WITH FRESH FLUSH

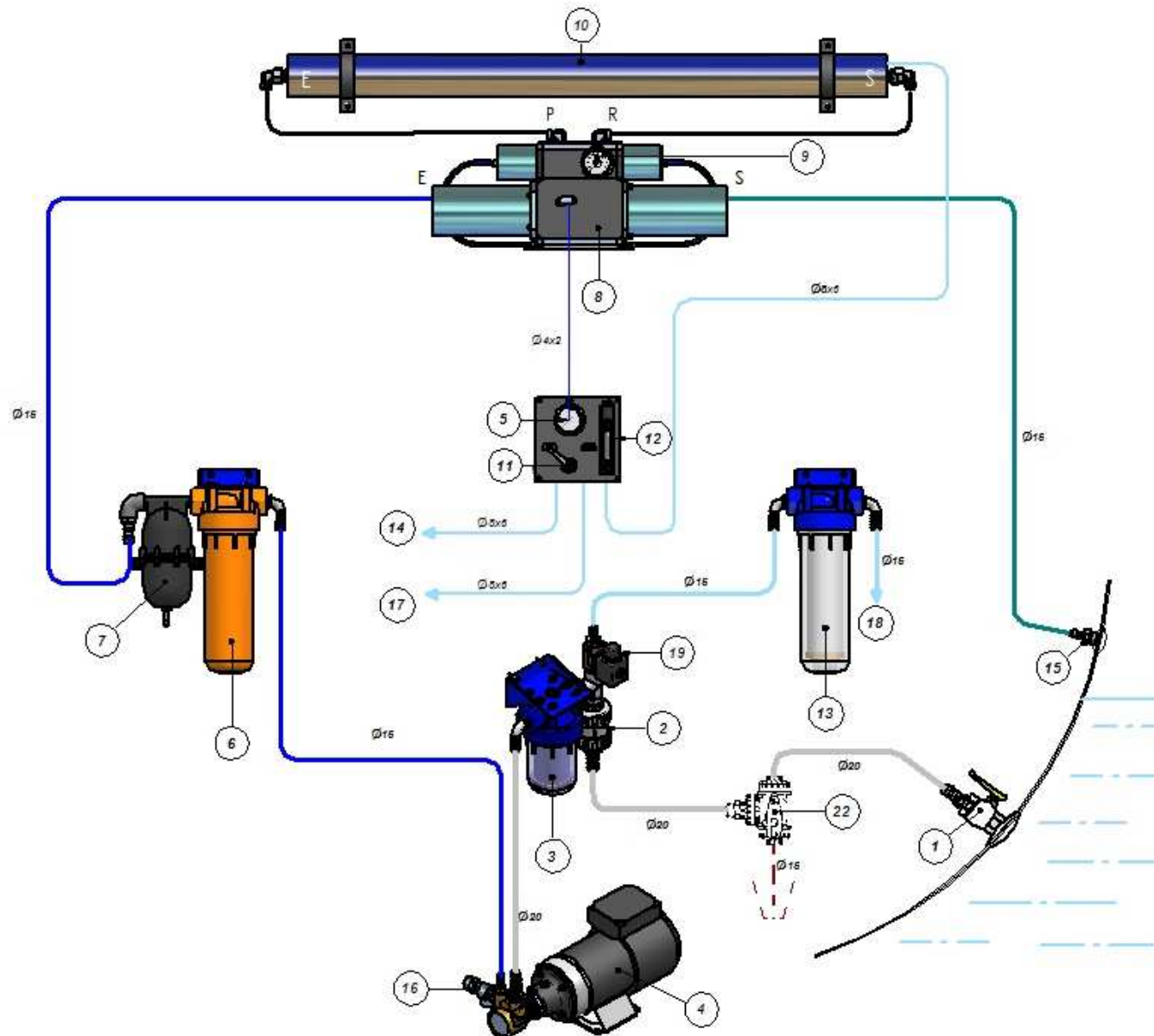

SYSTEM COMPONENTS

1. - Seacock valve to uptake the seawater
2. - Three-way valve (production – flushing)
3. - Washable strainer filter
4. - Low pressure booster pump
5. - Low pressure gauge
6. - 5 microns filter container
7. - Expansion vessel
8. - High pressure pump with energy recovery system ST-18/CERAMIC
9. - High pressure gauge
10. - R.O. Membrane and vessel
11. - Three ways valve for the produced water
12. - Flowmeter production
13. - Anti Cl carbon filter
14. - Produced water output to the tank
15. - Brine discharge thru-hull
16. - Pressure switch
17. - Direct produced water output -CONTROL
18. - Boat freshwater input
21. - (OPTIONAL) Automatic fresh flush box
22. - (OPTIONAL) Three-way valve for wintering
23. - (OPTIONAL) Remote control for fresh flush system

WATER-PRO MODULAR B-60 PACKING LIST

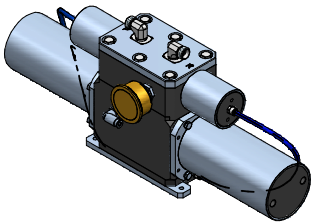

HIGH PRESSURE
PUMP ST 18



HYDRAULIC CONTROL
PANEL

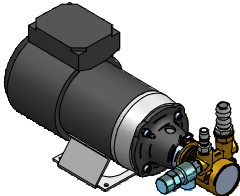

BOOSTER PUMP

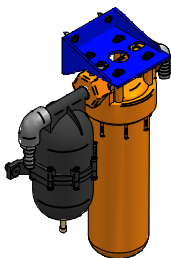

LOW PRESSURE FILTER SET

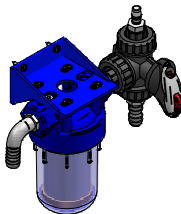

SEA STAINER SET

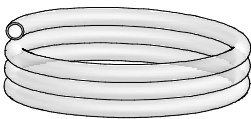

HOSE CLEAR BRAID Ø20

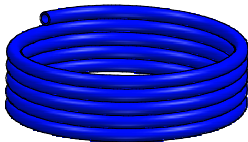

BLUE TUBE Ø15X22



BLUE TUBE Ø6X4

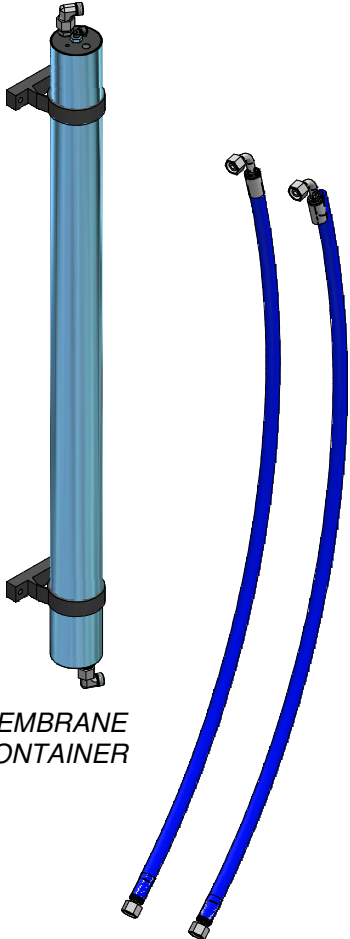

MEMBRANE
CONTAINER

2-HIGH PRESSURE
HOSE

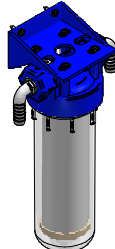

CARBON FILTER SET



POLYAMIDE HOSE
Ø4X2



4 – HOSE CLAMP
16/27



10 – HOSE CLAMP
12/22



CONNECTOR Ø6 TUBE X
¼ BSP PLASTIC



ADAPTER ½ BSP X ¾
BARB PVC



2-ADAPTER ½ BSP X
½ BARB PVC



FILTER WRENCH

WATER-PRO MODULAR B-60 PACKING LIST

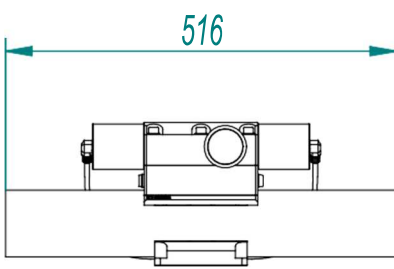

*HIGH PRESSURE
PUMP*

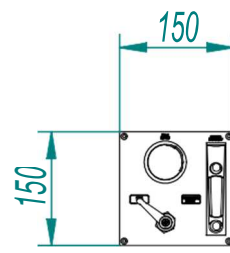
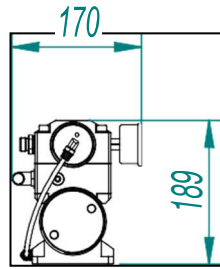

HYDRAULIC PANEL

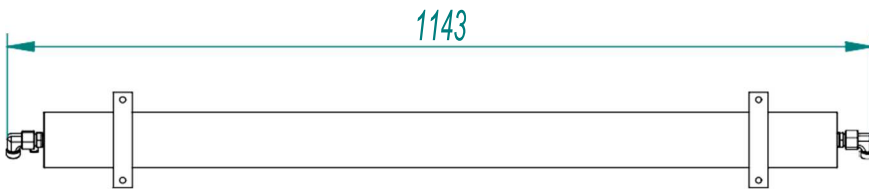
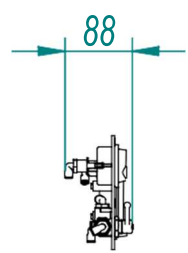

MEMBRANE CONTAINER SET

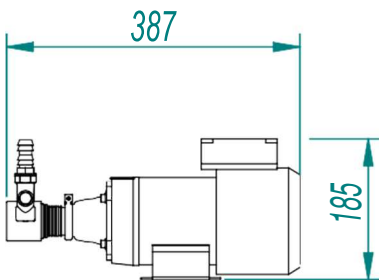
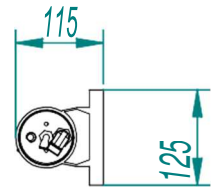

BOOSTER PUMP

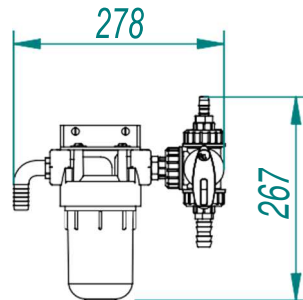
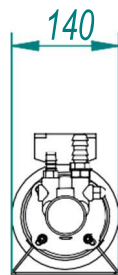

STAINER FILTER SET

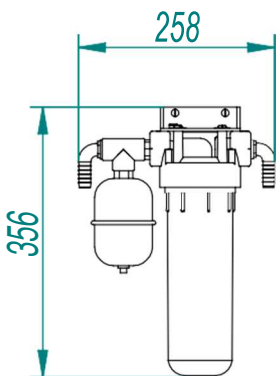
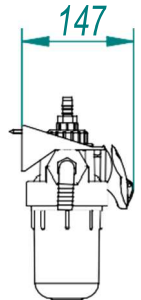

LOW PRESSURE FILTER SET

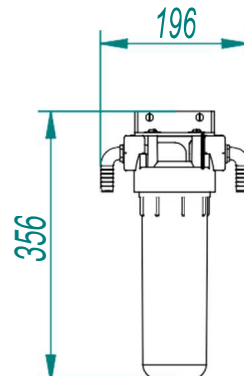
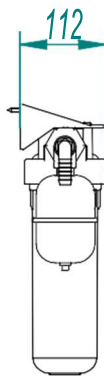

CARBON FILTER SET

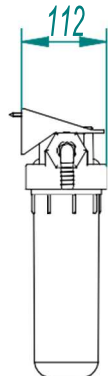

WATER-PRO MODULAR B-60 SPECS



Electrical specifications

- 550 W Motor – 12 V DC consumption: 25 Amps, 350 W*
- 550 W Motor – 24 V DC consumption: 12,5 Amps, 350 W*
- 550 W Motor – 220 AC consumption: 1,6 Amps, 350 W*
- Average consumption per litre: 6,4 W*

*The consumption is estimated and might have some variation depending on the water temperature, salinity, and system installation.

Other specifications

- Booster pump minimum inlet pressure: + 0,05 bars
- Booster pump outlet pressure: 10 – 12,5 bars
- High pressure pump outlet pressure: 45 – 60 bars
- Feed flow: 600 litres / hour
- Average effective production: 60 litres / hour (+/- 10%)
- Conversion: 10%
- Rejected/permeated ratio: 9 : 1
- Membrane type: 1 membrane 25/40
- Sound test: 58-62 db

WATER-PRO MODULAR B-60 COMPONENTS' WEIGHT

COMPONENTS	WEIGHT
High pressure pump	13 KG
Membrane container set	6 KG
Motor set	9 KG
Stainer filter set	1.2 KG
Low pressure filter set	1.5 KG
Carbon filter set	1.2 KG
Hydraulic panel	0.8 KG

BASIC MODEL

- Automatic pressure regulation
- Energy recovery high pressure pump
- **Manual fresh flush:** you would only turn a valve into the correct position to perform a fresh flush or pass into production mode.
- **Hydraulic indicators:** Flowmeter, low pressure gauge, high pressure gauge
- **Carbon filter** – Included in the installation kit, filters the chlorine from the tank to perform a fresh flush.



Hydraulic control panel

This hydraulic control panel, included in the installation kit, allows to read the production and low pressure. Moreover, it is equipped with a three-way valve to send the produced water to the tank or to the kitchen.

WATER-PRO MODULAR B-60 OPTIONS

Automatic fresh flush

With this option you can perform a fresh flush by only pressing a button. The kit includes a solenoid valve, carbon filter and a control panel.



Remote control

Start, flush, and stop the unit from an easy access point **only available with automatic fresh flush option.**



Wintering valve

This valve allows you to winterize your unit the easiest way possible.



Maintenance kit

In this kit you will find all the spares you need to for one year navigation.

It includes two microns filters, one rotary vane pump, one carbon filter and 250 g of membrane conservative.